

# FORWARD VISION II

2944K & 2944KF

## ASSEMBLY INSTRUCTIONS

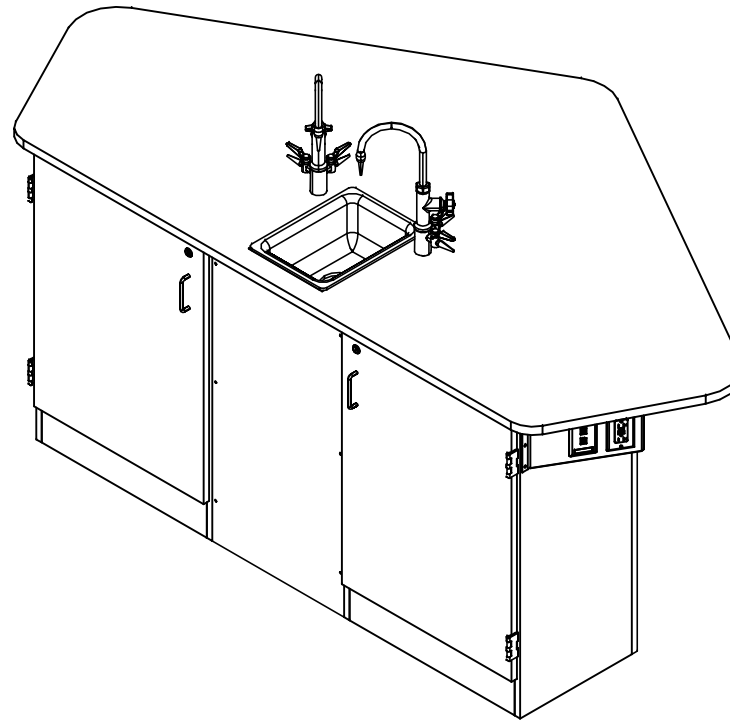

NOTE:

1. MODEL VIEWS MAY NOT REPRESENT EXACT MODEL PURCHASED

DWN BY:	EMK	DWN DATE:	11/4/16
APR BY:		DATE APR:	
APR BY:		DATE APR:	

UNLESS OTHERWISE SPECIFIED  
DIMENSION ARE IN INCHES  
CABINET SQUARENESS ± .0625  
FRACTIONAL VALUES ± 1/32"  
- ALL VALUES ± OVERALL -



300 South Krueger Street  
Suring, WI 54174  
diversifiedwoodcrafts.com

TITLE:  
FORWARD VISION II  
ASSEMBLY INSTRUCTIONS

A	CREATED DRAWING	11/4/16	EMK	-
REV.	DESCRIPTION	DATE	NAME	ECN NO.

REVISION LEVEL

THIS DRAWING IS THE SOLE PROPERTY OF  
DIVERSIFIED WOOD CRAFTS. IT MAY NOT  
BE ALTERED OR CHANGED WITHOUT  
PERMISSION

DRAWING NUMBER:

FORWARD VISION II

SCALE:

NTS

SHEET:

1 OF 7

REVISION:

REV A

## TOOLS REQUIRED

1/2" WRENCH
1/2" SOCKET AND TORQUE WRENCH - OPTIONAL
CONTACT CEMENT
SCREW DRIVER
C-CLAMPS
SHIM STOCK (IF NEEDED)

## ASSEMBLY COMPONENTS

ITEMS INCLUDED	PART #	PART DESCRIPTION	QTY
TOP	VARIES	TOP, PHENOLIC, 1.00X88X46, (EITHER FIXTURE OR FLAT),LABV	1
CABINET	N/A	24"W X 35"H X 15.25"D	2
REMOVABLE PANEL	N/A	18"W X 35"H X 0.75"D	1
BACK PANEL	N/A	66"W X 35"H X 0.75"D	1
SCREWS - REMOVABLE PANEL	100495	SCREW,#10X1- 1/2 PHIL TR. SMS,ZN	6
SCREWS - BACK PANEL	100478	SCREW,#8X1 1/4 SQ. WASHER FLAT HEAD	12
APRONS	N/A	0.81"THK X 4.50"W X 36.812"L	2
BRACKET - APRON TO CABINET	100972	BRACKET, APRON TO CABINET	2
SCREWS - APRON TO CABINET	100037	SCREW,#10X5/8 QUAD PNHD LUB	4
BOLT - APRON TO CABINET	100377	BOLT, 3/8 -16X2 HEX HEAD	4
NUT - APRON TO CABINET	100621	NUT, 3/8 -16 HEX ZINC	4
WASHER - APRON TO CABINET	100451	WASHER,5/16 FLAT ZINC PLATED	4
BRACKET - APRON TO APRON	100376	BRACKET, APRON TO APRON	1
SCREWS - APRON TO APRON	100037	SCREW,#10X5/8 QUAD PNHD LUB	8
BOLT - APRON TO APRON	100381	BOLT,5/16 X2- 3/4, CARRIAGE BOLT	2
NUT - APRON TO APRON	100044	NUT,HEX 5/16 -18 STEEL ZINC	2
WASHER - APRON TO APRON	100451	WASHER,5/16 FLAT ZINC PLATED	2
LEG	500101	LEG,OAK 2.25X2.25X34.25	1
LEG LEVELER	100079	LEG LEVELER,BLK,BASE 1	1
LEG BOOT	100076	LEG BOOT,BLK RUBBER	1

**NOTE:**

- \*\*\*XX\*\* INDICATES ITEMS USED ONLY FOR THE 2944K UNIT.

DWN BY:	EMK	DWN DATE:	11/4/16
APR BY:		DATE APR:	
APR BY:		DATE APR:	



300 South Krueger Street  
Suring, WI 54174  
diversifiedwoodcrafts.com

UNLESS OTHERWISE SPECIFIED  
DIMENSION ARE IN INCHES  
CABINET SQUARENESS ± .0625  
FRACTIONAL VALUES ± 1/32"  
- ALL VALUES ± OVERALL -

TITLE:  
FORWARD VISION II  
TOOLS AND ASSEMBLY COMPONENTS

A	CREATED DRAWING	11/4/16	EMK	-
REV.	DESCRIPTION	DATE	NAME	ECH NO.

THIS DRAWING IS THE SOLE PROPERTY OF  
DIVERSIFIED WOOD CRAFTS. IT MAY NOT  
BE ALTERED OR CHANGED WITHOUT  
PERMISSION

DRAWING NUMBER:	SCALE:	SHEET:	REVISION:
FORWARD VISION II	NTS	2 OF 7	REV A

## ASSEMBLY COMPONENTS

ITEMS INCLUDED	PART #	PART DESCRIPTION	QTY
SILICONE	100711	SILICONE,SEALANT,CLEAR	1
RUBBER BASE MOLDING	100283	RUBBER BASE MOLDING (SOLD BY FOOT)	14
STAINLESS STEEL CORNERS	100057	CORNERS-STAINLESS STEEL,BASE	4
SCREWS - BASE	100064	SCREW,#6X 1/2 PTH SMS SS SCREW	16
ELECTRICAL BRACKET	231782	BRACKET,ELEC BOX,DATA OUTLET	2
SCREWS - ELECTRICAL BRACKET	100649	SCREW,#8X3/4 PHIL TRUSS HEAD SMS	12
ELECTRICAL BOX	100033	ELECTRICAL BOX 3.00X2X2.5 DEEP	4
ELECTRICAL OUTLET	100034	ELEC,OUTLET,GFI,20A 125V,BLK	2
ELECTRICAL DATA JACK	225513	OUTLET,DATA JACK,BLACK	4
ELECTRICAL COVER PLATE	225512	COVER,PLATE,BLK	2
COAT HOOK	207663	HOOKS,COAT(BAER#IV582MB26D)	2
**FIXTURE - FAUCET**	100074-BKR	FIXTURE,L65-WSA-DIV(MULTI-SERVICE)	2
**FIXTURE - SINK**	100691	SINK,EPOXY L3,BLK	1
**FIXTURE - SINK TRAP**	100056	SINK TRAP,PLASTIC ADJUSTABLE	1
**FIXTURE - SINK STOPPER**	100112	SINK STOPPER 1 1/2,BLK	1
**FIXTURE - STRAINER**	100055	SINK,OUTLET/STRAINER EPOXY,BLK	1

**NOTE:**

1. **\*\*XX\*\*** INDICATES ITEMS USED ONLY FOR THE 2944K UNIT.

DWN BY:	EMK	DWN DATE:	11/4/16
APR BY:		DATE APR:	
APR BY:		DATE APR:	

UNLESS OTHERWISE SPECIFIED  
DIMENSION ARE IN INCHES

CABINET SQUARENESS ± .0625  
FRACTIONAL VALUES ± 1/32"  
- ALL VALUES ± OVERALL -



300 South Krueger Street  
Suring, WI 54174  
diversifiedwoodcrafts.com

TITLE:  
**FORWARD VISION II  
TOOLS AND ASSEMBLY COMPONENTS**

A	CREATED DRAWING	11/4/16	EMK	-
REV.	DESCRIPTION	DATE	NAME	ECN NO.
REVISION LEVEL				

THIS DRAWING IS THE SOLE PROPERTY OF  
DIVERSIFIED WOOD CRAFTS. IT MAY NOT  
BE ALTERED OR CHANGED WITHOUT  
PERMISSION

DRAWING NUMBER:	SCALE:	SHEET:	REVISION:
<b>FORWARD VISION II</b>	NTS	3 OF 7	REV A

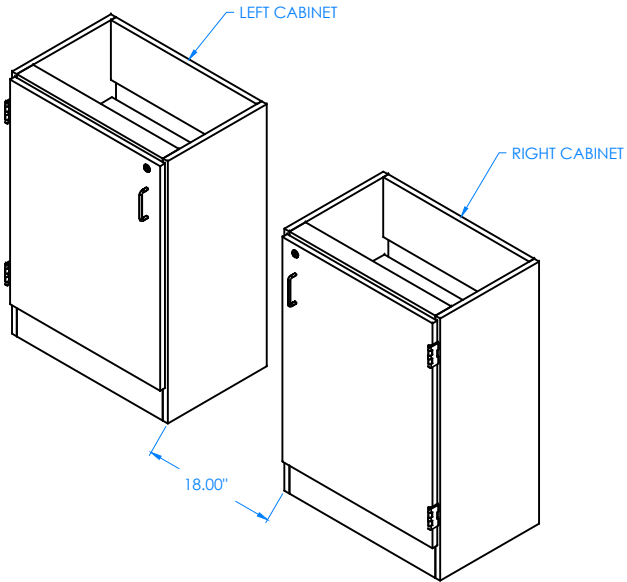

STEP 1:

POSITION THE TWO CABINETS IN DESIRED LOCATION. MAKING SURE DOOR HINGES ARE ON THE OUTSIDE. (IF YOU HAVE A "K" SERIES UNIT, PLACE UNIT OVER UTILITY HOOKUPS). LEAVE ENOUGH ROOM IN BETWEEN CABINETS FOR REMOVABLE PANEL. LEVEL CABINETS AND ATTACH TO FLOOR.

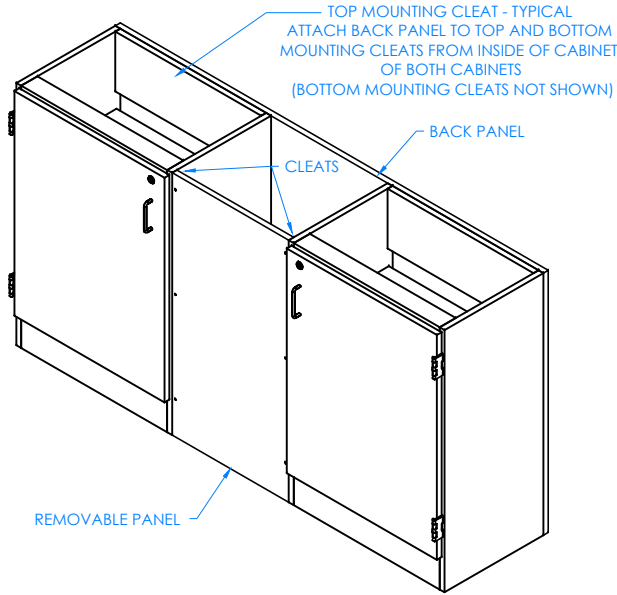

STEP 2:

ATTACH REMOVABLE PANEL WITH THE SCREWS PROVIDED TO THE CLEATS ON SIDES OF LEFT AND RIGHT CABINETS BY DRILLING PILOT HOLES THROUGH CLEATS. POSITION REMOVABLE PANEL SO THAT BOTTOM HOLES ARE MORE THAN 4" ABOVE FLOOR. ATTACH BACK PANEL TO BACK OF CABINETS WITH THE SCREWS PROVIDED INTO MOUNTING CLEATS LOCATED INSIDE ON TOP AND BOTTOM OF BOTH CABINETS.

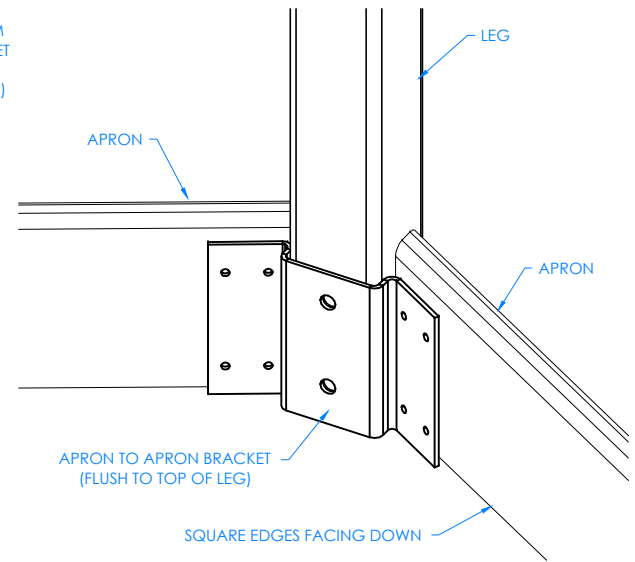

CLOSE UP OF LEG AND APRON TO APRON ASSEMBLY

STEP 3:

LAYOUT WORKSTATION FRAME WITH SQUARE EDGES OF APRONS ON THE FLOOR AND BOTTOM OF LEGS FACING UP. ATTACH THE APRON TO APRON BRACKET ONTO THE LEG WITH THE BOLTS, WASHERS, AND NUTS PROVIDED. MAKING SURE BRACKET IS FLUSH TO TOP OF LEG. TIGHTEN NUTS USING A 1/2" WRENCH OR 1/2" SOCKET AND TORQUE WRENCH, TO A MINIMUM OF 12FT LBS BUT NOT TO EXCEED 17FT LBS. ATTACH THE APRONS TO THE APRON TO APRON BRACKET WITH THE SCREWS PROVIDED.

NOTE:

- 1.

DWN BY:	EMK	DWN DATE:	11/4/16
APR BY:		DATE APR:	
APR BY:		DATE APR:	

UNLESS OTHERWISE SPECIFIED DIMENSION ARE IN INCHES  
 CABINET SQUARENESS ± .0625  
 FRACTIONAL VALUES ± 1/32"  
 - ALL VALUES ± OVERALL -



300 South Krueger Street  
 Suring, WI 54174  
 diversifiedwoodcrafts.com

TITLE:  
**FORWARD VISION II  
 ASSEMBLY INSTRUCTIONS**

A	CREATED DRAWING	11/4/16	EMK	-
REV.	DESCRIPTION	DATE	NAME	ECN NO.
REVISION LEVEL				

THIS DRAWING IS THE SOLE PROPERTY OF DIVERSIFIED WOOD CRAFTS. IT MAY NOT BE ALTERED OR CHANGED WITHOUT PERMISSION

DRAWING NUMBER:	SCALE:	SHEET:	REVISION:
<b>FORWARD VISION II</b>	NTS	4 OF 7	REV A

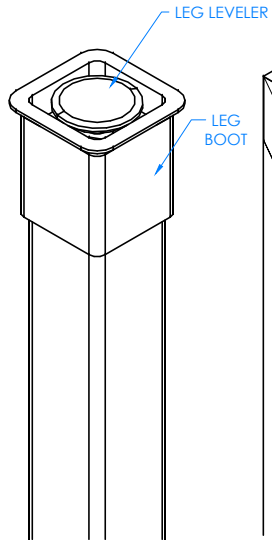

CLOSE UP OF LEG LEVELER AND LEG BOOT ASSEMBLY

STEP 4:

SLIDE LEG BOOT ONTO LEG WITH FLARED END TOWARDS BOTTOM OF LEG. SCREW LEG LEVELER INTO T-NUT ON BOTTOM OF THE LEG. REPEAT FOR ALL LEGS. SET WORKSTATION FRAME ASIDE.

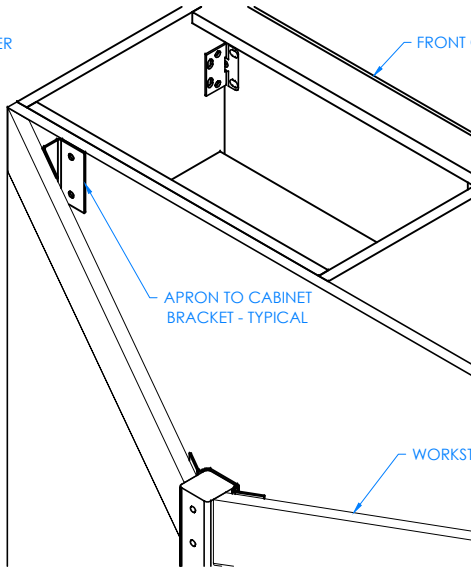

RIGHT SIDE OF WORKSTATION SHOWN

STEP 5:

WITH HELP FROM ANOTHER PERSON, STAND WORKSTATION FRAME UP. POSITION FRAME UP TO CABINET, MAKING SURE APRONS ARE SET IN 1/4" FROM SIDE OF CABINETS. ATTACH APRON TO CABINET BRACKET ONTO APRON WITH REMAINING SCREWS PROVIDED. ATTACH BRACKET ONTO BACK OF WORKSTATION BY GOING INSIDE OF THE CABINETS AND PLACING BOLTS THROUGH THE HOLES PROVIDED IN BACK OF CABINET. INSERT WASHERS, AND NUTS ON OUTSIDE. TIGHTEN NUTS USING A 1/2" WRENCH OR 1/2" SOCKET AND TORQUE WRENCH, TO A MINIMUM OF 12FT LBS BUT NOT TO EXCEED 17FT LBS .

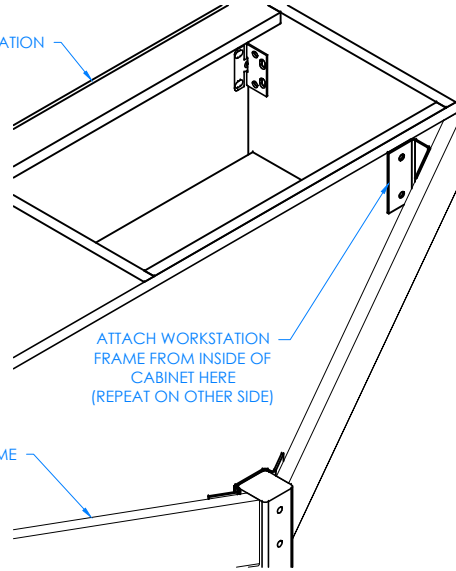

LEFT SIDE OF WORKSTATION SHOWN

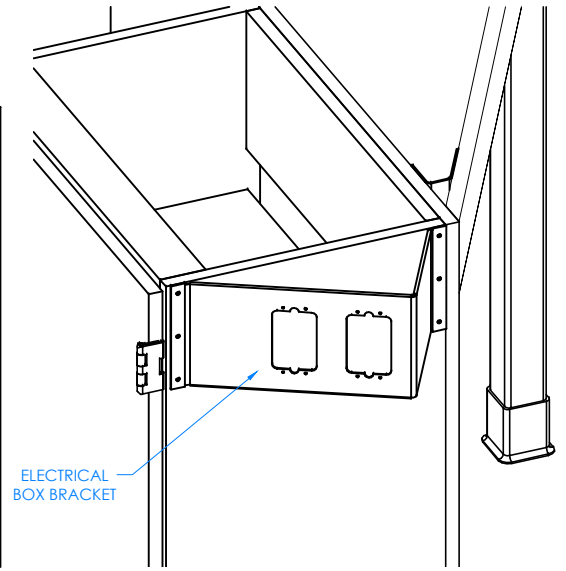

RIGHT SIDE OF RIGHT CABINET SHOWN

STEP 6:

ATTACH ELECTRICAL BOX BRACKET ONTO BOTH SIDES OF UNIT WITH THE SCREWS PROVIDED. ATTACH COAT HOOKS IN DESIRED LOCATION ON BOTH SIDES OF UNIT (NOT SHOWN).

NOTE:

- 1.

DWN BY:	EMK	DWN DATE:	11/4/16
APR BY:		DATE APR:	
APR BY:		DATE APR:	

UNLESS OTHERWISE SPECIFIED DIMENSION ARE IN INCHES  
 CABINET SQUARENESS ± .0625  
 FRACTIONAL VALUES ± 1/32"  
 - ALL VALUES ± OVERALL -



300 South Krueger Street  
 Suring, WI 54174  
 diversifiedwoodcrafts.com

TITLE:  
**FORWARD VISION II  
 ASSEMBLY INSTRUCTIONS**

A	CREATED DRAWING	11/4/16	EMK	-
REV.	DESCRIPTION	DATE	NAME	ECN NO.
REVISION LEVEL				

THIS DRAWING IS THE SOLE PROPERTY OF DIVERSIFIED WOOD CRAFTS. IT MAY NOT BE ALTERED OR CHANGED WITHOUT PERMISSION

DRAWING NUMBER:

**FORWARD VISION II**

SCALE:	SHEET:	REVISION:
NTS	5 OF 7	REV A

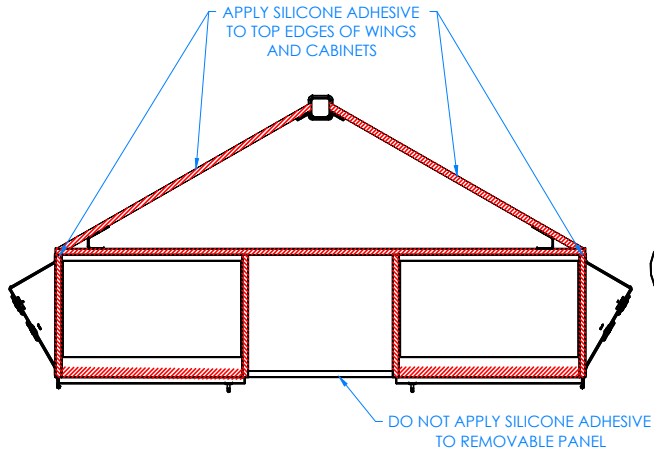

TOP VIEW OF WORKSTATION SHOWN

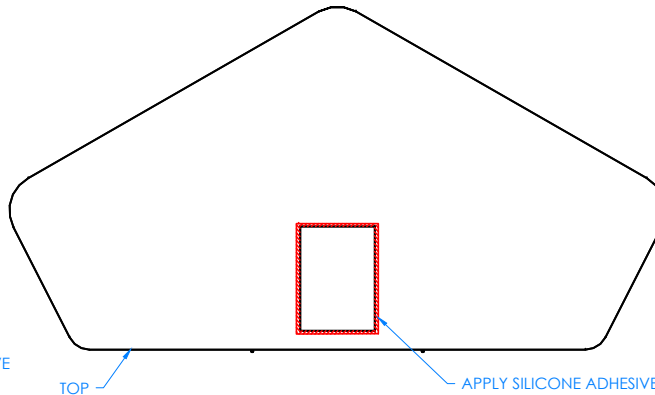

TOP VIEW OF WORKSTATION SHOWN

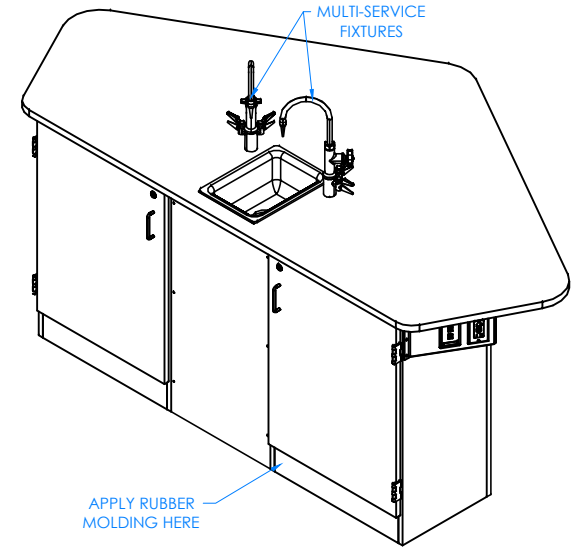

COMPLETE UNIT SHOWN

STEP 7:

ADJUST LEG LEVELERS TO LEVEL THE WORKSTATION FRAME WITH CABINETS. APPLY SILICONE ADHESIVE TO TOP EDGES OF CABINET AND WINGS. PLACE TOP ON UNIT WITH PROPER OVERHANG (CENTERED ON WORKSTATION). CLAMP ON TOP TO WINGS TO REMOVE ANY WARP USING SHIMS AND C-CLAMPS, IF NEEDED, WHEN ALIGNING THE TOP (DO THIS BEFORE ADHESIVE ON EDGES SETS UP). LET CURE FOR 6-12 HOURS. DO NOT APPLY SILICONE ADHESIVE TO REMOVABLE PANEL.

STEP 8:

IF YOU DO NOT HAVE A 2944K UNIT, SKIP TO STEP 9. APPLY SILICONE ADHESIVE TO THE SINK OPENING ON TOP. LOWER SINK INTO OPENING. WIPE OFF ANY EXCESS CAULK AND ALLOW TO SET. LET CURE FOR 6-12 HOURS.

STEP 9:

ATTACH RUBBER MOLDING TO BASE OF WORKSTATION USING CONTACT CEMENT. AFTER MOLDING IS IN PLACE, SCREW STAINLESS STEEL CORNER BRACKETS ON EACH CORNER OVER BASE MOLDING WITH THE SCREWS PROVIDED. IF YOU HAVE A 2944K UNIT, INSTALL MULTI-SERVICE FIXTURES IN THE HOLES PROVIDED ON TOP.

NOTE:

1. ALL WATER, ELECTRICAL, AND GAS CONNECTIONS SHOULD BE PERFORMED BY A TRAINED PROFESSIONAL PER LOCAL CODE.

DWN BY:	EMK	DWN DATE:	11/4/16
APR BY:		DATE APR:	
APR BY:		DATE APR:	

UNLESS OTHERWISE SPECIFIED DIMENSION ARE IN INCHES  
 CABINET SQUARENESS ± .0625  
 FRACTIONAL VALUES ± 1/32"  
 - ALL VALUES ± OVERALL -



300 South Krueger Street  
 Suring, WI 54174  
 diversifiedwoodcrafts.com

TITLE:  
**FORWARD VISION II  
 ASSEMBLY INSTRUCTIONS**

REV.	DESCRIPTION	DATE	NAME	ECN NO.
A	CREATED DRAWING	11/4/16	EMK	-
REVISION LEVEL				

THIS DRAWING IS THE SOLE PROPERTY OF DIVERSIFIED WOOD CRAFTS. IT MAY NOT BE ALTERED OR CHANGED WITHOUT PERMISSION

DRAWING NUMBER:	SCALE:	SHEET:	REVISION:
<b>FORWARD VISION II</b>	NTS	6 OF 7	REV A

## **TROUBLESHOOTING YOUR GFCI ELECTRICAL RECEPTACLE:**

**PLEASE NOTE: THROUGHOUT ANY OF THE FOLLOWING STEPS (PROCEDURES); IF YOU ARE NOT SURE YOU CAN DO THIS JOB SAFELY, AND COMPETENTLY, REFER THIS WORK TO QUALIFIED PROFESSIONAL!**

**If your unit comes equipped with a GFCI (Ground Fault Circuit Interrupter) electrical receptacle, and there is no power in the receptacle please consider/check the following:**

- The extension cord (if being used) is working properly.
- The breaker hasn't been tripped, or turned off.

This type of GFCI has two testing-related buttons on it. One button is appropriately labeled "TEST", and the other button is labeled "RESET". To test the GFCI receptacle follow these steps:

- Plug in an appliance (lamp or night light) into the outlet. The light should now be on. Then press the "TEST" button on the GFCI. The GFCI "RESET" button should pop out, and the light should go out.
- If the "RESET" button pops out, but the light doesn't go out, the GFCI has been improperly wired. In this case please contact a certified professional. There may also be a problem with other wiring in the same circuit.
- If the "RESET" button doesn't pop out, the GFCI is defective, or malfunctioned, and should be replaced.
- If the GFCI is functioning properly, and the lamp goes out, press the "RESET" button to restore power to the outlet.

Conversely, if you have a GFI that has tripped (which is common) and it will not reset, you may have a wiring short in the circuit, a defective appliance on the circuit, or the GFI itself has become defective. To test a tripping GFCI follow these steps:

- Remove every appliance connected to the GFCI's circuit and reset it. If it doesn't reset there may either be a wiring fault behind a socket outlet, or your GFCI itself has become faulty.
- Make sure whatever you are plugging into to the GFCI is dry and not damaged.
- Only plug in one item at a time. If you are plugging in a defective item it will cause the GFCI to trip, and that item therefore should be replaced.

If you are still having difficulty the easiest way to troubleshoot a GFI is to obtain a GFI tester, which is available at most hardware stores. It plugs into the GFI outlet, and will supply you with a "snapshot" of your connections, indicating wiring problems and/or the condition of the GFI. Another way to troubleshoot is to simply purchase a new GFI and install it.