

# KIDNEY-SHAPED POLYMER LAZY SUSANS

## Installation Instructions

*Inspect all parts and read all instructions prior to beginning assembly and installation.*

### Parts Included

- |                                  |                               |
|----------------------------------|-------------------------------|
| A. (2) Shelves                   | F. (8) #8 x 1/2" Screws       |
| B. (1) Telescopic Post           | G. (2) Shelf Clips            |
| C. (2) Universal Mounting Plates | H. (1) Installation Template  |
| D. (2) Bearing Hubs              | I. (1) Care Instruction Sheet |
| E. (2) Bearing Pins              |                               |

**Step 1** Use installation template to mark and drill 1/16" pilot holes for Universal Mounting Plates (C) in top and bottom interior of cabinet.

**Step 2** Fasten each of the Universal Mounting Plates (C) with (2) #8 x 1/2" Screws (F) using the slots so that future adjustment can be made, if necessary.

**Step 3** Insert Bearing Hubs (D) into the underside of each of the Shelves (A). Note that the keyway on the side of the Bearing Hub must be aligned with the key on the inside of the Shelf.

**Step 4** Slide the Shelves onto the lower portion of the Telescopic Post (B) from the bottom (slotted side).

**Step 5** Place the assembly into the cabinet. Align the bottom of the Telescopic Post over the top of the bottom Universal Mounting Plate making sure that the slot in the Post fits over the lug in the Mounting Plate. Push a Bearing Pin (E) through the slot in the pole and the hole in the Mounting Plate. Slide the Bottom Shelf down onto the pin.

**Step 6** Loosen the set screw that holds the upper portion of the Telescopic Post enough to allow the upper portion to move. Slide the upper portion up onto the top Universal Mounting Plate so that it is engaged securely. Tighten the set screw to hold the upper and lower portions of the post together securely.

**Step 7** Insert second Bearing Pin into one of the Post's upper holes to give desired shelf separation. Slide Top Shelf down over it. To ensure shelves remain in place during shipment of cabinet (if needed), push the Shelf Clip (G) into the post hole immediately above each shelf. If cabinet is already installed, the Shelf Clips are not needed and may be disposed of.

**Step 8** Check the alignment of the Shelves with the cabinet door opening by rotating the Shelves so that the detents (notches) on the Bearing Hubs engage the Bearing Pins to stop the Shelves. If the Universal Mounting Plates were installed correctly using the template, the Shelves should be perfectly aligned with the cabinet door opening. Should additional adjustment be needed, loosen the Screws holding the Mounting Plates just enough to allow rotation of the entire unit. Rotate the unit until the Shelves are in alignment with the cabinet opening, and tighten the Screws. Add remaining #8 x 1/2" Screws to the round holes in the Mounting Plates to complete the installation.

Your installation is complete! Affix the enclosed "Care Instructions" to an inside wall of the cabinet for future reference.

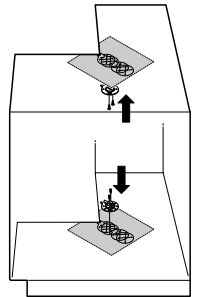

steps 1 & 2

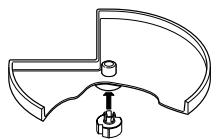

step 3

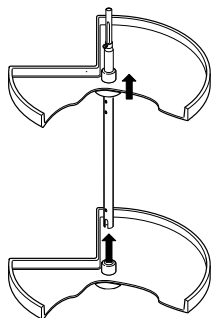

step 4

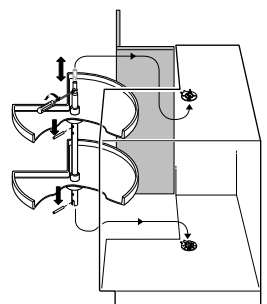

steps 5, 6 & 7

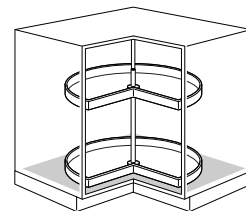

step 8

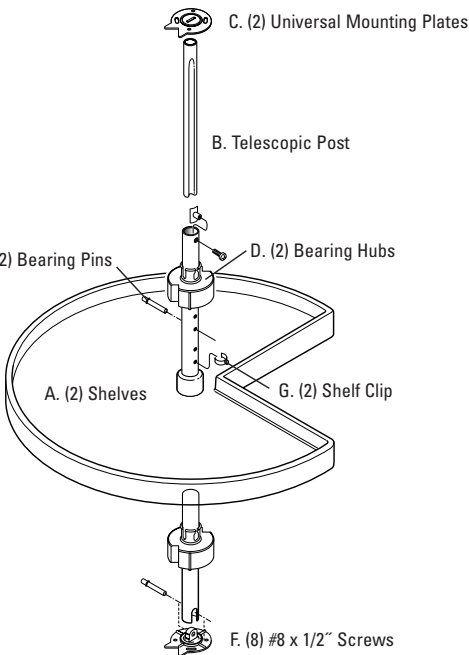
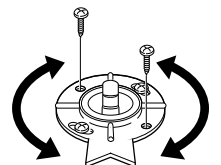

### Tools Required

- Phillips head Screwdriver
- Drill with 1/16" (1.5mm) bit for drilling pilot holes
- Tape measure or ruler
- Pencil

### Product Assemblies

- |       |       |                 |
|-------|-------|-----------------|
| PKN18 | PKN28 | P-KS-24-S-T-R-W |
| PKN24 | PKN32 | P-KS-28-S-T-R-W |



**Real Solutions**  
For Real Life.™

KNAPE & VOGT MANUFACTURING COMPANY

P.O. Box 191, Muncie, IN 47308

0.899.6535 • 765.288.8730 • Fax 765.288.0851 • www.kv.com