



## Furniture Levelers

- Perfect for entertainment units and built-in shelving units
- One-person leveling
- No need to lift the weight of furniture in order to adjust because it's accessible with hex key or screwdriver
- Higher weight capacity than conventional levelers
- Sturdy levelers won't bend when moving furniture

### 12mm Heavy Duty Metal Concealed Levelers

- Easy height adjustments with a #4 hex key or screwdriver
- Up to 1" height adjustment (11/16" on 306-03-12)
- One-person leveling
- 660 lbs. weight capacity
- Sturdy metal levelers won't bend when moving furniture
- 12mm drill bit available
- 100 per box

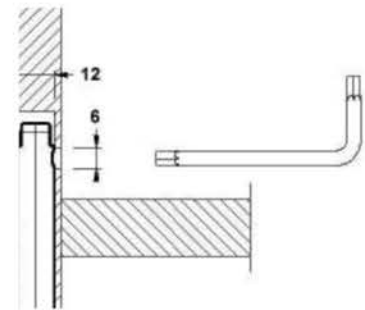

Use the template to drill the placement hole.



Drill the adjustment hole.



Insert 12mm Concealed Leveler into placement hole.



Adjust as needed through adjustment hole.

DESCRIPTION	ITEM NO.	'A' HEIGHT
12mm Concealed Leveler	306-03-12	1 1/4" (32mm)
12mm Concealed Leveler	306-05-12	2" (52mm)
12mm Concealed Leveler	306-07-12	2 7/8" (72mm)
12mm Concealed Leveler	306-10-12	4" (100mm)
12mm Concealed Leveler	306-12-12	4 3/4" (120mm)
Polybag, 4 pieces 306-05-12 with 1 hex key	400-05-12	2" (52mm)
Polybag, 4 pieces 306-10-12 with 1 hex key	400-10-12	4" (100mm)
Hex Key	306AK	
Drill Template	306-MA-12	
Screwdriver	306SD	
Drill Bit - 12mm	BIT-12	

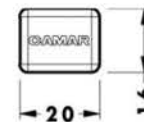

306AK



306SD

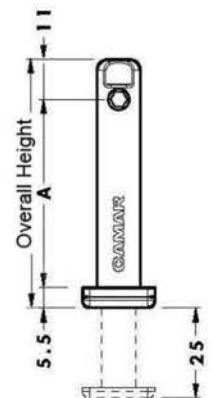

'A' Dimension will change with the height of the leveler - see chart.

\*10 Hex Keys are included in package of 100 levelers.