

BIT HOLDERS

9/32" 130-A YANKEE TYPE FOR 1/4" HEX INSERTS



| Part Number | Overall Length | |
|-------------|----------------|-----|
| | IN. | MM. |
| 450 | 21/4 | 57 |
| M-450 | 33/8 | 86 |

5/16" 131-A YANKEE TYPE FOR 1/4" HEX INSERTS



| Part Number | Overall Length | |
|-------------|----------------|-----|
| | IN. | MM. |
| 460 | 21/4 | 57 |
| M-460 | 33/8 | 86 |

7/32" 135-A YANKEE TYPE FOR 1/4" HEX INSERTS



| Part Number | Overall Length | |
|-------------|----------------|-----|
| | IN. | MM. |
| M-470 | 33/8 | 86 |

1/4"-24 SCREW SHANK FOR 1/4" HEX INSERTS



| Part Number | Overall Length | |
|-------------|----------------|-----|
| | IN. | MM. |
| 400-BH | 11/8 | 29 |

FEMALE SQUARE DRIVE

1/4" FEMALE SQUARE DRIVE



| Part Number | Overall Length | | Notes |
|-------------|----------------|-----|--------------------------------|
| | IN. | MM. | |
| 825 | 1 | 25 | For 1/4" Hex Inserts |
| M-825 | 29/32 | 58 | For 1/4" Hex Inserts; Magnetic |
| 820 | 23/32 | 18 | For 1/4" Square Inserts |

3/8" FEMALE SQUARE DRIVE



| Part Number | Overall Length | | Notes |
|-------------|----------------|-----|---------------------------------|
| | IN. | MM. | |
| 830 | 11/2 | 38 | For 5/16" Square Inserts |
| 835 | 11/2 | 38 | For 5/16" Hex Inserts |
| 838 | 11/2 | 38 | For 1/4" Hex Inserts |
| M-838 | 223/32 | 69 | For 1/4" Hex Inserts, Magnetic |
| M-835 | 23/4 | 70 | For 5/16" Hex Inserts, Magnetic |

1/2" FEMALE SQUARE DRIVE



| Part Number | Overall Length | | Notes |
|-------------|----------------|-----|---------------------------------|
| | IN. | MM. | |
| 850 | 13/4 | 45 | For 5/16" Square Inserts |
| 855 | 13/4 | 45 | For 5/16" Hex Inserts |
| 858 | 13/4 | 45 | For 1/4" Hex Inserts |
| M-855 | 23/4 | 70 | For 5/16" Hex Inserts, Magnetic |
| M-858 | 23/4 | 70 | For 1/4" Hex Inserts, Magnetic |

BIT HOLDERS/ ADAPTERS WITH SET SCREW OR THRU HOLE

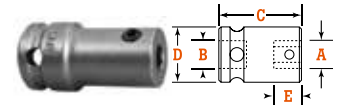

| Set Screw Lock | Part Number | | Hex Opening (A) IN. | Square Drive (B) IN. | Overall Length (C) IN. | Overall Length (C) MM. | Body Dia. (D) IN. | Body Dia. (D) MM. | Opening Depth (E) | |
|----------------|---------------------|-----------------|---------------------|----------------------|------------------------|------------------------|-------------------|-------------------|-------------------|-----|
| | Spring Pin Retainer | Spring Pin Only | | | | | | | IN. | MM. |
| | - | - | 1/4 | 1/4 | 11/4 | 32 | 3/4 | 19 | 5/8 | 16 |
| | - | - | 1/4 | 3/8 | 11/2 | 38 | 3/4 | 19 | 5/8 | 16 |
| | - | - | 1/4 | 1/2 | 11/2 | 38 | 7/8 | 22 | 5/8 | 16 |
| | - | - | 7/16 | 1/4 | 1 | 25 | 3/4 | 19 | 17/32 | 13 |
| | RP-314 | 21-S-156-0750 | 7/16 | 3/8 | 13/8 | 35 | 3/4 | 19 | 17/32 | 13 |
| | RP-514 | 21-S-156-0937 | 7/16 | 1/2 | 15/8 | 41 | 15/16 | 24 | 17/32 | 13 |
| | RP-614 | 21-S-156-0375 | 7/16 | 5/8 | 13/4 | 46 | 11/4 | 32 | 17/32 | 13 |
| | RP-520 | 21-S-187-1125 | 5/8 | 1/2 | 11/2 | 38 | 11/8 | 29 | 11/16 | 17 |
| | RP-620 | 21-S-187-1250 | 5/8 | 5/8 | 11/2 | 38 | 11/4 | 32 | 11/16 | 17 |
| | RP-720 | 21-S-187-1500 | 5/8 | 3/4 | 111/16 | 43 | 11/2 | 38 | 11/16 | 17 |
| | RP-820 | 21-S-187-1375 | 5/8 | 1 | 21/8 | 54 | 21/8 | 54 | 11/16 | 17 |
| | RP-724 | 21-S-187-1500 | 3/4 | 3/4 | 2 | 51 | 15/8 | 42 | 7/8 | 22 |
| | RP-728 | 21-S-187-1625 | 7/8 | 3/4 | 2 | 51 | 15/8 | 42 | 57/64 | 23 |
| | RP-828 | 21-S-187-1625 | 7/8 | 1 | 21/8 | 54 | 21/8 | 54 | 5/8 | 23 |