

PLUS®
HIGH EFFICIENCY PRESSURE FEED GUN



Anodized Finish

| Order No. | Model No. | Air Cap | Fluid Tip (mm) | Inlet Pressure | Application | Fluid Flow |
|-----------|--------------|-----------|----------------|----------------|-------------|---------------|
| 110272 | PLUS-514P-12 | #414 (HE) | 1.2 | 60-65 PSI | High solids | 7-14 oz./min. |

PLUS® Pressure Feed High Efficiency Air Caps

| | | | |
|--------------------------|----------------------------|------------|-------------------------------|
| #414 air cap (HE) | High solids | | Air Cap Pattern 11-14" |
| | Air Cap Order No. | 192312 | |
| | Air Cap Model No. | AV-440-414 | |
| | 60-65 PSI inlet | 19-22 CFM | |
| | Fluid tip 1.2mm | | |
| Fluid Tips | 1.0mm, 1.2mm, 1.3mm, 1.4mm | | |

Refer to Service Bulletin: SB-2-475

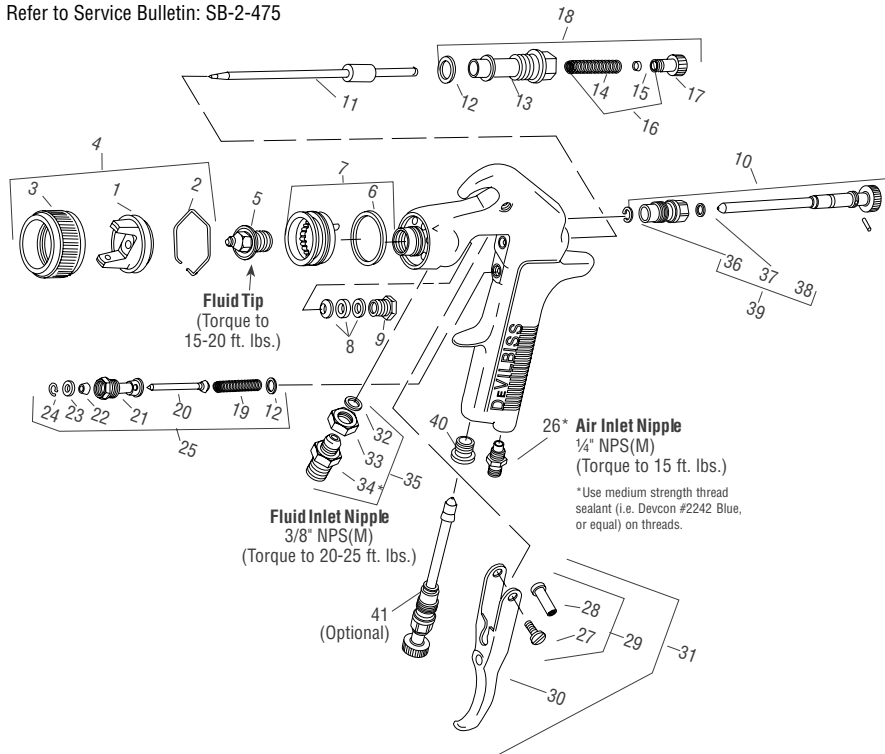

CHART 1: Air Cap

| No. on Air Cap | Air Cap Order No. | Air Cap Model No. |
|----------------|-------------------|-------------------|
| 410 | 192174 | AV-440-410 |
| 414 | 192312 | AV-440-414 |

CHART 2: Fluid Tips and Needles

| Tip Size (mm) | Fluid Tip (Ref. No. 5) | Suction Feed Fluid Needle (Ref. No. 11) | Pressure Feed Fluid Needle (Ref. No. 11) |
|---------------|------------------------|---|--|
| 1.0 | AV-213-10 | NR | GTI-449-12 |
| 1.2 | AV-213-12 | NR | GTI-449-12 |
| 1.4 | AV-213-14 | GTI-413 | GTI-449-12 |
| 1.6 | AV-213-16 | GTI-413 | NR |
| 1.8 | AV-213-18 | GTI-413 | NR |

NR = Not Recommended

●192227 (KK-5058-2) Gun Repair Kit includes a quantity of necessary parts.

| Ref. No. | Order No. | Model No. | Description | Ind. Parts Req. |
|----------|-----------|---------------|-----------------------------------|-----------------|
| 1 | — | — | Air Cap | 1 |
| 2 | 191972 | JGA-156-K10 | Spring Clip (Kit of 10) | 1 |
| 3 | 192042 | GTI-3 | Air Cap Retaining Ring | 1 |
| 4 | — | See Chart 1 | Air Cap and Retaining Ring | 1 |
| 5 | — | See Chart 2 | Fluid Tip | 1 |
| ●6 | 192179 | GTI-33-K5 | Baffle Seal (Kit of 5) | 1 |
| 7 | 192178 | GTI-425 | Baffle Assembly | 1 |
| ●8 | 192109 | JGA-4035-K5 | Packing (Kit of 5) | 1 |
| 9 | 190893 | 34411-122-K10 | Packing Nut | 1 |
| 10 | 192051 | GTI-405 | Spreader Valve | 1 |
| 11 | — | See Chart 2 | Fluid Needle | 1 |
| ●12 | 190161 | JGS-72-K10 | Gasket Kit (PTFE) (Kit of 10) | 2 |
| 13 | — | — | Body Bushing | 1 |
| ●14 | — | — | Fluid Needle Spring | 1 |
| ●15 | — | — | Spring Pad | 1 |
| 16 | 190894 | MBD-19-K10 | Spring and Pad (Kit of 10) | 1 |
| 17 | 192043 | GTI-414 | Needle Adjusting Screw | 1 |
| 18 | 192139 | KK-5059 | Bushing, Spring, Pad and Knob Kit | 1 |
| ●19 | — | — | Air Valve Spring | 1 |
| ●20 | — | — | Air Valve | 1 |
| 21 | — | — | Air Valve Body | 1 |
| ●22 | — | — | U Cup Seal | 1 |
| ●23 | — | — | Washer | 1 |
| ●24 | — | — | Snap Ring | 1 |
| 25 | 190780 | JGS-449-1 | Air Valve Assembly | 1 |
| 26 | 190287 | P-MB-51 | Air Inlet Nipple 1/4" NPS(M) | 1 |
| 27 | — | — | Trigger Stud Screw | 1 |
| 28 | — | — | Trigger Stud | 1 |
| 29 | 190889 | JGS-478 | Stud and Screw Kit | 1 |
| 30 | — | — | Trigger | 1 |
| 31 | 191943 | JGS-477-1 | Trigger Stud, Screw Kit | 1 |
| ●32 | — | — | Fluid Inlet Gasket (PTFE) | 1 |
| 33 | — | — | Locknut | 1 |
| 34 | — | — | Fluid Inlet Adapter | 1 |
| 35 | 190888 | JGA-4042 | Fluid Inlet, Gasket, Nut Kit | 1 |
| ●36 | — | — | Retaining Clip | 1 |
| ●37 | — | — | Seal | 1 |
| ●38 | — | — | Pin | 1 |
| 39 | 192229 | GTI-428-K5 | Clip, Seal & Pin (Kit of 5 Each) | 1 |
| 40 | 190828 | JGA-132 | Plug | 1 |
| 41 | 192228 | GTI-415 | Air Adjusting Valve (Optional) | 1 |