



No. 103RA Reducing Adapter Set - Sleeve Type - Low Profile

These adapters reduce larger drive sizes down for use on smaller drive tools. The low profile design allows for use in a wide range of applications. A magnetic retention device keeps the adapter attached to the socket. Adapters can be stacked if additional drive reduction is needed. Designed for impact or hand tool use.



3 piece set contents:

1 ea: 938RA, 1138RA and 2238RA

Three piece set is conveniently packaged in a blister pack.

Individual Reducing Adapters - Sleeve Type - Low Profile



Item Number	Female End Size	Male End Size
938RA	1/4"	3/8"
912RA	1/4"	1/2"
1138RA	3/8"	1/2"
2238RA	1/2"	3/4"
3009RA	3/4"	1"
4009RA	1"	1-1/2"
6009RA	1-1/2"	2-1/2"

Impact Wrench Quick Change Adapters

These adapters provide a "quick change" mechanism by the use of a sliding collar and positive retention ball for fast change of a socket on the end of the tool anvil. Works with Impact tool anvils that have a clip retention device or pin hole. A pin hole type anvil and use of a pin and retaining o-ring recommended to secure this adapter to the anvil.

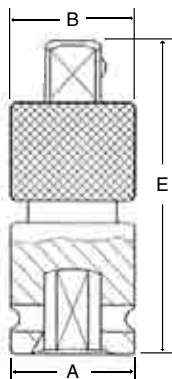

Item Number	Description	Dimensions (Inches)		
		A	B	E
930QC	1/4" Drive Quick Change Adapter	.51	.53	1.38
1130QC	3/8" Drive Quick Change Adapter	.79	.81	1.82
2230QC	1/2" Drive Quick Change Adapter	.98	1.00	2.38
3030QC	3/4" Drive Quick Change Adapter	1.74	1.76	3.18
4030QC	1" Drive Quick Change Adapter	2.13	2.15	3.95

Specials

