



# 1/4" Drive Impact Socket Set



1/4"

6s

No. 9772

1/4" Drive Master Set



This set contains the most popular sockets in our 1/4" surface drive line, plus 3 extensions, universal joint, 1/4" to 3/8" adapter and 1/4" Hex to 1/4" Square Adapter. Packaged in an all new compact, low profile molded storage case. This set is great for use on impact wrenches, air ratchets as well as hand ratchets.



### 72 piece set contents:

#### 10 Pieces Standard Length:

3/16", 7/32", 1/4", 9/32", 5/16", 11/32", 3/8", 7/16", 1/2", 9/16"

#### 10 Pieces Deep Length:

3/16", 7/32", 1/4", 9/32", 5/16", 11/32", 3/8", 7/16", 1/2", 9/16"

#### 14 Pieces Metric Standard Length:

4mm, 4.5mm, 5mm, 5.5mm, 6mm, 7mm, 8mm, 9mm, 10mm, 11mm, 12mm, 13mm, 14mm, 15mm

#### 14 Pieces Metric Deep Length:

4mm, 4.5mm, 5mm, 5.5mm, 6mm, 7mm, 8mm, 9mm, 10mm, 11mm, 12mm, 13mm, 14mm, 15mm

#### 6 Pieces Standard Universal:

1/4", 5/16", 3/8", 7/16", 1/2", 9/16"

#### 12 Pieces Metric Standard Universal:

5mm, 5.5mm, 6mm, 7mm, 8mm, 9mm, 10mm, 11mm, 12mm, 13mm, 14mm, 15mm

#### 1 Piece Each:

2", 4", & 6" Extensions  
1/4" Universal Joint  
1/4" F. x 3/8" M. Adapter  
1/4" Hex x 1/4" Square Adapter

Molded Storage Case





# 1/2" Drive Standard Length Impact Sockets



## 6 1/2" Drive - Standard Length - Fractional Sizes SAE



ANSI Specifications B107.2

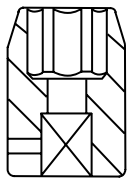

SHAPE I

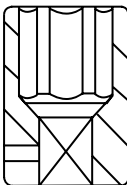

SHAPE II

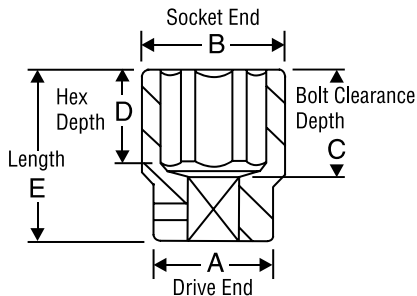

SHAPE III

| Item Number | Hex Size | Shape | Dimensions (Inches) |      |      |      |      |
|-------------|----------|-------|---------------------|------|------|------|------|
|             |          |       | A                   | B    | C    | D    | E    |
| 2010R       | 5/16"    | I     | .87                 | .59  | .83  | .35  | 1.50 |
| 2012R       | 3/8"     | I     | .87                 | .63  | .83  | .47  | 1.50 |
| 2014R       | 7/16"    | I     | .87                 | .71  | .83  | .47  | 1.50 |
| 2016R       | 1/2"     | I     | .87                 | .79  | .83  | .47  | 1.50 |
| 2018R       | 9/16"    | I     | .94                 | .87  | .83  | .47  | 1.50 |
| 2020R       | 5/8"     | II    | .98                 | .98  | .83  | .47  | 1.50 |
| 2022R       | 11/16"   | II    | 1.02                | 1.02 | .83  | .51  | 1.50 |
| 2024R       | 3/4"     | II    | 1.10                | 1.10 | .83  | .51  | 1.50 |
| 2026R       | 13/16"   | II    | 1.18                | 1.18 | .83  | .55  | 1.50 |
| 2028R       | 7/8"     | II    | 1.26                | 1.26 | .83  | .59  | 1.50 |
| 2030R       | 15/16"   | II    | 1.34                | 1.34 | .83  | .59  | 1.50 |
| 2032R       | 1"       | II    | 1.42                | 1.42 | .83  | .59  | 1.50 |
| 2034R       | 1-1/16"  | II    | 1.50                | 1.50 | .91  | .67  | 1.57 |
| 2036R       | 1-1/8"   | III   | 1.50                | 1.57 | .91  | .67  | 1.57 |
| 2038R       | 1-3/16"  | III   | 1.50                | 1.65 | .91  | .67  | 1.57 |
| 2040R       | 1-1/4"   | III   | 1.50                | 1.73 | .91  | .67  | 1.57 |
| 2042R       | 1-5/16"  | III   | 1.50                | 1.77 | 1.02 | .75  | 1.69 |
| 2044R       | 1-3/8"   | III   | 1.50                | 1.91 | 1.30 | .94  | 1.97 |
| 2046R       | 1-7/16"  | III   | 1.50                | 1.99 | 1.30 | .94  | 1.97 |
| 2048R       | 1-1/2"   | III   | 1.50                | 2.07 | 1.30 | .94  | 1.97 |
| 2050R       | 1-9/16"  | III   | 1.73                | 2.20 | 1.69 | .94  | 2.36 |
| 2052R       | 1-5/8"   | III   | 1.73                | 2.30 | 1.69 | 1.06 | 2.36 |
| 2054R       | 1-11/16" | III   | 1.73                | 2.40 | 1.69 | 1.06 | 2.36 |
| 2056R       | 1-3/4"   | III   | 1.73                | 2.48 | 1.69 | 1.06 | 2.36 |
| 2058R       | 1-13/16" | III   | 1.73                | 2.56 | 2.09 | 1.18 | 2.76 |
| 2060R       | 1-7/8"   | III   | 1.73                | 2.66 | 2.09 | 1.18 | 2.76 |
| 2062R       | 1-15/16" | III   | 1.73                | 2.72 | 2.09 | 1.18 | 2.76 |
| 2064R       | 2"       | III   | 2.05                | 2.80 | 2.09 | 1.26 | 2.76 |
| 2066R       | 2-1/16"  | III   | 2.05                | 2.85 | 2.09 | 1.26 | 2.76 |
| 2068R       | 2-1/8"   | III   | 2.05                | 2.95 | 2.09 | 1.26 | 2.76 |
| 2070R       | 2-3/16"  | III   | 2.05                | 3.01 | 2.09 | 1.38 | 2.76 |
| 2072R       | 2-1/4"   | III   | 2.05                | 3.07 | 2.09 | 1.38 | 2.76 |

## 6 Standard Length - Metric Sizes MM

| Item Number | Hex Size | Shape | Dimensions (Millimeters) |      |    |    |    |
|-------------|----------|-------|--------------------------|------|----|----|----|
|             |          |       | A                        | B    | C  | D  | E  |
| 2008M       | 8mm      | I     | 22                       | 15.0 | 21 | 9  | 38 |
| 2009M       | 9mm      | I     | 22                       | 15.0 | 21 | 12 | 38 |
| 2010M       | 10mm     | I     | 22                       | 17.0 | 21 | 12 | 38 |
| 2011M       | 11mm     | I     | 22                       | 19.0 | 21 | 12 | 38 |
| 2012M       | 12mm     | I     | 22                       | 19.0 | 21 | 12 | 38 |
| 2013M       | 13mm     | I     | 24                       | 20.0 | 21 | 12 | 38 |
| 2014M       | 14mm     | I     | 24                       | 22.0 | 21 | 12 | 38 |
| 2015M       | 15mm     | I     | 25                       | 23.0 | 21 | 12 | 38 |
| 2016M       | 16mm     | II    | 25                       | 25.0 | 21 | 12 | 38 |
| 2017M       | 17mm     | II    | 26                       | 26.0 | 21 | 13 | 38 |
| 2018M       | 18mm     | II    | 26                       | 26.0 | 21 | 13 | 38 |
| 2019M       | 19mm     | II    | 28                       | 28.0 | 21 | 13 | 38 |
| 2020M       | 20mm     | II    | 30                       | 30.0 | 21 | 13 | 38 |
| 2021M       | 21mm     | II    | 30                       | 30.0 | 21 | 13 | 38 |
| 2022M       | 22mm     | II    | 32                       | 32.0 | 21 | 13 | 38 |
| 2023M       | 23mm     | II    | 32                       | 32.0 | 21 | 13 | 38 |
| 2024M       | 24mm     | II    | 34                       | 34.0 | 21 | 13 | 38 |
| 2025M       | 25mm     | II    | 36                       | 36.0 | 21 | 14 | 38 |
| 2026M       | 26mm     | II    | 36                       | 36.0 | 21 | 14 | 38 |
| 2027M       | 27mm     | II    | 38                       | 38.0 | 23 | 17 | 40 |
| 2028M       | 28mm     | III   | 38                       | 40.0 | 23 | 17 | 40 |
| 2029M       | 29mm     | III   | 38                       | 40.0 | 23 | 17 | 40 |
| 2030M       | 30mm     | III   | 38                       | 42.0 | 23 | 17 | 40 |
| 2032M       | 32mm     | III   | 38                       | 44.0 | 23 | 17 | 40 |
| 2033M       | 33mm     | III   | 38                       | 45.0 | 26 | 19 | 43 |
| 2034M       | 34mm     | III   | 38                       | 46.0 | 33 | 24 | 50 |
| 2035M       | 35mm     | III   | 38                       | 48.5 | 33 | 24 | 50 |
| 2036M       | 36mm     | III   | 38                       | 48.5 | 33 | 24 | 50 |