



# 1/4" Drive Impact Socket Set



1/4"

6s

No. 9772

1/4" Drive Master Set



This set contains the most popular sockets in our 1/4" surface drive line, plus 3 extensions, universal joint, 1/4" to 3/8" adapter and 1/4" Hex to 1/4" Square Adapter. Packaged in an all new compact, low profile molded storage case. This set is great for use on impact wrenches, air ratchets as well as hand ratchets.



### 72 piece set contents:

#### 10 Pieces Standard Length:

3/16", 7/32", 1/4", 9/32", 5/16", 11/32", 3/8", 7/16", 1/2", 9/16"

#### 10 Pieces Deep Length:

3/16", 7/32", 1/4", 9/32", 5/16", 11/32", 3/8", 7/16", 1/2", 9/16"

#### 14 Pieces Metric Standard Length:

4mm, 4.5mm, 5mm, 5.5mm, 6mm, 7mm, 8mm, 9mm, 10mm, 11mm, 12mm, 13mm, 14mm, 15mm

#### 14 Pieces Metric Deep Length:

4mm, 4.5mm, 5mm, 5.5mm, 6mm, 7mm, 8mm, 9mm, 10mm, 11mm, 12mm, 13mm, 14mm, 15mm

#### 6 Pieces Standard Universal:

1/4", 5/16", 3/8", 7/16", 1/2", 9/16"

#### 12 Pieces Metric Standard Universal:

5mm, 5.5mm, 6mm, 7mm, 8mm, 9mm, 10mm, 11mm, 12mm, 13mm, 14mm, 15mm

#### 1 Piece Each:

2", 4", & 6" Extensions  
1/4" Universal Joint  
1/4" F. x 3/8" M. Adapter  
1/4" Hex x 1/4" Square Adapter

Molded Storage Case



# 1/2" Drive Standard Length Universal Impact Sockets



## 6 1/2" Drive - Standard Length Universal - Fractional Sizes SAE



1/2"

Item Number	Hex Size	Dimensions (Inches)				
		A	B	C	D	E
<b>2012U</b>	<b>3/8"</b>	1.10	.59	.63	.51	2.56
<b>2014U</b>	<b>7/16"</b>	1.10	.67	.63	.51	2.56
<b>2016U</b>	<b>1/2"</b>	1.10	.75	.63	.51	2.56
<b>2018U</b>	<b>9/16"</b>	1.10	.87	.63	.51	2.56
<b>2020U</b>	<b>5/8"</b>	1.10	.91	.63	.51	2.56
<b>2022U</b>	<b>11/16"</b>	1.26	1.02	.63	.51	2.56
<b>2024U</b>	<b>3/4"</b>	1.26	1.10	.63	.51	2.56
<b>2026U</b>	<b>13/16"</b>	1.26	1.18	.63	.51	2.56
<b>2028U</b>	<b>7/8"</b>	1.26	1.26	.63	.51	2.56
<b>2030U</b>	<b>15/16"</b>	1.26	1.34	.63	.51	2.56
<b>2032U</b>	<b>1"</b>	1.26	1.42	.63	.51	2.56
<b>2034U</b>	<b>1-1/16"</b>	1.26	1.50	.63	.51	2.56
<b>2036U</b>	<b>1-1/8"</b>	1.26	1.57	.71	.51	2.76
<b>2038U</b>	<b>1-3/16"</b>	1.26	1.65	.79	.51	2.83
<b>2040U</b>	<b>1-1/4"</b>	1.26	1.73	.79	.40	2.83

ANSI Specifications B107.2

## 6 Standard Length - Metric Sizes MM

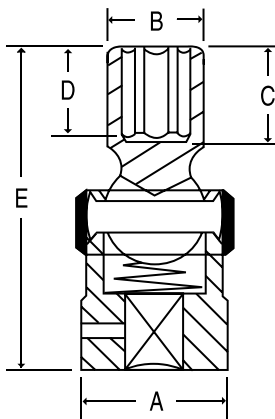

Item Number	Hex Size	Dimensions (Millimeters)				
		A	B	C	D	E
<b>2010UM</b>	<b>10mm</b>	28	15	16	13	65
<b>2011UM</b>	<b>11mm</b>	28	17	16	13	65
<b>2012UM</b>	<b>12mm</b>	28	19	16	13	65
<b>2013UM</b>	<b>13mm</b>	28	20	16	13	65
<b>2014UM</b>	<b>14mm</b>	28	22	16	13	65
<b>2015UM</b>	<b>15mm</b>	28	23	16	13	65
<b>2016UM</b>	<b>16mm</b>	28	23	16	13	65
<b>2017UM</b>	<b>17mm</b>	32	26	16	13	65
<b>2018UM</b>	<b>18mm</b>	32	26	16	13	65
<b>2019UM</b>	<b>19mm</b>	32	28	16	13	65
<b>2020UM</b>	<b>20mm</b>	32	30	16	13	65
<b>2021UM</b>	<b>21mm</b>	32	30	16	13	65
<b>2022UM</b>	<b>22mm</b>	32	32	16	13	65
<b>2023UM</b>	<b>23mm</b>	32	32	16	13	65
<b>2024UM</b>	<b>24mm</b>	32	34	16	13	65