

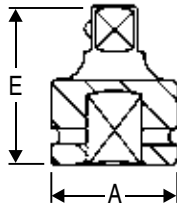

# 3/8" Drive Impact Attachments



## 3/8" Drive Adapters SAE



Item Number	Female End	Male End	Socket Retention Device	Dimensions (Inches)	
				A	E
*1128A	3/8"	1/4"	Friction Ball	.87	1.26
*1128AL	3/8"	1/4"	Locking Pin	.87	1.26
1138A	3/8"	1/2"	Friction Ball	.87	1.42
1138AL	3/8"	1/2"	Locking Pin	.87	1.42

\* Reducing Adapters are not covered by the GP Warranty.

\* See page 182 for New Reducing Sleeve Adapters

## 3/8" Drive Universal Joints SAE



1129UJ  
(Standard)



1129TUU  
(Thin-Wall)

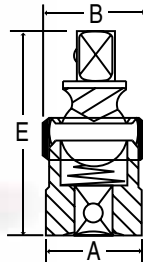

Item Number	Size	Socket Retention Device	Dimensions (Inches)		
			A	B	E
1129UJ	3/8" x 3/8"	Friction Ball	.94	1.02	1.97
1129UJL	3/8" x 3/8"	Locking Pin	.94	1.02	1.97
*1129TUU	3/8" x 3/8"	Friction Ball	.69	.77	1.85

\* 1129TUU is a thin-wall design that provides extra clearance in tight spaces.

Due to the thin wall design the 1129TUU is not covered by the GP Warranty.

## 3/8" Drive Extensions SAE



Standard



Locking

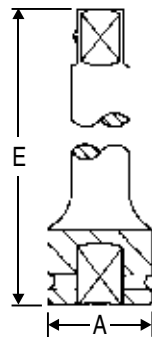

Item Number	Description	Socket Retention Device	Dimensions (Inches)	
			A	E
<b>Standard Extensions</b>				
1140E	1-3/4" Extension	Friction Ball	.75	1.73
1143E	3" Extension	Friction Ball	.75	2.95
1143EL	3" Extension	Locking Pin	.75	2.95
1146E	6" Extension	Friction Ball	.75	5.91
1146EL	6" Extension	Locking Pin	.75	5.91
1152E	12" Extension	Friction Ball	.75	11.80
1152EL	12" Extension	Locking Pin	.75	11.80

### Locking Extensions

These extensions feature a positive locking ball and sliding collar for quick release of sockets and accessories. Useful in hard to reach areas where a positive lock on the socket is required.

**1103QL 3 pc. Locking Extension Set - includes 3", 6", 12"**

1143QL	3" Locking Extension	.75	2.95
1146QL	6" Locking Extension	.75	5.91
1152QL	12" Locking Extension	.75	11.81
1158QL	18" Locking Extension	.75	18.11
1164QL	24" Locking Extension	.75	24.02

### Socket Retention Device Key for 3/8" Drive Adapters, Extensions & Universal Joints



Do NOT run the tool when the socket is OFF the fastener.



#### FB Friction Ball

A spring loaded steel ball that lines up with the socket retainer hole. Use caution when using this system because the socket is held in place only by spring pressure on the steel ball.

#### LP Locking Pin

Spring loaded pin, simply line up with socket retainer hole and press pin. To release socket, insert object through retainer hole and press pin.

