



*Impact Sockets,  
Chisels & Attachments*

**EVERYTHING IMPACT.®**





# GP is **EVERYTHING IMPACT**®

Grey Pneumatic (GP) through our distributors supplies the world's automotive, industrial, assembly, mining, maintenance, construction, and energy industries with heavy duty, high quality impact and specialty sockets. We carry a complete line of Impact Socket sets and individuals from 1/4" drive thru 2-1/2" and #5 spline drive with hex sizes up to 8". We also offer a large selection of star impact drivers, impact hex drivers, triple square drivers, torque limiting extensions plus Impact chisels and accessories.

GP sockets and tools are made in Taiwan using the highest quality chrome-molybdenum alloy steel and state-of-the-art manufacturing processes and equipment. Thorough and exact heat treatment, as well as rigid quality control, ensures the correct balance of strength and durability to deliver outstanding performance at the most competitive cost.

GP Tools are available through Automotive and Industrial warehouse distributors, tool stores, mobile tool truck dealers, tire equipment and supply warehouses and other sources that service these markets.

GP offers **Fast and Reliable** service to all of our distributors and their customers.



*GP Tools carry a  
Lifetime Warranty.*

## **All GP Impact Sockets feature the GP "High Torque" Drive**

### **Benefits are:**

**Increased Strength** - Transfers the pressure from the thinnest part of the socket wall toward the thicker section, resulting in increased strength.

**Increased Torque** - Allows up to 20% more torque to be applied than on standard hex impact sockets.

**Easier Access to Tight Areas** - The shift in pressure allows us to reduce the socket wall thickness, increasing access to tight areas.

**Reduced Wear** - Our impact sockets grip the fastener across a broader contact area, reducing the chance of rounding off fasteners.

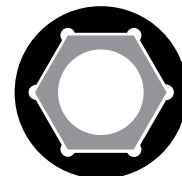

*GP "High Torque"  
drive offers many  
benefits.*



*All GP Sockets feature  
extra-large size markings  
for quick identification.*

**EVERYTHING IMPACT**®



# 3/8" Drive Impact Hex Drivers



## 3/8" Drive Fractional Hex Drivers



One piece impact hex drivers in fractional sizes.



Item Number	Hex Size	Dimensions (Inches)			
		A	C	D	E
<b>1906F</b>	<b>3/16"</b>	.75	1.22	.63	1.97
<b>1907F</b>	<b>7/32"</b>	.75	1.22	.63	1.97
<b>1908F</b>	<b>1/4"</b>	.75	1.22	.63	1.97
<b>1909F</b>	<b>9/32"</b>	.75	1.22	.63	1.97
<b>1910F</b>	<b>5/16"</b>	.75	1.22	.63	1.97
<b>1912F</b>	<b>3/8"</b>	.75	1.22	.63	1.97
<b>1914F</b>	<b>7/16"</b>	.75	1.22	.63	1.97
<b>1916F</b>	<b>1/2"</b>	.75	1.22	.63	1.97



## 3/8" Drive Metric Hex Drivers



HEX

One piece impact hex drivers in metric sizes.

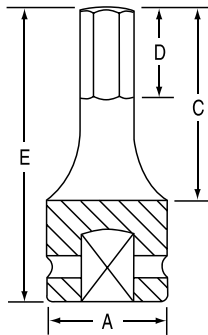

Item Number	Hex Size	Dimensions (Millimeters)			
		A	C	D	E
<b>1904M</b>	<b>4mm</b>	19	31	12	50
<b>1905M</b>	<b>5mm</b>	19	31	12	50
<b>1906M</b>	<b>6mm</b>	19	31	12	50
<b>1907M</b>	<b>7mm</b>	19	31	16	50
<b>1908M</b>	<b>8mm</b>	19	31	16	50
<b>1909M</b>	<b>9mm</b>	19	31	16	50
<b>1910M</b>	<b>10mm</b>	19	31	16	50
<b>1911M</b>	<b>11mm</b>	19	31	16	50
<b>1912M</b>	<b>12mm</b>	19	31	16	50



# 3/8" Drive Extended Length Impact Hex Driver Sets



## Hex No. 1247H 3/8" Drive - 4" Length - Fractional Hex Driver Set SAE



**4" Length**

### 7 piece set contents:

19064F . . . . . 3/16"	19124F . . . . . 3/8"
19074F . . . . . 7/32"	19144F . . . . . 7/16"
19084F . . . . . 1/4"	19164F . . . . . 1/2"
19104F . . . . . 5/16"	on a Metal Clip Rail

## Hex No. 1267H 3/8" Drive - 6" Length - Fractional Hex Driver Set SAE



**6" Length**

### 7 piece set contents:

19066F . . . . . 3/16"	19126F . . . . . 3/8"
19076F . . . . . 7/32"	19146F . . . . . 7/16"
19086F . . . . . 1/4"	19166F . . . . . 1/2"
19106F . . . . . 5/16"	on a Metal Clip Rail

## Hex No. 1247MH 3/8" Drive - 4" Length - Metric Hex Driver Set MM



**4" Length**

### 7 piece set contents:

19044M . . . . . 4mm	19084M . . . . . 8mm
19054M . . . . . 5mm	19104M . . . . . 10mm
19064M . . . . . 6mm	19124M . . . . . 12mm
19074M . . . . . 7mm	on a Metal Clip Rail

## Hex No. 1267MH 3/8" Drive - 6" Length - Metric Hex Driver Set MM



**6" Length**

### 7 piece set contents:

19046M . . . . . 4mm	19086M . . . . . 8mm
19056M . . . . . 5mm	19106M . . . . . 10mm
19066M . . . . . 6mm	19126M . . . . . 12mm
19076M . . . . . 7mm	on a Metal Clip Rail

HEX



# 3/8" Drive - 4" Length Impact Hex Drivers



## Hex 3/8" Drive - 4" Length - Fractional Hex Drivers SAE

One piece impact hex drivers in fractional sizes. 4" extended length for special applications.



Item Number	Hex Size	Dimensions (Inches)			
		A	C	D	E
<b>19064F</b>	<b>3/16"</b>	.75	3.23	.43	3.94
<b>19074F</b>	<b>7/32"</b>	.75	3.23	.43	3.94
<b>19084F</b>	<b>1/4"</b>	.75	3.23	.43	3.94
<b>19094F</b>	<b>9/32"</b>	.75	3.23	.43	3.94
<b>19104F</b>	<b>5/16"</b>	.75	3.23	.63	3.94
<b>19124F</b>	<b>3/8"</b>	.75	3.23	.63	3.94
<b>19144F</b>	<b>7/16"</b>	.75	3.23	.63	3.94
<b>19164F</b>	<b>1/2"</b>	.75	3.23	.63	3.94

## Hex 3/8" Drive - 4" Length - Metric Hex Drivers MM

One piece impact hex drivers in metric sizes. 4" extended length for special applications.

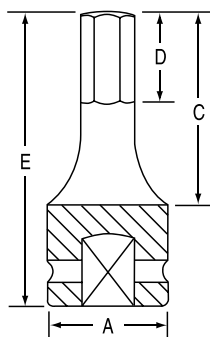

Item Number	Hex Size	Dimensions (Millimeters)			
		A	C	D	E
<b>19044M</b>	<b>4mm</b>	19	82	11	100
<b>19054M</b>	<b>5mm</b>	19	82	11	100
<b>19064M</b>	<b>6mm</b>	19	82	11	100
<b>19074M</b>	<b>7mm</b>	19	82	16	100
<b>19084M</b>	<b>8mm</b>	19	82	16	100
<b>19094M</b>	<b>9mm</b>	19	82	16	100
<b>19104M</b>	<b>10mm</b>	19	82	16	100
<b>19114M</b>	<b>11mm</b>	19	82	16	100
<b>19124M</b>	<b>12mm</b>	19	82	16	100



# 3/8" Drive - 6" Length Impact Hex Drivers



## Hex 3/8" Drive - 6" Length - Fractional Hex Drivers SAE

One piece impact hex drivers in fractional sizes. 6" extended length for special applications.

Item Number	Hex Size	Dimensions (Inches)			
		A	C	D	E
<b>19066F</b>	<b>3/16"</b>	.75	5.24	.43	5.91
<b>19076F</b>	<b>7/32"</b>	.75	5.24	.43	5.91
<b>19086F</b>	<b>1/4"</b>	.75	5.24	.43	5.91
<b>19096F</b>	<b>9/32"</b>	.75	5.24	.43	5.91
<b>19106F</b>	<b>5/16"</b>	.75	5.24	.63	5.91
<b>19126F</b>	<b>3/8"</b>	.75	5.24	.63	5.91
<b>19146F</b>	<b>7/16"</b>	.75	5.24	.63	5.91
<b>19166F</b>	<b>1/2"</b>	.75	5.24	.63	5.91

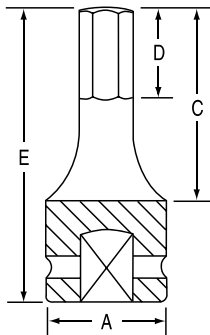

## Hex 3/8" Drive - 6" Length - Metric Hex Drivers MM

One piece impact hex drivers in metric sizes. 6" extended length for special applications.

Item Number	Hex Size	Dimensions (Millimeters)			
		A	C	D	E
<b>19046M</b>	<b>4mm</b>	19	133	11	150
<b>19056M</b>	<b>5mm</b>	19	133	11	150
<b>19066M</b>	<b>6mm</b>	19	133	11	150
<b>19076M</b>	<b>7mm</b>	19	133	16	150
<b>19086M</b>	<b>8mm</b>	19	133	16	150
<b>19096M</b>	<b>9mm</b>	19	133	16	150
<b>19106M</b>	<b>10mm</b>	19	133	16	150
<b>19116M</b>	<b>11mm</b>	19	133	16	150
<b>19126M</b>	<b>12mm</b>	19	133	16	150

HEX