

## No. 86850A-1

### 850 Pc. Senior Mechanics Tool Set

MASTER SETS

PART NO.	SET COUNT	DESCRIPTION
40972	1	¼" Drive Pro Flex Head Ratchet
49270	1	¼" Drive Thumbwheel Ratchet
4916T	6	¼" Drive Extension Set
40990	1	¼" Drive Universal Joint
4506	5	¼", ⅜" and ½" Drive Adapter Set
91844	44	¼" Drive 6 Point Standard and Deep Fract./Met. Socket Set
4934	7	¼" Drive 6 Point Flex Fractional Socket Set
1337	12	¼" Drive 6 Point Flex Metric Socket Set
89039	33	¼" and ⅜" Drive Master Bit Socket Set
19763	35	¼", ⅜", and ½" Drive TORX® Bit Socket SuperSet®
45183	1	⅜" Drive Pro Flex Head Ratchet
45178	1	⅜" Drive Pro Stubby Ratchet
4514	4	⅜" Drive Extension Set
4524	4	⅜" Drive Wobble Extension Set
45190	1	⅜" Drive Universal Joint
94549	49	⅜" Drive 6 Point Fractional/Metric Socket Set with Universal Joint
4607	7	⅜" Drive 6 Point Flex Fractional Socket Set
3910	10	⅜" Drive 6 Point Flex Metric Socket Set
19704	4	⅜" and ½" Drive Triple Square Bit Socket Set
19781	11	⅜" Drive Male and Female Pipe Plug Socket Set
42470	1	½" Drive 10.3" Pro Ratchet
40170	1	½" Drive 15" Pro Ratchet
42472	1	½" Drive Pro Flex Head Ratchet
41652	1	½" Drive Pro Stubby Ratchet
4114	3	½" Drive Extension Set
4121	19	½" Drive 12 Point Standard Fractional Socket Set
4819	19	½" Drive 12 Point Deep Fractional Socket Set
1959	19	½" Drive 6 Point Standard Metric Socket Set
1947	21	½" Drive 6 Point Deep Metric Socket Set
19798	8	½" Drive Male Pipe Plug Socket Set
4725	25	¾" Drive 12 Point Standard Fractional Socket Set
19766	6	¾" Drive Fractional Ball Hex Bit Socket Set
19752	8	¾" Drive Metric Ball Hex Bit Socket Set
19726	6	¾" Drive Metric Long Ball Hex Bit Socket Set
45674	3	¾" Drive Impact Extension Set
33990	1	¾" Drive Impact Universal Joint
4058	8	¾" Drive 6 Point Standard Fractional Impact Socket Set
4062	12	¾" Drive 6 Point Standard Metric Impact Socket Set
4078	8	¾" Drive 6 Point Deep Fractional Impact Socket Set
4082	12	¾" Drive 6 Point Deep Metric Impact Socket Set
33300	8	¾" Drive 6 Point Standard Fractional Swivel Impact Socket Set
33350	15	¾" Drive 6 Point Standard Metric Swivel Impact Socket Set
46170	1	½" Drive 3" Impact Extension with Ball Retainer
46171	1	½" Drive 5" Impact Extension with Ball Retainer
34990	1	½" Drive Impact Universal Joint
4039	19	½" Drive 6 Point Standard Fractional Impact Socket Set
4049	19	½" Drive 6 Point Deep Fractional Impact Socket Set
4037	25	½" Drive 6 Point Standard Metric Impact Socket Set
4047	26	½" Drive 6 Point Deep Metric Impact Socket Set
34300	13	½" Drive 6 Point Standard Fractional Swivel Impact Socket Set

PART NO.	SET COUNT	DESCRIPTION
34350	15	½" Drive 6 Point Standard Metric Swivel Impact Socket Set
46125	1	½" Drive Fractional Flip Impact Socket
46119	1	½" Drive Metric Flip Impact Socket
756	16	½" Drive TurboSocket® Set
803	13	⅜" Drive TurboSocket® Set
4498	8	Spark Plug Socket Set
86043	23	6 and 12 Point SuperKrome® Fractional Combination Wrench Set
86225	23	12 Point SuperKrome® Metric Combination Wrench Set
86017	13	12 Point SuperKrome® Fractional Long Pattern Combination Wrench Set
86037	19	12 Point SuperKrome® Metric Long Pattern Combination Wrench Set
86231	11	12 Point SuperKrome® Fractional Short Pattern Combination Wrench Set
86240	10	12 Point SuperKrome® Metric Short Pattern Combination Wrench Set
86241	5	12 Point SuperKrome® Metric Short Pattern Combination Wrench Set
386	5	SuperKrome® Fractional 15° Offset Flare Nut Wrench Set
378	6	SuperKrome® Fractional 15° Offset Flare Nut Wrench Set
4508	10	Fractional Flare Nut Crowfoot Wrench Set
4511	11	Metric Flare Nut Crowfoot Wrench Set
8008	1	8" Adjustable Wrench
8012	1	12" Adjustable Wrench
8015	1	15" Adjustable Wrench
77250	9	Adjustable Micrometer Torque Wrench 25–250 ft. lb.
86320	6	SureGrip® Screwdriver Set
86321	5	SureGrip® Long Reach Screwdriver Set
86322	5	SureGrip® Heavy Duty Screwdriver Set
86323	7	SureGrip® TORX® Screwdriver Set
86325	4	SureGrip® Stubby Screwdriver Set
19613	13	Fractional Ball Hex Key Set
19609	9	Metric Ball Hex Key Set
7509	1	9½" V-Jaw Tongue and Groove Pliers
7511	1	10½" V-Jaw Tongue and Groove Pliers
7516	1	16" Tongue and Groove Pliers
7210	1	10" Slip Joint Pliers
16315	1	6" Curved Chain Nose Pliers without Cutter
17835	5	General Purpose Pliers Set
17832	2	Extra Long Needle Nose Pliers Set
7612	12	Convertible Retaining Ring Pliers Set
7695	1	Wire Cutter/Stripper
8616	1	12" 16 oz Soft Face Hammer
8516	1	12" 12 oz Ball Peen Hammer
8542	1	13.5" Cross Peen Hammer with Hickory Handle
6020	20	Punch and Chisel Set
6069	9	Roll Pin Punch Set
6093	3	Pry Bar Set

## Swivel Impact Sockets

### SureGrip® Drive Design

SureGrip® Design drives the side of the fastener, not the corner. This not only provides increased strength, but also avoids the rounding of rusted or damaged fasteners, which can occur when using a sharp-cornered hex tool.

### Great on Domed Fasteners

S•K Sockets feature extra recess depth to allow for use where threaded fasteners protrude above the nut or where the fastener is domed.

### Gets Into Tight Spaces

The 30° flex angle on S•K Sockets allows the user to get at hard-to-reach fasteners. The socket can be positioned to the desired angle because of the heavy-duty spring.

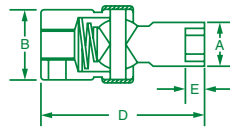

### 1/2" Drive, 6 Point, Swivel Fractional Impact Sockets

PART NO.	HEX SIZE	A	B	D	E
34316	1/2"	0.75	1.07	2.75	0.31
34318	9/16"	0.88	1.07	2.81	0.33
34320	5/8"	0.97	1.07	2.81	0.40
34322	11/16"	1.07	1.13	2.87	0.42
34324	3/4"	1.13	1.13	2.93	0.46
34326	13/16"	1.19	1.13	2.94	0.50
34328	7/8"	1.25	1.13	2.94	0.52
34330	15/16"	1.38	1.13	3.12	0.58
34332	1"	1.44	1.13	3.12	0.58
34334	1 1/16"	1.50	1.13	3.37	0.65
34336	1 1/8"	1.50	1.13	3.37	0.68
34338	1 3/16"	1.63	1.13	3.37	0.68
34340	1 1/4"	1.63	1.13	3.37	0.73

### 1/2" Drive, 6 Point, Swivel Metric Impact Sockets

PART NO.	HEX SIZE	A	B	D	E
34360	10mm	0.66	1.07	2.56	0.28
34361	11mm	0.69	1.07	2.56	0.28
34362	12mm	0.75	1.07	2.75	0.28
34363	13mm	0.82	1.07	2.75	0.31
34364	14mm	0.88	1.07	2.81	0.32
34365	15mm	0.94	1.07	2.81	0.32
34366	16mm	0.97	1.07	2.81	0.40
34367	17mm	1.07	1.13	2.81	0.40
34368	18mm	1.07	1.13	2.87	0.42
34369	19mm	1.13	1.13	2.94	0.46
34370	20mm	1.19	1.13	2.94	0.46
34371	21mm	1.19	1.13	2.94	0.50
34372	22mm	1.25	1.13	2.94	0.52
34373	23mm	1.38	1.13	3.12	0.55
34374	24mm	1.38	1.13	3.12	0.58

**high visibility**



### No. 34301

#### 8 Piece, 1/2" Drive, 6 Point, Swivel Fractional Impact Socket Set Includes:

PART NO.	SIZE	PART NO.	SIZE	PART NO.	SIZE	PART NO.	SIZE
34316	1/2"	34320	5/8"	34324	3/4"	34328	7/8"
34318	9/16"	34322	11/16"	34326	13/16"	34330	15/16"

Packaged in a molded plastic case.



### No. 34302

#### 5 Piece, 1/2" Drive, 6 Point, Swivel Fractional Impact Socket Set Includes:

PART NO.	SIZE	PART NO.	SIZE	PART NO.	SIZE
34332	1"	34336	1 1/8"	34340	1 1/4"
34334	1 1/16"	34338	1 3/16"		

Packaged in a molded plastic case.



### No. 34300

#### 13 Piece, 1/2" Drive, 6 Point, Swivel Fractional Impact Socket Set Includes:

PART NO.	SIZE	PART NO.	SIZE	PART NO.	SIZE	PART NO.	SIZE
34316	1/2"	34324	3/4"	34332	1"	34340	1 1/4"
34318	9/16"	34326	13/16"	34334	1 1/16"		
34320	5/8"	34328	7/8"	34336	1 1/8"		
34322	11/16"	34330	15/16"	34338	1 3/16"		

Packaged in a molded plastic case.

IMPACT SOCKETS