

Spanner Wrenches & Sets

– Adjustable



Adjustable Hook Spanner

Capacity Range	Thickness of Handle	Thickness of Hook	Depth of Hook	Overall Length	Weight Each (lb)	Part No.	Std. Pkg. Qty.
	A	B	C	D		Industrial Black	
3/4 to 2	1/4	3/8	1/8	6-1/2	.23	471	6
1-1/4 to 3	9/32	1/2	5/32	8-1/16	.43	472	6
2 to 4-3/4	11/32	17/32	7/32	11-3/16	1.03	474	6
4-1/2 to 6-1/4	11/32	17/32	1/4	12	1.07	474A	6
6-1/8 to 8-3/4	11/32	17/32	5/16	13-5/16	1.40	474B	6

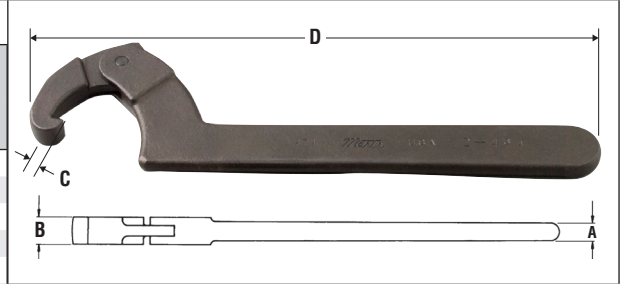

Adjustable Pin Spanner

Capacity Range	Thickness		Pin Size		Overall Length	Weight Each (lb)	Part No.	Std. Pkg. Qty.
	Handle	Hook	Diameter	Length				
	A	B	C	D	E			
3/4 to 2	1/4	3/8	1/8	1/8	6-1/2	.23	0471	6
3/4 to 2	1/4	3/8	3/16	5/32	6-1/2	.23	0471A	6
1-1/4 to 3	9/32	1/2	3/16	3/16	8-1/16	.42	0472	6
1-1/4 to 3	9/32	1/2	1/4	7/32	8-1/16	.42	0472A	6
2 to 4-3/4	11/32	17/32	1/4	1/4	11-3/16	.99	0474	6
4-1/2 to 6-1/4	11/32	17/32	3/8	1/4	12-3/16	1.08	0474A	6

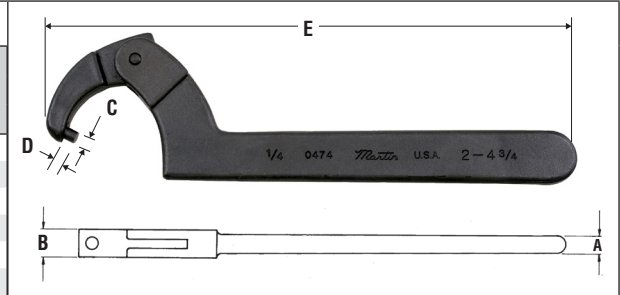

Adjustable Spanner Wrench Sets

SPW6K		SHW5K	
Image	CAPACITY RANGE PART NO.	Image	CAPACITY RANGE PART NO.
	3/4 to 2 0471		3/4 to 2 471
	3/4 to 2 0471A		1-1/4 to 3 472
	1-1/4 to 3 0472		2 to 4-3/4 474
	1-1/4 to 3 0472A		4-1/2 to 6-1/4 474A
	2 to 4-3/4 0474		6-1/8 to 8-3/4 474B
	4-1/2 to 6-1/4 0474A		Kit Bag C60B
Kit Bag C60B			

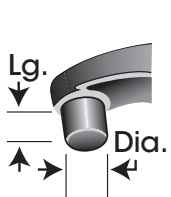

Adjustable Pin Spanner

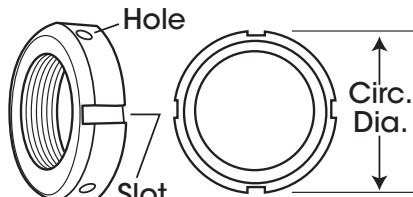

Pins fit into the holes or slots on the side of the flange or collar.

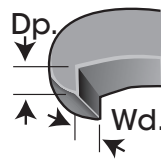

Adjustable Hook Spanner

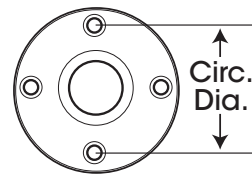

Pins fit into the holes or slots on the face of the flange or collar.
Adjustable Face Spanner

Crowfoot Wrenches

BD10		QTY.
4112	3/8 Crowfoot Wrench	1
4114	7/16 Crowfoot Wrench	1
4116	1/2 Crowfoot Wrench	1
4118	9/16 Crowfoot Wrench	1
4120	5/8 Crowfoot Wrench	1
4122	11/16 Crowfoot Wrench	1
4124	3/4 Crowfoot Wrench	1
4126	13/16 Crowfoot Wrench	1
4128	7/8 Crowfoot Wrench	1
4130	15/16 Crowfoot Wrench	1
4132	1 Crowfoot Wrench	1
4134	1-1/16 Crowfoot Wrench	1
4136	1-1/8 Crowfoot Wrench	1
4140	1-1/4 Crowfoot Wrench	1
4144	1-3/8 Crowfoot Wrench	1
4148	1-1/2 Crowfoot Wrench	1
BC20	5/8 Drive Crowfoot	1
BC22	11/16 Drive Crowfoot	1
BC24	3/4 Drive Crowfoot	1
BC26	13/16 Drive Crowfoot	1
BC28	7/8 Drive Crowfoot	1
BC30	15/16 Drive Crowfoot	1
BC32	1 Drive Crowfoot	1
BC34	1-1/16 Drive Crowfoot	1
SC36	1-1/8 Drive Crowfoot	1
SC38	1-3/16 Drive Crowfoot	1
SC40	1-1/4 Drive Crowfoot	1
SC42	1-5/16 Drive Crowfoot	1
SC44	1-3/8 Drive Crowfoot	1
SC46	1-7/16 Drive Crowfoot	1
SC50	1-9/16 Drive Crowfoot	1
SC52	1-5/8 Drive Crowfoot	1
SC54	1-11/16 Drive Crowfoot	1
SC56	1-3/4 Drive Crowfoot	1
SC58	1-13/16 Drive Crowfoot	1
SC60	1-7/8 Drive Crowfoot	1
SC62	1-15/16 Drive Crowfoot	1
SC64	2 Drive Crowfoot	1



Spanner Wrenches

BD11		QTY.
O471	3/4 to 2 Adjustable Pin Spanner	1
O471A	3/4 to 2 Adjustable Pin Spanner	1
O472	1-1/4 to 3 Adjustable Pin Spanner	1
O472A	1-1/4 to 3 Adjustable Pin Spanner	1
O474	2 to 4-3/4 Adjustable Pin Spanner	1
O474A	4-1/2 to 6-1/4 Adjustable Pin Spanner	1
471	3/4 to 2 Adjustable Hook Spanner	1
472	1-1/4 to 3 Adjustable Hook Spanner	1
474	2 to 4-3/4 Adjustable Hook Spanner	1
474A	4-1/2 to 6-1/4 Adjustable Hook Spanner	1
474B	6-1/8 to 8-3/4 Adjustable Hook Spanner	1
482	2 Adjustable Face Spanner	1
483	3 Adjustable Face Spanner	1
484	4 Adjustable Face Spanner	1



Part Number Interchange



Check Nut Wrenches 15" — Industrial Black (Continuation)					
Wrench Opening	Martin	Part Number	Proto	Armstrong	Gray
1-5/8	610	—	JKE52	31-352	—
1-11/16	610A	—	JKE54	—	—

Ratcheting Box Wrenches — Straight Pattern — Chrome						
Wrench Opening	Points	Martin	Part Number	Proto	Armstrong	Gray
1/4 x 5/16	6 pt	RB810	R810SA	J1191-A	27-587	—
1/4 x 5/16	12 pt	RB810DH	R810B	1191T	27-588	—
3/8 x 7/16	6 pt	RB1214	R1214SA	J1192-A	27-590	—
3/8 x 7/16	12 pt	RB1214DH	R1214B	J1192LO	27-591	—
1/2 x 9/16	6 pt	RB1616	R1616SA	J1193-A	27-593	—
1/2 x 9/16	12 pt	RB1616DH	R1616B	J1193LO	27-594	—
5/8 x 11/16	12 pt	RB2022	R2022A	J1194LO	27-596	—
5/8 x 3/4	12 pt	RB2024	R2024A	—	27-599	—
11/16 x 13/16	12 pt	RB2226	—	—	—	—
3/4 x 7/8	12 pt	RB2428	R2428A	J1195LO	27-602	—

Ratcheting Box Wrenches and Sets 25° Offset Pattern — Chrome						
Wrench Opening	Points	Martin	Part Number	Proto	Armstrong	Gray
1/4 x 5/16	6 pt	RB0810	—	J1181-A	27-613	—
3/8 x 7/16	6 pt	RB01214	—	J1182-A	27-616	—
1/2 x 9/16	6 pt	RB01618	—	J1183-A	27-619	—
5/8 x 11/16	12 pt	RB02022	RYA2022A	J1184-A	27-622	—
5/8 x 3/4	12 pt	RB02024	—	J1186	27-624	—
11/16 x 13/16	12 pt	RB02226	—	—	—	—
3/4 x 7/8	12 pt	RB02428	RYA2428	J1185-A	27-626	—

Flare Nut Wrench 12 Pt. — Chrome					
Wrench Opening	Martin	Part Number	Proto	Armstrong	Gray
3/8	4112	—	—	—	—
7/16	4114	—	—	—	—
1/2	4116	—	—	—	—
9/16	4118	—	—	—	—
5/8	4120	—	—	—	—
11/16	4122	—	—	—	—
3/4	4124	—	—	—	—
13/16	4126	—	—	—	—
7/8	4128	—	—	—	—
15/16	4130	—	—	—	—
1	4132	—	—	—	—
1-1/16	4134	—	—	—	—
1-1/8	4136	—	—	—	—
1-1/4	4140	—	—	—	—
1-3/8	4144	—	—	—	—
1-1/2	4148	—	—	—	—

Flare Nut Wrench 12 Pt. — Industrial Black					
Wrench Opening	Martin	Part Number	Proto	Armstrong	Gray
3/8	BLK4112	—	—	—	—
7/16	BLK4114	—	—	—	—
1/2	BLK4116	—	—	—	—
9/16	BLK4118	RX18	—	—	—
5/8	BLK4120	RX20	—	—	—
11/16	BLK4122	RX22	—	—	—
3/4	BLK4124	RX24	—	—	—
13/16	BLK4126	RX26	—	—	—
7/8	BLK4128	RX28	—	—	—
15/16	BLK4130	RX30	—	—	—
1	BLK4132	RX32	—	—	—
1-1/16	BLK4134	RX34	—	—	—
1-1/8	BLK4136	RX36	—	—	—
1-1/4	BLK4140	RX40	—	—	—
1-3/8	BLK4144	RX44	—	—	—
1-1/2	BLK4148	RX48	—	—	—

Adjustable Wrenches 22-1/2° Angle — Cobalt					
Wrench Opening	Martin	Part Number	Proto	Armstrong	Gray
6	A6	AD6B	J706	28-506	65306
8	A8	AD8B	J708	28-508	65308
10	A10	AD10B	J710	28-510	65310
12	A12	AD12B	J712	28-512	65312
15	A15	D715B	J715	28-515	65315
18	A18	D718B	J718	28-518	65318
24	A24	D724B	J724	28-524	65324

Adjustable Wrenches — Industrial Black					
Wrench Opening	Martin	Part Number	Proto	Armstrong	Gray
6	A6T	GAJ6A	J706S	34-506	65306B
8	A8T	GAJ8A	J708S	34-508	65308B
10	A10T	GAJ10A	J710S	34-510	65310B
12	A12T	GAJ12A	J712S	34-512	65312B
15	A15T	GAJ15A	J715S	34-515	65315B
18	A18T	GAJ18A	J718S	34-518	65318B
24	A24T	GAJ24A	J724S	—	65324B

Set Screw Wrench — Industrial Black					
Wrench Opening	Martin	Part Number	Proto	Armstrong	Gray
1/4 x 5/16	525	—	—	35-457	—
5/16 x 3/8	527	—	—	35-463	—
3/8 x 7/16	529	—	—	35-466	—
1/2 x 5/8	534	—	—	35-478	—

Single Head Open End Wrenches — Industrial Black					
Wrench Opening	Martin	Part Number	Proto	Armstrong	Gray
1/2	1	—	—	31-016	1SE
9/16	702	—	—	31-018	702SE
5/8	703	—	—	—	703SE
11/16	3	—	—	31-022	3SE
3/4	704	—	—	31-024	704SE
13/16	705	—	—	—	705SE
7/8	—	—	—	31-028	5SE
15/16	6A	—	—	31-030	6SE
1	706	—	—	31-032	706SE
1-1/16	7	—	—	31-034	7SE
1-1/8	707	—	—	31-036	707SE

Single Head Open End Wrenches — Industrial Black (Continuation)					
Wrench Opening	Martin	Part Number	Proto	Armstrong	Gray
1-1/4	8	—	—	31-040	8SE
1-5/16	8A	—	—	—	—
1-3/8	708A	—	—	31-044	708ASE
1-7/16	9	—	—	31-046	9SE
1-1/2	709	—	—	31-048	709SE
1-5/8	10	—	—	31-052	10SE
1-11/16	10A	—	—	—	—
1-13/16	11	—	—	31-058	11SE
1-7/8	11A	—	—	—	11ASE
2	12	—	—	31-064	12SE
2-1/16	12A	—	—	—	—
2-3/16	13	—	—	31-070	—
2-1/4	13A	—	—	31-072	13ASE
2-3/8	14	—	—	31-076	14SE
2-7/16	14A	—	—	31-078	—
2-9/16	15	—	—	31-082	15SE
2-5/8	15A	—	—	31-084	—
2	16	—	—	31-088	16SE
2-13/16	16B	—	—	—	—
2-15/16	16A	—	—	31-094	—
3	17A	—	—	31-096	17ASE
3-1/8	17	—	—	31-100	17SE
3-3/8	18A	—	—	31-108	—
3-1/2	18	—	—	31-112	—
3-3/4	19B	—	—	31-120	—
3-7/8	19	—	—	31-124	—
4-1/8	19C	—	—	—	—
4-1/4	19A	—	—	—	—
4-1/2	20B	—	—	—	—
4-5/8	20	—	—	—	—
5	20A	—	—	—	—

Adjustable Face Spanner — Industrial Black					
Extreme Capacity	Martin	Part Number	Proto	Armstrong	Gray
2	482	AFS482B	JC482	34-151	AFS2
3	483	AFS483B	JC483	34-154	AFS3
4	484	AFS484B	JC484	34-157	AFS4

Pin Spanner — Industrial Black					
For Circle Diameter	Martin	Part Number	Proto	Armstrong	Gray
1	452	—	—	34-201	—
1-1/4	453	—	—	34-204	—
1-1/2	454	—	—	34-207	—
1-3/4	455	—	—	34-210	—
2	456	—	—	34-213	—
2-1/4	457	—	—	34-216	—
2-1/2	458	—	—	34-219	—
2-3/4	459	—	—	34-222	—
3	460	—	—	34-225	—
3-1/4	461	—	—	34-228	—
3-1/2	462	—	—	34-231	—
3-3/4	463	—	—	34-234	—
4	464	—	—	34-237	—
5	466	—	—	34-240	—
6	468	—	—	34-243	—

Face Spanner — Industrial Black					
Center Distance of Pins	Martin	Part Number	Proto	Armstrong	Gray
1	418	—	—	34-101	—
1-1/4	420	—	—	34-104	—
1-1/2	422	—	—	34-107	—
1-3/4	424	—	—	34-110	—
2	426	—	—	34-113	—
2-1/4	428	—	—	34-116	—
2-1/2	430	—	—	34-119	—
2-3/4	432	—	—	34-121	—
3	434	—	—	34-124	—
3-1/4	436	—	—	34-127	—
3-1/2	438	—	—	34-130	—
3-3/4	440	—	—	34-133	—
4	442	—	—	34-136	—

Adjustable Hook Spanner — Industrial Black					
Capacity Range	Martin	Part Number	Proto	Armstrong	Gray
3/4 to 2	471	AHS300B	JC471	34-301	AHS2
1-1/4 to 3	472	AHS301B	JC472	34-304	AHS3
2 to 4-3/4	474	AHS304B	JC474	34-307	AHS4
4-1/2 to 6-1/4	474A	AHS307B	JC474A	34-310	AHS6
6-1/8 to 8-3/4	474B	—	—	34-313	AHS8

Adjustable Pin Spanner — Industrial Black					
Capacity Range	Martin	Part Number	Proto	Armstrong	Gray
3/4 to 2	471	APS351B	—	34-351	APS2
3/4 to 2	0471A	—	—	34-354	APS21
1-1/4 to 3	472	—	—	34-357	APS3
1-1/4 to 3	0472A	—	—	34-360	APS31
2 to 4-3/4	474	APS363B	—	34-363	—
4-1/2 to 6-1/4	0474A	APS366B	—	34-366	APS6

Construction Wrench 15° Angle — Industrial Black					
Wrench Opening	Martin	Part Number	Proto	Armstrong	Gray
5/8	203A	—	—	C203A	32-820
11/16	203	—	—	C203	32-822
3/4	204A	—	—	C204A	32-824
7/8	205	—	—	C205	32-828
15/16	206	—	—	C206C	32-830
1	206B	—	—	C206B	32-832
1-1/16	207	—	—	C207	32-834
1-1/8	207A	—	—	C207A	32-836
1-1/4	208	—	—	C208	32-840
1-5/16	208A	—	—		