

Wrench Opening	Diameter of Head		Thickness of Head		Length		Wt. Ea. (lb)	Part No.	Std. Pkg. Qty.	Wrench Opening
	A	B	C							
1-1/16	1-25/32	9-7/8	5/8	1.9	RN7063	1	1-1/16			
1-1/4	2	10-1/4	23/32	2.1	RN7075	1	1-1/4			
1-7/16	2-17/64	10-9/16	7/8	2.6	RN7088	1	1-7/16			
1-5/8	2-31/64	11	61/64	2.9	RN7100	1	1-5/8			
1-13/16	2-21/32	11-5/16	63/64	3.5	RN7113	1	1-13/16			
2	3-1/32	11-11/16	1-7/32	4.0	RN7125	1	2			
2-3/16	3-9/32	12	1-1/4	5.2	RN7138	1	2-3/16			
2-3/8	3-13/32	12-3/8	1-7/16	6.0	RN7150	1	2-3/8			
2-9/16	3-3/4	12-11/16	1-17/32	6.6	RN7163	1	2-9/16			
2-3/4	4-11/64	13-1/16	1-17/32	7.5	RN7175	1	2-3/4			
2-15/16	4-23/64	13-7/16	1-17/32	7.9	RN7188	1	2-15/16			
3-1/8	4-31/64	13-13/16	1-5/8	9.4	RN7200	1	3-1/8			
3-1/2	4-31/32	14-1/8	1-23/32	10.5	RN7225	1	3-1/2			
3-7/8	5-35/64	14-1/2	1-23/32	13.3	RN7250	1	3-7/8			
Wrench Opening	Diameter of Head		Thickness of Head		Length		Wt. Ea. (lb)	Part No.	Std. Pkg. Qty.	Wrench Opening
A	B	C								
1	1-25/32	9-7/8	5/8	1.9	1807B	1	1			
1-1/16	1-25/32	9-7/8	5/8	1.9	1807	1	1-1/16			
1-1/8	1-25/32	9-7/8	5/8	1.9	1807A	1	1-1/8			
1-3/16	2	10-1/4	23/32	2.1	1808B	1	1-3/16			
1-1/4	2	10-1/4	23/32	2.1	1808	1	1-1/4			
1-5/16	2	10-1/4	23/32	2.1	1808A	1	1-5/16			
1-3/8	2-17/64	10-9/16	7/8	2.6	1809B	1	1-3/8			
1-7/16	2-17/64	10-9/16	7/8	2.6	1809	1	1-7/16			
1-1/2	2-17/64	10-9/16	7/8	2.6	1809A	1	1-1/2			
1-5/8	2-31/64	11	61/64	2.9	1810	1	1-5/8			
1-11/16	2-31/64	11	61/64	2.9	1810A	1	1-11/16			
1-3/4	2-21/32	11-5/16	63/64	3.5	1811B	1	1-3/4			
1-13/16	2-21/32	11-5/16	63/64	3.5	1811	1	1-13/16			
1-7/8	2-21/32	11-5/16	63/64	3.5	1811A	1	1-7/8			
1-15/16	3-1/32	11-11/16	1-7/32	4.0	1812A	1	1-15/16			
2	3-1/32	11-11/16	1-7/32	4.0	1812	1	2			
2-1/16	3-1/32	11-11/16	1-7/32	4.0	1812B	1	2-1/16			
2-1/8	3-9/32	12	1-1/4	5.2	1813B	1	2-1/8			
2-3/16	3-9/32	12	1-1/4	5.2	1813	1	2-3/16			
2-1/4	3-13/32	12-3/8	1-7/16	6.0	1813A	1	2-1/4			
2-3/8	3-13/32	12-3/8	1-7/16	6.0	1814	1	2-3/8			
2-7/16	3-3/4	12-11/16	1-17/32	6.5	1815B	1	2-7/16			
2-1/2	3-3/4	12-11/16	1-17/32	6.5	1815C	1	2-1/2			
2-9/16	3-3/4	12-11/16	1-17/32	6.5	1815	1	2-9/16			
2-5/8	3-3/4	12-11/16	1-17/32	6.5	1815A	1	2-5/8			
2-3/4	4-11/64	13-1/16	1-17/32	7.5	1816	1	2-3/4			
2-13/16	4-23/64	13-7/16	1-17/32	7.9	1816C	1	2-13/16			
2-15/16	4-23/64	13-7/16	1-17/32	7.9	1816B	1	2-15/16			
3	4-31/64	13-13/16	1-5/8	9.4	1817A	1	3			
3-1/8	4-31/64	13-13/16	1-5/8	9.4	1817	1	3-1/8			
3-3/8	4-31/32	14-1/8	1-23/32	10.5	1818A	1	3-3/8			
3-1/2	4-31/32	14-1/8	1-23/32	10.5	1818	1	3-1/2			
3-3/4	5-35/64	14-1/2	1-23/32	13.3	1819B	1	3-3/4			
3-7/8	5-35/64	14-1/2	1-23/32	13.3	1819	1	3-7/8			
4-1/8	6-3/4	16-7/32	2-7/8	20.8	1820B	1	4-1/8			
4-1/4	6-3/4	16-7/32	2-7/8	20.1	1820	1	4-1/4			
4-1/2	7-1/4	18-7/32	3	35.2	1821B	1	4-1/2			
4-5/8	7-1/4	18-7/32	3	38.0	1821	1	4-5/8			
4-3/4	7-1/4	18-7/32	3	38.2	1822	1	4-3/4			
32 mm	50.8 mm	260.4 mm	18.3 mm	2.1	1832MM	1	32 mm			
36 mm	57.7 mm	268.2 mm	22.4 mm	2.6	1836MM	1	36 mm			
41 mm	63.0 mm	279.4 mm	24.1 mm	2.9	1841MM	1	41 mm			
46 mm	67.6 mm	287.3 mm	24.9 mm	3.5	1846MM	1	46 mm			
50 mm	67.6 mm	287.3 mm	24.9 mm	3.5	1850MM	1	50 mm			
55 mm	83.3 mm	304.8 mm	31.8 mm	5.2	1855MM	1	55 mm			
60 mm	86.6 mm	314.5 mm	36.6 mm	6.0	1860MM	1	60 mm			
65 mm	95.3 mm	322.3 mm	38.9 mm	6.6	1865MM	1	65 mm			
70 mm	105.9 mm	331.7 mm	38.9 mm	7.5	1870MM	1	70 mm			
75 mm	110.7 mm	341.4 mm	38.9 mm	7.9	1875MM	1	75 mm			
80 mm	113.8 mm	350.8 mm	41.1 mm	9.4	1880MM	1	80 mm			

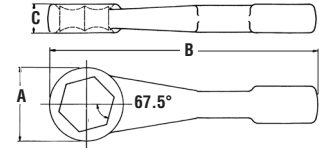

Roughneck "Hammer Wrench"
Straight Pattern — 6 Point
Alloy Steel — Drop Forged

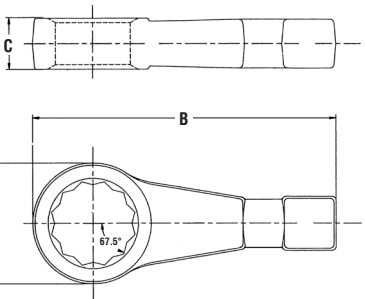

Roughneck "Hammer Wrench"
Straight Pattern — 12 Point
Alloy Steel — Drop Forged
SAE and Metric