

AIR COUPLERS & PLUGS

COUPLER/PLUG STYLES

- Milton® offers 11 different automotive & industrial styles
- Most styles are not interchangeable. However, couplers & plugs within the same style, from most manufacturers, will work together
- Milton®'s "Match-Up System" ensures that all couplers and plugs with the same letter code can be used together regardless of thread size
- Milton®'s 3-way couplers (page 5) simplify the process by working with A, M® & T style plugs
- Milton®'s 5 in ONE™ universal couplers (page 4) are the ultimate in versatility. They securely connect with A, M®, T, V & L style plugs
- Couplers & plugs are not D.O.T. certified

MILTON® INDUSTRIAL PLUG IDENTIFIER

<p>M-Style® Milton/Industrial Interchange</p> <p>$.211$ $\frac{1}{4}$" FLOW SIZE</p> <p>PAGE 6</p>	<p>V-Style High Flow/European Interchange</p> <p>$.185$ $\frac{1}{4}$" FLOW SIZE</p> <p>PAGE 9</p>	<p>A-Style ARO "210" Interchange</p> <p>$.325$ $\frac{1}{4}$" FLOW SIZE</p> <p>PAGE 10</p>
--	--	--

NOTE: PLUG PROFILES ARE ACTUAL SIZE

<p>T-Style Tru-flate/Parker Interchange</p> <p>$.085$ $\frac{1}{4}$" FLOW SIZE</p> <p>PAGE 11</p>	<p>L-Style Lincoln Interchange</p> <p>$.792$ $\frac{1}{4}$" FLOW SIZE</p> <p>PAGE 12</p>	<p>D-Style Diamond-U Interchange</p> <p>$.170$ $\frac{1}{4}$" FLOW SIZE</p> <p>PAGE 12</p>	<p>P-Style Tru-flate/Parker Interchange</p> <p>$.128$ $\frac{3}{8}$" FLOW SIZE</p> <p>PAGE 13</p>
<p>H-Style Milton/Industrial Interchange</p> <p>$.312$ $\frac{3}{8}$" FLOW SIZE</p> <p>PAGE 14</p>	<p>AA-Style ARO "310" Interchange</p> <p>$.589$ $\frac{3}{8}$" FLOW SIZE</p> <p>PAGE 14</p>	<p>G-Style (.125) Tru-flate/Parker Interchange</p> <p>$.125$ $\frac{1}{2}$" FLOW SIZE</p> <p>PAGE 15</p>	<p>G-Style (.375) Milton/Industrial Interchange</p> <p>$.375$ $\frac{1}{2}$" FLOW SIZE</p> <p>PAGE 15</p>

WARNING: FOR USE WITH COMPRESSED SHOP AIR ONLY. NOT FOR BREATHABLE AIR USE



AIR HANDLING CAPACITY

- Basic Flow Size defines the air flow capacity
- Please do not confuse Basic Flow Size with Thread Size
- Thread Size is not directly related to air flow capacity in any way

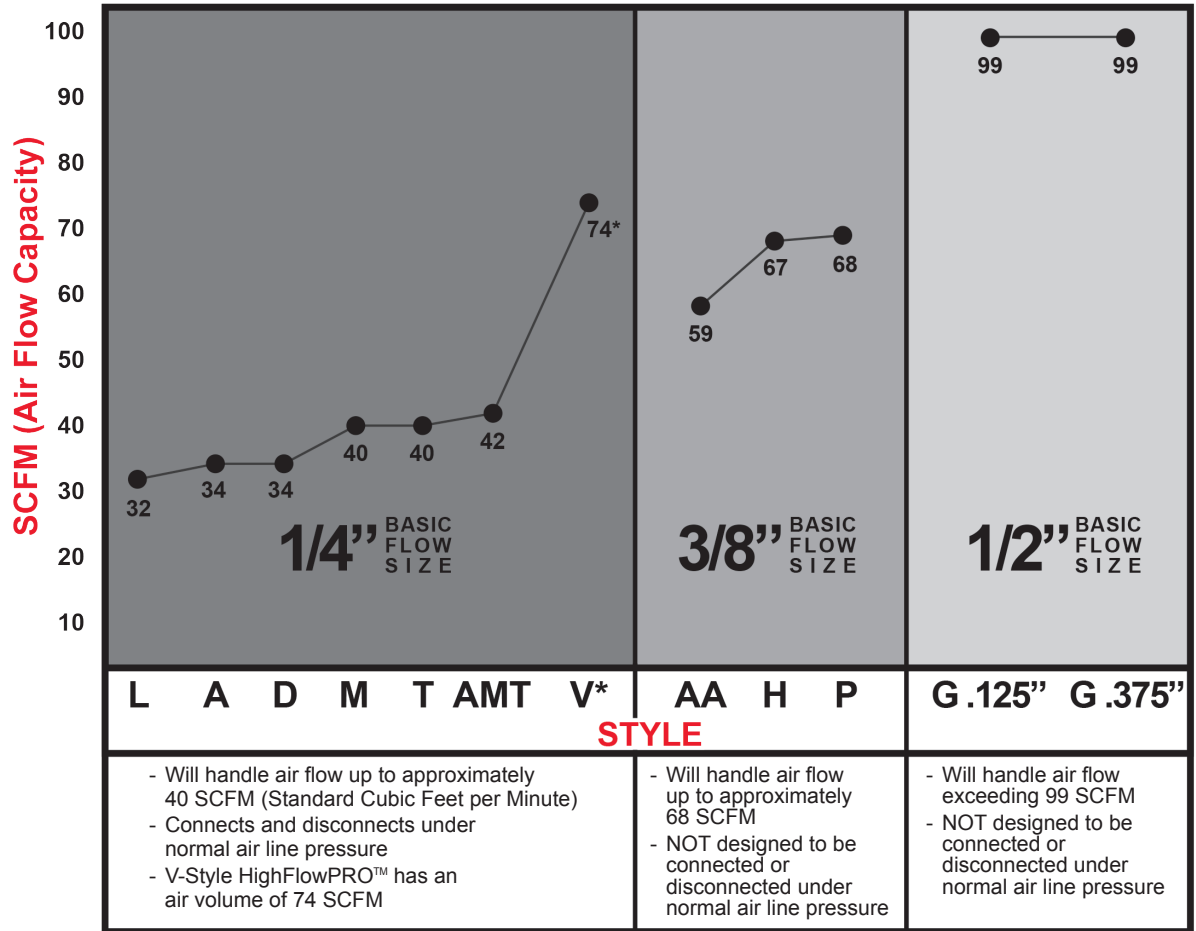

- Will handle air flow up to approximately 40 SCFM (Standard Cubic Feet per Minute)
- Connects and disconnects under normal air line pressure
- V-Style HighFlowPRO™ has an air volume of 74 SCFM

- Will handle air flow up to approximately 68 SCFM
- NOT designed to be connected or disconnected under normal air line pressure

- Will handle air flow exceeding 99 SCFM
- NOT designed to be connected or disconnected under normal air line pressure

*Low Pressure, High Volume

DEFINITION OF TERMS

DRAG GUARD



Protects couplers from accidental disconnection

PUSH-TYPE



Eliminates need to retract coupler sleeve to connect. Convenient and time saving option

PUSH-ON & LOCK

Push cut hose onto hose barb. Locks hose in place. Only for use with Push-on & Lock hose on page 24

RE-CAP

Recap plugs screw directly onto tire valves to allow for direct coupler connection and faster pressurization

G-STYLE TRU-FLATE/PARKER INTERCHANGE

There are two distinct G-Style plug profiles. Although different, both styles fully connect with all G-Style couplers

- 1/2" basic flow size
- 8 ball bearing connection
- G-Style couplers are steel, plated to resist rust
- G-Style plugs are case hardened steel, plated to resist rust
- Also known as "1/2" flow T-Style"
- Maximum inlet pressure: 300 PSI
- Maximum temperature: 250°F
- Air flow: 99 SCFM
- Seals: Buna-N

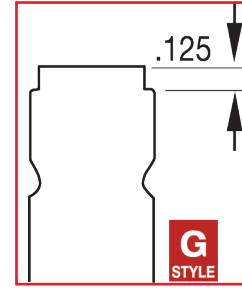

G-Style Couplers

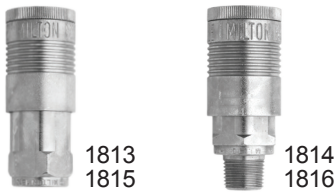

Boxed Part No.	Bulk Part No.	Retail Part No.	Per Card	NPT (in)	Product Specs	
					Connection	Body
1813				3/8"	Female	Plated Steel
1814					Male	
1815	1815BK	s-1815	1	1/2"	Female	
1816	1816BK	s-1816	1		Male	

G-Style Plugs



Boxed Part No.	Bulk Part No.	Retail Part No.	Per Card	NPT (in)	Product Specs	
					Connection	Material
1817	1817BK	s-1817	1	1/2"	Male	Zinc Chromate Coated Steel
1818	1818BK	s-1818	1		Female	
1819	1819BK			3/8"	Male	
1820					Female	

G-STYLE INDUSTRIAL INTERCHANGE

- 1/2" basic flow size
- G-Style couplers are steel plated to resist rust
- G-Style plugs are case hardened steel, plated to resist rust
- Also known as "1/2" flow M-Style®"
- Maximum inlet pressure: 300 PSI
- Maximum temperature: 250°F
- Air flow: 99 SCFM
- Seals: Buna-N

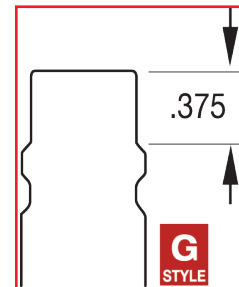

G-Style Steel Plugs



Boxed Part No.	Bulk Part No.	NPT (in)	Product Specs	
			Connection	Material
1855	1855BK	1/4"	Male	Case Hardened Plated Steel
1859	1859BK	3/8"		
1860			1/2"	
1857	1857BK	Female		
1858	1858BK			

G-Style 1/2" Coupler/Plug Kits



Kit Part No.	Kit includes (qty):				
	#1815	#1816	#1857	#1858	#652-8
s-224	1	1	1	1	1
s-1815-2	2				

