

# AIR COUPLERS & PLUGS

## COUPLER/PLUG STYLES

- Milton® offers 11 different automotive & industrial styles
- Most styles are not interchangeable. However, couplers & plugs within the same style, from most manufacturers, will work together
- Milton®'s "Match-Up System" ensures that all couplers and plugs with the same letter code can be used together regardless of thread size
- Milton®'s 3-way couplers (page 5) simplify the process by working with A, M® & T style plugs
- Milton®'s 5 in ONE™ universal couplers (page 4) are the ultimate in versatility. They securely connect with A, M®, T, V & L style plugs
- Couplers & plugs are not D.O.T. certified

## MILTON® INDUSTRIAL PLUG IDENTIFIER

**M-Style®**  
Milton/Industrial Interchange

$.211$   $\frac{1}{4}$ " FLOW SIZE

**PAGE 6**

**V-Style**  
High Flow/European Interchange

$.185$   $\frac{1}{4}$ " FLOW SIZE

**PAGE 9**

**A-Style**  
ARO "210" Interchange

$.325$   $\frac{1}{4}$ " FLOW SIZE

**PAGE 10**

NOTE: PLUG PROFILES ARE ACTUAL SIZE

**T-Style**  
Tru-flate/Parker Interchange

$.085$   $\frac{1}{4}$ " FLOW SIZE

**PAGE 11**

**L-Style**  
Lincoln Interchange

$.792$   $\frac{1}{4}$ " FLOW SIZE

**PAGE 12**

**D-Style**  
Diamond-U Interchange

$.170$   $\frac{1}{4}$ " FLOW SIZE

**PAGE 12**

**P-Style**  
Tru-flate/Parker Interchange

$.128$   $\frac{3}{8}$ " FLOW SIZE

**PAGE 13**

**H-Style**  
Milton/Industrial Interchange

$.312$   $\frac{3}{8}$ " FLOW SIZE

**PAGE 14**

**AA-Style**  
ARO "310" Interchange

$.589$   $\frac{3}{8}$ " FLOW SIZE

**PAGE 14**

**G-Style (.125)**  
Tru-flate/Parker Interchange

$.125$   $\frac{1}{2}$ " FLOW SIZE

**PAGE 15**

**G-Style (.375)**  
Milton/Industrial Interchange

$.375$   $\frac{1}{2}$ " FLOW SIZE

**PAGE 15**

WARNING: FOR USE WITH COMPRESSED SHOP AIR ONLY. NOT FOR BREATHABLE AIR USE



## AIR HANDLING CAPACITY

- Basic Flow Size defines the air flow capacity
- Please do not confuse Basic Flow Size with Thread Size
- Thread Size is not directly related to air flow capacity in any way

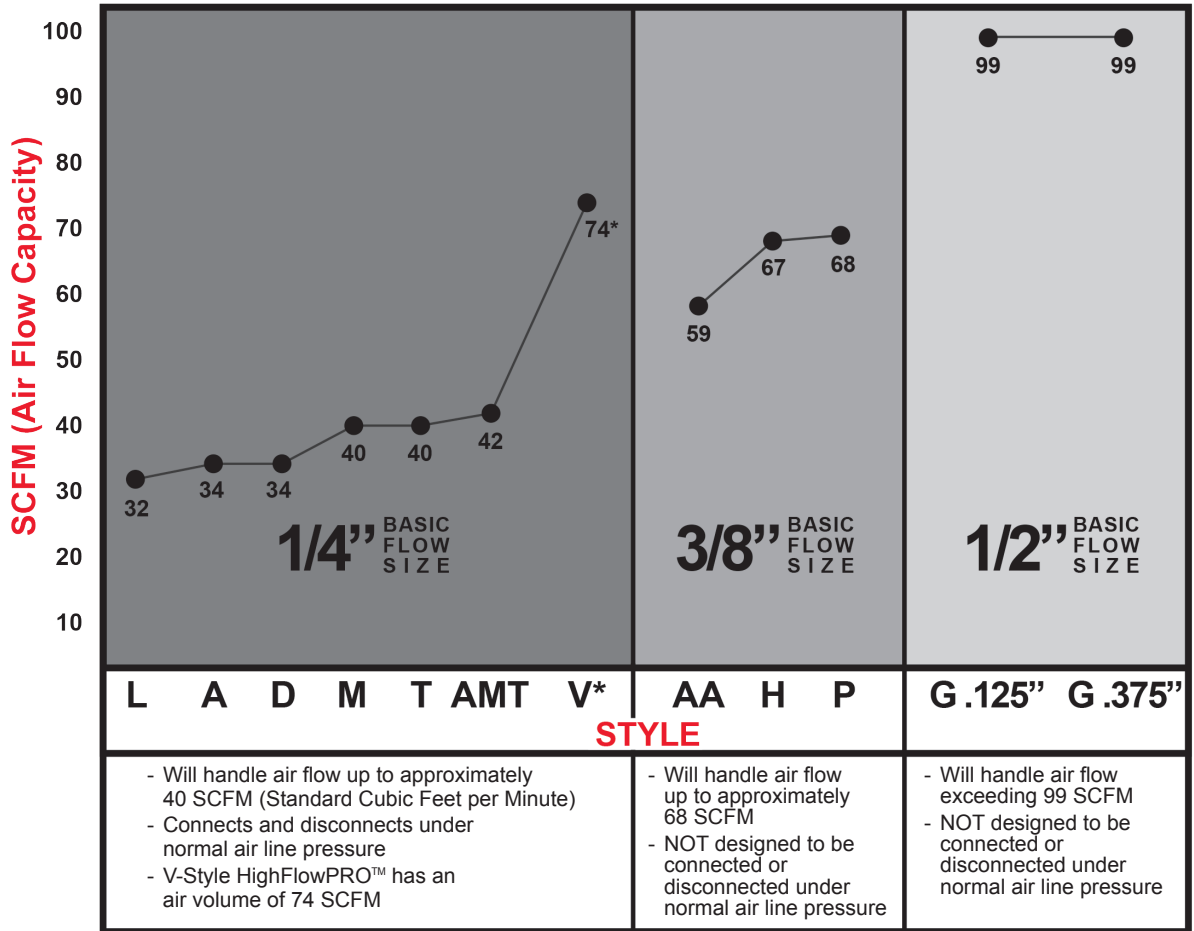

L A D M T AMT V*	AA H P	G.125" G.375"
<b>STYLE</b>		
<ul style="list-style-type: none"> <li>- Will handle air flow up to approximately 40 SCFM (Standard Cubic Feet per Minute)</li> <li>- Connects and disconnects under normal air line pressure</li> <li>- V-Style HighFlowPRO™ has an air volume of 74 SCFM</li> </ul>	<ul style="list-style-type: none"> <li>- Will handle air flow up to approximately 68 SCFM</li> <li>- NOT designed to be connected or disconnected under normal air line pressure</li> </ul>	<ul style="list-style-type: none"> <li>- Will handle air flow exceeding 99 SCFM</li> <li>- NOT designed to be connected or disconnected under normal air line pressure</li> </ul>

\*Low Pressure, High Volume

## DEFINITION OF TERMS

### DRAG GUARD



Protects couplers from accidental disconnection

### PUSH-TYPE



Eliminates need to retract coupler sleeve to connect. Convenient and time saving option

### PUSH-ON & LOCK

Push cut hose onto hose barb. Locks hose in place. Only for use with Push-on & Lock hose on page 24

### RE-CAP

Recap plugs screw directly onto tire valves to allow for direct coupler connection and faster pressurization

**HIGHFLOWPRO™**

**UP TO 75% MORE FLOW**

COUPLERS  
PLUGS  
CAM/GROOVE

HOSE  
HOSE REELS  
FITTINGS

BLO-GUNS

FRLS

PUSH-TO-CONNECT

INFLATOR GAGES

PRESSURE &  
SERVICE GAGES

GREASE GUNS

MERCHANDISERS

**V-STYLE HIGH FLOW/EUROPEAN INTERCHANGE**

**V-Style specifically designed for high volume and HVLP (High Volume Low Pressure) applications**

- Provides up to 75% MORE FLOW than standard couplers
- 6 ball bearing connection
- V-Style couplers are push-type for quicker connection
- Maximum inlet pressure: 300 PSI
- 1/4" basic flow size
- Maximum temperature: 250°F
- Air flow: 74 SCFM
- Seals: Buna-N

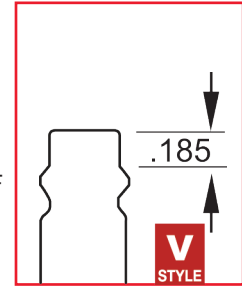

**V-Style HIGHFLOWPRO™ Hi-Flow Couplers**

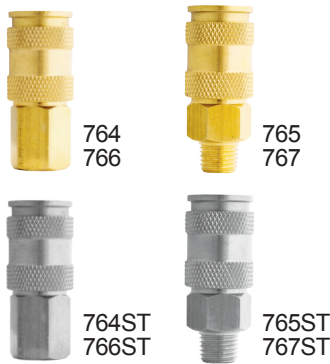

Boxed Part No.	Bulk Part No.	Retail Part No.	Per Card	NPT (in)	Product Specs			
					Connection	Body	Sleeve	Feature
764		s-764	1	1/4"	Female	Brass	Brass	Push-Type
765		s-765	1		Male			
766		s-766	1	3/8"	Female	Brass	Brass	
767		s-767	1		Male			
764ST	764STBK	s-764ST	1	1/4"	Female	Solid Steel	Steel	
765ST	765STBK	s-765ST	1		Male			
766ST	766STBK	s-766ST	1	3/8"	Female	Solid Steel	Steel	
767ST	767STBK	s-767ST	1		Male			

**NOTE:** V-Style couplers will accept M-Style® and A-Style plugs, however to retain maximum flow use V-Style plugs

**V-Style HIGHFLOWPRO™ Hi-Flow Plugs - Brass**



Boxed Part No.	Retail Part No.	Per Card	NPT (in)	Product Specs	
				Connection	Material
760	s-760	2	1/4"	Male	Solid Brass
761	s-761	2		Female	
762	s-762	2	3/8"	Male	
763	s-763	2		Female	

**NOTE:** The use of brass plugs with air tools will cause damage and premature wear on the couplers and plugs

**V-Style HIGHFLOWPRO™ Hi-Flow Plugs - Steel**



Boxed Part No.	Retail Part No.	Per Card	NPT (in)	Product Specs	
				Connection	Material
760-1	s-760-1	2	1/4"	Male	Case Hardened Steel
761-1	s-761-1	2		Female	
762-1	s-762-1	2	3/8"	Male	
763-1	s-763-1	2		Female	

**NOTE:** Steel plugs are highly recommended for use with any type of percussion tool such as impact tools, grinders, polishers, drills, etc.