



**LIFETIME  
WARRANTY**

Backed by a Lifetime Warranty, Sunex Impact Sockets are warranted against defects in materials and workmanship for the life of the product. This warranty does not apply to items that have been misused, abused, altered in any way, or worn out from use. Some Adapters, Reducers, and Extra Thin Wall Impact Sockets are sold with out of box warranty.

# IMPACT SOCKETS

Since 1984, we've led the market with our solution-based designs and quality materials. All of our Impact Sockets (low-profile, standard, deep, hex drivers, universal joint, specialty, and extensions/adapters) are backed by an industry-leading warranty, so you can rest easy knowing your sockets are guaranteed to perform.

# IMPACT SOCKETS

## HIGHEST QUALITY. HIGHEST STANDARDS.

### RADIUSED CORNERS

Focuses impact on fastener's flat surfaces, increasing torque and reducing wear and rounding to the fastener.

### DURABLE CR-MO STEEL

Precision manufactured with chrome-molybdenum steel for high-impact applications.

### HEAT TREATED / TEMPERED

Sockets are first heat treated to increase hardness and then tempered to maximize durability.



### SPECIALTY SOCKETS

Every job has its own challenges. We offer a wide selection of specialty sockets to handle anything the job calls for.

### METRIC

### SAE

1/4"  
DRIVE

3/8"  
DRIVE

1/2"  
DRIVE

3/4"  
DRIVE

1"  
DRIVE

### NO-SKIP SIZE SPECTRUM

Sunex Impact Socket Sets include every size in the specification range: Largest to smallest, and everything in between.

## 3/8" DRIVE INDIVIDUAL SAE SOCKETS

SIZE	STANDARD	DEEP	UNIVERSAL	DEEP UNIV.	MAGNETIC	12 POINT	12 PT UNIV.	12 PT. DEEP	12 PT. UNIV./DEEP
SAE	MODEL	MODEL	MODEL	MODEL	MODEL	MODEL	MODEL	MODEL	MODEL
1/4"					308MG				
5/16"	310	310D	310U	310UD	310MG	310Z	310UZ	36801	310ZUD
3/8"	312	312D	312U	312UD	312MG	312Z	312UZ	36802	312ZUD
7/16"	314	314D	314U	314UD	314MG	314Z	314UZ	36803	314ZUD
1/2"	316	316D	316U	316UD	316MG	316Z	316UZ	36804	316ZUD
9/16"	318	318D	318U	318UD	318MG	318Z	318UZ	36805	318ZUD
5/8"	320	320D	320U	320UD	320MG	320Z	320UZ	36806	
11/16"	322	322D	322U	322UD	322MG	322Z	322UZ	36807	
3/4"	324	324D	324U	324UD	324MG	324Z	324UZ	36808	
13/16"	326	326D	326U	326UD		326Z	326UZ	36809	
7/8"	328	328D	328U	328UD		328Z	328UZ	368010	
15/16"	330	330D				330Z	330UZ	368011	
1"	332	332D				332Z	332UZ	368012	

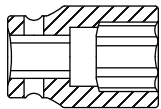

Standard

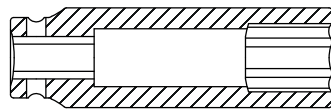

Deep

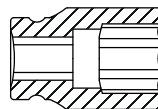

Magnetic

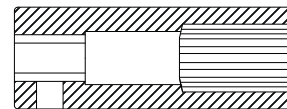

12 Point

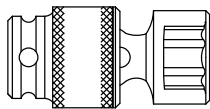

Universal

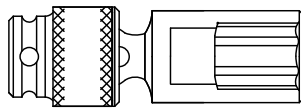

Deep Universal

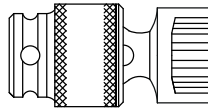

12 Point Universal

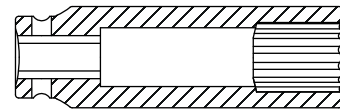

12 Point Deep

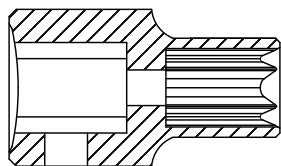

## 3/8" DRIVE INDIVIDUAL EXTERNAL STAR SOCKETS

MODEL	SIZE	MODEL	SIZE
304SE	E4	3670S35	E10
3670SE1	E5	3670SE6	E11
3670SE2	E6	3670SE7	E12
3670SE3	E7	3670SE8	E14
3670SE4	E8	3670SE9	E16

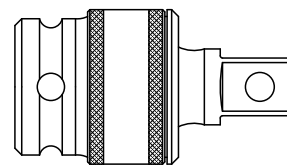

## 3/8" DRIVE INDIVIDUAL UNIVERSAL JOINT

MODEL	SIZE
3301	Universal Joint

## 3/8" DR. DEEP 6 POINT SAE

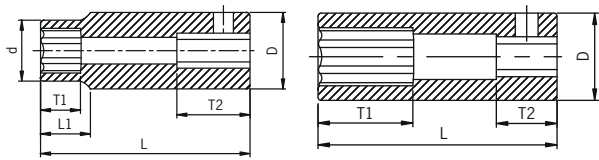

A

B

ITEM	SIZE	SHAPE	D	D	T1	T2	L1	L
310D	5/16"	A	12.6	19	12	14	13	64
312D	3/8"	A	14.6	19	18	14	13	65
314D	7/16"	A	17.1	19	18	14	13	65
316D	1/2"	B	/	19.7	22	14	/	65
318D	9/16"	B	/	20.7	24	14	/	65
320D	5/8"	B	/	23.5	25	14	/	65
322D	11/16"	B	/	24	25	14	/	65
324D	3/4"	B	/	26	25	14	/	65
326D	13/16"	B	/	28	25	14	/	65
328D	7/8"	B	/	30	25	14	/	65
330D	15/16"	B	/	32	25	14	/	65
332D	1"	B	/	34	25	14	/	65

## 3/8" DR. DEEP 6 POINT METRIC

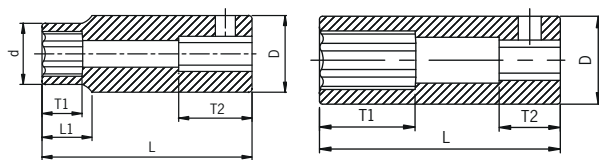

A

B

ITEM	SIZE	SHAPE	D	D	T1	T2	L1	L
307MD	7mm	A	11.4	19	12	14	13	63
308MD	8mm	A	12.7	19	12	14	13	64
309MD	9mm	A	14	19	12	14	13	65
310MD	10mm	A	15.2	19	18	14	13	65
311MD	11mm	A	17	19	18	14	13	65
312MD	12mm	B	/	19	20	14	/	65
313MD	13mm	B	/	19.7	22	14	/	65
314MD	14mm	B	/	20.7	24	14	/	65
315MD	15mm	B	/	22.2	25	14	/	65
316MD	16mm	B	/	24	25	14	/	65
317MD	17mm	B	/	24	25	14	/	65
318MD	18mm	B	/	25	25	14	/	65
319MD	19mm	B	/	26	25	14	/	65
320MD	20mm	B	28	28	25	14	/	63
321MD	21mm	B	/	28	25	14	/	65
322MD	22mm	B	/	30	25	14	/	65

## 3/8" DR. STANDARD 12 POINT SAE

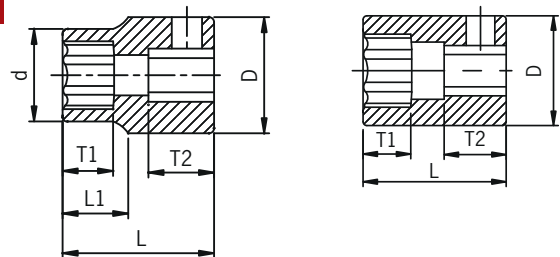

A

B

ITEM	SIZE	SHAPE	D	D	T1	T2	L1	L
310Z	5/16"	A	12.6	19	7	12	13	29.5
312Z	3/8"	A	14.6	19	8	12	13	29.5
314Z	7/16"	A	17.1	19	9	12	13	29.5
316Z	1/2"	B	/	19.7	9	12	/	29.5
318Z	9/16"	B	/	20.7	9	12	/	29.5
320Z	5/8"	B	/	23.5	11	12	/	29.5
322Z	11/16"	B	/	24	11	12	/	30
324Z	3/4"	B	/	26	13	15	/	30
326Z	13/16"	B	/	28	13	15	/	30
328Z	7/8"	B	/	30	13	15	/	30
330Z	15/16"	B	/	32	13	15	/	30
332Z	1"	B	/	34	13	15	/	30