



MODEL TR95/96

Removable Rim Bracket

Customer Service
(800) 247-7668

PARTS LIST					
Item	Qty	Description	Item	Qty	Description
A	1	Adapter Bracket	H	4	5/16" Flat Washer
B	1	Locking Pin	I	2	1/4" Roll Pins
C	1	Rim Removal Bushing	J	1	Top Pole
D	2	3/4" External Tooth Lock Washer	K	1	Bottom Pole
E	1	3/4" Jam Nut	L	1	Cotter Pin
F	4	5/16" x 2-1/2" S.F.M.S.	M	1	Rim *
G	4	5/16" Hex Nut	N	1	Net *
Note: *TR96 Only			O	4	5/16" Lock Washer

- ◆ Inspect all contents prior to installation. Report any missing parts to dealer immediately.
- ◆ Read all instructions before proceeding.

TOOLS/MATERIALS REQUIRED	
1 each Hammer	1 each Straight Blade Screwdriver
2 each Adjustable Wrenches	1 each 1/2" Wrench

Required for TR95, TR96

1. Mount *Adjustable Bracket (A)* to Backboard with *5/16" x 2-1/2" S.F.M.S. (F)*, *5/16" Flat Washers (H)*, *5/16" Lock Washers (O)* and *5/16" Hex Nuts (G)*. **(Figure 1)**
2. Slide rim into *Adjustable Bracket (A)* as far as possible. Then insert the *Locking Pin (B)* into the locking position. **(Figure 1 and 2)** The Locking Pin should be above brace as shown. Insert *Cotter Pin (L)* on other side of Locking Pin, or use a padlock (not provided).

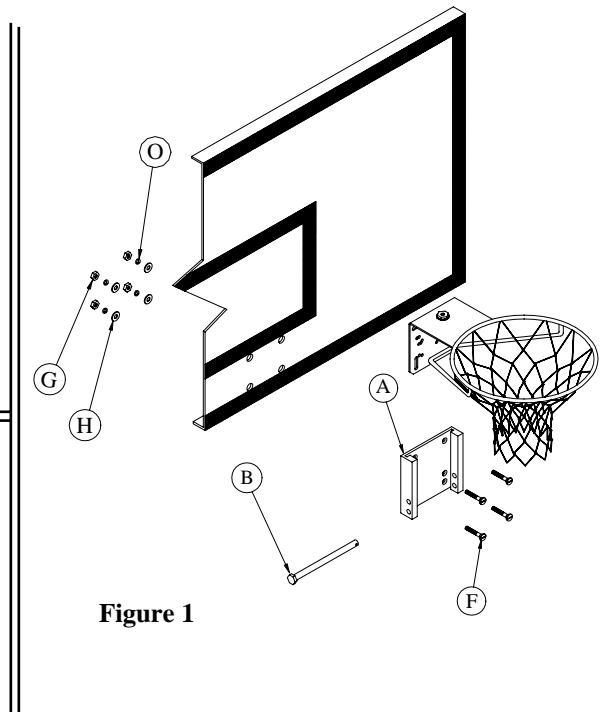

Figure 1

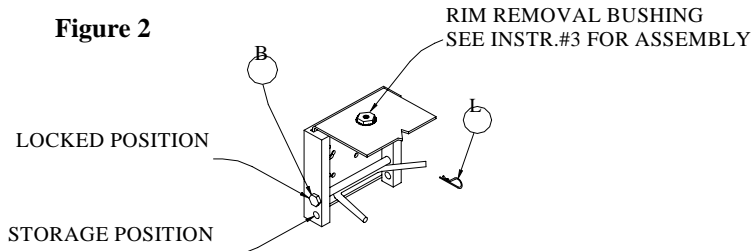
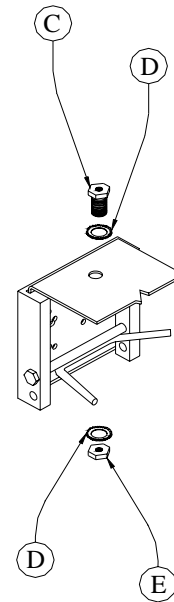

Figure 2

3. Install Rim Removal Bushing on rim by inserting the *Rim Removal Bushing* (C) thru the 3/4" hole in the top of the rim. Fasten it tightly with the 3/4" *External Tooth Lock Washer* (D) and the 3/4" *Jam Nut* (E). (Figure 3)

Warning!!! Rim Removal Bushing (Item C) must be as tight as possible to prevent injury when removing the rim.

Figure 3



Required for TR95, TR96

4. Assemble Removal Pole by inserting the *Top Pole* (J) into the *Bottom Pole* (K) until both 1/4" holes align. Insert a 1/4" *Roll Pin* (I) into each hole and tap lightly with a hammer until the Roll Pin is flush with the surface of the Bottom Pole. (Figure 4)

Note: Use Caution inserting Roll Pins. Do not bend as alignment of holes in Removal Pole is critical!

Figure 4

