

Die Cut Handle Bags

100% Recycled Kraft, Kraft and White Virgin Paper

Performance Features

- Dubl Life® bag made from 100% Recycled Paper
- Dubl Life bag is FSC chain of custody certified
- Large rectangular flat bottom creates stable carrier for platters and clam shell packaging
- Die cut handles create easy-carrying feature that supports stability and convenience
- 3/4 die cut handle creates a built-in locking system that allows the bag to be easily picked up and carried.

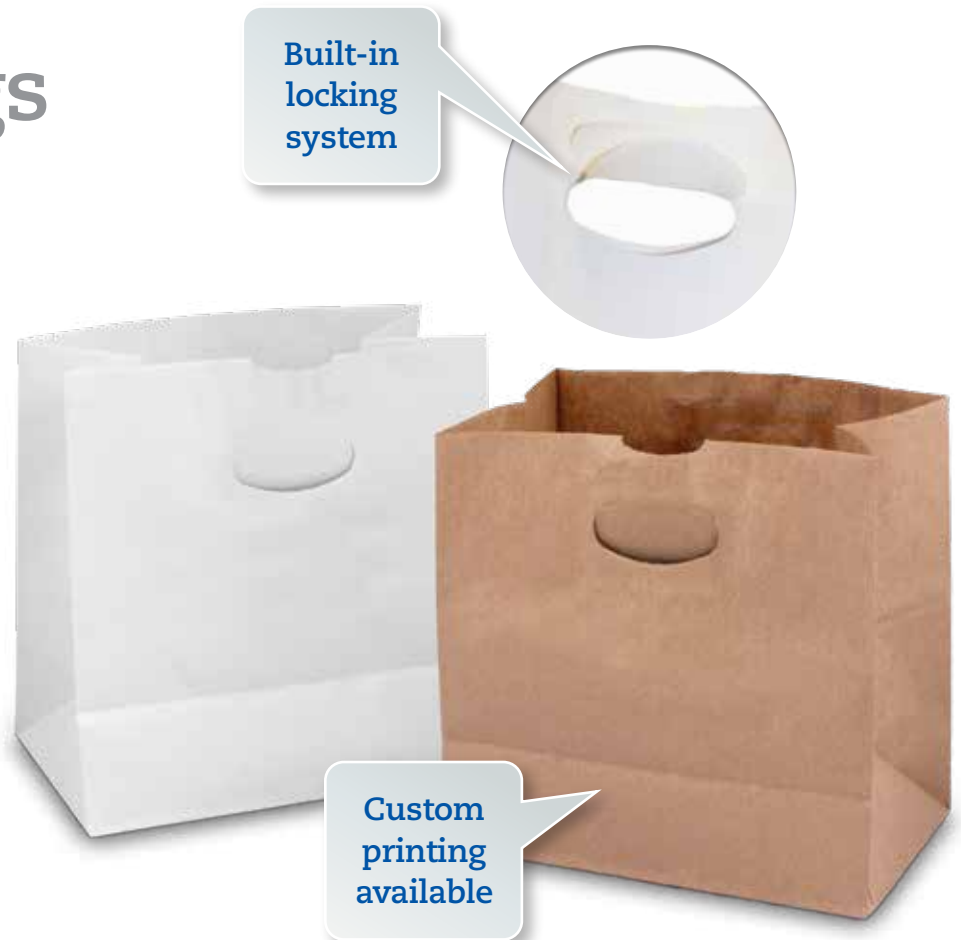

Item#	UPC	Bag Size / Description	Dimensions	Basis Weight	Bale Pack	Pack Config.	Bales/Pallet	Ti/Hi	Bale Weight (lbs.)	Bale Dimensions L x W x H	Cubic	Load Dimensions
18077	079594180771	Dubl Life ¾ Die Cut Handle	11 x 6 x 11	40	500	1/500	36	9x4	27.83	16 x 13 x 11.5	1.38	48 x 41 x 45
83862	079594838627	¾ Die Cut Handle White	11 x 6 x 11	40	500	1/500	36	9x4	28	17.5 x 11.5 x 10.5	1.38	48 x 41 x 45
84245	079594842457	¾ Die Cut Handle Kraft	11 x 6 x 11	40	500	1/500	36	9x4	28	17.5 x 11.5 x 10.5	1.38	48 x 41 x 45

* plastic patch on die cut handle must be removed before recycling/composting