

WALL SERVICE BENCH

3210K, 3220K, 3230K, & 3240K SERIES

ASSEMBLY INSTRUCTIONS

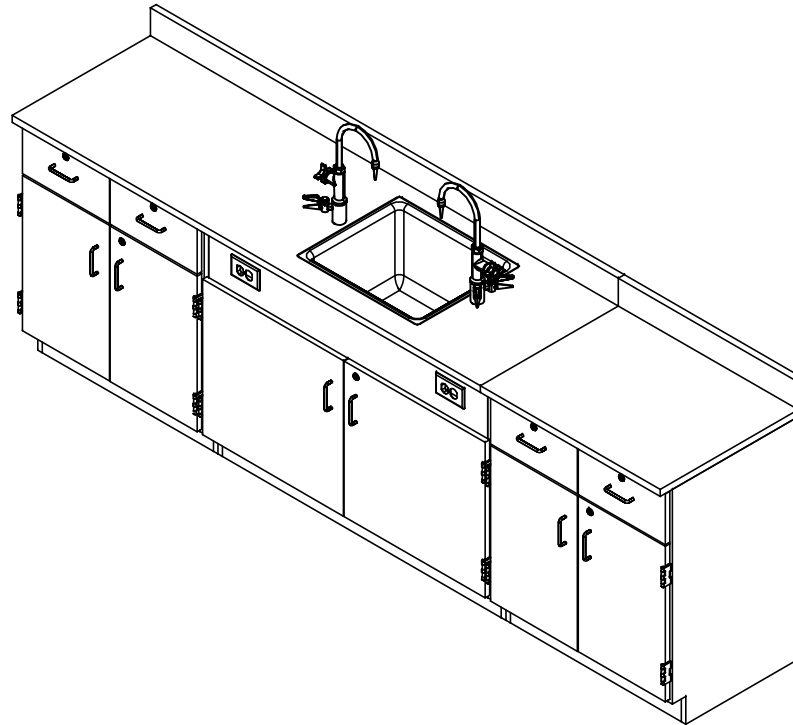

NOTE:

1. MODEL VIEWS MAY NOT REPRESENT EXACT MODEL PURCHASED

DWN BY:	EMK	DWN DATE:	4/13/15
APR BY:		DATE APR:	
APR BY:		DATE APR:	

UNLESS OTHERWISE SPECIFIED
DIMENSION ARE IN INCHES
CABINET SQUARENESS ± .0625
FRACTIONAL VALUES ± 1/32"
- ALL VALUES ± OVERALL -



300 South Krueger Street
Suring, WI 54174
diversifiedwoodcrafts.com

TITLE:
**WALL SERVICE BENCH
ASSEMBLY INSTRUCTIONS**

A	DESCRIPTION	DATE	NAME	ECN NO.
REV.				

REVISION LEVEL

THIS DRAWING IS THE SOLE PROPERTY OF
DIVERSIFIED WOOD CRAFTS. IT MAY NOT
BE ALTERED OR CHANGED WITHOUT
PERMISSION

DRAWING NUMBER:

WALL SERVICE BENCH

SCALE:

NTS

SHEET:

1 OF 4

REVISION:

REV A

TOOLS REQUIRED

CONTACT CEMENT
PHILLIPS SCREW DRIVER
1/8" DRILL BIT
1/2" AND 3/16" WRENCHES
C-CLAMPS
SHIM STOCK (IF NEEDED)

ASSEMBLY COMPONENTS

ITEMS INCLUDED	PART #	PART DESCRIPTION	QTY
INNER CABINET	N/A	B81 - 48"W X 22"D X 35"H	1
OUTER CABINETS	N/A	B03, B06, B10, B16, AND/OR B21 - 30"W X 22"D X 35"H	2
TOP	VARIES	TOP(STYLE VARIES), 1.00X78X24,BLK,FIXT	1
TOP	VARIES	TOP(STYLE VARIES), 1.00X30X24,BLK,FLAT	1
TOP - BACKSPLASH	VARIES	TOP(STYLE VARIES), 1.00X78X4,BLK,FLAT	1
TOP - BACKSPLASH	VARIES	TOP(STYLE VARIES), 1.00X30X4,BLK,FLAT	1
SILICONE	100711	SILICONE,SEALANT,CLEAR	2
FIXTURE - FAUCETS	100074-BKR	FIXTURE,L65-WSA-DIV(MULTI-SERVICE)	2
FIXTURE - SINK	100699	SINK,EPOXY L30,BLK	1
FIXTURE - SINK TRAP	100056	SINK TRAP,PLASTIC ADJUSTABLE	1
FIXTURE - SINK STOPPER	100112	SINK STOPPER 1 1/2,BLK	1
FIXTURE - STRAINER	100055	SINK,OUTLET/STRAINER EPOXY, BLK	1
ELECTRICAL BOX	100033	ELECTRICAL BOX 3.00X2X2.50 DEEP	2
ELECTRICAL OUTLET	100034	ELEC,OUTLET,GFI,20A 125V, BLK	2
RUBBER BASE MOLDING	100283	RUBBER BASE MOLDING (SOLD BY FOOT)	12.50
STAINLESS STEEL CORNERS	100057	CORNERS-STAINLESS STEEL,BASE	2
SCREWS - BASE	100064	SCREW,#6X1/2 PTH SMS SS SCREW	8

NOTE:

- TOPS ARE EITHER EPOXY OR PHENOLIC.

DWN BY:	EMK	DWN DATE:	4/13/15
APR BY:		DATE APR:	
APR BY:		DATE APR:	

UNLESS OTHERWISE SPECIFIED
DIMENSION ARE IN INCHES
CABINET SQUARENESS ± .0625
FRACTIONAL VALUES ± 1/32"
- ALL VALUES ± OVERALL -



300 South Krueger Street
Suring, WI 54174
diversifiedwoodcrafts.com

TITLE:
WALL SERVICE BENCH
TOOLS AND ASSEMBLY COMPONENTS

A	DESCRIPTION	DATE	NAME	ECH NO.
	CREATED ASSEMBLY INSTRUCTIONS	4/13/15	EMK	-
REV.				

THIS DRAWING IS THE SOLE PROPERTY OF
DIVERSIFIED WOOD CRAFTS. IT MAY NOT
BE ALTERED OR CHANGED WITHOUT
PERMISSION

DRAWING NUMBER:	SCALE:	SHEET:	REVISION:
WALL SERVICE BENCH	NTS	2 OF 4	REV A

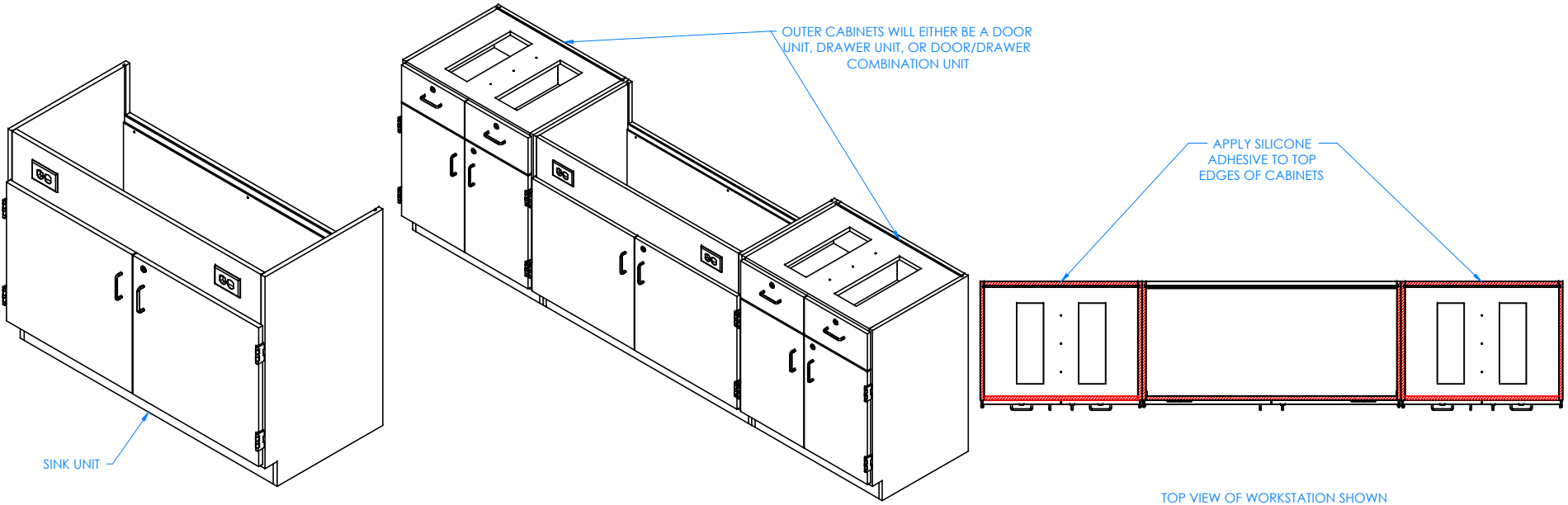

STEP 1:
CENTER THE SINK CABINET OVER THE UTILITY HOOK-UPS.

STEP 2:
POSITION THE OTHER TWO CABINETS ON EITHER SIDE OF SINK CABINET. MAKE SURE ALL CABINETS ARE TIGHT TOGETHER. FASTEN CABINETS TO WALL. NOTE: CABINETS MUST BE LEVELED OR DOORS AND DRAWERS MAY NOT OPEN OR CLOSE CORRECTLY.

STEP 3:
APPLY SILICONE ADHESIVE TO TOP EDGES OF CABINETS. POSITION TOP OVER CABINETS. MAKE SURE ONE CUT EDGE OF THE TOP IS FLUSH WITH THE EDGE OF THE SINK CABINET. APPLY A BEAD OF ADHESIVE TO THE TWO EDGES OF TOPS AND PRESS FIRMLY TO CONNECT TOPS TOGETHER. BE SURE TOP IS TIGHT AGAINST WALL. CLAMP THE TOP TO THE RAIL/BASE EVERY 12" TO REMOVE ANY WARP, USING SHIMS AND C-CLAMPS, IF NEEDED, WHEN ALIGNING TOPS (DO THIS BEFORE ADHESIVE ON CABINET EDGES SETS UP). LET CURE FOR 6-12 HOURS.

NOTE:
1.

DWN BY:	EMK	DWN DATE:	4/13/15
APR BY:		DATE APR:	
APR BY:		DATE APR:	

UNLESS OTHERWISE SPECIFIED DIMENSION ARE IN INCHES
CABINET SQUARENESS ± .0625
FRACTIONAL VALUES ± 1/32"
- ALL VALUES ± OVERALL -



300 South Krueger Street
Suring, WI 54174
diversifiedwoodcrafts.com

TITLE:
WALL SERVICE BENCH
ASSEMBLY INSTRUCTIONS

REV.	DESCRIPTION	DATE	NAME	ECH NO.
A	CREATED ASSEMBLY INSTRUCTIONS	4/13/15	EMK	-
REVISION LEVEL				

THIS DRAWING IS THE SOLE PROPERTY OF DIVERSIFIED WOOD CRAFTS. IT MAY NOT BE ALTERED OR CHANGED WITHOUT PERMISSION

DRAWING NUMBER:	SCALE:	SHEET:	REVISION:
WALL SERVICE BENCH	NTS	3 OF 4	REV A

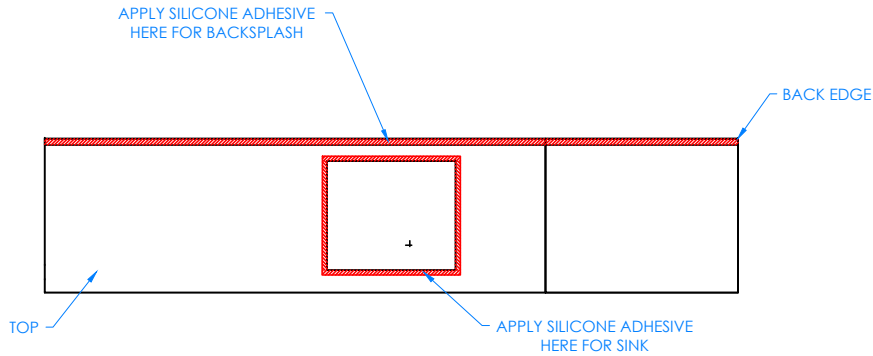

TOP VIEW OF WORKSTATION SHOWN

STEP 4:

APPLY SILICONE ADHESIVE TO THE CUT EDGE OF THE BACKSPASH. POSITION IT ON THE BACK EDGE OF THE TOP ALONG THE WALL. APPLY A BEAD OF ADHESIVE ON THE EDGES OF THE BACKSPASH WHERE THE TWO SECTIONS MEET. MAKE SURE BACKSPASH IS TIGHT AGAINST THE WALL AND ON CABINET TOP. APPLY THE ADHESIVE TO THE SINK OPENING ON TOP. LOWER SINK INTO OPENING. WIPE OFF ANY EXCESS CAULK AND ALLOW TO SET. LET CURE FOR 6-12 HOURS.

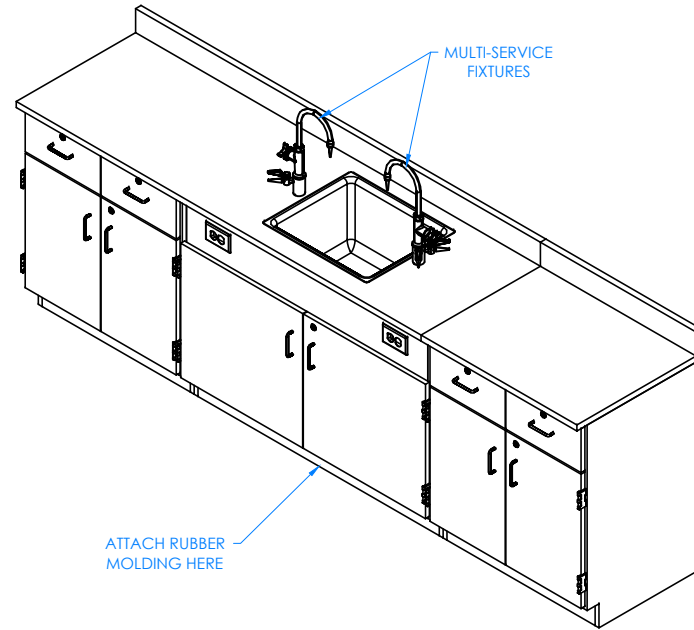

COMPLETE UNIT SHOWN

STEP 5:

INSTALL THE MULTI-SERVICE FIXTURES IN THE HOLES PROVIDED ON TOP. ATTACH RUBBER BASE MOLDING TO BASE OF CABINET USING CONTACT CEMENT. AFTER MOLDING IS IN PLACE, SCREW STAINLESS STEEL CORNER BRACKETS ON EACH CORNER OVER THE BASE MOLDING WITH SCREWS PROVIDED.

NOTE:

1. ALL WATER, ELECTRICAL, AND GAS CONNECTIONS SHOULD BE PERFORMED BY A TRAINED PROFESSIONAL PER LOCAL CODE.

DWN BY:	EMK	DWN DATE:	4/13/15
APR BY:		DATE APR:	
APR BY:		DATE APR:	

UNLESS OTHERWISE SPECIFIED DIMENSION ARE IN INCHES
 CABINET SQUARENESS ± .0625
 FRACTIONAL VALUES ± 1/32"
 - ALL VALUES ± OVERALL -



300 South Krueger Street
 Suring, WI 54174
 diversifiedwoodcrafts.com

TITLE:
**WALL SERVICE BENCH
 ASSEMBLY INSTRUCTIONS**

A	CREATED ASSEMBLY INSTRUCTIONS	4/13/15	EMK	-
REV.	DESCRIPTION	DATE	NAME	ECH NO.

REVISION LEVEL

THIS DRAWING IS THE SOLE PROPERTY OF
 DIVERSIFIED WOOD CRAFTS. IT MAY NOT
 BE ALTERED OR CHANGED WITHOUT
 PERMISSION

DRAWING NUMBER:	SCALE:	SHEET:	REVISION:
WALL SERVICE BENCH	NTS	4 OF 4	REV A