

# TWO STATION DRAWING TABLE

DT-80A, DT-82A, & DTA-21A  
ASSEMBLY INSTRUCTIONS

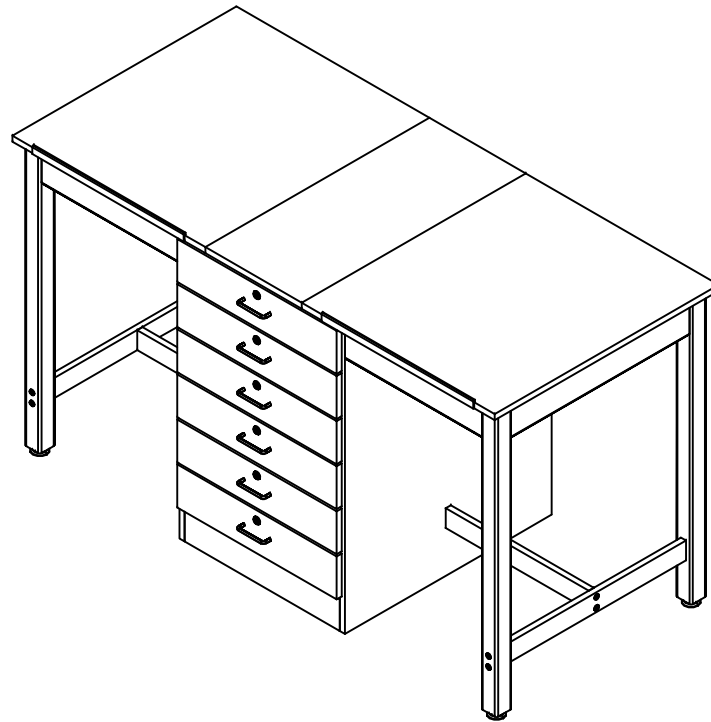

**NOTE:**

1. MODEL VIEWS MAY NOT REPRESENT EXACT MODEL PURCHASED

DWN BY:	EMK	DWN DATE:	1/7/15
APR BY:		DATE APR:	
APR BY:		DATE APR:	

UNLESS OTHERWISE SPECIFIED  
DIMENSION ARE IN INCHES  
CABINET SQUARENESS ± .0625  
FRACTIONAL VALUES ± 1/32"  
- ALL VALUES ± OVERALL -



300 South Krueger Street  
Suring, WI 54174  
diversifiedwoodcrafts.com

TITLE:  
TWO STATION DRAWING TABLE  
ASSEMBLY INSTRUCTIONS

REV.	DESCRIPTION	DATE	NAME	ECH NO.
A	CREATED ASSEMBLY INSTRUCTIONS	1/7/15	EMK	-
REVISION LEVEL				

THIS DRAWING IS THE SOLE PROPERTY OF  
DIVERSIFIED WOOD CRAFTS. IT MAY NOT  
BE ALTERED OR CHANGED WITHOUT  
PERMISSION

DRAWING NUMBER:	SCALE:	SHEET:	REVISION:
DT-80A, DT-82A, & DTA-21A	NTS	1 OF 5	REV A

## TOOLS REQUIRED

1/2" WRENCH
1/2" SOCKET AND TORQUE WRENCH - OPTIONAL
4MM ALLEN WRENCH

## ASSEMBLY COMPONENTS

ITEMS INCLUDED	PART #	PART DESCRIPTION	QTY
TOP AND APRON ASSEMBLIES	N/A	TOP ASSEMBLY (FACTORY ASSEMBLED)	2
CABINET	N/A	CABINET - SIZE VARIES	1
LEGS	VARIES	LEG,MPL - HEIGHT VARIES	4
LEG HARDWARE	520001-4	LEG HARDWARE KIT, 4 LEGS	1
LEG BRACE	N/A	LEG BRACE - SIZE VARIES	2
STRETCHER	N/A	STRETCHER - SIZE VARIES	2
CONFIRMATS - LEGS	227578	SCREW,7MMX90MM,CONN,ALLENHEAD, BLACK	8
CONFIRMATS - STRETCHER	228564	SCREW,7MMX50MM,CONN,ALLENHEAD, BLACK	8
BOLT - INTERNAL APRON	231922	BOLT, 3/8 -16X1.625 HEX HEAD	4
WASHER - INTERNAL APRON	100451	WASHER,5/16 FLAT ZINC PLATED	4
PENCIL LEDGE	14-0027	PENCIL LEDGE	2
SCREWS - PENCIL LEDGE	236263	SCREW,#6X3/4 TRUSS HEAD,QUAD BLACK	6

**NOTE:**

1.

DWN BY:	EMK	DWN DATE:	1/7/15
APR BY:		DATE APR:	
APR BY:		DATE APR:	

UNLESS OTHERWISE SPECIFIED  
DIMENSION ARE IN INCHES  
CABINET SQUARENESS ± .0625  
FRACTIONAL VALUES ± 1/32"  
- ALL VALUES ± OVERALL -



300 South Krueger Street  
Suring, WI 54174  
diversifiedwoodcrafts.com

TITLE:  
TWO STATION DRAWING TABLE  
TOOLS AND ASSEMBLY COMPONENTS

REV.	DESCRIPTION	DATE	NAME	ECH NO.
A	CREATED ASSEMBLY INSTRUCTIONS	1/7/15	EMK	-

THIS DRAWING IS THE SOLE PROPERTY OF  
DIVERSIFIED WOOD CRAFTS. IT MAY NOT  
BE ALTERED OR CHANGED WITHOUT  
PERMISSION

DRAWING NUMBER:	SCALE:	SHEET:	REVISION:
DT-80A, DT-82A, & DTA-21A	NTS	2 OF 5	REV A

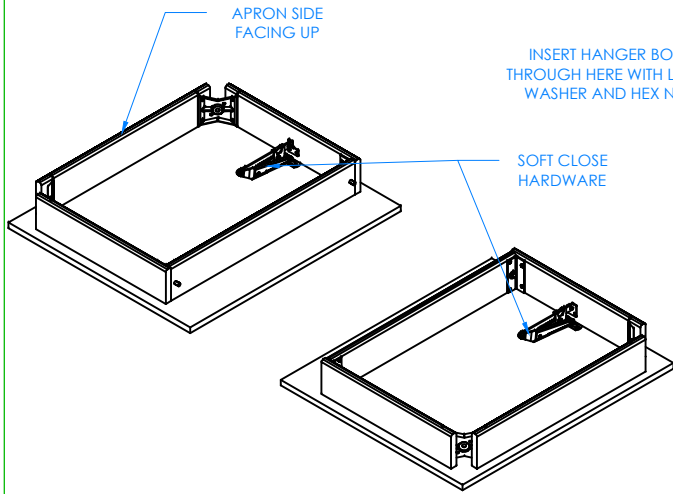

STEP 1:  
LAY THE TWO TOP ASSEMBLIES ON THE FLOOR WITH APRON SIDE FACING UP. BE SURE TOP ASSEMBLIES ARE ON A CLEAN SURFACE TO PREVENT DAMAGE.

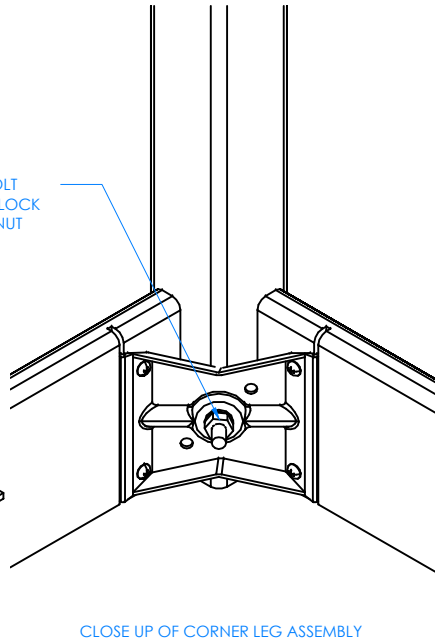

STEP 2:  
INSERT HANGER BOLT ON ONE OF THE LEGS THROUGH THE CORNER BRACKET AND INSERT LOCK WASHER AND HEX NUT. USING A 1/2" WRENCH OR 1/2" SOCKET AND TORQUE WRENCH, SCREW ON THE NUT BUT DO NOT TIGHTEN ALL THE WAY. REPEAT FOR OTHER 3 LEGS. NOTE: THE TWO LEGS WITH A CHAMFER MUST GO ON THE FRONT OF THE TABLE WITH CHAMFERED EDGES FACING OUT.

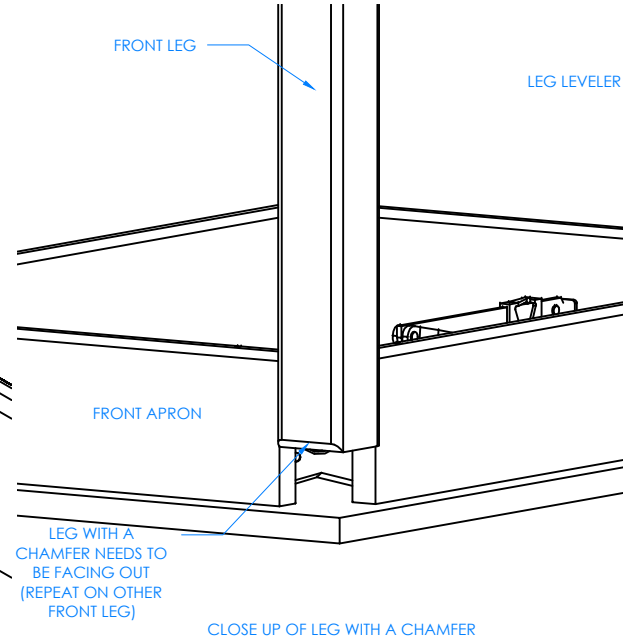

STEP 3:  
SCREW LEG LEVELERS INTO T-NUT ON BOTTOM OF LEGS.

NOTE:  
1.

DWN BY:	EMK	DWN DATE:	1/7/15
APR BY:		DATE APR:	
APR BY:		DATE APR:	

UNLESS OTHERWISE SPECIFIED DIMENSION ARE IN INCHES  
CABINET SQUARENESS ± .0625  
FRACTIONAL VALUES ± 1/32"  
- ALL VALUES ± OVERALL -



300 South Krueger Street  
Suring, WI 54174  
diversifiedwoodcrafts.com

TITLE:  
TWO STATION DRAWING TABLE  
ASSEMBLY INSTRUCTIONS

REV.	DESCRIPTION	DATE	NAME	ECH NO.
A	CREATED ASSEMBLY INSTRUCTIONS	1/7/15	EMK	-
REVISION LEVEL				

THIS DRAWING IS THE SOLE PROPERTY OF DIVERSIFIED WOOD CRAFTS. IT MAY NOT BE ALTERED OR CHANGED WITHOUT PERMISSION

DRAWING NUMBER:	SCALE:	SHEET:	REVISION:
DT-80A, DT-82A, & DTA-21A	NTS	3 OF 5	REV A

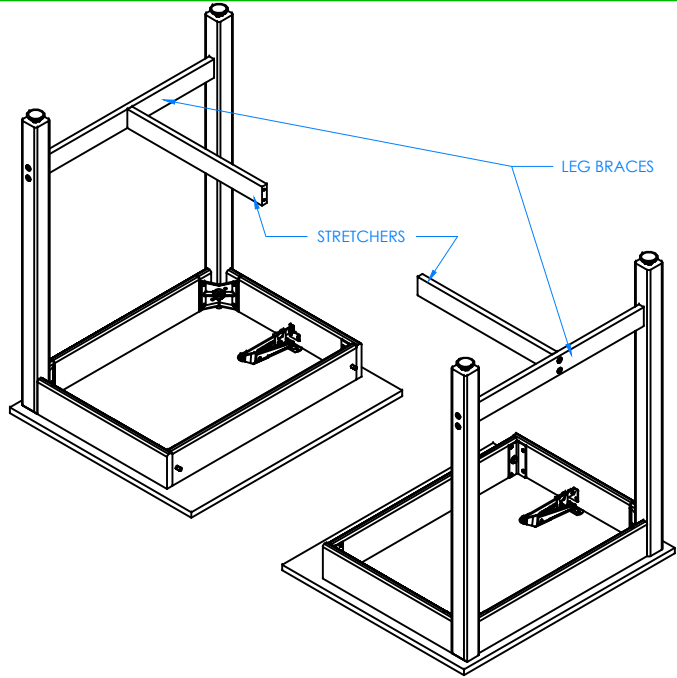

STEP 4:

USING A 4MM ALLEN WRENCH, INSERT THE CONFIRMATS INTO ONE LEG AND SCREW INTO BRACE. REPEAT FOR THE OTHER LEGS. MAKE SURE BRACES ARE STRAIGHT AND CONFIRMATS ARE TIGHT. ATTACH STRETCHERS TO THE BRACES USING CONFIRMATS PROVIDED. GO BACK TO STEP 2 AND TIGHTEN UP THE HANGER BOLTS FOR EACH LEG USING A 1/2" WRENCH OR 1/2" SOCKET AND TORQUE WRENCH, TO A MINIMUM OF 12FT LBS BUT NOT TO EXCEED 17FT LBS.

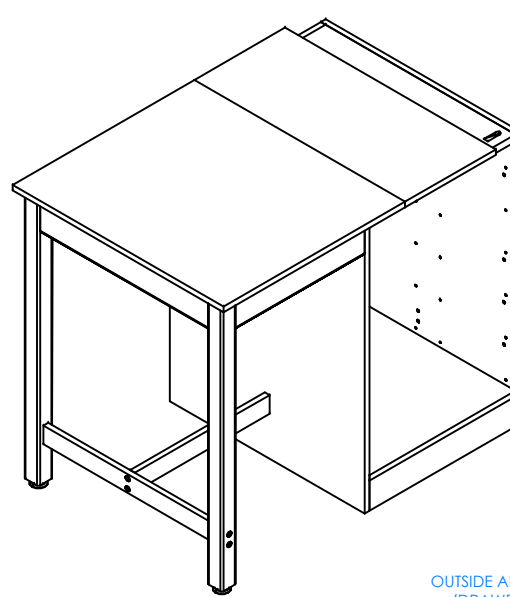

STEP 5:

FLIP ONE APRON ASSEMBLY OVER ONTO THE LEGS. ALIGN THE HOLES UP ON THE STRETCHER TO THE HOLES ON LEFT SIDE OF CABINET. TAKE OUT DRAWERS TO ATTACH STRETCHER FROM INSIDE THE CABINET. SCREW CONFIRMATS INTO STRETCHER. REPEAT PROCESS FOR OTHER APRON ASSEMBLY.

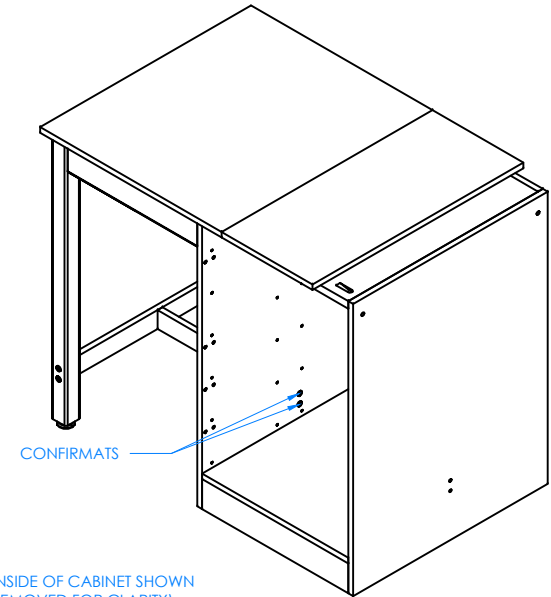

OUTSIDE AND INSIDE OF CABINET SHOWN (DRAWERS REMOVED FOR CLARITY)

NOTE:

- 1.

DWN BY:	EMK	DWN DATE:	1/7/15
APR BY:		DATE APR:	
APR BY:		DATE APR:	



300 South Krueger Street  
Suring, WI 54174  
diversifiedwoodcrafts.com

UNLESS OTHERWISE SPECIFIED  
DIMENSION ARE IN INCHES  
CABINET SQUARENESS ± .0625  
FRACTIONAL VALUES ± 1/32"  
- ALL VALUES ± OVERALL -

TITLE:  
TWO STATION DRAWING TABLE  
ASSEMBLY INSTRUCTIONS

A	CREATED ASSEMBLY INSTRUCTIONS	1/7/15	EMK	-
REV.	DESCRIPTION	DATE	NAME	ECH NO.

REVISION LEVEL

THIS DRAWING IS THE SOLE PROPERTY OF  
DIVERSIFIED WOOD CRAFTS. IT MAY NOT  
BE ALTERED OR CHANGED WITHOUT  
PERMISSION

DRAWING NUMBER:	SCALE:	SHEET:	REVISION:
DT-80A, DT-82A, & DTA-21A	NTS	4 OF 5	REV A

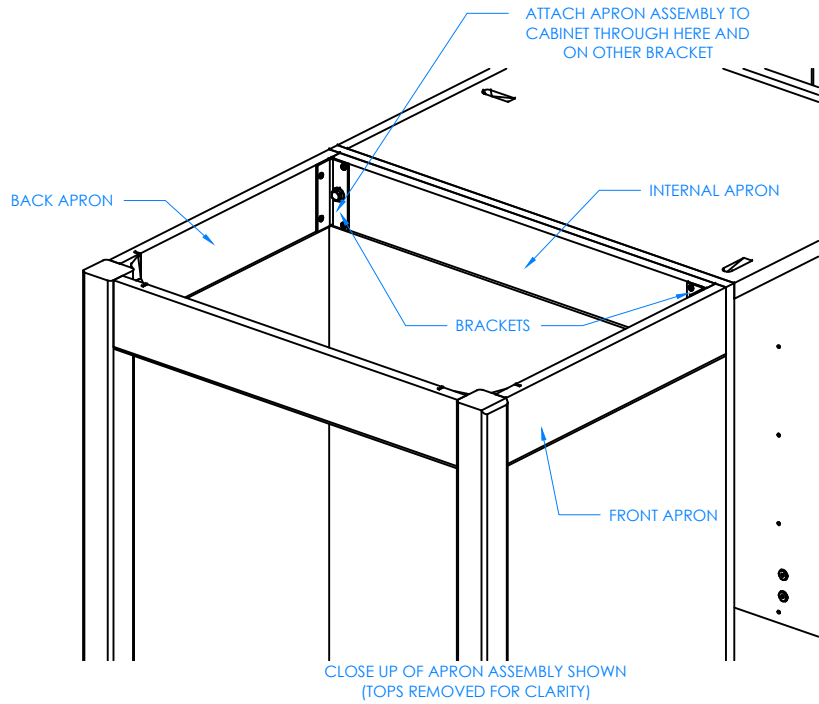

STEP 6:

POSITION ONE APRON ASSEMBLY SO INNER HOLES OF THE BRACKETS ON INTERNAL APRON ARE LINED UP WITH THE TWO HOLES ON LEFT SIDE OF CABINET (FRONT APRON WILL BE FLUSH WITH FRONT OF CABINET AND BACK APRON WILL BE FLUSH WITH BACK OF CABINET). INSERT THE TWO BOLTS AND WASHERS THAT ARE PROVIDED INTO THOSE HOLES AND TIGHTEN. ADJUST LEG LEVELERS TO LEVEL APRON ASSEMBLY WITH THE CABINET.

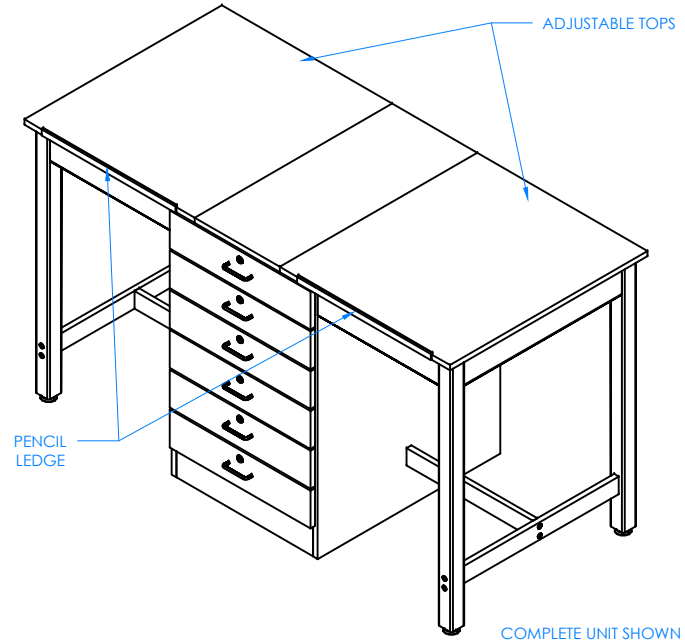

STEP 7:

LINE UP PENCIL LEDGE ON SIDE OF ADJUSTABLE TOPS IN DESIRED LOCATION. SCREW PENCIL LEDGE TO TOP USING SCREWS PROVIDED. HOLES NEED TO BE PREDRILLED TO PREVENT TOP FROM SPLITTING. SET YOUR TABLE IN PLACE AND PUT DRAWERS BACK IN.

NOTE:

- 1.

DWN BY:	EMK	DWN DATE:	1/7/15
APR BY:		DATE APR:	
APR BY:		DATE APR:	

 300 South Krueger Street  
 Suring, WI 54174  
 diversifiedwoodcrafts.com

UNLESS OTHERWISE SPECIFIED  
 DIMENSION ARE IN INCHES  
 CABINET SQUARENESS ± .0625  
 FRACTIONAL VALUES ± 1/32"  
 - ALL VALUES ± OVERALL -

TITLE:  
**TWO STATION DRAWING TABLE  
 ASSEMBLY INSTRUCTIONS**

REV.	DESCRIPTION	DATE	NAME	ECH NO.
A	CREATED ASSEMBLY INSTRUCTIONS	1/7/15	EMK	-
REVISION LEVEL				

THIS DRAWING IS THE SOLE PROPERTY OF  
 DIVERSIFIED WOOD CRAFTS. IT MAY NOT  
 BE ALTERED OR CHANGED WITHOUT  
 PERMISSION

DRAWING NUMBER:	SCALE:	SHEET:	REVISION:
DT-80A, DT-82A, & DTA-21A	NTS	5 OF 5	REV A