

# WALL STORAGE BENCH

SB-4L & SB-4P  
ASSEMBLY INSTRUCTIONS

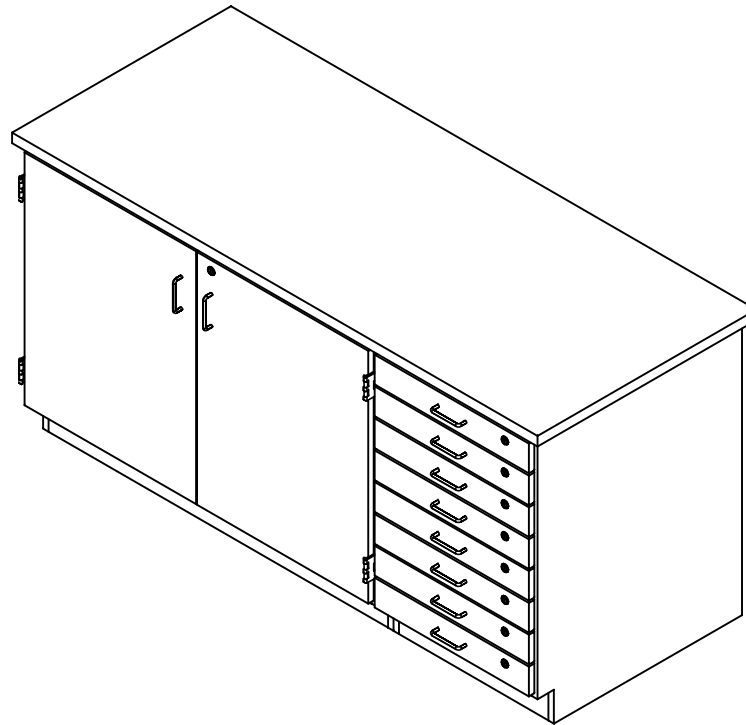

NOTE:

1. MODEL VIEWS MAY NOT REPRESENT EXACT MODEL PURCHASED

DWN BY:	EMK	DWN DATE:	3/7/14
APR BY:		DATE APR:	
APR BY:		DATE APR:	

UNLESS OTHERWISE SPECIFIED  
DIMENSION ARE IN INCHES  
CABINET SQUARENESS ± .0625  
FRACTIONAL VALUES ± 1/32"  
- ALL VALUES ± OVERALL -



300 South Krueger Street  
Suring, WI 54174  
diversifiedwoodcrafts.com

TITLE:  
WALL STORAGE BENCH  
ASSEMBLY INSTRUCTIONS

REV.	DESCRIPTION	DATE	NAME	ECN NO.
A	CREATED ASSEMBLY INSTRUCTIONS	3/7/14	EMK	-
REVISION LEVEL				

THIS DRAWING IS THE SOLE PROPERTY OF  
DIVERSIFIED WOOD CRAFTS. IT MAY NOT  
BE ALTERED OR CHANGED WITHOUT  
PERMISSION

DRAWING NUMBER:	SCALE:	SHEET:	REVISION:
SB-4L & SB-4P	NTS	1 OF 3	REV A

## TOOLS REQUIRED

SCREW DRIVER  
CONTACT CEMENT

## ASSEMBLY COMPONENTS

ITEMS INCLUDED	PART #	PART DESCRIPTION	QTY
CABINET ASSEMBLY	WHB-123 X 24	22"W X 28"D X 35"H	1
CABINET ASSEMBLY	DPSC-50	48"W X 28"D X 35"H	1
MAPLE TOP (SB-4L)	100416	TOP,MPL,1.75X30X72	1
SCREWS - MAPLE TOP	100641	SCREW,#8X1 <sup>3</sup> / <sub>4</sub> " QUAD RD WASH HD	8
PLAM TOP (SB-4P)	17-0036	TOP,PLAM,1.25X30X72,ALMOND	1
SCREWS - PLAM TOP	100597	SCREW,#8X1 <sup>1</sup> / <sub>2</sub> " QUAD ROUND WASHER	8
CORNER BASE ASSEMBLY	206513	CORNER,BASE,ASSY,SST,2 CORNERS W/ SCREWS	2
RUBBER BASE MOLDING	100283	RUBBER BASE MOLDING (SOLD BY FOOT)	16.333

**NOTE:**

- SB-4L = MAPLE TOP, SB-4P = PLAM TOP

DWN BY:	EMK	DWN DATE:	3/7/14
APR BY:		DATE APR:	
APR BY:		DATE APR:	

UNLESS OTHERWISE SPECIFIED  
DIMENSION ARE IN INCHES  
CABINET SQUARENESS ± .0625  
FRACTIONAL VALUES ± 1/32"  
- ALL VALUES ± OVERALL -



300 South Krueger Street  
Suring, WI 54174  
diversifiedwoodcrafts.com

TITLE:  
WALL STORAGE BENCH  
TOOLS AND ASSEMBLY COMPONENTS

REV.	DESCRIPTION	DATE	NAME	ECH NO.
A	CREATED ASSEMBLY INSTRUCTIONS	3/7/14	EMK	-

THIS DRAWING IS THE SOLE PROPERTY OF  
DIVERSIFIED WOOD CRAFTS. IT MAY NOT  
BE ALTERED OR CHANGED WITHOUT  
PERMISSION

DRAWING NUMBER:	SCALE:	SHEET:	REVISION:
SB-4L & SB-4P	NTS	2 OF 3	REV A

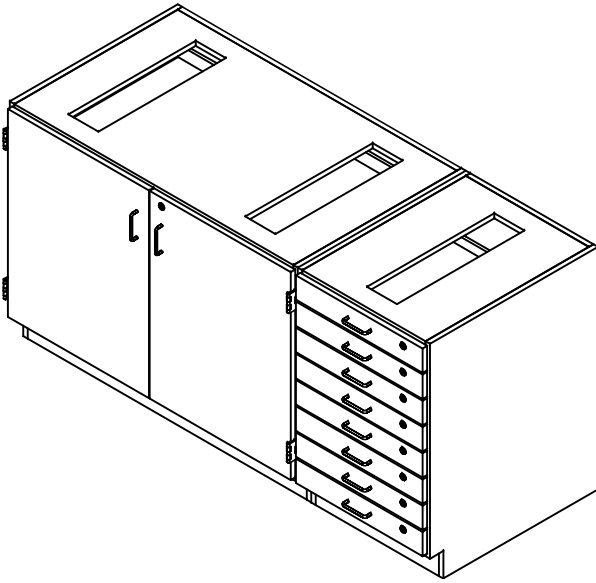

STEP 1:

POSITION THE BASE CABINETS IN DESIRED LOCATION. LEVEL THE CABINETS AND ANCHOR CABINETS TOGETHER. CABINETS MUST BE LEVELED OR DOORS AND DRAWERS MAY NOT OPEN OR CLOSE CORRECTLY.

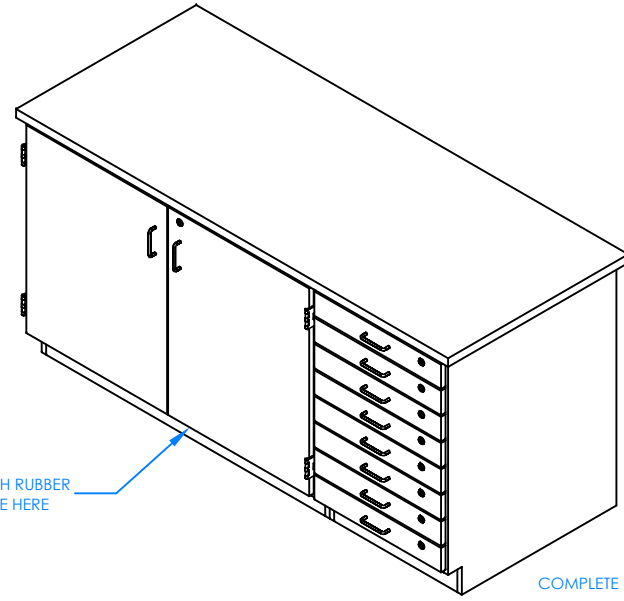

ATTACH RUBBER  
BASE HERE

COMPLETE UNIT SHOWN

STEP 2:

ATTACH THE TOP TO THE CABINET WITH THE SCREWS PROVIDED. SCREW THROUGH THE INSIDE OF THE CABINET TO THE TOP. MAKE SURE SCREWS ARE TIGHT AND TOP IS SECURE. ATTACH RUBBER MOLDING USING CONTACT CEMENT. AFTER MOLDING IS IN PLACE, SCREW STAINLESS STEEL CORNER BRACKETS ON EACH CORNER OVER THE BASE MOLDING.

NOTE:

1.

DWN BY:	EMK	DWN DATE:	3/7/14
APR BY:		DATE APR:	
APR BY:		DATE APR:	

UNLESS OTHERWISE SPECIFIED  
DIMENSION ARE IN INCHES  
CABINET SQUARENESS ± .0625  
FRACTIONAL VALUES ± 1/32"  
- ALL VALUES ± OVERALL -



300 South Krueger Street  
Suring, WI 54174  
diversifiedwoodcrafts.com

TITLE:  
WALL STORAGE BENCH  
ASSEMBLY INSTRUCTIONS

REV.	DESCRIPTION	DATE	NAME	ECH NO.
A	CREATED ASSEMBLY INSTRUCTIONS	3/7/14	EMK	-
REVISION LEVEL				

THIS DRAWING IS THE SOLE PROPERTY OF  
DIVERSIFIED WOOD CRAFTS. IT MAY NOT  
BE ALTERED OR CHANGED WITHOUT  
PERMISSION

DRAWING NUMBER:	SCALE:	SHEET:	REVISION:
SB-4L & SB-4P	NTS	3 OF 3	REV A