

# ClearShot

## ASSEMBLY INSTRUCTIONS

Please read over the step-by-step instructions to ensure easy and quick assembly.

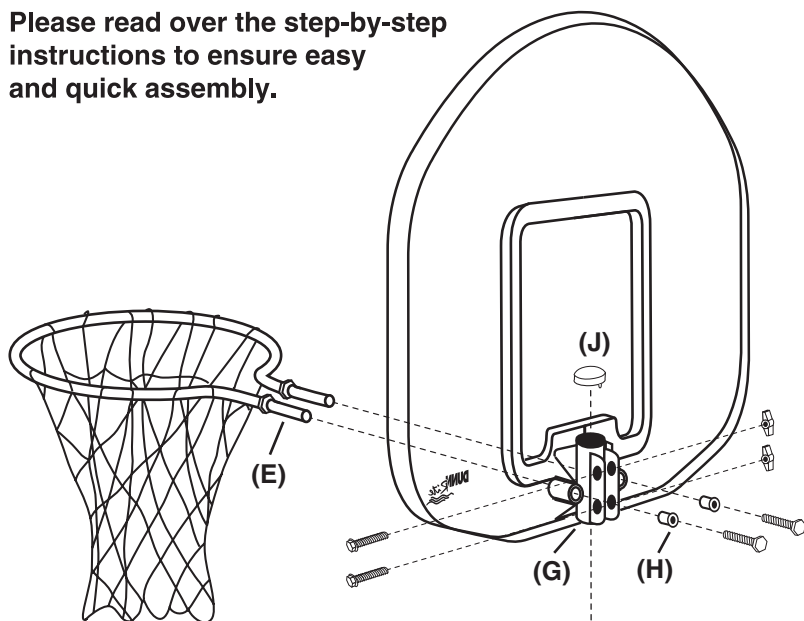

## ASSEMBLY INSTRUCTIONS

1. Apply base decal onto front of base and fill with water.
2. Place end of post with plastic insert into hole on front section of base so that the square hole (A) in the insert seats over the square impression on the bottom of the base. Place clamp (B) around pole making sure lip of base (C) locks in to groove of clamp. Secure clamp to pole and base by inserting one (1/4" X 1") bolt through clamp holes and tightening with hand-knob nut (D) while pushing firmly down on pole.
3. Net Installation: The net has 12 loops. Thread first loop on one of the hoop legs and continue until you have threaded nine loops on one leg (see ill. F). With one hand, hold the ninth loop in its position, in front of the hex nut, and rotate the net around the front of the hoop (1) as far as it will go. On the other leg, install the remaining three hoops onto the rim (2).
4. Insert Rim Legs (E) into holes in the front of backboard until the Hex Nuts recess into the hex holes on the front of the backboard. Install 2 spacers (H) into the backside of Rim Holes. Install two (1/4" X 3/4") bolts and tightened with wrench. *Watch quick net installation video at: <https://www.youtube.com/watch?v=cFby95JPRRI&t=6s>*
5. Slip backboard assembly onto top of pole, install (1/4" X 1") bolt into hex holes on bracket clamps and loosely install the two white hand knobs. Adjust to desired height and tighten the two hand knobs. Install post cap (J) into top of post.

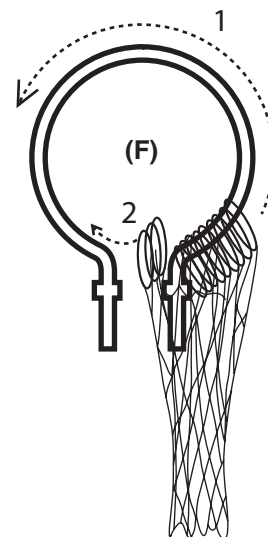
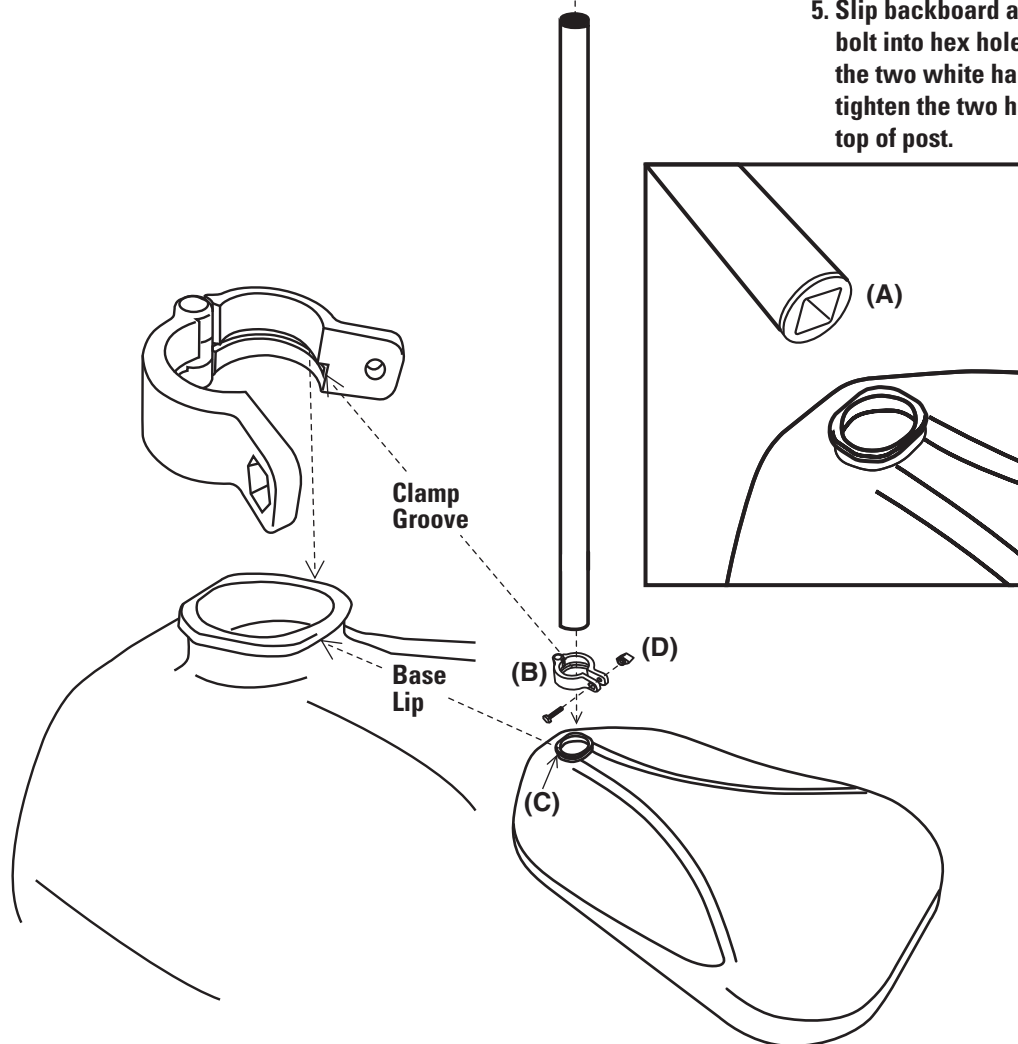

For assistance call:  
1-800-798-9646