



Equipment Supply Company

Instruction Manual

Pneumatic Passenger & Light Truck Tire Spreader

ESCO #90453



WARNING:

THIS PRODUCT, AS WELL AS ALL TIRE TOOLS, SHOULD NEVER BE USED BY PERSONS UNLESS THEY HAVE BEEN TRAINED PROPERLY ACCORDING TO OSHA REGULATIONS 29CFR 1910.177 ENTITLED "SERVICING SINGLE-PIECE & MULTIPIECE RIM WHEELS".

FOR THE SAFE USE OF THIS PRODUCT, PLEASE READ INSTRUCTIONS. FAILURE TO DO SO CAN LEAD TO A VOID IN WARRANTY OR SERIOUS INJURY. PLEASE USE THIS TOOL AND OTHER TIRE SERVICE TOOLS WITH THE UPMOST SAFETY PRECAUTIONS.

CAUTION

Before using the product, carefully read the instructions manual and all stickers and warnings noted on the product. This is necessary to avoid injury to the operator and damage to the product.

Use this product only for spreading tire and repairing the tire protective wrap. Do not use this product for any other purpose. ESCO will not be responsible for the problems caused by any wrong operation.

Keep the hook and claw of machine clean during usage. Clean the extraneous matter such as grease in order to avoid injury to the operator caused by slide.

Do not use this product if it is visibly worn, distorted or damaged. Disposal of this product must be done according to local rules and regulations on waste disposal.

In order to avoid eye injury during repairing process, wears appropriate eye protection.

About this Product

This product is specially designed for servicing automotive and some heavy duty truck tires and spreading the tires during repairing for polishing, cleaning and films affixed etc. Equipped with work light and tools rack to improve work efficiency, enable the tire repairing work to be more convenient, and faster.

Tire Width:

5.75 in – 10.85 in
145MM—275MM

Tire Diameter:

11"—24"

Input Voltage: 220V 50/60HZ

Work Light Voltage: 12V

Air Pressure:

110 - 145 PSI
6-8 KG/CM²



Product Drawing

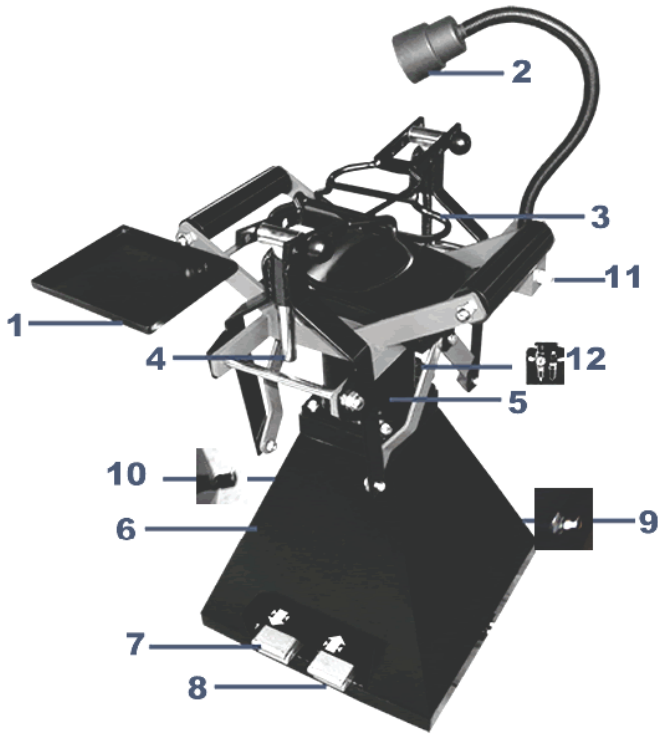

1	<i>Tool Tray</i>	7	<i>Descent Foot Valve</i>
2	<i>Work Light</i>	8	<i>Ascend Foot Valve</i>
3	<i>Spreading Hook</i>	9	<i>Pneumatic Pump Union</i>
4	<i>Orientation Pin</i>	10	<i>Pneumatic Tool Union</i>
5	<i>Power</i>	11	<i>Main Body Power</i>
6	<i>Body</i>	12	<i>Air Regulator Device</i>

INSTALLATION

1. Place this product on solid surface and keep it flat. Fixing it on the floor is recommended.
2. Attach the work tray to the machines with bolts as show in the image below.



3. Install the spreading hook on the machine with orientation pin.



4. Attach a 1/4 NPT quick coupler nipper (not provide) into the fitting located on the treadle valve assembly. Use 1/4 inch air nose with 110 psi minimum.

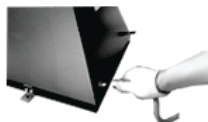

Operation

1. Before starting the machine, check carefully whether the fasteners on the machine are tight and have not been loosened during shipment of product. If they are loose, they must be re-tightened.



2. Fix the tire on the tire spreader with claw by hand.

3. Depending on the size of tire being repaired, it is appropriate to adjust the spreading claw to be the correct height. Place the spreading hook pin in the correct position for the tire. Adjust the spreading hook by moving the pin and spreading hook up and down in order to insert into one of the four adjusting holes.



4. Press the ascend foot valve and spread the tire to be the required width. If the tire being spreaded is raised so high that it breaks away from machine, the spreading hook arm is positioned too high and needs to be readjusted and tested again.

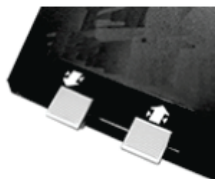

5. Tires need to be rotated to a new location, push the descend foot valve to release air pressure till the spreading hook loosens, then put the tire on the machine rotary to find out a suitable location. Repeat the above operation for spreading tire.



6. The work light equipped with the machine also needs to be adjusted to the most suitable location for full illumination for easier maintenance work.



7. When finished repairing tires, press down the descend foot valve to release air pressure, spreading hook releases, then demount the tire from machine.



Maintenance

Add the lubrication oil to the oil cup in time, always guarantee that the oil quantity in the cup to be occupy $1/3$ - $2/3$ of the total volume. Adjust drip oil speed, piston reciprocating run every 5 ~ 6 times for drip one blob oil for standard. ensure the oil pathway lubricate fully.

Clear away the dust and sundries always, check whether the fastener is loose or not.

Drip oil to the piston rod and the various parts of pin regularly. Reducing friction, extending machine life.

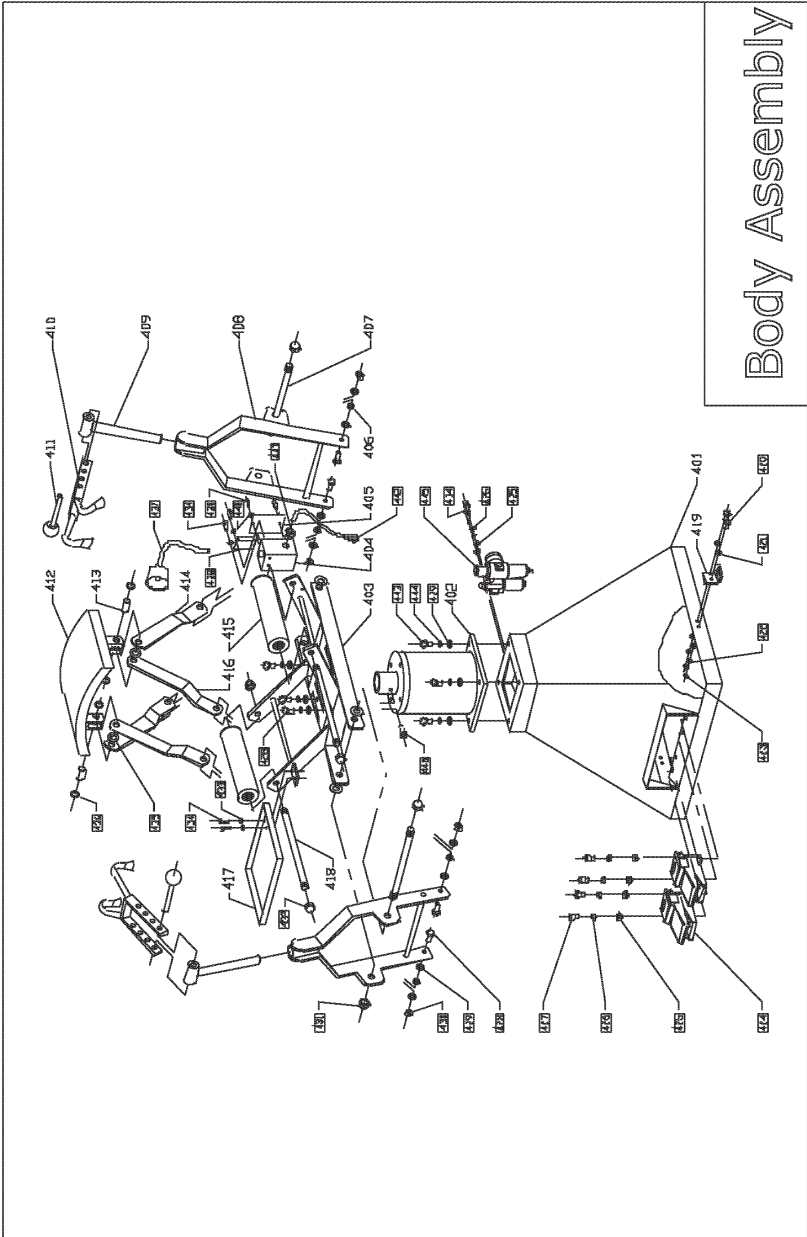

NO	CODE	description	quantity
401	110000	Main Body	1
402	200000	Cylinder	1
403	310000	Bracket	1
404	380000	Power box	1
405	380003	Box cover	1
406	300003	sheath	4
407	300005	Staff 1	2
408	320000	Waver rack	2
409	330000	Shaft	2
410	340000	Spread hook	2
411	370000	Align pin	2
412	350000	Coping	1
413	300004	Coping shaft	2
414	300002	Connect board 2	2
415	360000	Bracket unite element	2
416	300001	Connect board 1	2
417	300007	Tool salver	1
418	300006	Staff 2	2
419	100001	Corner angle iron	2
420		Hexangular bolt M6X16	4
421		Even gasket 6	8
422		Spring gasket 6	4
423		Hexangular nut M6	4
424		Step valve	2
425		Big even gasket 5	2
426		Spring gasket 5	6
427		Column hexangular bolt M5X16	8
428		Hexangular bolt M10X25	8
429		Even gasket 10	8
430		Cease nut M10	16
431		Cover nut M16	4
432		Hexangular nut M5	4
433		Even gasket 5	2
434		Cover nut M14	4
435		Even gasket 16	6
436		Shaft pring block ring16	4
437		Working light	1
438		Column hexangular bolt M5X10	2
439		Crossed setboltM4X8	2
440		Transformer	1
441		Even gasket 4	2
442		Across line	1
443		Power line	1
444		Hexangular bolt M10X30	4
445		Column hexangular bolt M8X16	1
446		Spring gasket 10	8
447		Oil-water separator	1

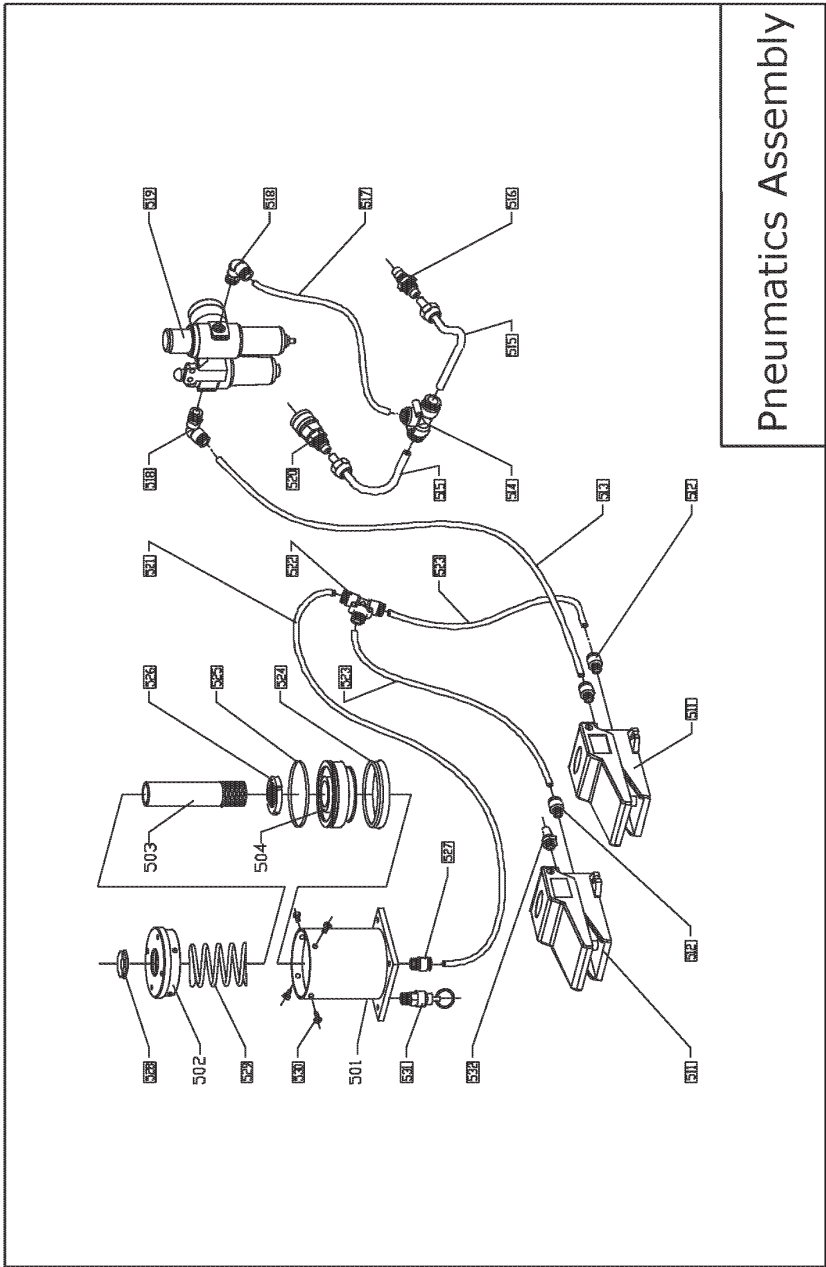

NO	CODE	DESCRIPTION	QUANTITY
501	210000	Cylinder	1
502	200003	Cylinder cover	1
503	200002	Piston staff	1
504	200001	Piston	1
511		Step valve	2
512		Direct tie-in	3
513		PU pipe	2
514		red-tee	1
515		PU pipe	2
516		Metal speediness tie-in	1
517		PU pipe	1
518		Right angle tie-in	2
519		Oil-water separator	1
520		Metal speediness tie-in	1
521		PU pipe	1
522		Straight tee	1
523		PU pipe	1
526		PU pipe	1
527		PU pipe	1
528		Y- windtight ring	1
529		O- windtight ring	1
530		Circinal nut M56X2	1
531		Dustproof ring	1
532		constringent spring	1
533		Hexangular bolt M10X16	4
534		Safety valve	1
535		Silencer	1



CONTACT INFO:

www.esco.net - info@esco.net
15270 Flight Path Drive
Brooksville, FL 34604
PH. 352.754.1117
Toll Free. 1.800.352.9852 (US, Canada Only)
Fax: 352.754.4508

ESCO - The Proper Tools to Keep Your Equipment Moving!

Stay Connected with ESCO...

