

SPRING-LOADED CAP
RETURNS TO NEUTRAL POSITION
WHEN BX PLATE NOT IN USE

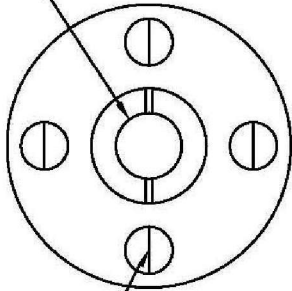

1/4" X 1-1/2" TAPPING SCREWS

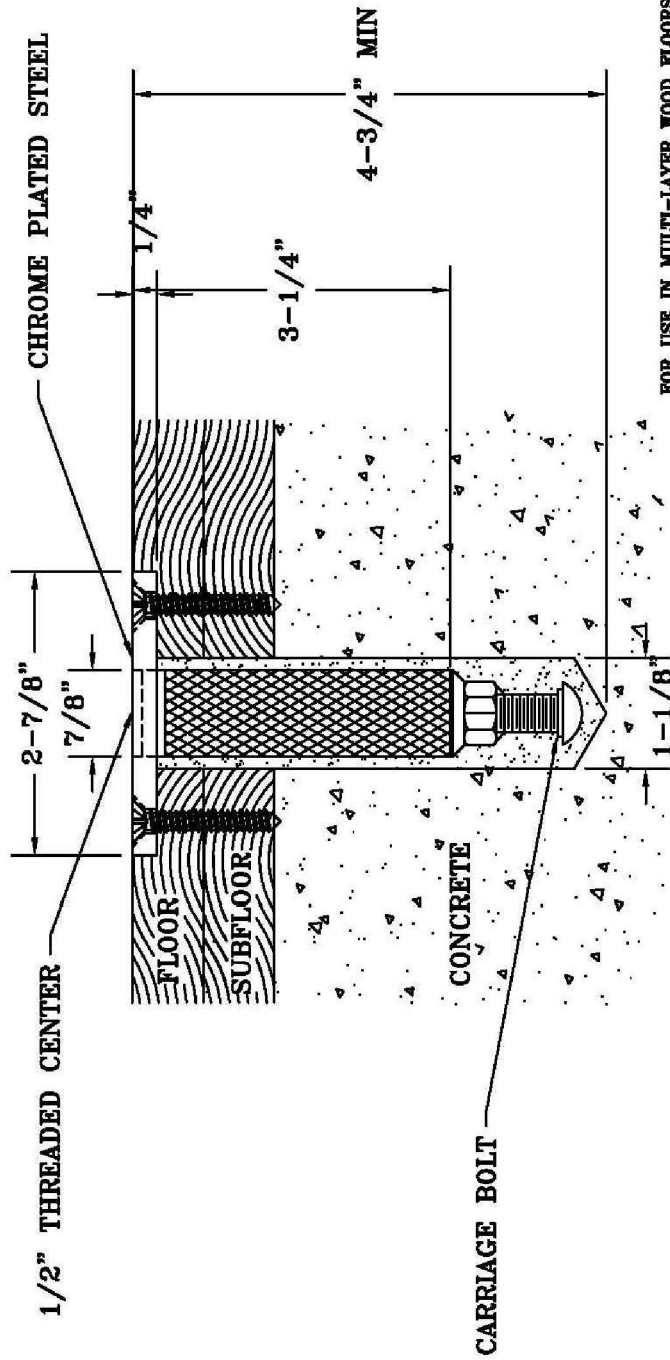

FOR USE IN MULTI-LAYER WOOD FLOORS OVER CONCRETE

1026-12-00 STYLE BX FLOOR PLATE

STYLE BX FLOOR PLATES ARE 1/2" THREADED STEEL FLOOR PLATES USED FOR INSTALLING T-BASE VOLLEYBALL UPRIGHTS OR MANY DIFFERENT GYMNASIIC APPARATUS'S. THESE FLOOR PLATES ARE DESIGNED FOR INSTALLATION INTO FLOORS THAT HAVE MULTIPLE LAYERS OF WOOD OVER CONCRETE. THE FLOOR PLATE CONSISTS OF A FLOOR PLATE TUBE ASSEMBLY THAT HAS A FLAT CIRCULAR TOP THAT SITS FLUSH WITH THE WOOD FLOOR SURFACE. THE FLOOR PLATE WILL WITHSTAND GREATER THAN 6000 lb. VERTICAL LOAD WITH NO PULL OUT, WHEN INSTALLED ACCORDING TO DIRECTIONS.

REVISION		
REV.	DATE	BY



Gared Holdings, LLC
9200 E. 146th St. Noblesville, IN 46060

THIS DOCUMENT CONTAINS TRADE SECRET AND OTHER MATERIALS WHICH ARE PROTECTED BY CONFIDENTIALITY NOTICE AND AGREEMENT AND BY COPYRIGHT. ANY USE OR COPYING OF THIS DOCUMENT EXCEPT AS AUTHORIZED BY GARED HOLDINGS, LLC IS STRICTLY PROHIBITED.

STYLE BX FLOOR PLATE			
DRAWN	DKH	DATE	06/10/09
MATERIAL	STEEL		
APPROVED	DWP	DATE	06/10/09
FINISH	CHROME		
FILE LOC.	Q:\Final Release\Specifications\1026-12-00		DWG. NO. 1026-12-00
SIZE	SCALE	SHT. NO.	PART NO.
A	NONE	1 OF 1	1026-12-00
REV			-