



# Adjustable Wall Mount for ESV1500 and ESV1018 Illuminated Cabinets

Part Number: 706100 (used to ESV1500), 706000 (used for ESV1018)

1. Attach wall mount track, closed end down approximately 2.5 ft (.8 m) from floor. Wall mount track must be secured into wall studs or to the wall using 50 lbs wall anchors. Note: mounting screws are not provided.
2. Slide adjustable plate onto wall mount track and tighten knobs to desired height.
3. Slide back of illuminated cabinet underneath lip on adjustable plate to secure.

Note: If mounting the ESV1200 Illuminated Cabinet, install bracket first before placing cabinet in mount.

### ESV1018 and ESV1500 Mounting Guide

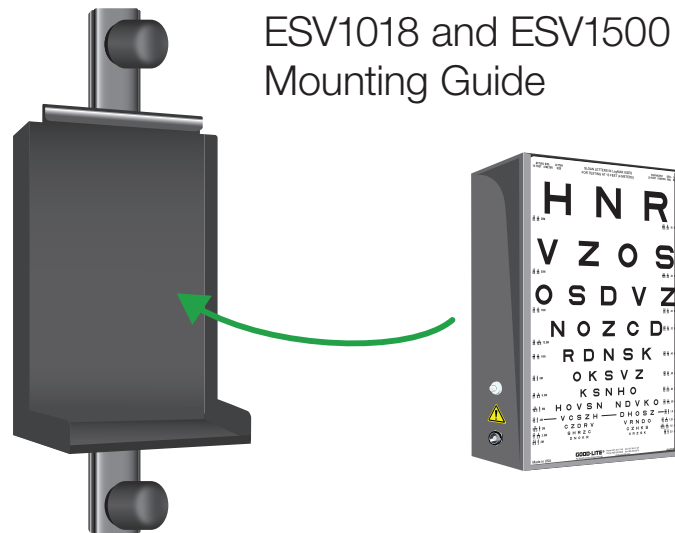

### ESV1200 Mounting Guide

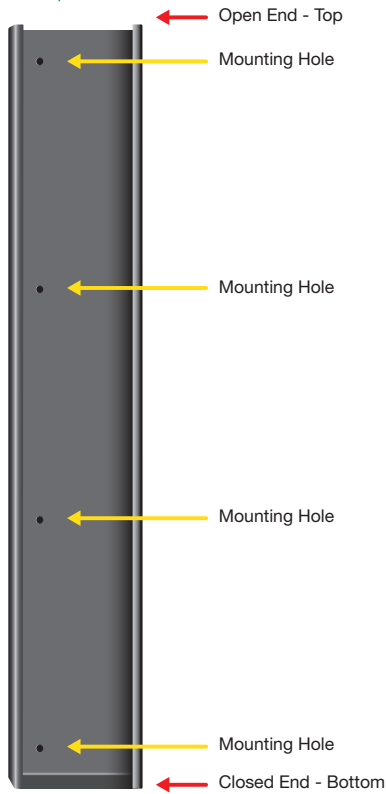
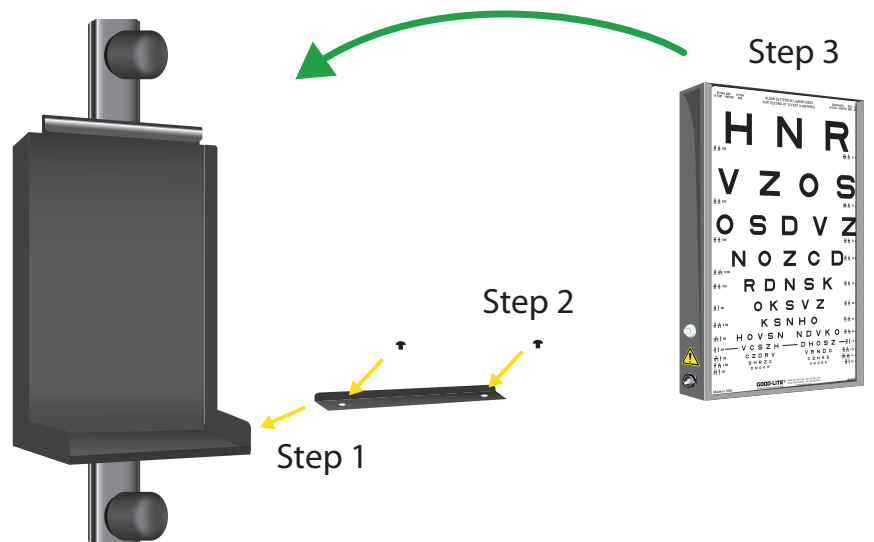

## 1. Mount to Wall