



33800 Lear Industrial Parkway, Avon, OH 44011

1-888-333-1134

www.MainAccess.com

Installation Videos Available on YouTube



Item # 200601T
iSTEP

Attention: DO NOT return product to store! If you have any damaged or missing components, please contact Main Access customer service for immediate assistance at 1-888-333-1134 or info@MainAccess.com.

All assembly videos available mainaccess.com or YouTube

Be sure to check out the wide variety of products that Main Access offers!

AQUA CLOUD
OVERSIZED FLOATING MATTRESS



Illuminate Your Life



The Anchor



SmartLite

RECHARGABLE UNDERWATER LED LIGHT

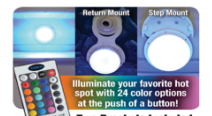

Assembly Instructions for Model #200601T iStep



iSTEP

iStep Components	Qty
A1) Upper Step Tread	1
A2) Lower Step Tread	1
B1) Upper Left Side Riser	1
B2) Lower Left Side Riser	1
C1) Upper Right Side Riser	1
C2) Lower Right Side Riser	1
D) Ballast Tray	1
E1) Upper Handrails	2
E2) Lower Handrails	2
F) Top Step Support Brace	1
G) Mid Riser Brace	1
H) Deck Connectors	2
J) Handrail Connectors	2

Hardware Kit (not shown)	Qty
M) Ballast Sand Bags	2
N) #8 x 1" SS Screws	18
O) #14 x 1-1/4" SS Screws	8

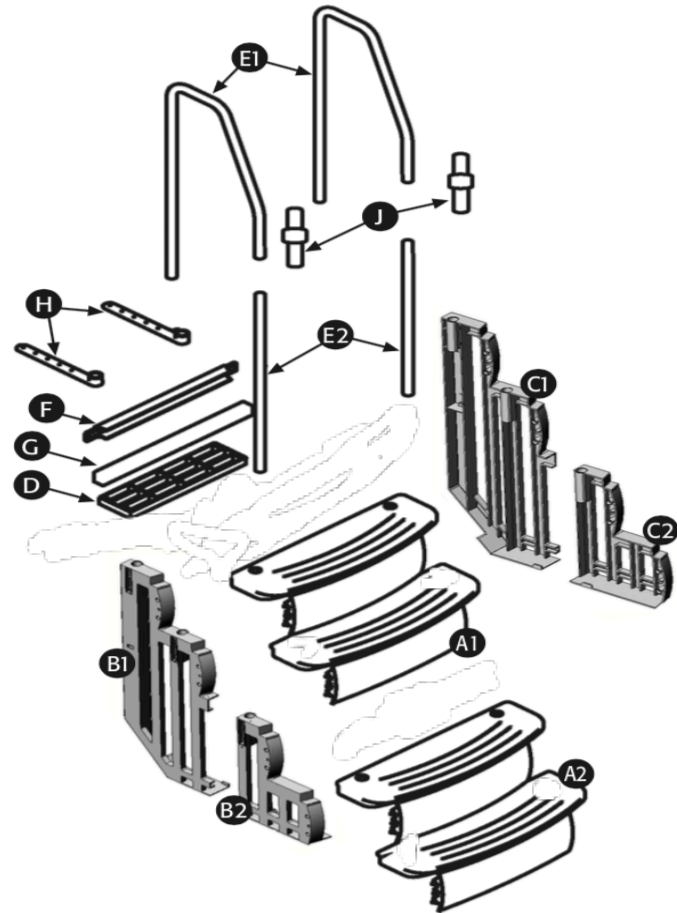

****Replacement Parts Available at MainAccess.com****

SAFETY INSTRUCTIONS:

- Install step per manufacturer's instructions.
- Locate **iStep** on a solid base.
- iStep is designed for use by one person at a time.
- This step is intended for use as a swimming pool entry/exit only.
- Face the step when entering and exiting the pool.
- No jumping, no diving from the step.
- Do not swim through, behind or around the step.

Tools Required

Cordless Screwgun/Drill, 1/8" Drill Bit,
Standard Phillips Bit, Safety Glasses

SAND NOT INCLUDED. FLAT BOTTOM POOLS ONLY.

Note: Before you begin the assembly of your ladder/step please insure you have all components and hardware.

Step 1: Align the holes on upper left riser with the mushroom caps on the upper step tread.



Step 2: Snap into place with a rubber mallet.



Step 3: Repeat steps 1 & 2 on the right side of the step.



Step 4: Align the holes on the lower left riser with the mushroom caps on the lower step tread.



Step 5: Snap mushroom caps into place using rubber mallet.



Step 6: Repeat steps 4 & 5 on the right side of the step.



For Questions Regarding Installation, Please Contact Main Access Customer Service 1-888-333-1134



iSTEP

Model #200601T Assembly Instructions

Step 7: Insert the tabs from lower step assembly into the slots of the upper step assembly.

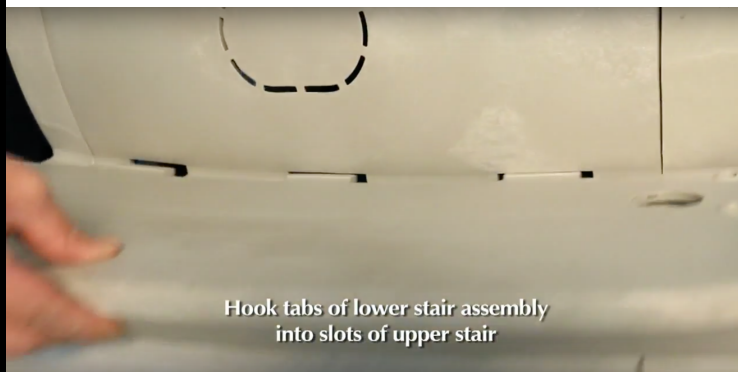

Step 8: Align ballast tray between all four risers under the step.

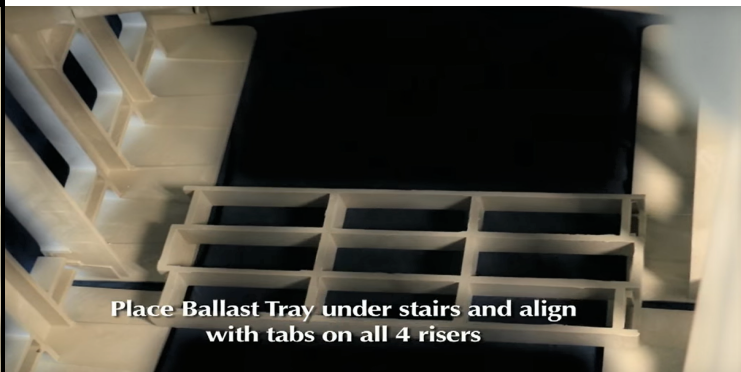

Step 9: Snap tabs from upper and lower risers into the ballast tray with a rubber mallet.



Step 10: Insert top step support brace in between upper risers.



Step 11: Insert mid riser brace in between risers and over the tabs. May have to tilt risers to



Step 12: Insert lower handrails into the holes on either side of the lower step tread.



Step 13: Insert the smaller end of the handrail connector into the top of the lower handrail.

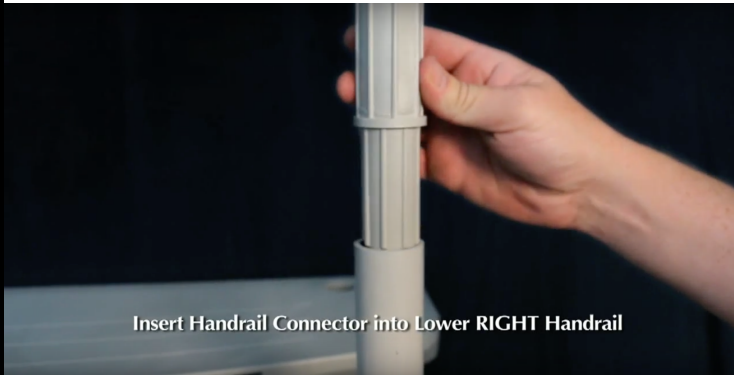

Step 14: Place upper handrail through deck connector and insert into the hole on the top step.

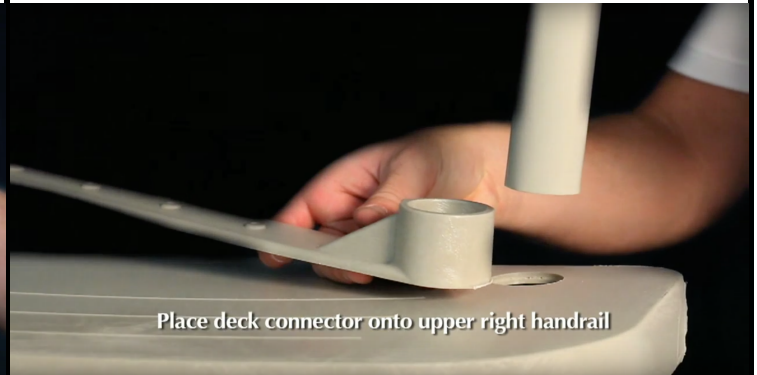

Step 15: Insert front end of upper handrail down over the handrail connector.



Step 16: Drill #14 x 1 1/4" screws into handrails through all upper and lower risers.



Step 17: Drill #8 x 1" screws into four dimples on step tread.



Step 18: Insert the socket cap into the unused hole on the left side of the middle step.



For Questions Regarding Installation, Please Contact Main Access Customer Service 1-888-333-1134

Step 21: Pool Installation

Note: Two people are required for installation.

A total weight of approximately 100 lbs. is required to keep the step from floating once in place under water. With the assistance of another person, carefully place the step in the pool. Place two sealed bags of sand (not included) into the ballast bags (M) and over the ballast tray (D) to weigh the step down. Walk the step back against the pool wall to prevent swim-behind hazards.

***Optional* Purchase (2) Anchors (#200888) to weigh down the iStep. Sand not included.**

The Anchor

**Step 22: Deck Mount Installation**

With the step in position, with 6"-8" of the pool wall, slide the deck connectors (H) into position on either the pool top rail or pool deck. Secure to the deck with two #8 x 1" screws (N). Use a minimum of two screws per deck connector. Secure each deck connector (H) to each upper handrail (E1) by using a single #8 x 1" screw.

All Finished!



**For Questions Regarding Installation, Please Contact Main Access Customer Service
1-888-333-1134 or Info@MainAccess.com**

Be Sure to Check Out Other Great Products From Main Access!

SmartLite

RECHARGABLE UNDERWATER LED LIGHT



Illuminate your favorite hot spot with 24 color options at the push of a button!

Two Brackets Included

Mount it to your step or hang it from the return!

The Anchor



Use them to easily weigh down your pool step!

AQUA CLOUD

OVERSIZED FLOATING MATTRESS



Luxury Pool Floats!

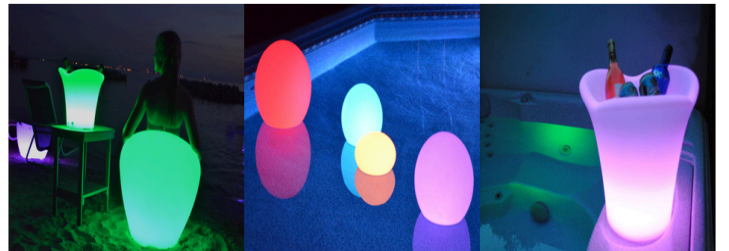

Light-up Floating Globes and Furniture!

