



# Power-Flo II™

## SP1700 PUMP SERIES REPLACEMENT PARTS

Pumps

Parts for Pump Models: SP1705, SP1710, SP1711, SP1720, SP1725, SP1750, SP1775, SP1780

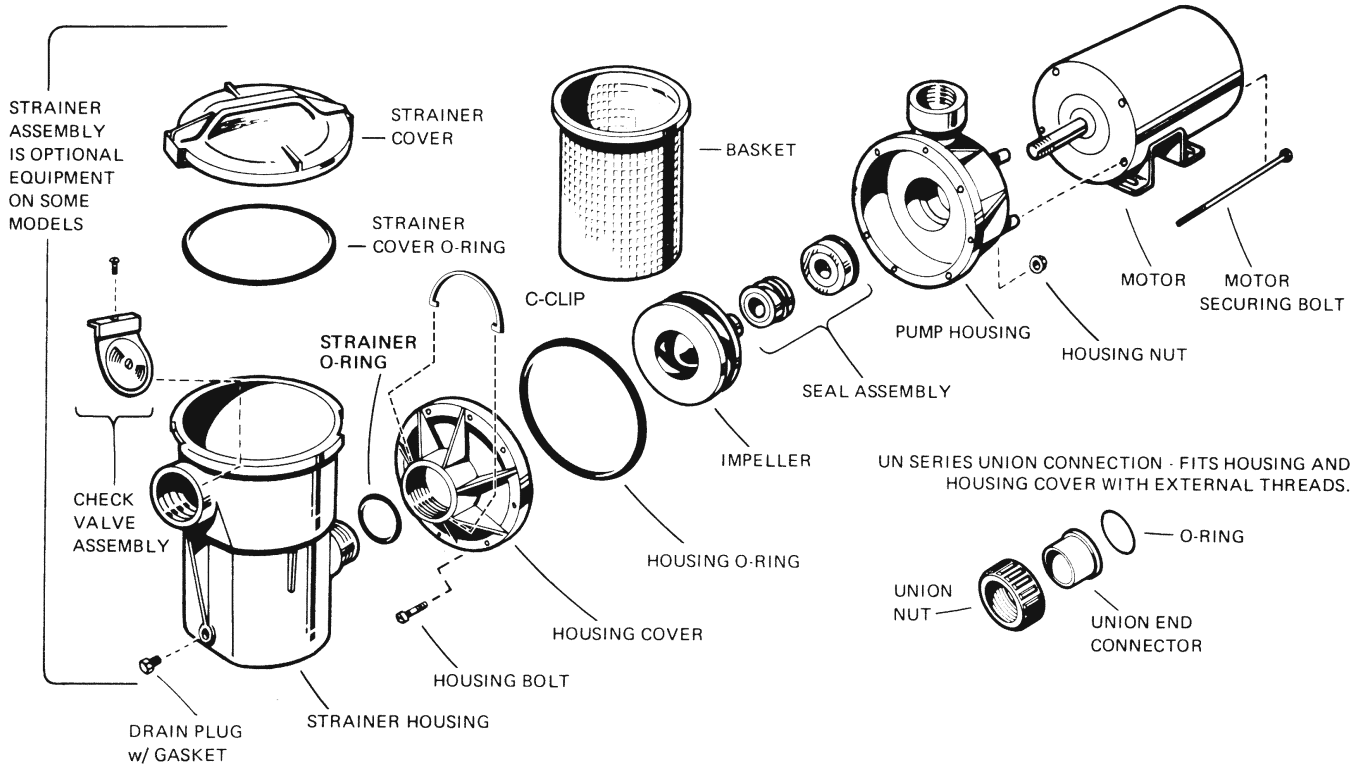

| Part No.   | Description  | Ctn. | Qty. |
|------------|--|------|------|
| SPX1705AA  | Pump Housing   | 4    |      |
| SPX1705B   | Housing Cover with Integral Diffuser (SP1700 Series, Power-Flo II)   | 1    |      |
| SPX1500KA  | Seal Assembly with Cup   | 10   |      |
| SPX1720KA  | Seal Assembly (Power-Flo II, 1 and 1 1/2 H.P.)   | 10   |      |
| SPX1705Z1  | Housing O-Ring Gasket  | 10   |      |
| SPX1500N2  | Housing Bolt, No. 10-24 Hex. Head  | 20   |      |
| SPX1500Y2  | Housing Nut, No. 10-24 Hex.  | 20   |      |
| SPX1705C   | Impeller, 1/2 H.P. (SP1700 Series, Power-Flo II)   | 10   |      |
| SPX1707C   | Impeller, 3/4 H.P. (SP1700 Series, Power-Flo II)   | 10   |      |
| SPX1711C   | Impeller, 1 H.P.   | 10   |      |
| SPX2607C   | Impeller (Power-Flo III, 1 H.P.)   | 10   |      |
| SPX2610C   | Impeller (Power-Flo III, 1 1/2 H.P.)   | 10   |      |
| SPX1500CAP | Strainer Housing with Basket   | 1    |      |
| SPX1500D2A | Strainer Cover with O-Ring   | 10   |      |
| SPX1500P   | Strainer Cover O-Ring  | 10   |      |
| SPX1250RA  | Strainer Basket  | 10   |      |
| SPX1500LX  | Strainer Basket – Large, 4 1/2" x 7" (1992)  | 10   |      |
| SPX1500RA  | Check Valve Assembly (1992 and Prior)  | 10   |      |
| SPX1500W   | Strainer O-Ring  | 10   |      |
| SPX1700FG  | Drain Plug with Gasket – SP1700 Series Housing   | 10   |      |
| SPX1500X1  | Shim for vertical discharge (1999 and Prior)   | 10   |      |
| SPX1515C   | Strainer Housing C-Clip (2000-2003)  | 10   |      |
| SPX1515CN  | Strainer Housing C-Clip (2004- )   | 10   |      |
| SPX1500JS  | Union End Connector – Socket   | 5    |      |
| SPX1500JT  | Union End Connector – Threaded   | 5    |      |
| SPX1500G   | Union Nut  | 10   |      |
| SPX1495Z1  | O-Ring, End Connector  | 10   |      |
| SPXHKIT12  | H-KIT Quick Pump Repair for Power-Flo (Includes SPX1500KA, SPX1580Z1, SPX1500P, SPX1500W, SPX1500H, SPX1705Z1 and Jack's Lube) | 10   |      |

**NOTE:** Parts for Power-Flo Pump Motors are listed on page 135.