

Combi-Cam ϵ

electronic cam lock

miniK 10™

INSTALLATION



1. miniK10
2. Adaptor
3. Cylinder nut
4. Stop Cam
- 5-6. Cams
7. Cam Screw
- 8-10. Mounting Screws

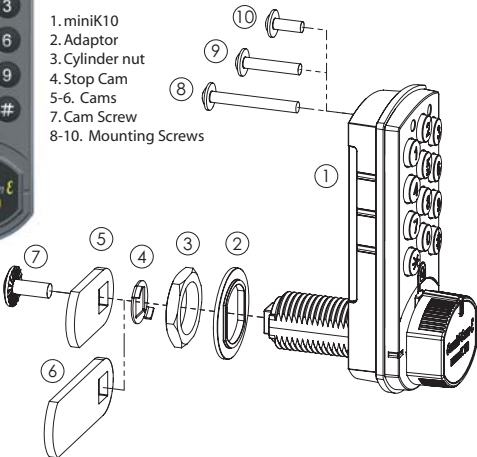

NOTE: Read instructions, set combination and test lock BEFORE installing!

Replacing existing lock:

1. Place mounting template centered on existing hole and mark upper mounting screw hole.
2. Drill mounting screw hole.
3. Install lock using adaptor if necessary.
4. Thread nut on cylinder.
5. Install mounting screw
6. Tighten both nut and mounting screw.
7. Test operation of lock

New Install:

1. Place mounting template on door and mark upper mounting screw hole and lower cylinder hole
2. Drill mounting screw hole and cylinder holes.
3. Continue steps 4-7 above

Note: Before drilling holes, make sure MiniK10 is positioned with proper clearance for cam to work.

Other Installations: Go to www.combi-cam.com/Install/

- More detailed instructions
- Semiflush wood
- Semiflush metal

FJM Security Products
800-654-1786
www.fjmsecurity.com



miniK10™

Mounting Template

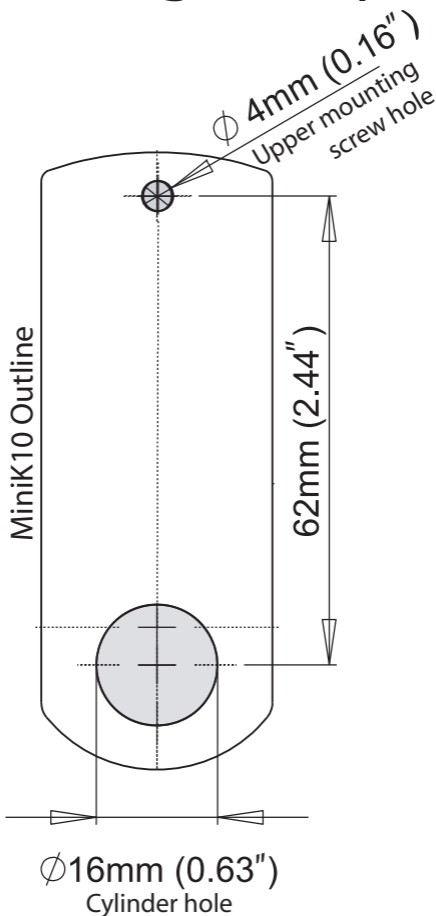

Combi-Cam ϵ