

SCISSORS HINGE

Installation Instructions

Inspect all parts and read all instructions prior to beginning assembly and installation.

Parts Included

- A. Hinges
- B. Mounting Screws

Tools Required

- Phillips Screwdriver
- Drill with 1/16" (1.5mm) bit for drilling pilot holes
- Tape measure or ruler
- Pencil
- Tape

Product Assemblies

SH

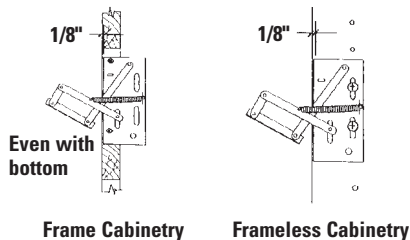

Step 1 Remove false drawer panel from cabinet. Locate the hinges inside the cabinet opening, 1/8" (2mm) back from the cabinet front and even with the bottom opening. Be sure to note right and left hand hinge. Determine if the cabinet is frameless or framed style cabinetry. Locate screw placement in appropriate illustration, and attach hinges "finger-tight" with provided screws.

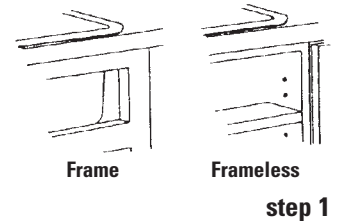

Optional Step

Mark center of screw holes on cabinet and remove hinge. Drill pilot hole 1/4" deep. Mark the drill bit as shown above with tape wrapped 1/4" from tip of drill bit.

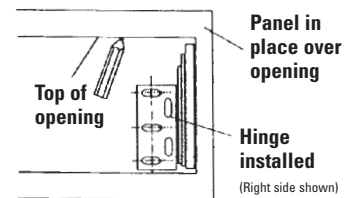

Step 2 Hold false drawer panel in place over cabinet opening. With pencil inside the cabinet, mark pilot holes for hinge attachment on the back of the false drawer panel and mark the top of the cabinet opening on the back of the false drawer panel. This mark is necessary for locating the placement of the tray.

Step 3 Remove the panel and the hinges. Drill pilot holes 1/4" deep, taking caution not to drill through front of false drawer panel. Attach the hinges to the back of the false drawer panel in the center of the slots using the mounting screws provided. Make sure screws are shorter than the thickness of the false drawer panel.

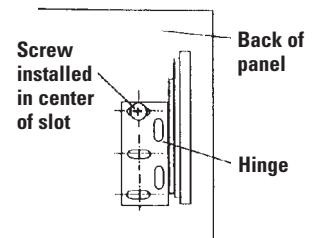

Step 4 Position tray per manufacturer's directions. Open hinges and re-attach to both sides of the cabinet. Close the false drawer panel to check for any necessary horizontal or vertical adjustments. If hinge operation binds, loosen screws holding false drawer panel to hinge and retighten. Hinges should move freely when properly installed. Open panel, and slip tray keyholes over the 1/8" tall screw heads. Gently tighten screws to hold tray in place, but do not over tighten. Installation and assembly is now complete.



Real Solutions
For Real Life.™

KNAPE & VOGT MANUFACTURING COMPANY

P.O. Box 191, Muncie, IN 47308

0.899.6535 • 765.288.8730 • Fax 765.288.0851 • www.kv.com

RN-219EFS 03/03