

CABINET HARDWARE JIG INSTRUCTIONS

- Confirm hole spacing by screwing your hardware through bushings after tightening drill guides into position.
- Double check all dimensions before drilling, and confirm measurements by drilling on scrap wood first.
- For high gloss or delicate finishes, use tape on tool or work piece to protect finish.
- Ensure thumb screws remain tight by checking after each time you drill.
- Do not use pliers to tighten thumb screws, they should only be hand-tightened.
- Do not adjust any screws besides silver thumb screws, all other screws have been set and tightened to factory specifications to ensure accuracy.

PARTS DIAGRAM

PARTS VARY BY MODEL

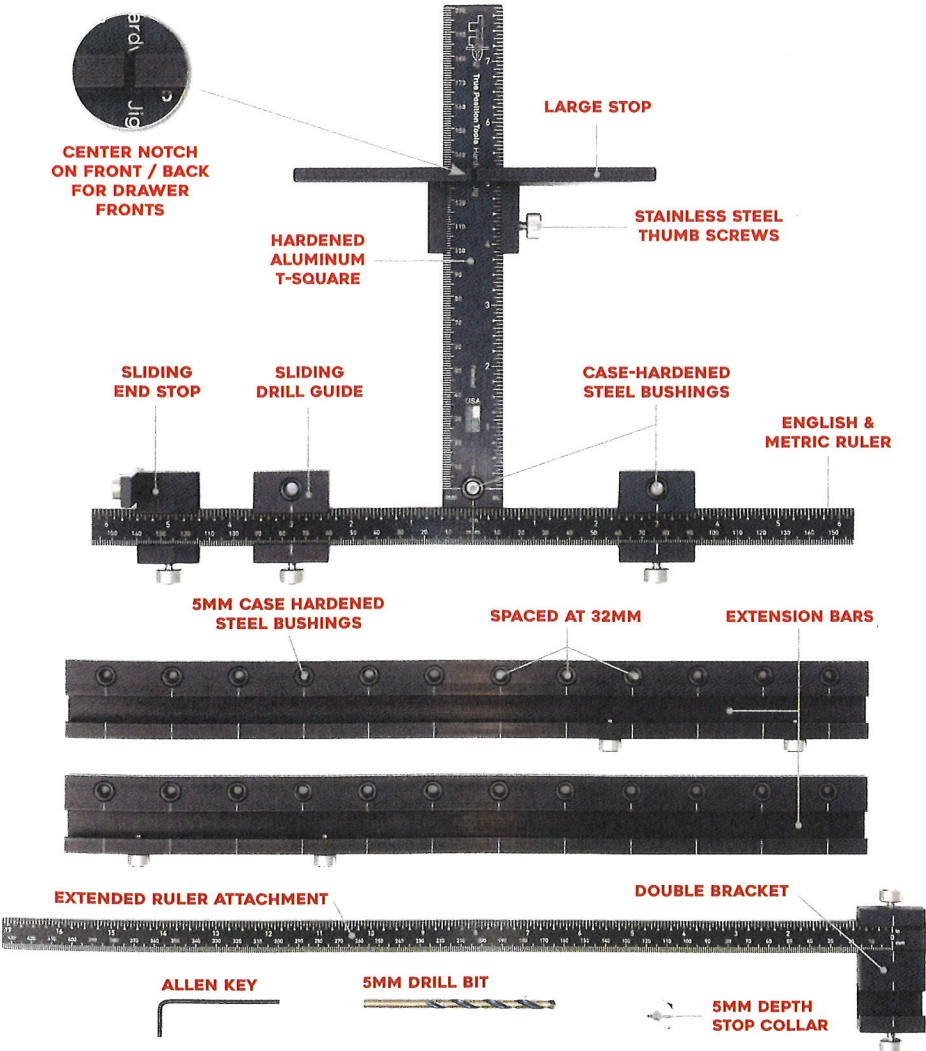

NEW!

Shaker Drawer Front Spacers

PROVIDES STABILITY WHEN DRILLING RECESSED DRAWER FRONT PANELS



Remove Sliding Drill Guide and insert spacer into reverse side.



Place Sliding Drill Guide on drawer front with spacer on recessed portion. Adjust until both sit flush.

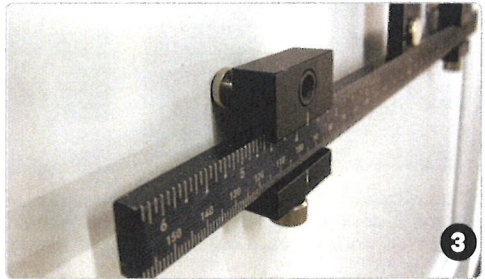

Return Sliding Drill Guides to appropriate measurements to install cabinet hardware.



SCAN FOR WEB INSTRUCTIONS

KNOB ON DOOR INSTALLATION

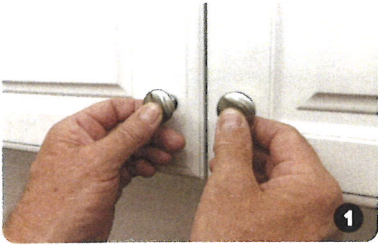

1 Place hardware (measure as needed) to find position you like; mark hole location



2 Measure from bottom of door to mark

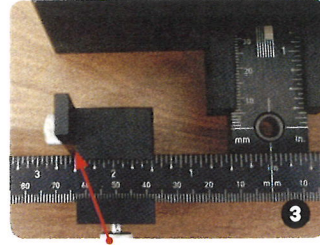

3 Set **Sliding End Stop** to measurement from Step 2 and tighten



4 Measure from side of door to mark

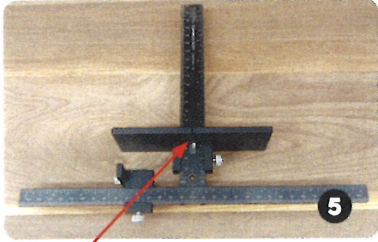

5 Set **Large Stop** to measurement from Step 4 and tighten

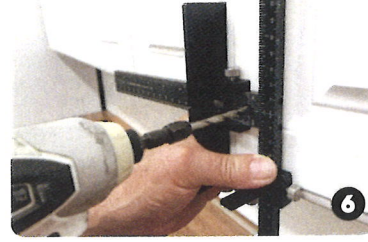

6 Position tool with stops as shown and drill hole through drill bushing

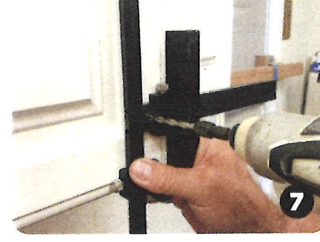

7 Flip tool to its reverse side, place on opposite door and repeat

HANDLE ON DOOR INSTALLATION

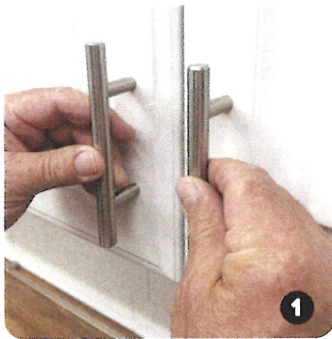

1 Place hardware (measure as needed) to find position you like; mark bottom hole location



2 Measure from bottom of door to mark

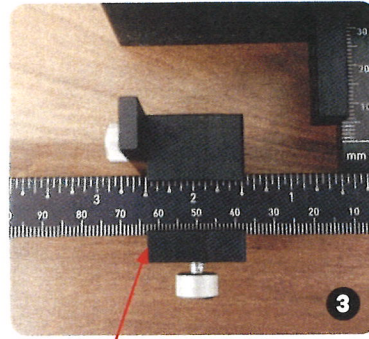

3 Set **Sliding End Stop** to measurement from Step 2 and tighten



4 Measure from side of door to mark

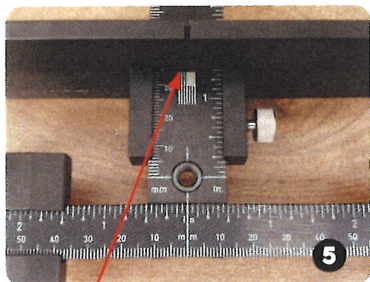

5 Set **Large Stop** to measurement from Step 4 and tighten

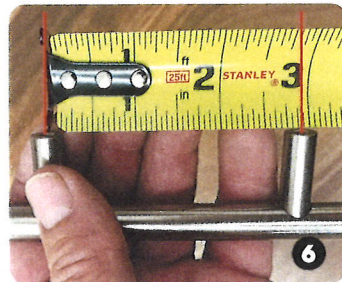

6 Measure handle spacing (center to center)

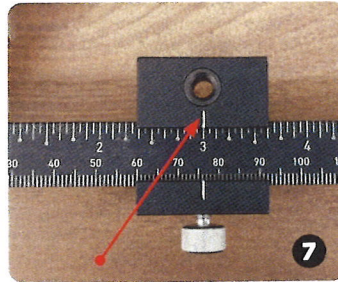

7 Transfer hardware measurement from Step 6 to Sliding Drill Guide and tighten

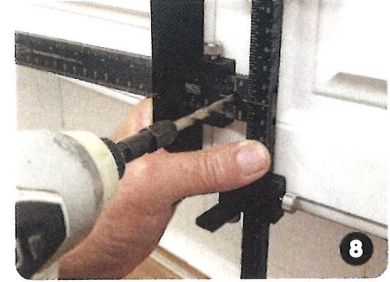

8 Position tool as shown, drill through fixed center bushing for bottom hole

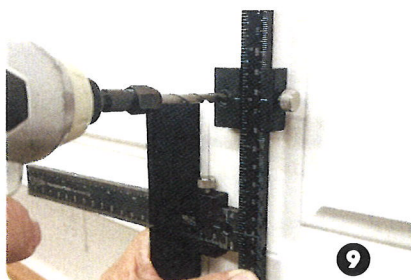

9 Drill through Sliding Drill Guide for top hole

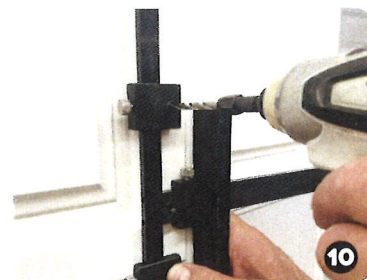

10 Flip tool to its reverse side, place on opposite door and repeat

001.35.050
059

32mm LINE BORING FOR SHELF PINS

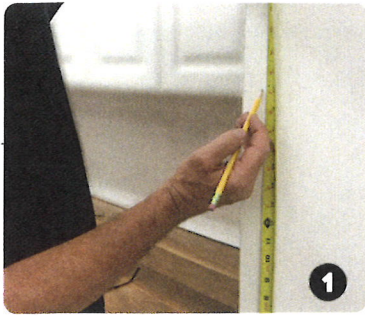

1 Measure and mark desired location of center hole to be drilled (we are drilling in sets of three)

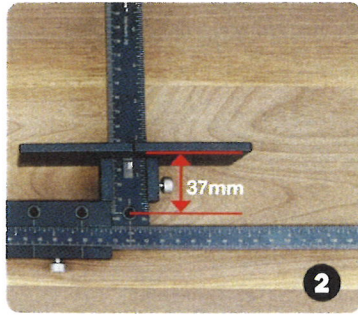

2 Mount Extension Bar firmly against T-Square. When Large Stop touches Extension Bars, industry standard for shelf pin offset is achieved (37mm)

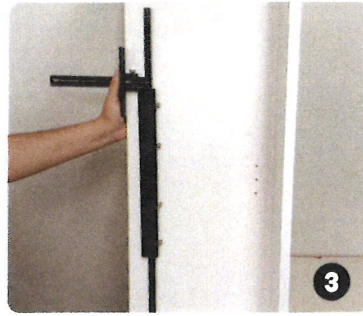

3 Slide Extended Ruler Attachment into Extension Bar, align any drill bushing with mark in cabinet from Step 1, tighten Thumb Screws

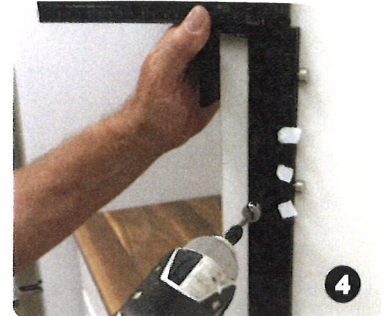

4 Mark your holes with tape for reference, drill first set of shelf pin holes

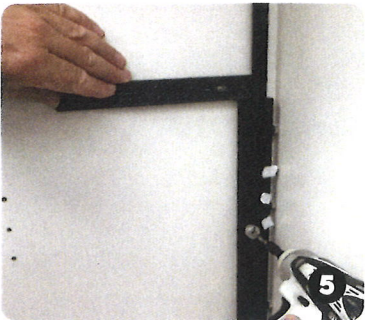

5 Remove Large Stop and press Thumb Screws against back panel then drill

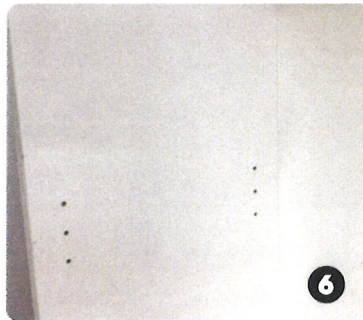

6 Perfectly spaced at 32mm every time

PRO TIP

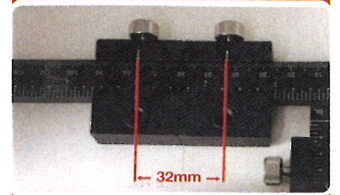

Two Sliding Drill Guides together produces 32mm hinge plate dimensions (industry standard)

DRILLING HINGE PLATE HOLES

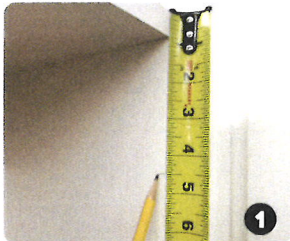

1 Mark center of hinge plate

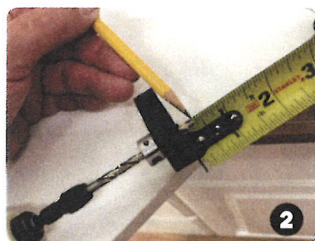

2 Set Depth Stop Collar to drill depth and tighten. Depth varies depending on screw type and cabinet material

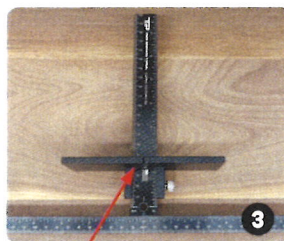

3 Set Large Stop to 37mm (industry standard)

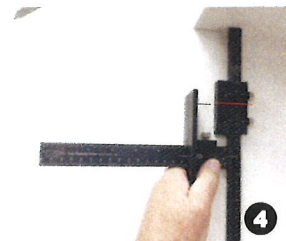

4 Place two Sliding Drill Guides side by side, to achieve 32mm spacing position tool with Large Stop and T-square firmly against cabinet surface, adjust Sliding Drill Guide centers to mark and tighten. Drill first set of hinge plate holes



5 Flip tool to bottom of cabinet, position tool with Large Stop and T-square firmly against cabinet surface, and drill second set of holes

PRO TIPS

Only reverse Large Stop if you have stability or clearance issues

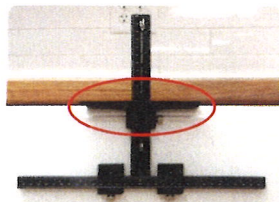

Standard Large Stop

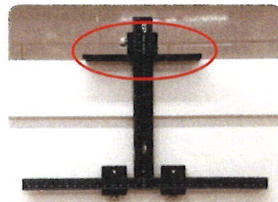

Reversed Large Stop

Reversing either the Large Stop or the Sliding End Stop produces a 5/16" (~8mm) minimum spacing

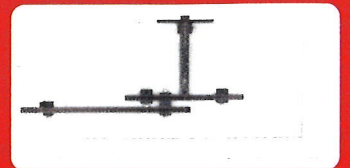
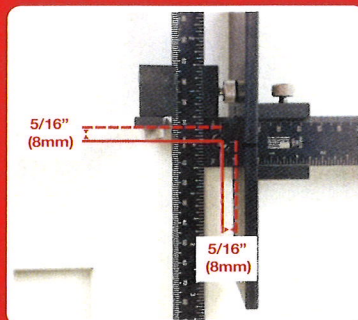

If your handle pattern interferes with Double Bracket, align Bracket and Extended Ruler to number on T-square that does not interfere (aligned at 2" in above image)

KNOB ON DRAWER FRONT



1 Place hardware (measure as needed) to find position you like; mark hole location (We are centering on width and height)

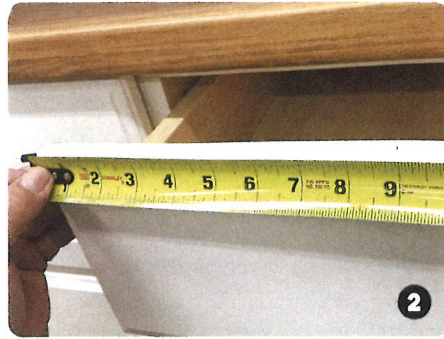

2 Measure width to find center

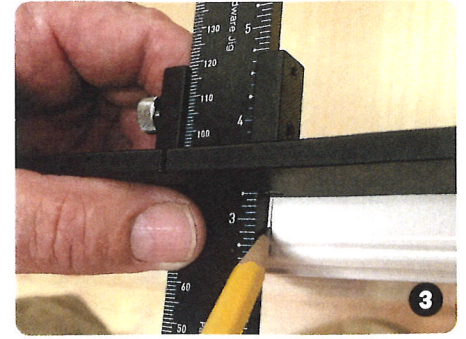

3 Mark center on top of drawer

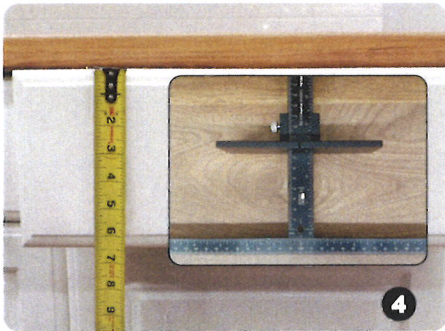

4 Measure height of drawer and set Large Stop at half of drawer height if centering



5 Line up notch on center of Large Stop with center mark at top of drawer then push tool flush against drawer face

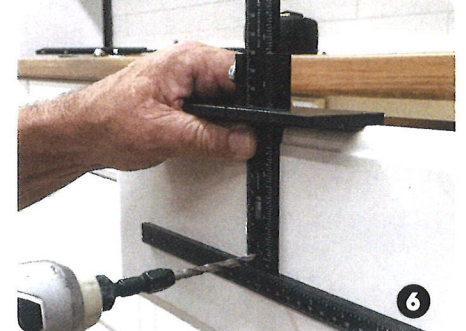

6 Drill hole using fixed center drill bushing (Large Stop reversed for stability)



See more at www.TruePositionTools.com



HANDLE ON DRAWER FRONT

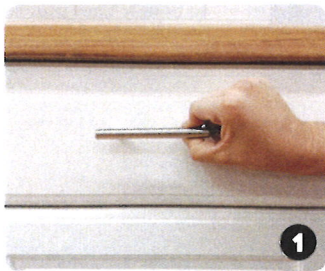

1 Place hardware (measure as needed) to find position you like. We are centering handle on width and height

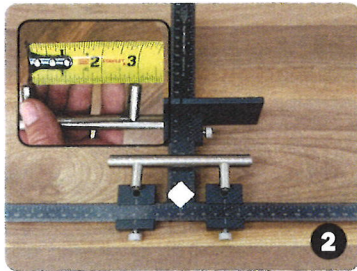

2 Measure hole centers. Adjust and tighten Sliding Drill Guides. Cover unused bushing with tape to prevent accidental drilling



3 Measure drawer width to find center

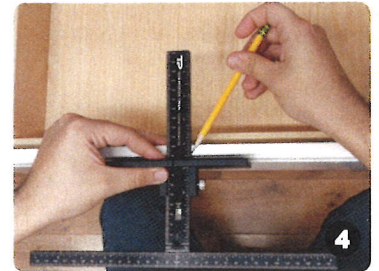

4 Use half of measurement from Step 3 to mark center on top of drawer

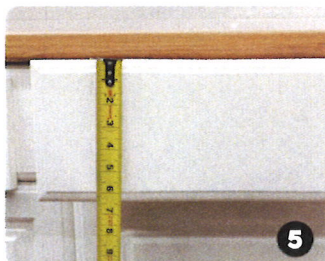

5 Measure height of drawer front

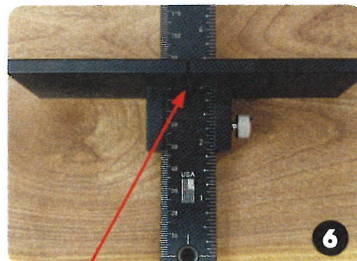

6 Set Large Stop to half of measurement from Step 5 if centering

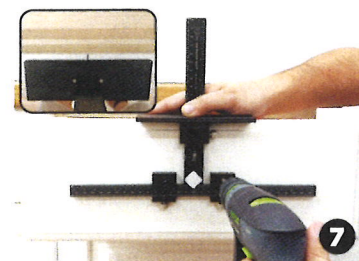

7 Line up notch on Large Stop with mark from Step 4, then drill

LARGE HANDLE ON WIDE DRAWER FRONT

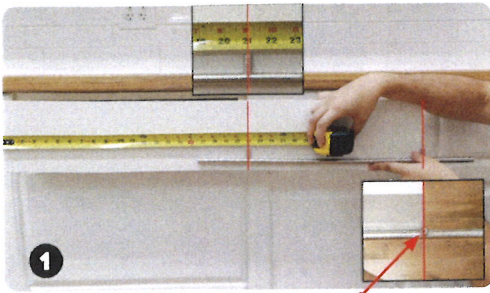

1 Line up center of one end of hardware hole with edge of drawer front and measure from opposite end of drawer to center of other hardware hole

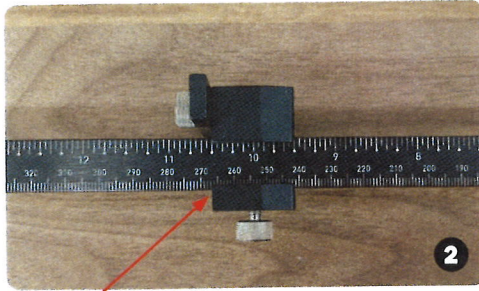

2 Set Sliding End Stop on Extended Ruler at half the measurement from step 1

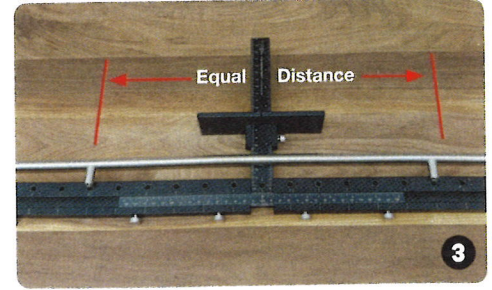

3 Place hardware on Extension Bars and mark holes to be drilled with tape (If needed, adjust Extension Bars equally left and right until holes align)

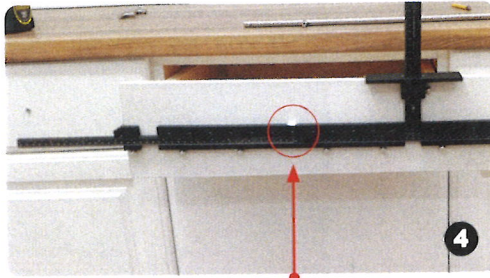

4 Attach the Extended Ruler to the Extension Bar; set 0 mark on Extended Ruler with marked hole on Extension Bar. If 0 mark does not work, use another digit - 10" mark makes for easy math

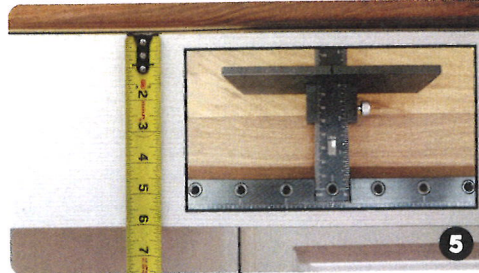

5 Measure height of drawer and set Large Stop to desired location (half of measurement, if centering)



6 Hold stops firmly against top and side of drawer. Drill through marked holes and install hardware



The majority of large handles fit perfectly into our extension bar hole pattern, as large handles usually come in 32mm increments – the same increments as our hole pattern.

Alternative Configuration:

LARGE HANDLE ON WIDE DRAWER FRONT

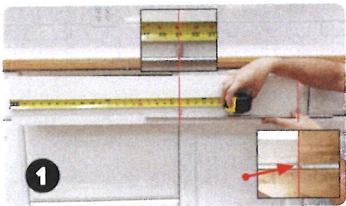

1 Line up center of one end of hardware hole with edge of drawer front and measure from opposite end of drawer to center of other hardware hole to find total length of drawer without hardware

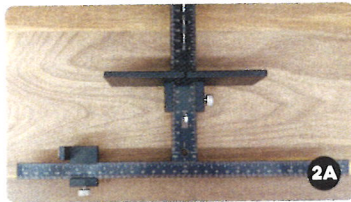

2A Set Sliding End Stop at half the measurement from Step 1
2A If half your measurement is 6-1/4" or under, tighten the Sliding End Stop at your number directly on T-square

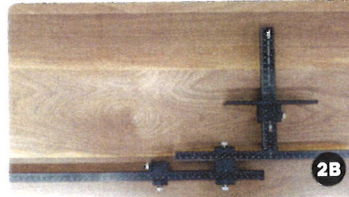

2B If half your measurement is over 6-1/4", attach the Extended Ruler and tighten the Sliding End Stop at your number on the Extended Ruler

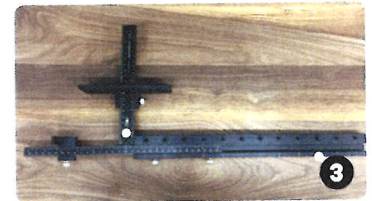

3 Attach one Extension Bar on the side of T-square without Sliding End Stop and use the hole in the center of your T-square as the first hole you will drill through

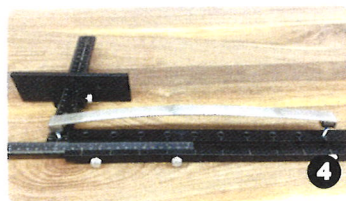

4 Confirm hole spacing using your hardware. Adjust Extension Bar as needed, then tighten Thumb Screws when hardware aligns with holes on Bar

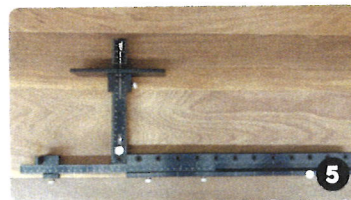

5 Mark selected holes with tape to avoid drilling through incorrect holes

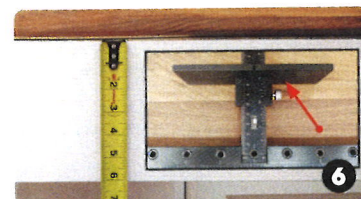

6 Measure height of drawer and set Large Stop to desired location (half of measurement, if centering)



7 Hold stops firmly against top and side of drawer. Drill through marked holes and install hardware

USING EXTENDED RULER ATTACHMENT ON DRAWER

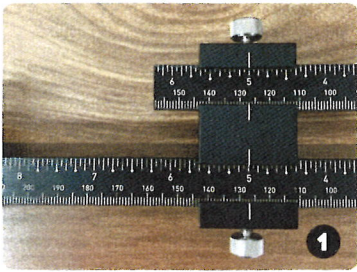

1 Connect Extended Ruler Attachment and Double Bracket to T-square at 5" mark to extend length of ruler to 16"



2 Place hardware (measure as needed) to find position you like; mark hole location with pencil (We are centering on width and height)



3 Measure drawer width to find center

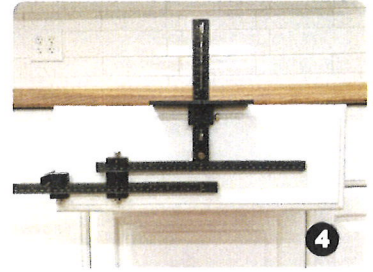

4 Set the Sliding End Stop to half of the drawer width measurement from step 3

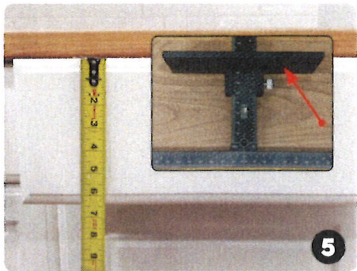

5 Measure height of drawer and set **Large Stop** to desired location and tighten Thumb Screws (half of measurement, if centering)

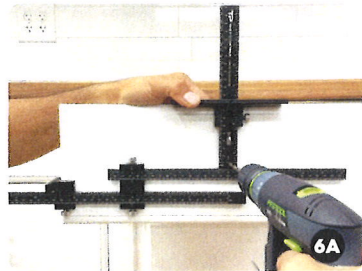

6A. For knobs: drill through center of bushing

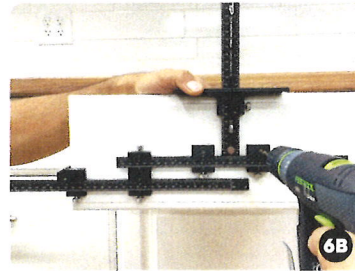

6B. For handles: measure hardware and tighten Sliding Drill Guides to match hardware measurement then drill (refer to Handle on Drawer Front section if more information is needed)

PRO TIP

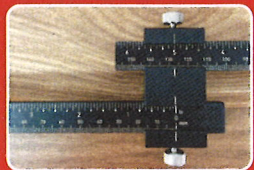

For drawers larger than 32", align 5" mark on T-Square with the 0" mark on the Extended Ruler. Divide the measurement from Step 3 in half and **SUBTRACT 5"**.

Example
40" drawer front: 20" - 5" = 14"
Place Sliding End Stop on 14" mark.

LARGE HANDLE ON DOORS

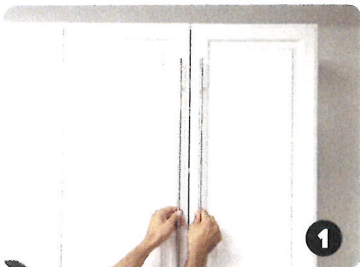

1 Place hardware (measure as needed) to find position you like; mark bottom hole location with pencil



2 Measure from bottom of door to mark



3 Slide the Extension Bars onto the T-Square and tighten Thumb Screws

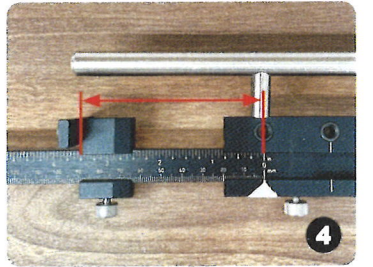

4 Set Extended Ruler at index mark for bottom hole. Set Sliding End Stop to measurement from step 2



5 Measure from side of door to mark

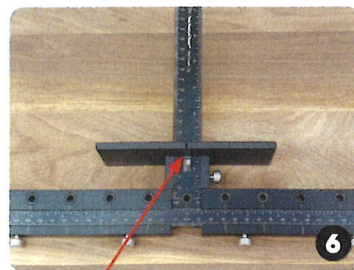

6 Set **Large Stop** to measurement from step 5 and tighten Thumb Screws

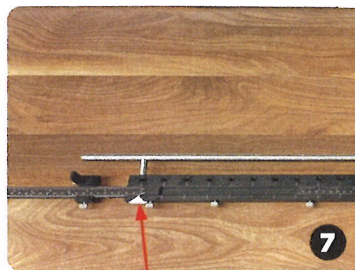

7 Match the **bottom hole** on hardware to bottom hole on Extension Bar and mark with tape

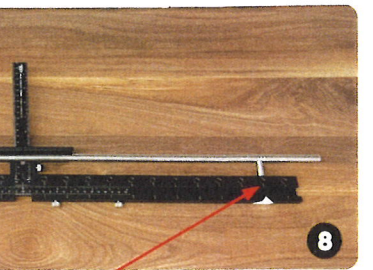

8 Match **top hole** on hardware to matching hole on Extension Bar; mark hole with tape

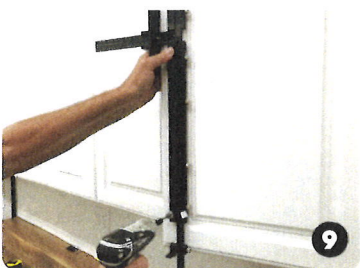

9 Hold both stops firmly against door and drill bottom hole

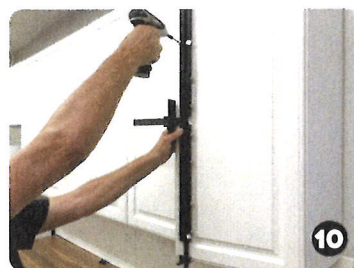

10 Drill top hole

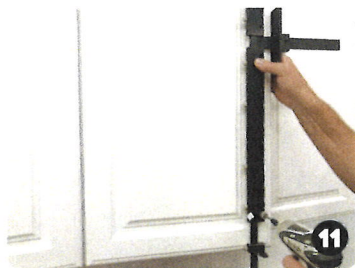

11 Flip tool to its reverse side, place on opposite door and repeat