

# PRODUCT DATA SHEET

**Product Description:** Towel Ring, Clearwater. Post is fabricated from die cast zinc with a US26 bright chrome finish. Ring is fabricated from brass or stainless steel. Ships with mounting hardware.

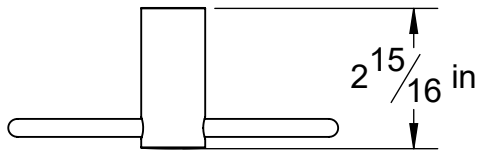
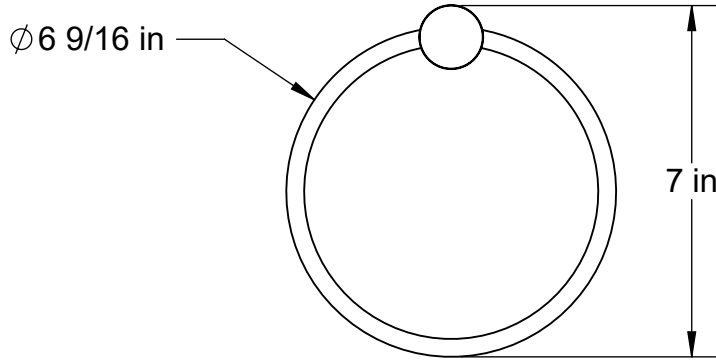

**Overall Size:** 6 9/16" W X 7" H X 2 15/16" D

**Material:** Die Cast Zinc Post, Brass Or Stainless Steel Ring

**Finish:** US26 Bright Chrome

### Cross Reference

Manufacturer	Part Number



Description:

**Towel Ring,  
Clearwater**

Part Number:

**10211**

Date

Rev.

Sheet 1 of 1