

PRODUCT DATA SHEET

Product Description: Plain bearing mortise residential door hinges; 3 1/2 In. X 3 1/2 In. X 5/8 In. radius corners; 2 hinges per pack; 12 X 3/4 In. Phillips head wood screws included; fabricated from steel; US19 matte black finish.

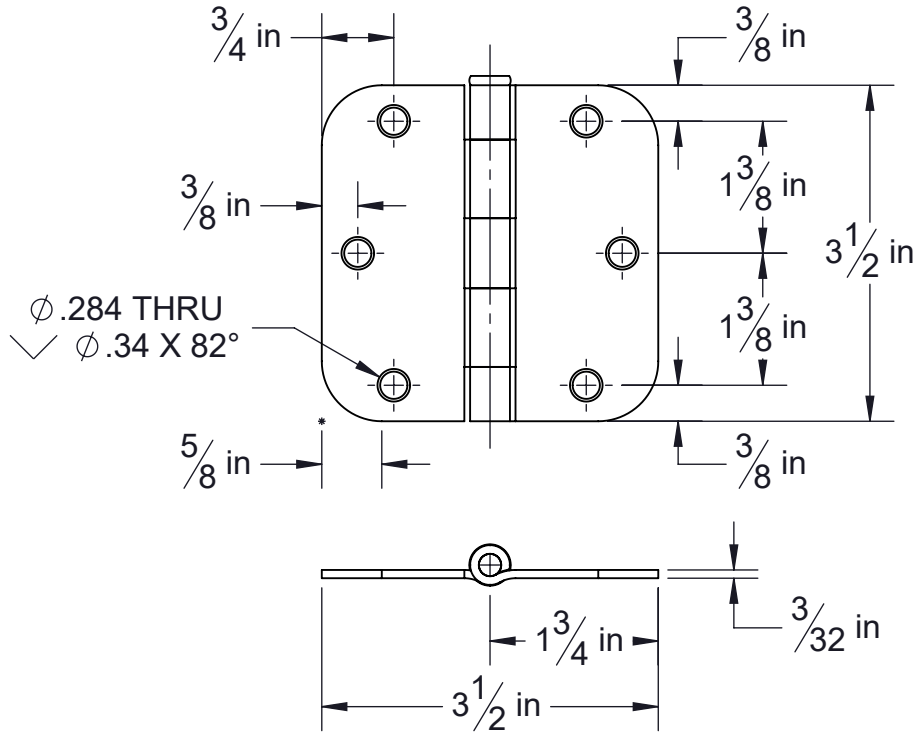

Overall Size: 3 1/2" W X 3 1/2" H X 5/8" Radius

Material: Steel

Finish: US19 Matte Black

Cross Reference

| Manufacturer | Part Number |
|--------------|-------------|
| | |
| | |
| | |



Description:

**Door Hinges, Plain Bearing,
3 1/2 In. X 3 1/2 In. X 5/8 In.,
2 Pack**

Part Number:

35355819

Date

Rev.