



LED BEHAVIORS

⏻ Off - Lights are off

🔗 Connecting - double blinks

🔗 Connected - blue light is on

🔋 Charging - Red light solid

🔋 Charged - Blue light solid

Long press power button to turn off

🔗🔗 Pairing Mode - alternating blue and red lights

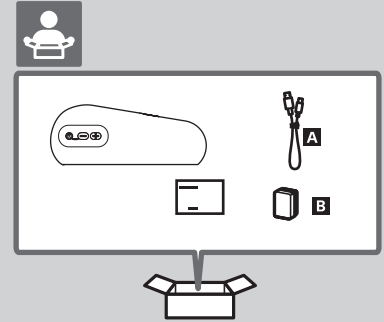

1



CHARGING charge 5 hours before first use

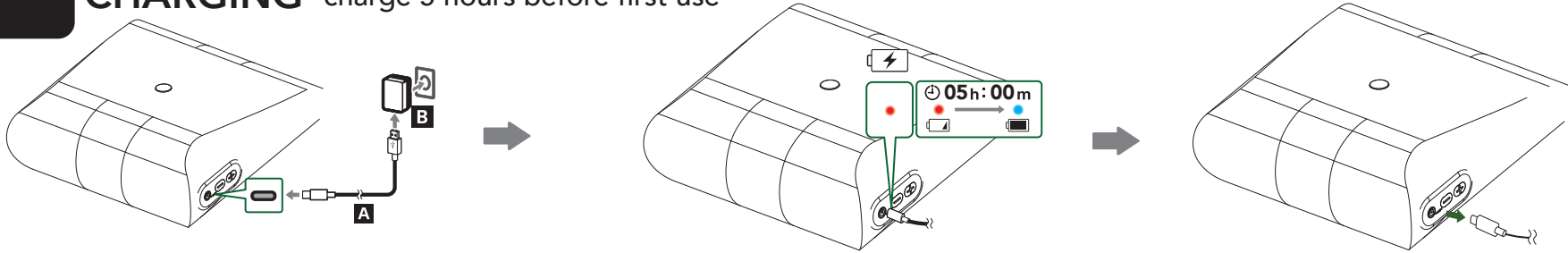

2



Pairing Mode - Long press of the power button puts pillow in pairing mode. Pairing mode is shown with alternating blue and red lights.

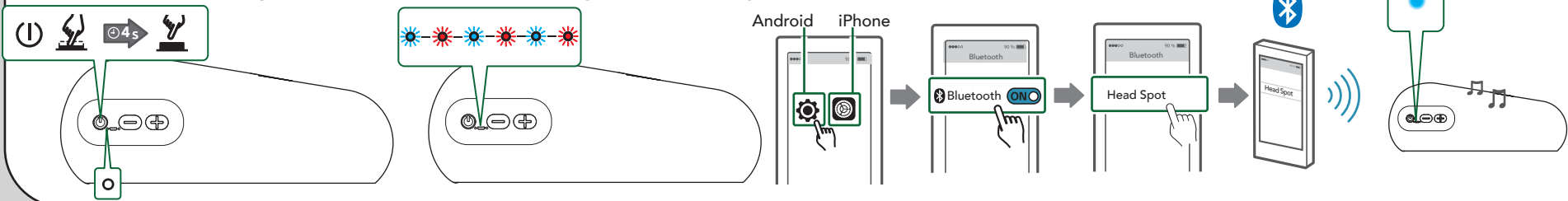

Place ear on Head Spot logo after playing sound.

Lay down on pillow use full weight of your head for best sound.

Move pillow around and see what sound and feels best.

Try laying on your side, try with the control panel on the left or right or on top.