

SERVOX® INTON

Instructions For Use

servo^{na}

BRUCE
MEDICAL SUPPLY

Servox Factory Authorized Distributor and Service Center

Bruce Medical Supply
411 Waverley Oaks Rd., Suite 154
Waltham, Massachusetts 02452
USA

www.BruceMedical.com
Email: sales@brucemedical.com
Phone: 781-894-6262



CE 0197



SERVOX® INTON

Instruction Manual

Instructions for Use

SERVOX® INTON Speech Aid

Page 16-29



Foreword

Dear customer,

We would like to thank you for your trust in purchasing our high-quality product.

The high quality, safety and easy use of the SERVOX® INTON Speech Aid and the LA 2.40 Charger are what distinguish this product from others.

In order to use the SERVOX® INTON and the charger properly, please read these instructions carefully before using it for the first time!

Please note:

This instruction manual is not intended as a replacement for comprehensive speech therapy.

Although the SERVOX® INTON Speech Aid is relatively simple to use, please contact a speech therapist in order to ensure optimal use in view of good vocal rehabilitation.

Contents

Supply Contents	4
Intended Use	4
Safety Instructions	5
Warranty and Product Liability	5
Device Overview	6
Device Description/Functions	7
SERVOX® INTON Speech Aid	7
Inserting the Battery	7
Adjusting the Volume	7
Adjusting the Pitch	7
Fine Pitch Settings	9
Operating the Buttons	9
Intonation (Speech Melody)	9
Other	9
Hip Bag/Holster	10
Accessories	10
Oral Connector with Adapter	10
LA 2.40 Charger	11
General Instructions	11
Functional Details	12
Error Messages	12
Maintenance	13
Cleaning	13
Repair	13
Note regarding serial number	13
Disposal	13
Technical Data	14
Dimensions	14
Weights	14
Electrical Values: Battery	14
Electrical Values: Charger	14
Other	14
Symbols Key	15

Supply Contents

Intended Use

Supply Contents:

- **SERVOX® INTON Speech Aid (electrolarynx)**
- **NiMH Battery**
- **Hip Bag**
- **Carrying Cord**
- **LA 2.40 Charger (110 V or 230 V)**
- **Adjustment screwdriver**
- **Instructions for Use**

The SERVOX® INTON Speech Aid offers patients who have lost their voice due to an injury, illness or surgical removal of the larynx the opportunity to make themselves quickly understood again.

The SERVOX® INTON can also be used by patients who experience a temporary speech loss after a tracheotomy because they have to rest their vocal cords or are attached to a respiration device.

Even patients who have mastered the use of the oesophageal voice can use the SERVOX® INTON in various situations, e.g. when speaking on the phone, during business conferences, if tired, ill or in very stressful situations, in case of emergency and in environments where it is necessary to raise the voice.

The SERVOX® INTON may only be used for the applications listed above. Servona is not liable for damages of any kind resulting from any other use.



Safety Instructions

The SERVOX® INTON Speech Aid has been developed using the latest technology. The production is subject to constant quality control.

- **Do not expose the device to extremely cold or hot temperatures!**
- **Protect the charger from temperatures above 30°C (86°F)!
(Do not place in direct sunlight, on top of or next to heat sources, such as a heater or stove).**
- **Do not drop the SERVOX® INTON!**
- **Never drop the speech aid or charger in water or other fluids!**
- **Never use the charger in moist or wet areas!**
- **Never place the SERVOX® INTON against the tracheostoma!**
- **Do not hold the speech aid directly to the ear!**

Please note:

The manufacturer is not liable for any damages to people, items or pets which occur as a result of failure to comply with the instructions for use or safety precautions.

Warranty and Product Liability

The parts and materials are covered under a 24-month warranty (6-month warranty on batteries). The owner or warranty claimant are responsible for settling the shipping costs. Only original replacement parts and accessories may be used.

In the case of non-compliance, or if repairs or alterations to the SERVOX® INTON and/or the LA 2.40 Charger or its components are carried out by unauthorised persons, the warranty becomes invalid. In such cases any product liability on the part of Servona GmbH is ruled out.

Device Overview

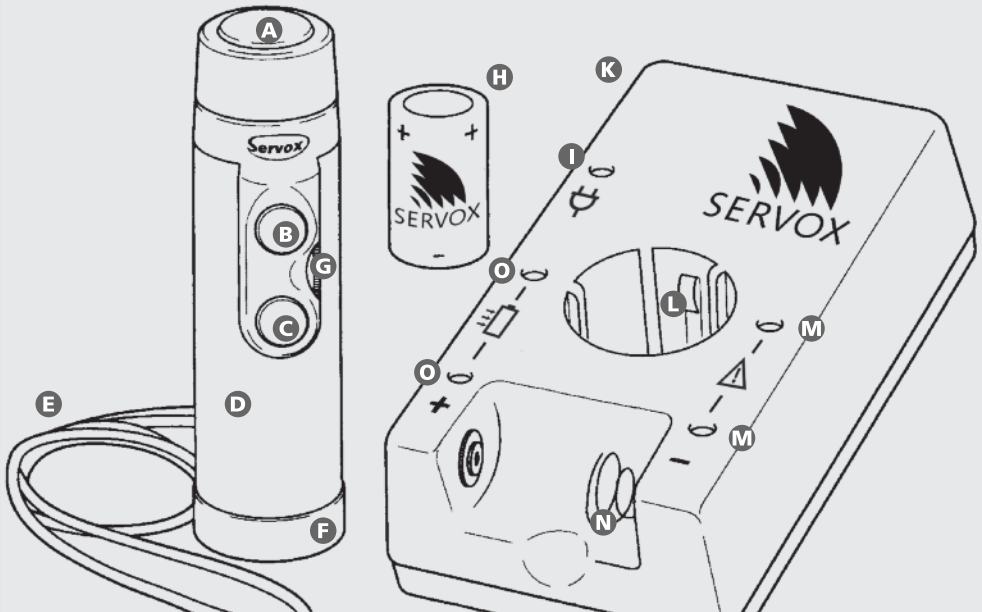

- A** Hard Membrane
- B** Baseline Button (top operating button)
- C** Accentuation Button (lower operating button)
- D** Titanium Housing
- E** Carrying Cord
- F** Bottem Cover
- G** Volume Control
- H** Battery
- I** Power Display (green LED)
- K** Charger
- L** Charging Port for SERVVOX® INTON
- M** Error Display (red LED)
- N** Charging Compartment for Spare Battery
- O** Charge Display (yellow LED)

Device Description/Functions

SERVOX® INTON Speech Aid

Inserting the Battery

Completely charge the NiMH battery in the charger before using the device for the first time (see LA 2.40 Charger General Instructions). Remove the bottom cover and place the battery into the device with the minus pole ('-') pointing away from you.

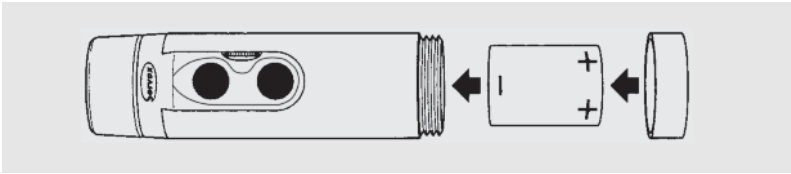

Please note:

For optimal use the batteries should be alternated, i.e. after each use the battery should be swapped. You can number the batteries to make this easier.

Adjusting the Volume

You can adjust the volume by using the volume control. By turning it upwards, the sound becomes louder; downwards, the sound becomes softer. The quality of your voice will be best when the volume is at the lowest possible (but still audible) setting when using the device directly on the neck or cheek.

Adjusting the Pitch

It is recommended that a similar pitch is chosen to that of the natural voice. The frequency must be adjusted separately for each button.

The following steps are necessary for changing the pitch:

1. Unscrew the bottom cover and remove battery.

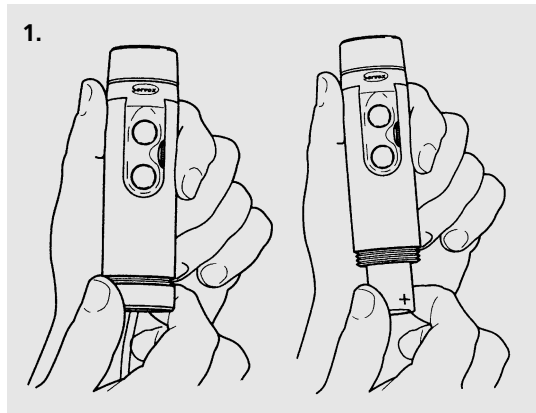

2.

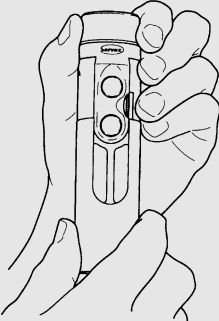

2. Hold the top of the device and slide off the titanium housing.

3. Place the battery back into the battery compartment and screw the bottom cover back on.

4. In order to adjust the baseline frequency, carefully adjust the control (pictured in the diagram) using the plastic screwdriver:

Higher pitch (H) = Turn anti-clockwise.

Lower pitch (L) = Turn clockwise.

5. Check if the new pitch meets your expectations by using the basic tone button (top button). Family members or close friends can help with finding the 'right' pitch by listening to you speaking at trial pitch levels.

6. You can finely adjust the tone by turning the sound cap (see chapter 'Fine Pitch Adjustment').

7. After adjusting the basic pitch, unscrew the bottom cover and remove the battery. Then slide on the titanium housing, place the battery in the battery compartment and screw on the bottom cover tightly.

3.

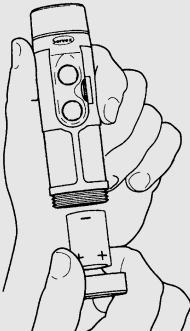

4.

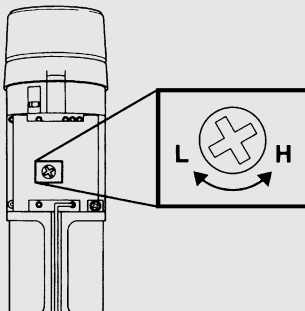

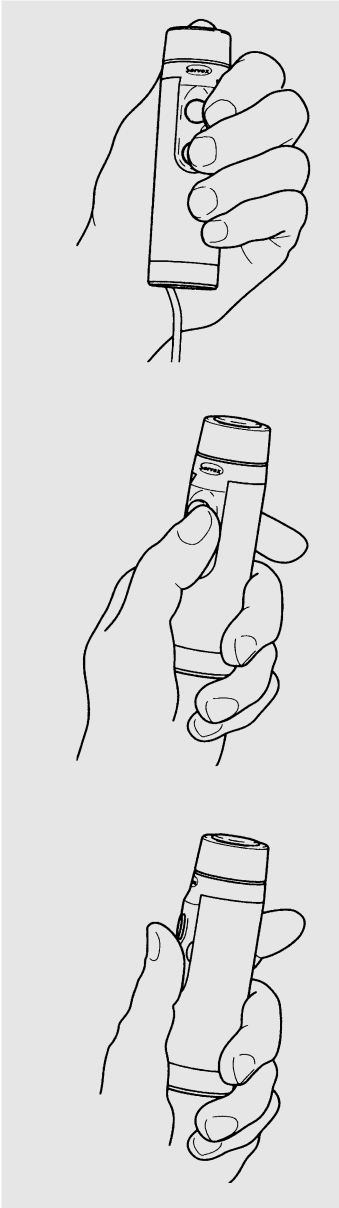

Fine Pitch Settings

If the tone is too 'unclear', the sound cap must be screwed on more tightly. Please be careful not to turn the sound cap too far, as it could be damaged. To achieve a pure tone at maximum volume, the sound cap can be loosened slightly.

Please note:

To avoid over tightening, the speech aid is fitted with an O-ring. After a too tight or too loose adjustment the volume is reduced.

Operating the buttons

All SERVVOX® INTON Speech Aid users should first practice speaking using the baseline button only. The accentuation button should only be used once you have become comfortable using the baseline pitch.

Switch off

The device can be switched off by turning the battery cover halfway to the left (e.g. to avoid undesired sounds while wearing).

You can wear the device around your neck using the carrying cord.

Hip Bag

This bag can be adjusted to fit various belt widths and is attached using the Velcro closure on the back side. A separate compartment allows for the convenient and safe storage of a replacement battery.



Accessories

These products are not included in the supply contents. These accessories can be ordered separately if desired.



Oral Connector with Adapter

With the help of the oral connector with adapter, the SERVVOX® INTON Speech Aid can be used directly after the laryngectomy and during periods of radiation treatment or when the throat is still too sensitive or swollen to use the speech aid alone.

Attention:

Read the separate instruction sheet!

LA 2.40 Charger



General Instructions

- Never use the charger in moist or wet areas!
- Never place the device on a heater or in direct sunlight while it is being charged! The optimal performance of both the device and battery is achieved at temperatures from +10°C to +30°C (50°F – 86°F).
- Batteries placed in the device gradually discharge themselves if the charger is not plugged into a power socket.
- To operate the charger, attach the power cord to a power socket. Only after this the battery or the speech aid can be used.
Attention: Make sure that the main voltage corresponds to the date on the identification plate!
- To charge the SERVOX® INTON Speech Aid, simply place it in the LA 2.40 Charger and remove it when needed. A second battery can be charged at the same time and is therefore always ready for use. (Please make sure the polarity is correct!)
- The amount of charging time required depends on the remaining battery capacity and whether 1 or 2 batteries are being charged at the same time.
- The replacement battery and SERVOX® INTON Speech Aid can always be kept in the charger, as the electronics of the device prevent over-charging.

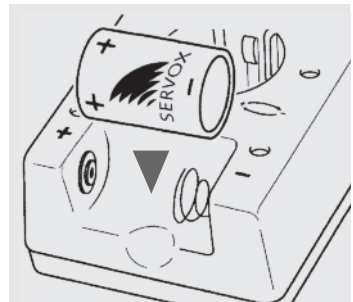

Functional Details

Operating	Display	Significance
Connect power cord	Green control light remains constantly illuminated	The charger is in proper working order
Speech aid and/or replacement battery in charger shaft	Yellow control light illuminates	The battery is being charged
	Yellow control light flashes in 2-seconds interval	The battery is about 80-85% charged. The charger switches to a lower charging current to ensure that the battery is optimally charged
	Yellow control light not illuminated	The battery is optimally charged

Error Messages

Display	Significance	Solution
Yellow control light flashes in 1-second interval.		
– immediately	The battery is defective.	Insert a new battery. A defective battery must be disposed properly.
– after 5 minutes	Battery was deep discharged and could not be formatted.	Insert a new battery. A defective battery must be disposed properly.
– after several hours	The battery is defective.	Insert a new battery. A defective battery must be disposed properly.
Red control light illuminates and yellow control light flashes in 1-second interval.	The battery was inserted incorrectly.	Insert the battery in such a way that the polarity (+ and –) is correct. Please note: If the battery is inserted incorrectly, a second battery will not charge either!

Maintenance

Cleaning

- The exterior of the SERVOX® INTON as well as the batteries can be cleaned using a cloth soaked in alcohol.
- The charger may only be cleaned with a dry cloth.
- When using household cleaners, please observe the instructions for use from the respective manufacturers.
- The battery contacts inside the SERVOX® INTON and on the battery themselves can be cleaned using an eraser. Clean the contacts regularly. Dirty or oxidised contacts may lead to interruptions in sound.

Repair

Please do not attempt to make any repairs on your own! In the event that a repair becomes necessary, send the SERVOX® INTON, together with the charger and batteries, in the original packaging to your local distributor.

Note regarding serial number

To locate the speech aid serial number, unscrew the bottom cover and slide off the titanium housing. The serial number is on a label on the plastic housing below the operating buttons.

The serial number of the LA 2.40 charger is found on the bottom of the housing on the inscription plate.

For your safety and to maintain the warranty, only original replacement parts may be used. If you have questions about replacement parts and accessories, please contact your local distributor.

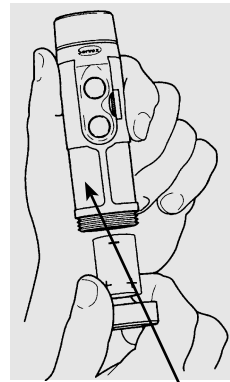

serial number

Disposal

This product is classified within the scope of EU Directive 2002/96/EU (WEEE) and is not allowed to be disposed of in the normal household waste.

Technical data

Dimensions

Speech Aid:	L 118 x Ø 35 mm (L 4.65 in x Ø 1.38 in)
Charger:	85 x 45 x 146 mm (W 3.35 in x H 1.77 in x L 5.75 in)
Sound:	Frequency range: ~ 60 – 160 Hz

Weights

Speech Aid:	110 g (0.24 lb) without battery
Charger:	380 g (0.84 lb) without battery
Battery:	60 g (0.13 lb)

Electrical Values NiMH Battery

Voltage:	7.2 V DC
----------	----------

Electrical Values Charger

Input Voltage:	110 V~ or 230 V~/50 - 60 Hz
Output voltage:	18 V= max.
Power:	5.2 VA
Charging current:	80 mA max.
Short Circuit Current 230 V:	50 mA max.
Short Circuit Current 110 V:	100 mA max.
Environment temperature:	+10°C to +30°C (50°F - 86°F) (full performance) 0°C to +40°C (32°F - 104°F) (still permissible)

Rights reserved for technical changes!

Symbols Key

	The battery charger is connected to the mains voltage!
	Battery is being charged
	Warning: Please consult Instructions for Use – special instructions
	Enclosed safety transformer
	Safety class II device
	Only for indoor use
	The device is a medical device and complies with the conditions relevant to EU Guideline 93/42/EEG Annex I for Medical Products and is inspected by the appropriate authorities. It was classified as a Class IIa product according to Annex I.
	This product is not allowed to be disposed of in normal household waste. Please contact the public waste management organisations in your country regarding the disposal of this product in accordance with the applicable regulations.



Servox Factory Authorized Distributor and Service Center

Bruce Medical Supply
411 Waverley Oaks Rd., Suite 154
Waltham, Massachusetts 02452
USA

www.BruceMedical.com
Email: sales@brucemedical.com
Phone: 781-894-6262

All rights reserved.
**Reprint, including excerpts, only with
the permission of Servona GmbH.**



BRUCE
MEDICAL SUPPLY

**Servox Factory Authorized
Distributor and Service Center**

Bruce Medical Supply
411 Waverley Oaks Rd., Suite 154
Waltham, Massachusetts 02452
USA

www.BruceMedical.com
Email: sales@brucemedical.com
Phone: 781-894-6262

Herstellung und Vertrieb durch:
Production and sales:
Production et vente :

servona

Servona GmbH

Biberweg 24-26 | D-53842 Troisdorf
P.O. Box 92 01 06 | D-53831 Troisdorf
Tel. +49 (0)22 41.93 22-0
Fax +49 (0)22 41.93 22-277
info@servona.com | www.servona.de



18983