

RPP-3PORT

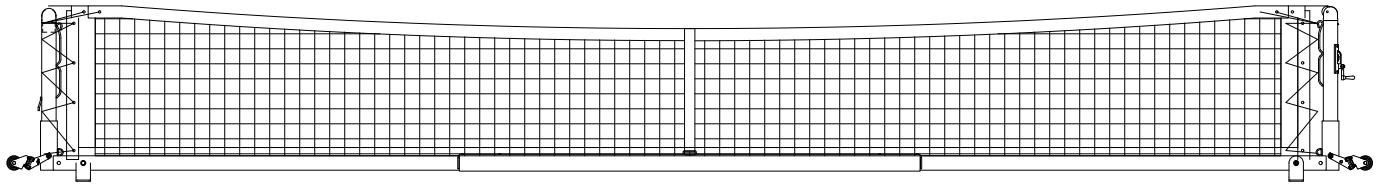

Assembly and Use Instructions

Call Jaypro Sports at 1-800-243-0533 during
regular business hours for technical support.
www.jayprosports.com

ASSEMBLY AND USE INSTRUCTIONS

FIRST ENSURE YOU HAVE ALL PARTS. NOTE FASTENERS, NET, CENTER STRAP, AND DECALS NOT DEPICTED.

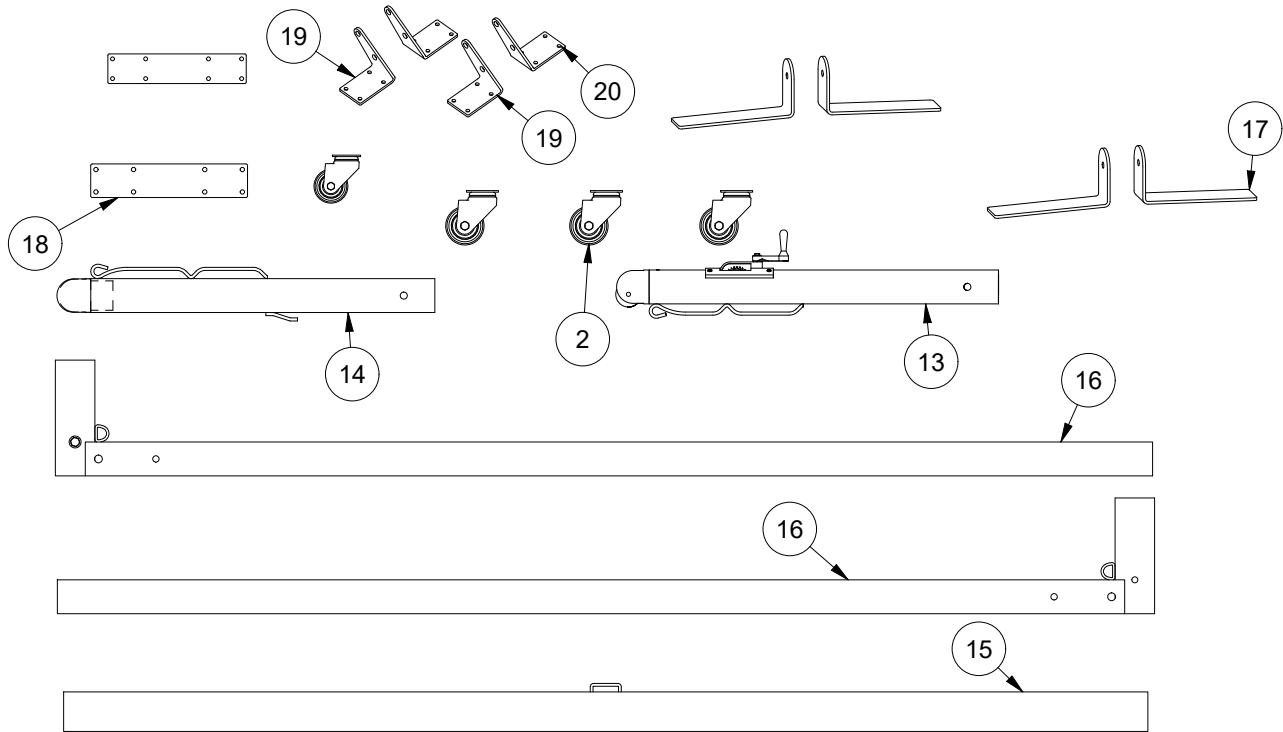

ITEM	QTY	PART #	DESCRIPTION
1	1	VA-17	CENTER STRAP
2	4	CS0003	3" CASTER WHEEL
3	2	HM124	.5 x 4 QUICK RELEASE PIN ZP
4	16	HN261	5/16-18 UNC-Nylon Lock Nut-ZP-GrNC
5	2	HN704	1/2 - 13 Hex Nut - ZP - GrNC
6	6	HS5399	1/4-20 x 1/2 HEX BUTTON CAP SCREW-SS
7	16	HS281	5/16-18 x 1-1/4 HEX CAP SCREW-ZP-GrNC
8	2	HS5048	1/2-13 x 4-1/2 HEX CAP SCREW-ZP-Gr5
9	8	HW2044	1/2 SAE WASHER-ZP-GrNC
10	32	HW2083	5/16 STD WASHER-ZP-GrNC
11	1	LL0069	RPP-3PORT WARNING LABEL
12	1	PT-21N	PICKLEBALL NET
13	1	RPP-3PORT-AA	RPP-3PORT POST WINCH END
14	1	RPP-3PORT-BB	RPP-3PORT POST ANCHOR END
15	1	RPP-3PORT-C	RPP-3PORT CENTER WELDMENT
16	2	RPP-3PORT-L	RPP-3PORT SLEEVE AND OUTER BASE WELDMENT
17	4	SR5694	RPP-3PORT FOOT TAB
18	2	SR5696	RPP-3PORT WHEEL PLATE
19	2	SR5697	RPP-3PORT WHEEL TAB 2
20	2	SR5698	RPP-3PORT WHEEL TAB 1
21	2	LL0103	CENTER BASE DECAL
22	4	LL0215	POST DECAL
23	2	LL0090	LOCATING LINE DECAL
24	2	LL0089	PINCH POINT WARNING LABEL
25	2	HS5062	1/2-13 x 5 HEX CAP SCREW-ZP-GrNC
26	2	HN2951	1/2-13 UNC-Nylon Lock Nut-ZP-GrNC
27	1	HM6188	5/32" ALLEN WRENCH
28	2	RR5022	BUNGEE BALLS



RPP-3PORT

www.jayprosports.com / (800) 243-0533 / 976 Hartford Tpke, Waterford, CT 06385 USA

SUBJECT TO CHANGES IN DESIGN AND MANUFACTURING
© COPYRIGHT 2022 JAYPRO SPORTS, LLC. ALL RIGHTS RESERVED

Sheet 2 of 7

ASSEMBLY AND USE INSTRUCTIONS

IMPORTANT: ASSEMBLY SHOULD BE DONE WITH TWO PEOPLE.

1. ASSEMBLE BOTH OF YOUR WHEEL KITS. BEFORE FULLY TIGHTENING HARDWARE.

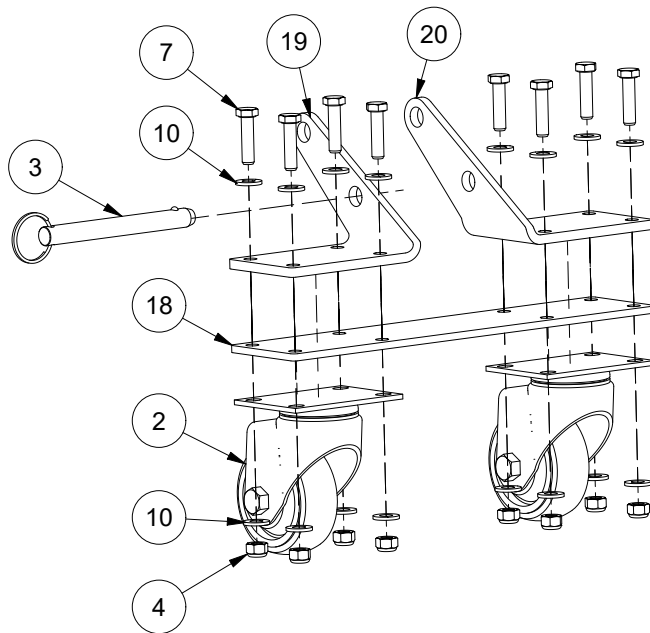

WARNING:
NEVER ATTEMPT TO SLIDE FRAME TOGETHER OR APART WHILE WHEELS ARE ENGAGED OR STABILIZER FEET ARE INSTALLED.

ENGAGE WHEELS TO LIFT SYSTEM OFF FEET, ROTATE FEET, THEN DISENGAGE WHEELS AND SET SYSTEM GENTLY ON GROUND BEFORE SLIDING TOGETHER OR APART.

2. LAY OUT YOUR FRAME PIECES AS SHOWN BEFORE INSERTING ENDS INTO CENTER. WHEN SLIDING ENDS INTO CENTER, LIFT GENTLY AND PUSH FROM POST SLEEVE. IT IS CRITICAL TO HOLD SLEEVE SUCH THAT ALL SURFACES ARE PARALLEL AND BOTTOM CLEARS PLAYING SURFACE WHILE SLIDING. ALL PARTS SHOULD BE FREE OF DIRT AND DEBRIS BEFORE SLIDING.

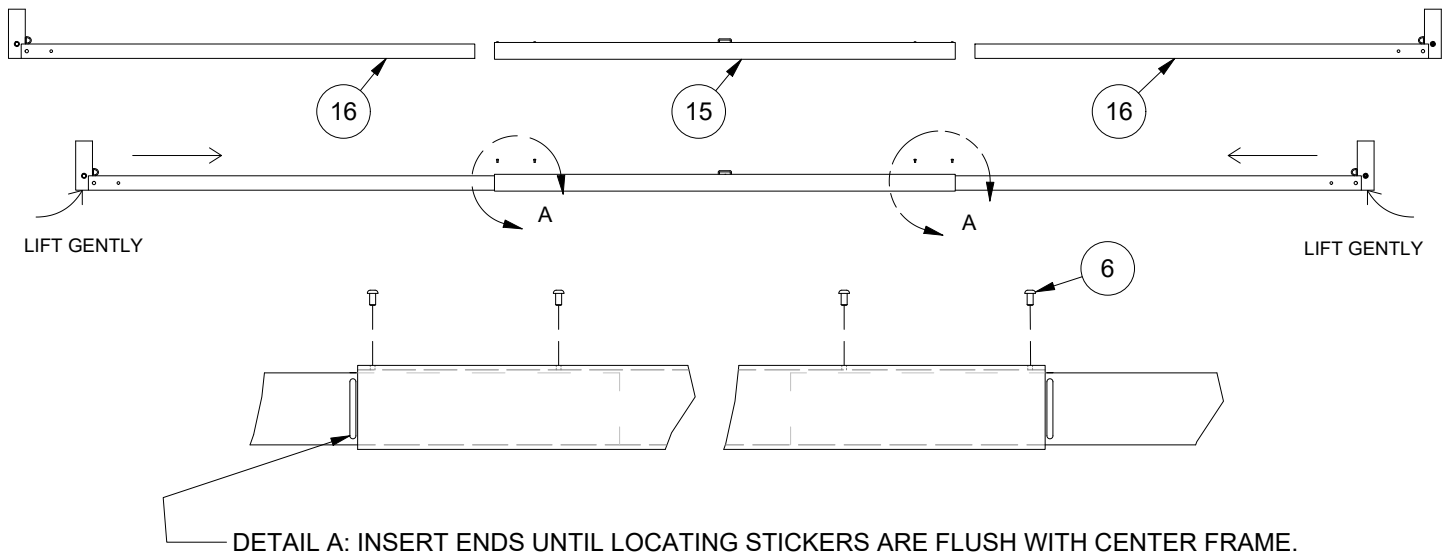

IMPORTANT: MAKE SURE THE THREE SECTIONS ARE ALIGNED IN A STRAIGHT LINE. THIS CAN BE VIEWED BY LOOKING STRAIGHT ON FROM ONE END. SECURE SYSTEM WITH SET SCREWS. TIGHTEN UNTIL SCREWS ARE FLUSH.

IF USING INDOORS, ATTACH THE PROTECTIVE RUBBER STRIPPING UNDER THE CENTER TUBE (15) AND EACH OF THE 4 FEET. ONLY 3" OF THE STRIPPING IS NEEDED PER FOOT.



RPP-3PORT

www.jayprosports.com / (800) 243-0533 / 976 Hartford Tpke, Waterford, CT 06385 USA

SUBJECT TO CHANGES IN DESIGN AND MANUFACTURING
© COPYRIGHT 2022 JAYPRO SPORTS, LLC. ALL RIGHTS RESERVED

Sheet 3 of 7

ASSEMBLY AND USE INSTRUCTIONS

3. ONCE YOUR FRAME IS ASSEMBLED, INSERT YOUR POSTS INTO THEIR SLEEVES. ENSURE THE HOLES AT THE BOTTOM OF THE POSTS LINE UP WITH THE HOLES IN THE SLEEVES.

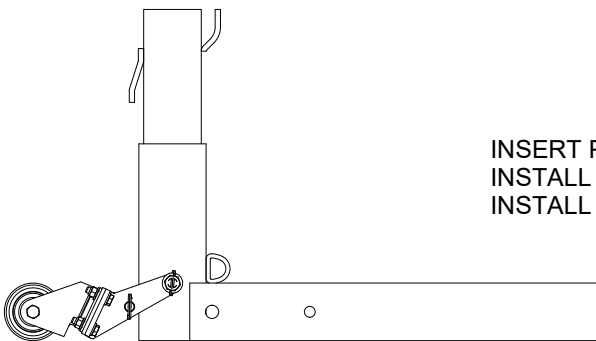
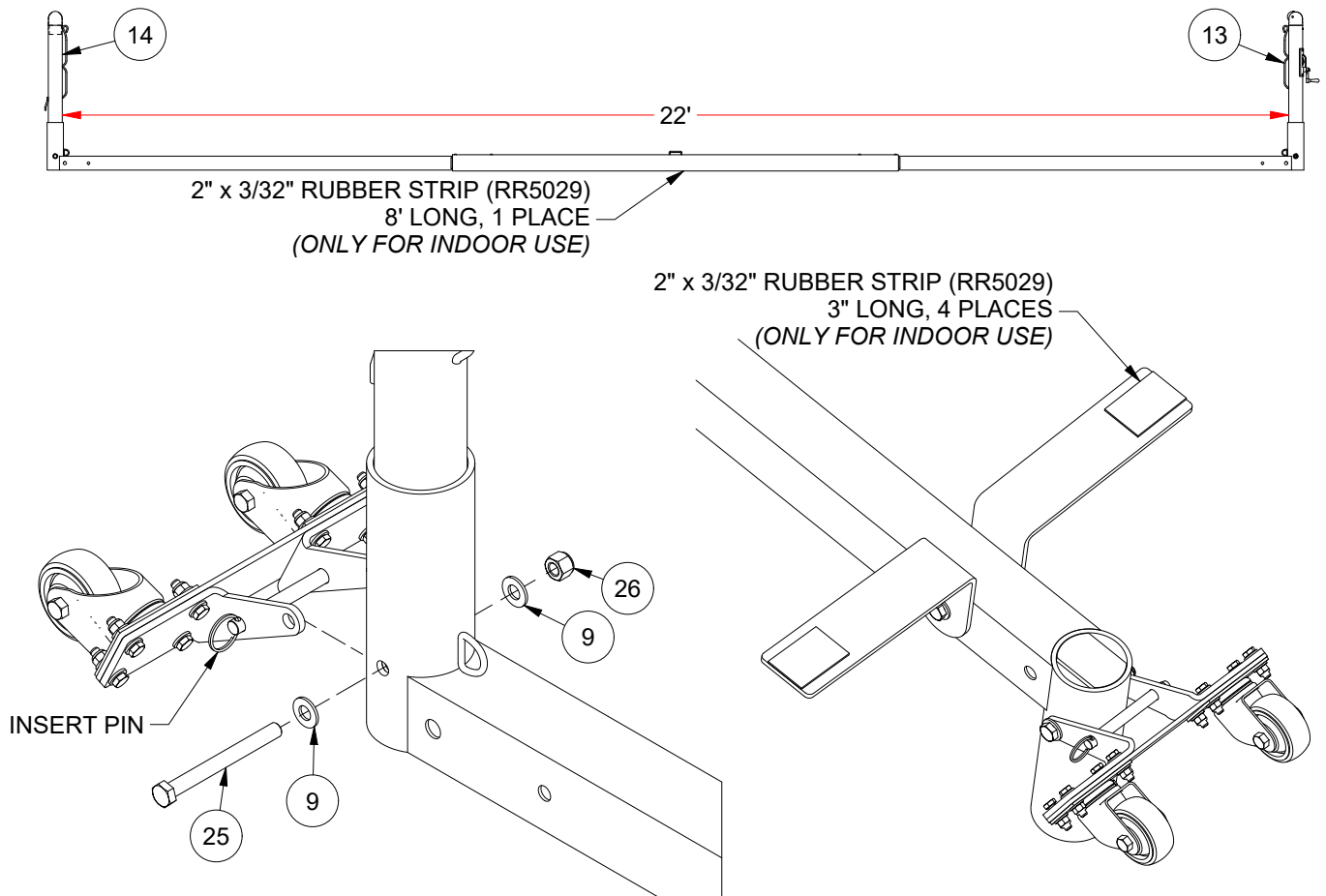

RPP-3PORT

www.jayprosports.com / (800) 243-0533 / 976 Hartford Tpke, Waterford, CT 06385 USA

SUBJECT TO CHANGES IN DESIGN AND MANUFACTURING
© COPYRIGHT 2022 JAYPRO SPORTS, LLC. ALL RIGHTS RESERVED

Sheet 4 of 7

ASSEMBLY AND USE INSTRUCTIONS

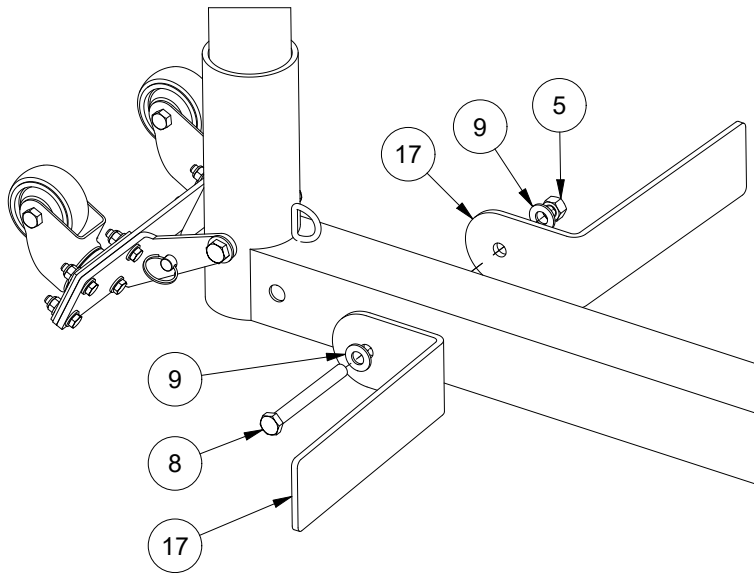

INSTALL STABILIZER FEET ON BOTH ENDS OF THE SYSTEM. THIS MUST BE DONE WHILE THE WHEELS ARE IN PLAYING POSITION. LOOSELY ASSEMBLE HARDWARE.

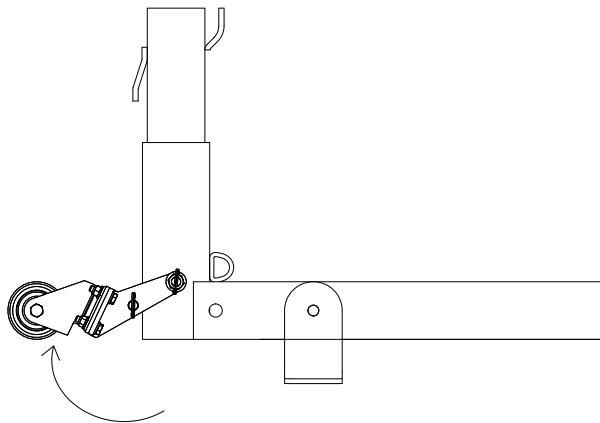

RAISE EACH END, ONE AT A TIME, AND ROTATE THE FEET INTO THEIR PROPER POSITION. COMPLETE TIGHTENING THE HARDWARE.

A SECOND PERSON MAY BE REQUIRED TO FLIP WHEELS WHILE THE FRAME IS HELD UP. USE CAUTION TO AVOID INJURY.

NOTE: WHEELS MAY BE COMPLETELY REMOVED DURING PLAY.

ASSEMBLY AND USE INSTRUCTIONS

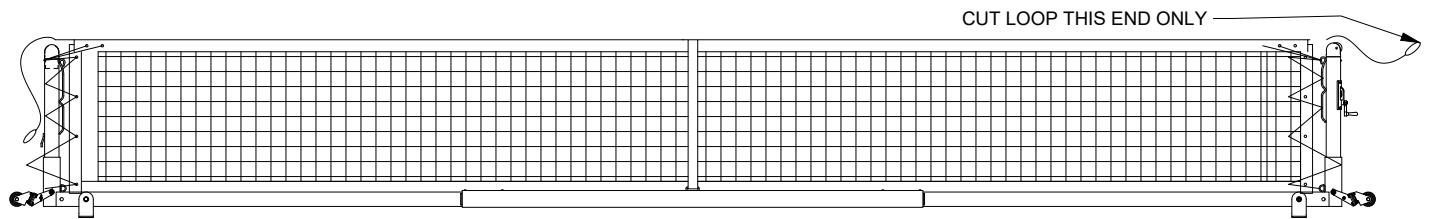

NET INSTALLATION:

1. CUT OFF LOOP AND APPROXIMATELY 8" OF CABLE AT ONE END OF TOP NET CABLE, INSERT INSIDE THE WINCH POST, AS SHOWN.
2. ATTACH LOOP ON OTHER END OF NET CABLE TO HOOK ON OUTSIDE OF STATIC POST.
3. GUIDE CABLE INTO WINCH HOUSING AND INSERT THROUGH HOLE IN THE WINCH WHEEL.
4. ENSURE PULLEY WHEEL/CABLE TRACK AT TOP OF EACH POST IS IN LINE WITH NET CABLE.
5. TURNING THE HANDLE COUNTER-CLOCKWISE, TIGHTEN CABLE SO CENTER OF NET IS APPROXIMATELY 35 1/2". DO NOT OVER TIGHTEN.
6. CENTER NET AND TIE OFF HEAD BAND ROPES AROUND EACH POST.
7. LACE NET SIDE BANDS TO POSTS USING BLACK LACING CORD THROUGH GROMMETS AND NET RAILS ON SIDES OF POSTS.
8. USING A CENTER STRAP IS OPTIONAL. IF USING THE CENTER STRAP ADJUST HEIGHT AT CENTER TO 34".

NET REMOVAL:

1. WHEN REMOVING THE NET IMMEDIATELY TIE A LOOP INTO THE CABLE AFTER RELEASING FROM THE WINCH. THIS WILL PREVENT THE CABLE FROM PULLING THROUGH THE HEADBAND.



RPP-3PORT

www.jayprosports.com / (800) 243-0533 / 976 Hartford Tpke, Waterford, CT 06385 USA

SUBJECT TO CHANGES IN DESIGN AND MANUFACTURING
© COPYRIGHT 2022 JAYPRO SPORTS, LLC. ALL RIGHTS RESERVED

Sheet 6 of 7

ASSEMBLY AND USE INSTRUCTIONS

INSTRUCTIONS TO COLLAPSE SYSTEM TO 16' FOR STORAGE:

1. REMOVE NET OR RELEASE NET TENSION UNTIL THERE IS NO TENSION ON POLES.
2. ENGAGE WHEELS TO LIFT SYSTEM OFF STABILIZER FEET.
3. LOOSEN THE HARDWARE HOLDING THE STABILIZER FEET, AND ROTATE THE FEET UP. TIGHTEN THE HARDWARE TO HOLD THE FEET IN POSITION.
4. DIS-ENGAGE WHEELS AND GENTLY PLACE SYSTEM BACK ON GROUND.
5. COMPLETELY REMOVE THE TWO SET SCREWS ON ONE SIDE.
6. CLEAR SYSTEM OF DIRT AND DEBRIS THEN SLIDE FREE SIDE INTO THE CENTER.
7. PUSH FROM THE SLEEVE/ POST AND GENTLY LIFT TO ENSURE ALL SURFACES ARE PARALLEL WHILE SLIDING.
8. REINSTALL SET SCREWS - ONLY HAND TIGHTEN.

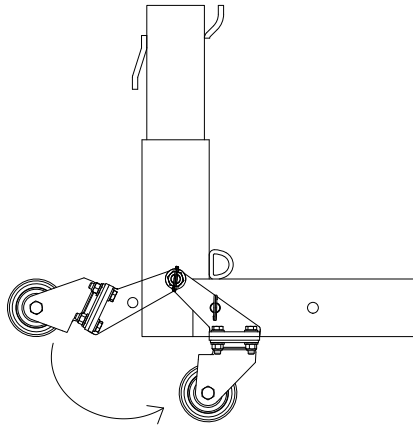

9. ENGAGE THE WHEELS BY LIFTING EACH END OF THE SYSTEM AND FLIPPING THE ASSEMBLIES UNDER THE FRAME.

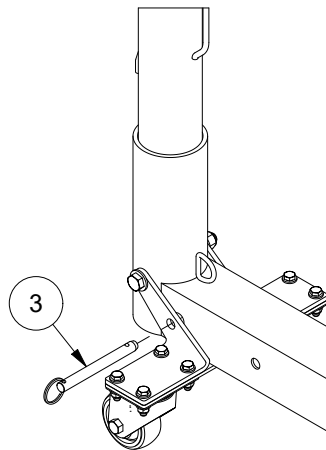

10. LOCK WHEELS WITH QUICK RELEASE PIN. NEVER MOVE SYSTEM WITHOUT LOCKING WHEELS.

WARNING:
NEVER ATTEMPT TO SLIDE FRAME TOGETHER OR APART WHILE WHEELS ARE ENGAGED OR STABILIZER FEET ARE INSTALLED.

ENGAGE WHEELS TO LIFT SYSTEM OFF FEET, ROTATE FEET, THEN DISENGAGE WHEELS AND SET SYSTEM GENTLY ON GROUND BEFORE SLIDING TOGETHER OR APART.

NOTE: A SECOND PERSON MAY BE REQUIRED TO FLIP WHEELS WHILE THE FRAME IS HELD UP. USE CAUTION TO AVOID INJURY.

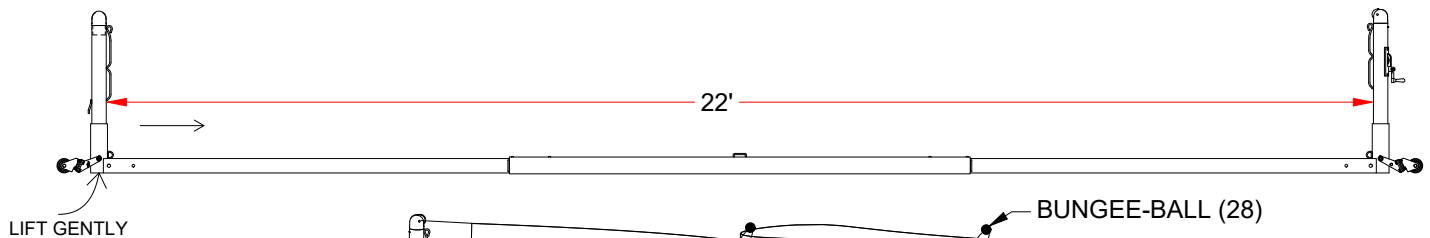

11. NET CAN BE REMOVED OR SLACK FOLDED.

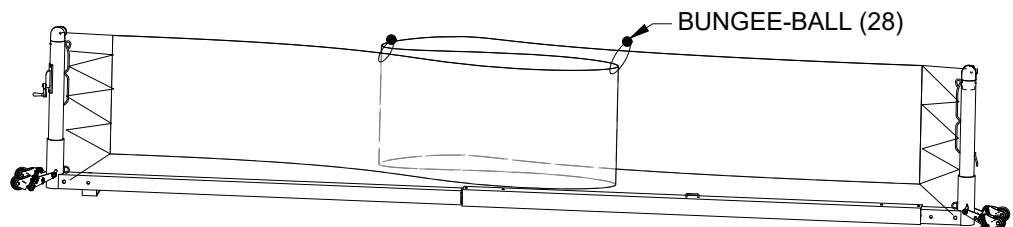

12. RE-ENGAGE AND LOCK WHEELS TO TRANSPORT AS NEEDED

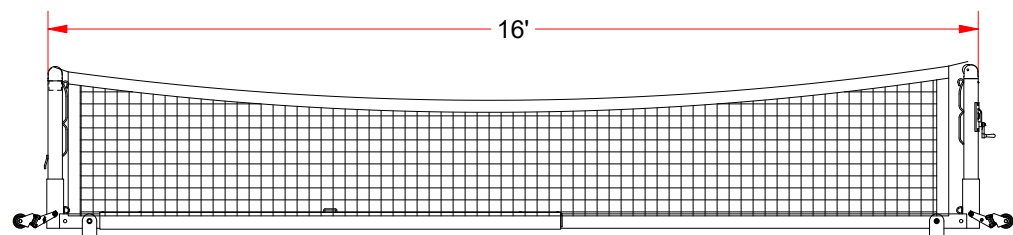

RPP-3PORT

www.jayprosports.com / (800) 243-0533 / 976 Hartford Tpke, Waterford, CT 06385 USA

SUBJECT TO CHANGES IN DESIGN AND MANUFACTURING
© COPYRIGHT 2022 JAYPRO SPORTS, LLC. ALL RIGHTS RESERVED

Sheet 7 of 7