

18G45GT 18GS45GT

Indoor Emergency Safety Shower Type: Combination, Top Water Inlet

Floor mounted unheated emergency safety shower with closed ABS bowl eye/face wash unit, available with either galvanized mild steel or stainless steel pipework. These ANSI compliant models are ideal for use in indoor applications not subject to the possibility of freezing or over heating. Includes universal eye wash and shower sign for enhanced visibility.



Specifications

MATERIALS OF CONSTRUCTION	
PIPEWORK AND FITTINGS (G)	Galvanized mild steel tubulars and fittings
PIPEWORK AND FITTINGS (GS)	Stainless steel tubulars and fittings
OPERATING VALVES	Shower: 316L stainless steel, two piece stay open valve Eye/face: chrome plated brass
SHOWER SPRAY OUTLET	Machine molded nylon 6 red shower nozzle
EYE/FACE WASH BOWL/LID	Acrylic capped ABS
EYE WASH DIFFUSERS	Chrome plated brass with stainless steel mesh
SERVICES	
WATER INLET	1 1/4 in Female NPT
DESIGN OPERATING PRESSURE	2.0 to 6 BAR G (29 to 87 PSI)
TEST PRESSURE	10.3 BAR G (149 PSI)
MINIMUM FLOW AT OPERATING PRESSURE	Shower: 76 liters/minute minimum (20 US Gallons). Eye/face wash: 11.4 liters/minute minimum (3 US Gallons)
ENVIRONMENTAL OPERATING TEMPERATURE	
MINIMUM AMBIENT OPERATING TEMPERATURE	5° C (41° F)
MAXIMUM AMBIENT OPERATING TEMPERATURE	35° C (95° F)
OPERATIONAL	
SHOWER SPRAY OPERATION	Pull handle
EYE/FACE WASH OPERATION	Pull lid down
NOMINAL WEIGHTS and DIMENSIONS	
DIMENSIONS - STANDARD ORIENTATION (W x D x H)	504 mm (19.8 in) x 768 mm (30.2 in) x 2617 mm (103 in) Height includes sign
WEIGHT (NO OPTIONS)	17 kg (37 lb)

HUGHES



Justrite Safety Group

RM07298 RevA

hughes-safety-showers.com

Indoor Emergency Safety Shower Type: Combination

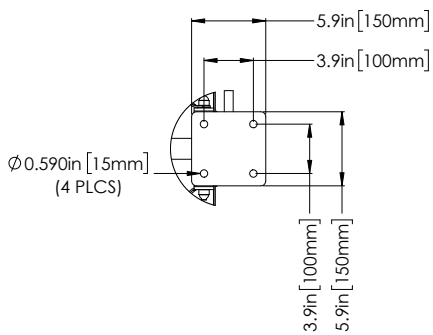
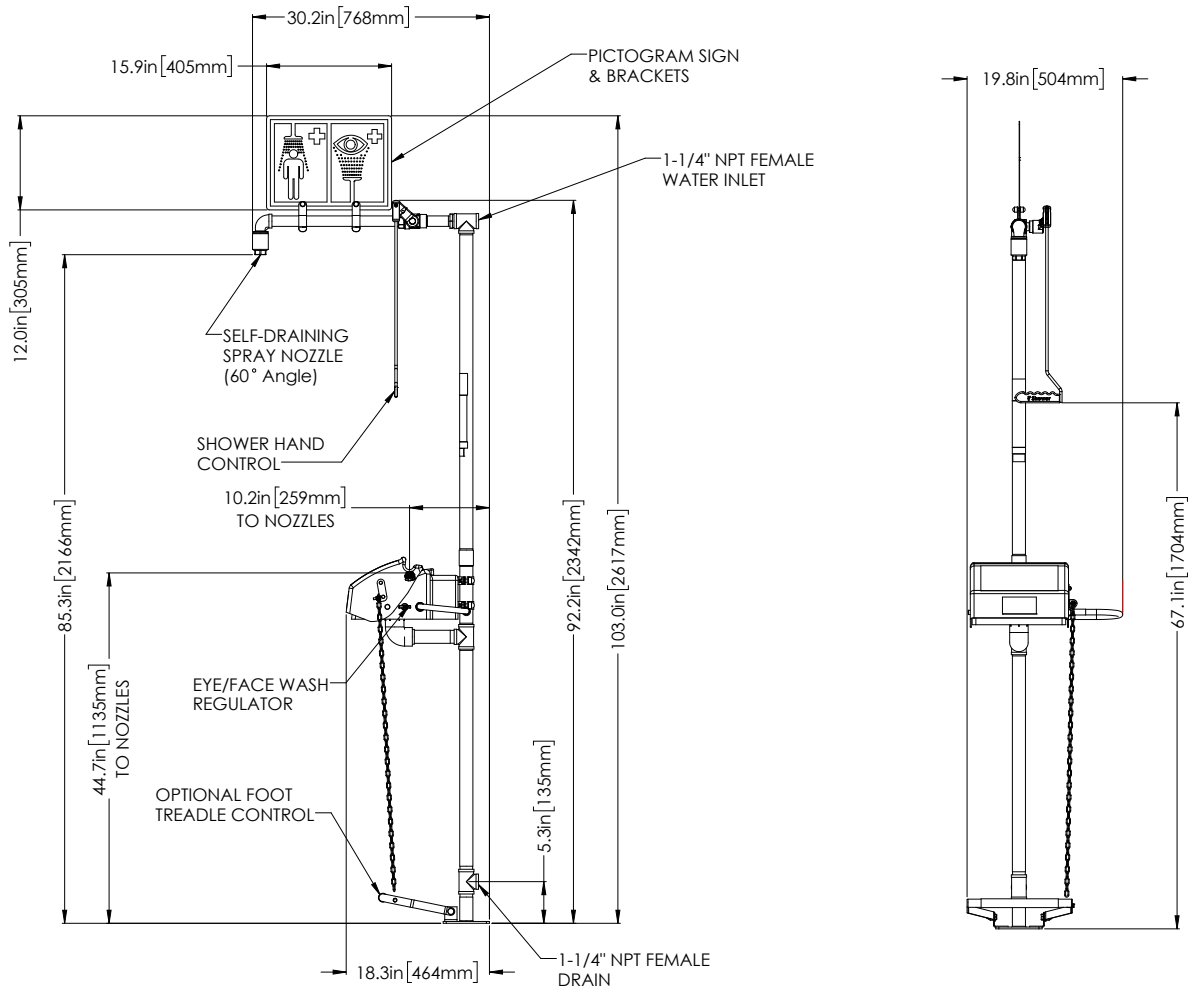

MOUNTING PLATE VIEW
(MOUNTING HARDWARE NOT INCLUDED)

VARIATIONS IN MANUFACTURING AND ASSEMBLY
ALLOW FOR $\pm 1/8$ in [3 mm] PER THREADED JOINT.

For Technical Support Contact:
customer.service@hughes-safety.com • 1-866-312-1652

For Reorder & Sales Support Contact:
custserv@justrite.com • 1-800-798-9250

HUGHES

HUGHES-SAFETY-SHOWERS.COM

Justrite Safety Group

Hughes North America
457 Campbell Street
Sarnia, Ontario N7T 2J1, Canada.

Registered No. 0939240. VAT Registration No. 918 5005 32 ©2019 Hughes Safety Showers