



GEARWRENCH®

RATCHET GUIDE

The wide line of GEARWRENCH ratchets offers professional automotive techs and industrial mechanics an impressive arsenal of tools to accomplish just about any job. From our 120XP™ Ratchets with their 3 degree swing arc to our innovative Gimbal Ratchets, every ratchet in the line delivers on the GEARWRENCH promise of superior Speed, Strength, and Access.

120XP Ratchets

The Double-Pawl design of GEARWRENCH 120XP™ Ratchets provides 120 ratcheting positions so fasteners can be turned in the tightest spaces and jobs can be completed faster. Two pawls alternately engage a 60-tooth gear, allowing a swing arc of just 3 degrees and delivering strength that exceeds ASME torque performance requirements.

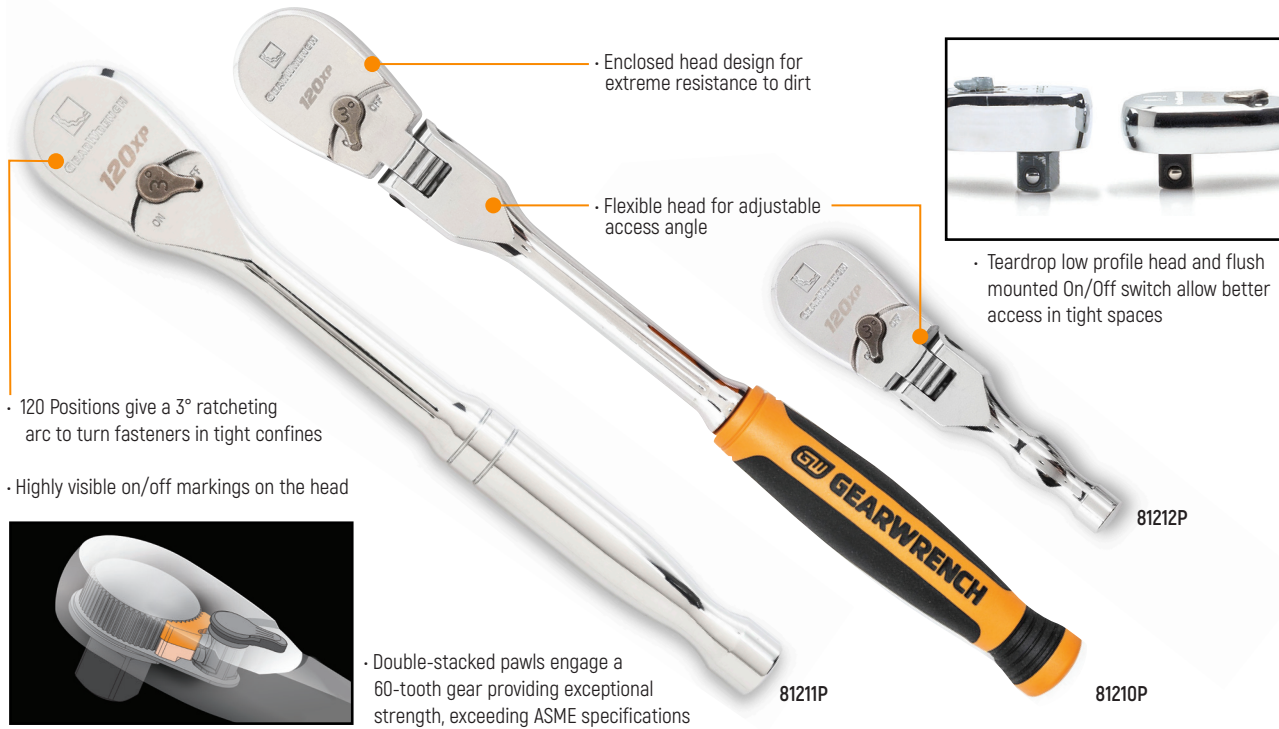

- 3° SWING ARC**
FOR TIGHTER TURNS
- LOW PROFILE HEAD**
FLUSH REVERSING LEVER
- 180° FLEX HEAD**
FOR EASIER ACCESS
- OIL & SOLVENT RESISTANT**

| SKU # | Drive Size | Head Style | Handle Style | Finish | Head Width | Head Thickness | Overall Length | Weight | Repair Kit |
|--------|------------|------------|--------------|--------------|------------|----------------|----------------|--------|------------|
| 81011P | 1/4" | Tear Drop | Standard | Full Polish | 0.98 | 0.39 | 5.12 | 0.29 | 81099P |
| 81034 | 1/4" | Tear Drop | Extra Long | Full Polish | 0.98 | 0.39 | 9.00 | 0.77 | 81099P |
| 81012P | 1/4" | Tear Drop | Flex | Full Polish | 1.02 | 0.41 | 6.85 | 0.33 | 81099P |
| 81009P | 1/4" | Tear Drop | Flex | Cushion Grip | 1.02 | 0.41 | 8.18 | 0.36 | 81099P |
| 81211P | 3/8" | Tear Drop | Standard | Full Polish | 1.25 | 0.55 | 8.38 | 0.72 | 81227P |
| 81269 | 3/8" | Tear Drop | Extra Long | Full Polish | 1.25 | 0.55 | 18.00 | 1.08 | 81227P |
| 81215P | 3/8" | Tear Drop | Flex | Full Polish | 1.30 | 0.55 | 11.47 | 0.95 | 81227P |
| 81212P | 3/8" | Tear Drop | Stubby Flex | Full Polish | 1.30 | 0.55 | 5.00 | 0.55 | 81227P |
| 81210P | 3/8" | Tear Drop | Flex | Cushion Grip | 1.30 | 0.55 | 13.58 | 0.99 | 81227P |
| 81304P | 1/2" | Tear Drop | Standard | Full Polish | 1.72 | 0.75 | 11.02 | 1.87 | 81339P |
| 81364 | 1/2" | Tear Drop | Extra Long | Full Polish | 1.72 | 0.75 | 24.00 | 2.86 | 81339P |
| 81306P | 1/2" | Tear Drop | Flex | Full Polish | 1.72 | 0.75 | 16.90 | 2.44 | 81339P |

FORGE AHEAD

90T Ratchets

GEARWRENCH 90-Tooth Ratchets have a 4-degree swing arc and a low-profile enclosed head for easier access to hard-to-turn fasteners and extreme resistance to dirt infiltration. The ratchets are some of the strongest on the market, exceeding ASME torque performance specifications. They are available individually or in sets and are offered in a wide range of sizes and styles to suit every preference and job requirement.



• Highly visible On/Off markings on the head

• Locking flex-head with 9 locked positions and unlocked option for adjustable access angle

• 90-Tooth gear delivers a 4° swing arc to turn a fastener in tight confines

• 1/2" Drive dual material handle - large handle butt for improved grip



• Dual material comfort grip handle
• Solvent resistant handle grip for durability



• 3/8" drive ratchet with the head size of a 1/4" drive ratchet

• Exceeds ASME torque performance requirements



• Teardrop low profile head and flush mounted On/Off switch allows better access in tight spaces



| SKU # | Drive Size | Head Style | Handle Style | Finish | Head Width | Head Thickness | Overall Length | Weight | Repair Kit |
|--------|------------|------------|--------------|--------------|------------|----------------|----------------|--------|------------|
| 81011T | 1/4" | Tear Drop | Standard | Full Polish | 0.98 | 0.35 | 5.13 | 0.27 | 81099T |
| 81028T | 1/4" | Tear Drop | Long Handle | Full Polish | 0.98 | 0.35 | 6.87 | 0.32 | 81099T |
| 81007T | 1/4" | Tear Drop | Standard | Cushion Grip | 0.98 | 0.35 | 6.88 | 0.32 | 81099T |
| 81029T | 1/4" | Tear Drop | Long Handle | Cushion Grip | 0.98 | 0.35 | 8.26 | 0.34 | 81099T |
| 81015T | 1/4" | Tear Drop | Locking Flex | Full Polish | 0.98 | 0.35 | 6.97 | 0.33 | 81099T |
| 81012T | 1/4" | Tear Drop | Flex | Full Polish | 0.98 | 0.35 | 6.97 | 0.33 | 81099T |
| 81016T | 1/4" | Tear Drop | Locking Flex | Cushion Grip | 0.98 | 0.35 | 8.23 | 0.33 | 81099T |
| 81009T | 1/4" | Tear Drop | Flex | Cushion Grip | 0.98 | 0.35 | 8.26 | 0.39 | 81099T |
| 81211T | 3/8" | Tear Drop | Standard | Full Polish | 1.25 | 0.47 | 8.39 | 0.70 | 81227T |
| 81264T | 3/8" | Tear Drop | Long Handle | Full Polish | 1.25 | 0.47 | 11.00 | 0.81 | 81227T |
| 81209T | 3/8" | Tear Drop | Stubby | Full Polish | 1.25 | 0.47 | 4.72 | 0.41 | 81227T |
| 81220T | 3/8" | Compact | Standard | Full Polish | 1.00 | 0.43 | 8.40 | 0.51 | |
| 81228T | 3/8" | Compact | Stubby | Full Polish | 1.00 | 0.43 | 4.70 | 0.32 | |
| 81208T | 3/8" | Tear Drop | Standard | Cushion Grip | 1.25 | 0.47 | 9.40 | 0.64 | 81227T |
| 81265T | 3/8" | Tear Drop | Long Handle | Cushion Grip | 1.25 | 0.47 | 13.00 | 0.77 | 81227T |
| 81266T | 3/8" | Tear Drop | Locking Flex | Full Polish | 1.25 | 0.47 | 11.47 | 0.93 | 81227T |
| 81215T | 3/8" | Tear Drop | Flex | Full Polish | 1.25 | 0.47 | 11.40 | 0.85 | 81227T |
| 81212T | 3/8" | Tear Drop | Stubby Flex | Full Polish | 1.25 | 0.47 | 5.00 | 0.52 | 81227T |
| 81267T | 3/8" | Tear Drop | Locking Flex | Cushion Grip | 1.25 | 0.47 | 13.63 | 0.93 | 81227T |
| 81210T | 3/8" | Tear Drop | Flex | Cushion Grip | 1.25 | 0.47 | 13.38 | 0.85 | 81227T |
| 81213T | 3/8" | Tear Drop | Off-Set Flex | Cushion Grip | 1.25 | 0.47 | 12.26 | 0.99 | 81227T |
| 81304T | 1/2" | Tear Drop | Standard | Full Polish | 1.72 | 0.64 | 11.00 | 1.65 | 81339T |
| 81360T | 1/2" | Tear Drop | Long Handle | Full Polish | 1.72 | 0.64 | 15.00 | 1.97 | 81339T |
| 81303T | 1/2" | Tear Drop | Standard | Cushion Grip | 1.72 | 0.64 | 11.80 | 1.30 | 81339T |
| 81361T | 1/2" | Tear Drop | Long Handle | Cushion Grip | 1.72 | 0.64 | 16.50 | 1.75 | 81339T |
| 81362T | 1/2" | Tear Drop | Locking Flex | Full Polish | 1.72 | 0.64 | 16.93 | 2.30 | 81339T |
| 81363T | 1/2" | Tear Drop | Locking Flex | Full Polish | 1.72 | 0.64 | 24.00 | 2.79 | 81339T |
| 81306T | 1/2" | Tear Drop | Flex | Full Polish | 1.72 | 0.64 | 16.98 | 2.05 | 81227T |
| 81371T | 1/2" | Tear Drop | Locking Flex | Cushion Grip | 1.72 | 0.64 | 17.00 | 1.96 | 81339T |
| 81372T | 1/2" | Tear Drop | Locking Flex | Cushion Grip | 1.72 | 0.64 | 24.00 | 2.44 | 81339T |
| 81370T | 1/2" | Tear Drop | Flex | Cushion Grip | 1.72 | 0.64 | 17.00 | 2.07 | 81339T |

120XP Sets



| SKU # | Drive Size | Description | Handle Style | Includes |
|--------|------------------|--|--------------|--------------------------------|
| 81230P | 1/4", 3/8", 1/2" | 4 Pc 120XP Flex-Head Ratchet Set | Full Polish | 81012P, 81212P, 81215P, 81306P |
| 81204P | 1/4", 3/8" | 2 Pc 120XP Flex-Head Ratchet Set | Cushion Grip | 81009P, 81210P |
| 81206P | 1/4", 3/8", 1/2" | 3 Pc 120XP Ratchet Set | Full Polish | 81011P, 81211P, 81304P |
| 81271 | 1/4", 3/8" | 2 Pc 120XP Extra Long Handle Ratchet Set | Full Polish | 81034, 81269 |

90T Sets



| SKU # | Drive Size | Description | Handle Style | Includes |
|--------|------------------|--|--------------|--------------------------------|
| 81206T | 1/4", 3/8", 1/2" | 3 Pc 90T Ratchet Set | Full Polish | 81011T, 81211T, 81304T |
| 81207T | 1/4", 3/8", 1/2" | 3 Pc 90T Ratchet Set | Cushion Grip | 81007T, 81208T, 81303T |
| 81216T | 1/4", 3/8" | 2 Pc 90T Flex-Head Ratchet Set | Full Polish | 81012T, 81215T |
| 81230T | 1/4", 3/8", 1/2" | 4 Pc 90T Flex-Head Ratchet Set | Full Polish | 81012T, 81215T, 81212T, 81306T |
| 81204T | 1/4", 3/8" | 2 Pc 90T Flex-Head Ratchet Set | Cushion Grip | 81009T, 81210T |
| 81203T | 1/4", 3/8" | 3 Pc 90T Mixed Ratchet Set | Cushion Grip | 81007T, 81208T, 81210T |
| 81274T | 1/4", 3/8" | 2 Pc 90T Locking Flex Head Set | Full Polish | 81015T, 81266T |
| 81276T | 1/4", 3/8", 1/2" | 3 Pc 90T Locking Flex-Head Ratchet Set | Full Polish | 81015T, 81266T, 81362T |
| 81275T | 1/4", 3/8" | 2 Pc 90T Locking Flex-Head Ratchet Set | Cushion Grip | 81016T, 81267T |
| 81298T | 1/4", 3/8", 1/2" | 3 Pc 90T Locking Flex-Head Ratchet Set | Cushion Grip | 81016T, 81267T, 81371T |
| 81268T | 1/4", 3/8" | 2 Pc 90T Long Handle Ratchet Set | Full Polish | 81028T, 81264T |
| 81229T | 3/8" | 3 Pc 90T Ratchet Spark Plug Set | Cushion Grip | 81213T, 80546, 80547 |
| 81253T | 3/8" | 2 Pc 90T Compact Head Ratchet Set | Full Polish | 81220T, 81228T |

Additional Sets



| SKU # | Drive Size | Description | Includes |
|-------|------------------|--|--|
| 81032 | 1/4" | 45 Pc 72T Slim Head Mechanics Tool Set | 81025 and 81030 Slim Head Ratchets, 4mm - 13mm sockets, [2] 1/4" adapters, 4" extension, 30 Pc mixed bits in box |
| 81031 | 1/4" | 43 Pc 72T Slim Head Mechanics Tool Set | 6" Bit Driver and 12" 1/4" drive Slim Head Ratchet, 4mm - 13mm sockets, 4" extension, 30 Pc mixed bits in box |
| 81223 | 1/4, 3/8" | 2 Pc Cushion Grip Roto Ratchet Set | 81224, 81225 |
| 81222 | 1/4", 3/8" | 2 Pc Thumbwheel Ratchet Set | 81008, 81226 |
| 81310 | 1/4", 3/8", 1/2" | 3 Pc Full Polish Quick Release Ratchet Set | 81014, 81218, 81309 |