



# GEARWRENCH®

## RATCHET GUIDE

The wide line of GEARWRENCH ratchets offers professional automotive techs and industrial mechanics an impressive arsenal of tools to accomplish just about any job. From our 120XP™ Ratchets with their 3 degree swing arc to our innovative Gimbal Ratchets, every ratchet in the line delivers on the GEARWRENCH promise of superior Speed, Strength, and Access.

### 120XP Ratchets

The Double-Pawl design of GEARWRENCH 120XP™ Ratchets provides 120 ratcheting positions so fasteners can be turned in the tightest spaces and jobs can be completed faster. Two pawls alternately engage a 60-tooth gear, allowing a swing arc of just 3 degrees and delivering strength that exceeds ASME torque performance requirements.

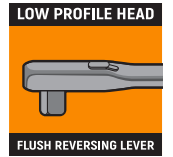
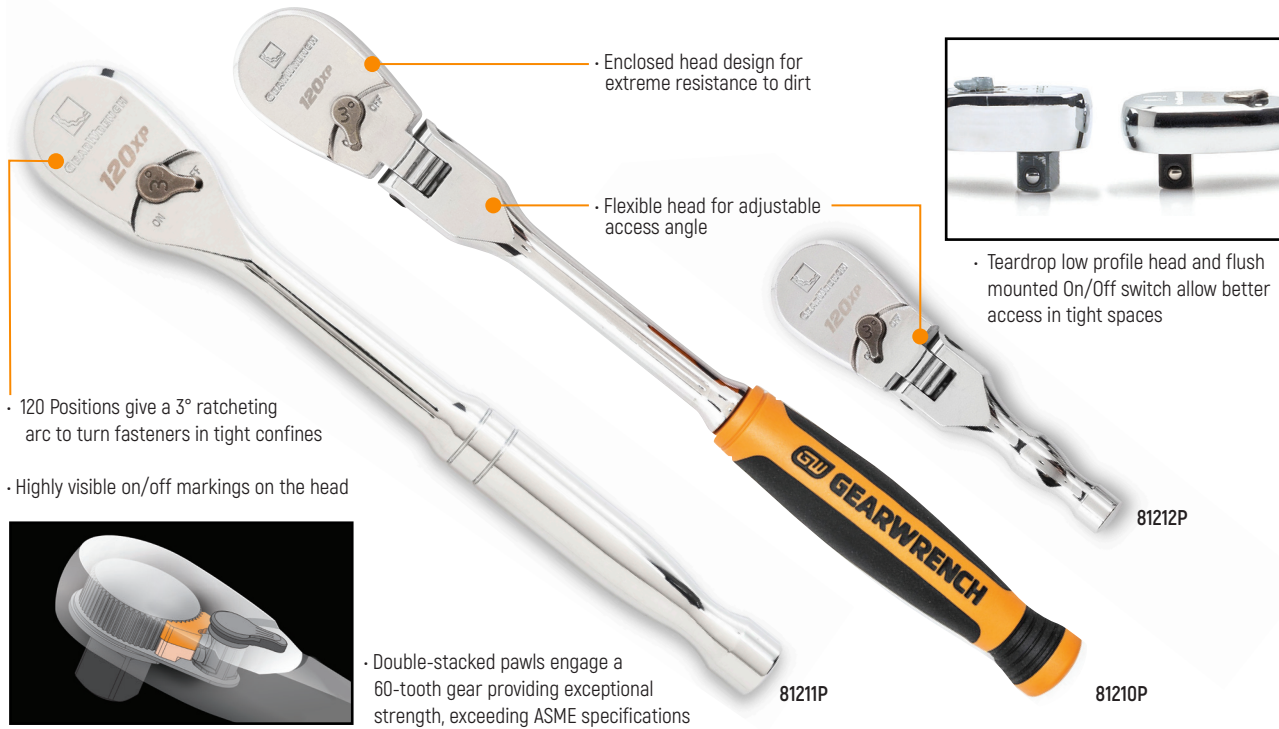

SKU #	Drive Size	Head Style	Handle Style	Finish	Head Width	Head Thickness	Overall Length	Weight	Repair Kit
81011P	1/4"	Tear Drop	Standard	Full Polish	0.98	0.39	5.12	0.29	81099P
81034	1/4"	Tear Drop	Extra Long	Full Polish	0.98	0.39	9.00	0.77	81099P
81012P	1/4"	Tear Drop	Flex	Full Polish	1.02	0.41	6.85	0.33	81099P
81009P	1/4"	Tear Drop	Flex	Cushion Grip	1.02	0.41	8.18	0.36	81099P
81211P	3/8"	Tear Drop	Standard	Full Polish	1.25	0.55	8.38	0.72	81227P
81269	3/8"	Tear Drop	Extra Long	Full Polish	1.25	0.55	18.00	1.08	81227P
81215P	3/8"	Tear Drop	Flex	Full Polish	1.30	0.55	11.47	0.95	81227P
81212P	3/8"	Tear Drop	Stubby Flex	Full Polish	1.30	0.55	5.00	0.55	81227P
81210P	3/8"	Tear Drop	Flex	Cushion Grip	1.30	0.55	13.58	0.99	81227P
81304P	1/2"	Tear Drop	Standard	Full Polish	1.72	0.75	11.02	1.87	81339P
81364	1/2"	Tear Drop	Extra Long	Full Polish	1.72	0.75	24.00	2.86	81339P
81306P	1/2"	Tear Drop	Flex	Full Polish	1.72	0.75	16.90	2.44	81339P

FORGE AHEAD

