

Automatic Drain with Y-Strainer Valve



Automatically Drains Water from Compressed Air Systems

- Use with air compressors, water separators and at drop legs — See properly piped shop diagram for install locations (pg. 45)
- Adjustable interval time and drain time
- Removable filter for easy cleaning
- Includes electric timer, 1/4" Y-strainer valve with filter screen and 6 ft. power cord

| Order No. | Description |
|-----------|---------------------------------------|
| 130512 | Automatic drain with Y-strainer valve |



Refer to Service Bulletin: SB-6-184

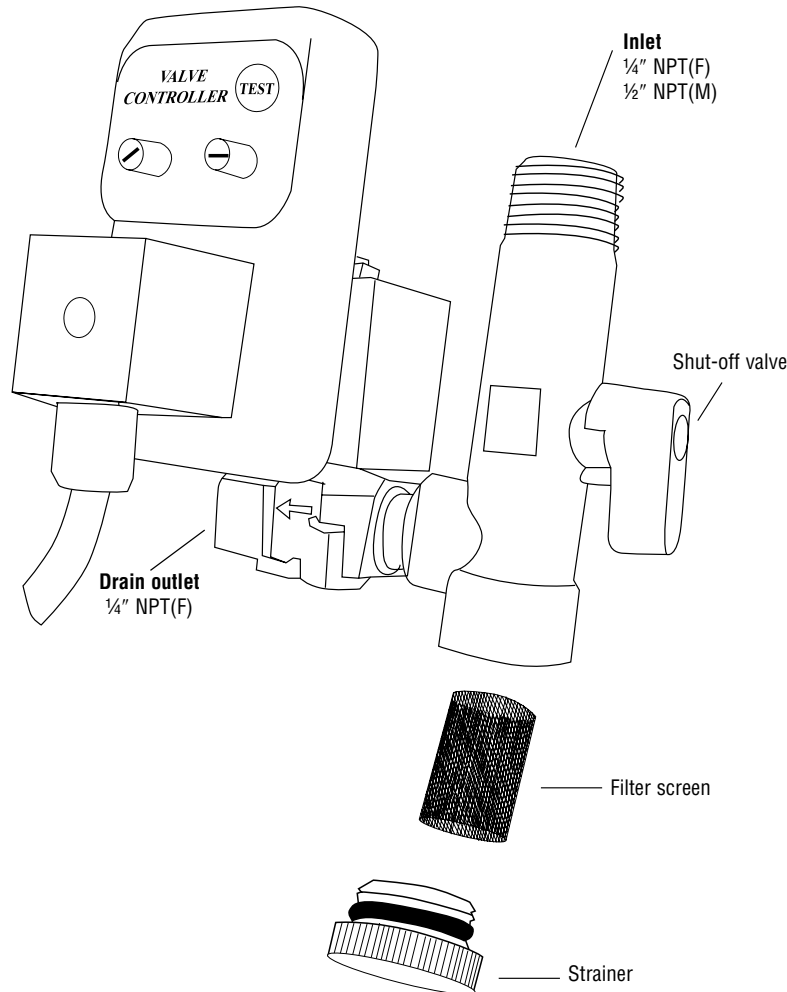

SPECIFICATIONS:

| | |
|--------------------------|---------------------------|
| Timer | |
| Interval time (T2) | .5 - 45 minutes |
| Discharge time (T1) | .5 - 10 seconds |
| Supply voltage | 120v/60hz |
| Current Consumption | 4mA Max. |
| Operating Temperature | -14°F to 122°F |
| Environmental Protection | NEMA 4 |
| Case Material | ABS Plastic FR Grade |
| Valve | |
| Type | 2-way direct acting valve |
| In/Out Ports | 1/4" NPT Female |
| Max. Working Pressure | 230 PSI |
| Operating Temperature | 36°F to 131°F Ambient |
| Media Temperature | 194°F Max. |
| Valve Body | Forged Brass |
| Mounting | Any Position |

