

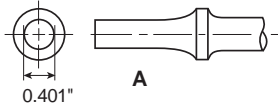

CHISELS

TYPE OF SHANK

Round .401"



CP7111/CP7110/CP7150

Hex .401"

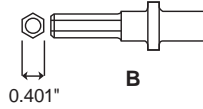

CP7111H

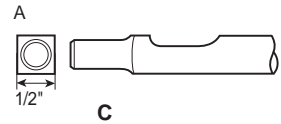

CP7120

DRAWING	DESCRIPTION	LENGTH		WIDTH		SHANK		
		in	mm	in	mm	A	B	C
	Flat Chisel	4	102	0,625	16			WP123997
		7	180	0,5	12,7	A008542		
		7	180	0,75	19	A046073	CA155786	205 051 2803
		7,5	191	0,625	16			WP123996
		18	457	0,75	19	A046080		
	Undercoat Goo Scraper	6,5	165	1	25	A046072		
	Spot Weld Splitter	7	180	1	25	A046075		
	Twin Blade Panel Cutter	7	180	1	25	A046071		
	Nut Splitter	10	254	0,75	19	A046044		
	Rivet Cutter	6,5	165	0,625	16	A046050	CA155778	
	Angle Scaling	6,5	165	1,375	35			WP123999
		7	180	1,25	32	A046063	CA155780	
	Scraper	6	152	1,75	44	A133907		
	Diamond Point	7	180	0,3	7,6	A046064	CA155782	
		7,5	191	0,25	6			WP123995
	Edging Chisel	5,375	137	0,625	16	A046076		



Spares & Accessories

CHISEL RETAINERS

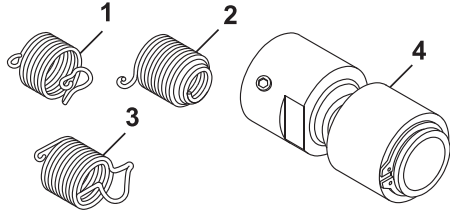

MODEL USED	TYPE	PART NUMBER	DESCRIPTION
CP714	1	205 048 7413	Quick Change
	1	A046095	Heavy Duty Quick Change
	2	A046096	Bee hive
	3	205 052 5333	Zip Change
	3	A046094	Heavy Duty Zip Change made in USA
	4	894 015 8924	Posi Lock Quick Change
	4	A121721	Heavy Duty Posi Lock Quick Change made in USA
	CP717	1	A047095
2		A047096	Bee hive

CHISELS

TYPE OF SHANK

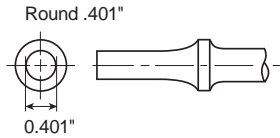

CP714

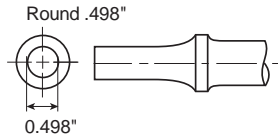

CP717

DRAWING	DESCRIPTION	LENGTH		WIDTH		SHANK	
		in	mm	in	mm	ROUND .401"	ROUND .498"
	Flat Chisel	7	180	0,5	12,7	A008542	
		7	180	0,625	16	A046073	A047073
		18	457	0,75	19	A046080	
	Undercoat Goo Scraper	6,5	165	1	25	A046072	
	Spot Weld Splitter	7	180	1	25	A046075	
	Twin Blade Panel Cutter	7	180	1	25	A046071	A047071
	Nut Splitter	10	254	0,75	19	A046044	
	Rivet Cutter	6	152	0,75	19	A047050	
		6,5	165	0,625	16	A046050	
	Angle Scaling	7	180	1,25	32	A046063	A047051