

## A little about the DF-800BR Hot Stapler



Dent Fix Equipment is proud to say we manufacture the DF-800BR Hot Stapler in the USA. We do this to guarantee its superior quality and ensure it lives up to the standards we put into every Dent Fix product. Your DF-800BR Hot Stapler has a 5 year warranty which gives you the peace of mind that Dent Fix stands behind all their products and more importantly: You, our valued customer.



From our manufacturing facilities in sunny southern California we proudly ship our products to every corner of the US and all over the world. For over 33 years Dent Fix has exclusively produced and offered premier repair solutions for the collision and body shop repair industry. This winning philosophy is what we believe in and is the reason why Dent Fix products are so highly respected. We are excited to provide you the Technician with the products that increase your efficiency and profitability with higher quality results.

## Other Products from Dent Fix



### DING MASTER DELUXE

Paintless Dent Repair Glue Pulling Kit

DINGS, DENTS, HAIL AND WEATHER DAMAGE are all easily repaired whether on steel or aluminum panels. Access to the back panel is not necessary; glue pullers are the easiest means of paintless dent repair. This kit includes everything you see here organized in a rugged blow molded case.

DF-DM550DX

### THE MAXI

Multiple Pull Dent Station

WELD • PULL • TWIST

This 220v dent removal station is perfect for light to heavy pulls. Leverage puller for power and precision pulls. Slide hammer rod for tapping action. Bear Claws and Wiggle Wire for crease pulling. Optional stand DF-509 not pictured.

DF-505

DENT FIX PRODUCTS SOLVE PROBLEMS - SINCE 1979

© Copyright 2012 Dent Fix Corporation 1611 W. 135th St., Gardena, CA 90249



# DF-800BR INSTRUCTION MANUAL

HOT STAPLER



## Getting to Know Your DF-800BR Deluxe Kit

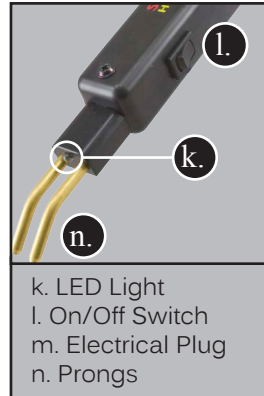

k. LED Light  
l. On/Off Switch  
m. Electrical Plug  
n. Prongs

a. Hot Stapler unit  
b. N-Clip Staples  
c. U-Clip Staples  
d. W-Clip Staples  
e. Z-Clip Staples  
f. S-Clip Staples  
g. M-Clip Staples  
h. V-Clip Staples  
i. Finishing Iron  
j. Plastic Rods

ONCE A STAPLE IS SET AND THE SWITCH IS TURNED ON, THE TEMPERATURE CAN REACH 1,022° F. IF NOT HANDLED PROPERLY CAN CAUSE BURNING, BLINDNESS AND/OR A FIRE

### SAFETY PRECAUTIONS:

- Wear heat-resistant gloves when working.
- Before setting the staple, make sure that tip of the prong is cold.
- Do not touch staple with bare hands when it is set and ON/OFF switch is engaged.
- Do not use near combustible materials.
- Notify the people around you to be cautious of the high temperatures and avoid approaching you when welding or stapling.
- Do not use with wet hands.
- Do not soak this product in water or other liquids.
- Do not use in wet or damp locations.
- Whenever the tool is not being used, for an extended period unplug unit from wall socket.
- The repair area is exposed to high temperatures. Be aware of and avoid contact with melted plastic.

### OPERATION PRECAUTIONS:

- This product was designed for the plastic repair. Do not use it for purposes other than the original usage.
- The device should be used with authorized staples/clips.
- Never disassemble.
- Do not use in wet or damp locations.
- Staple will become extremely hot when ON/OFF Switch is engaged.
- When you plug in or disconnect the plug, please hold the plug itself. (Do not pull the cable.)

## Hot Stapler Operation Procedure

1. Plug into the proper 110 volt electrical outlet.
2. Choose the suitable Dent Fix Breakaway® StapleClips® (see chart below) and set into the tip of the prongs. (See Image 1)

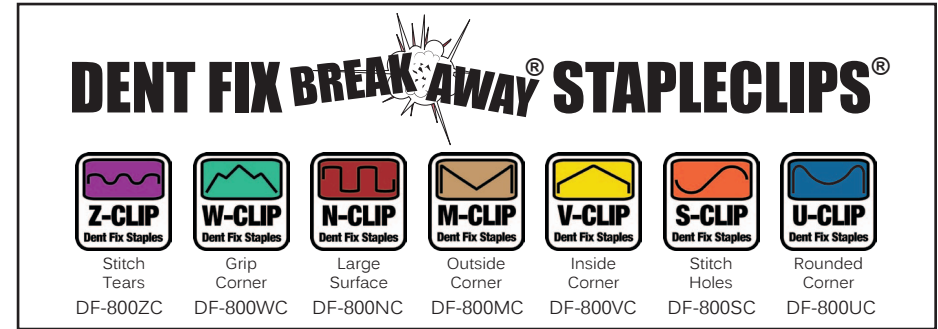

3. Join the adjacent pieces of the repair area together to restore the original form.
4. Press the switch button on the grip and hold in position on plastic about 5 seconds until the StapleClips® is hot enough to melt the plastic and press the StapleClips® gently to set. The LED light will light up when ON/OFF Switch. (See Image 2)

WHEN PRESSED TOO HARD THE STAPLECLIPS® CAN BEND OR PENETRATE THROUGH THE REPAIR AREA.

APPLY LIGHT, CONTROLLED PRESSURE.

5. When the StapleClips® is half way through the repair surface, you may give a little twist to the S and Z StapleClips® to lock laterally in the plastic, then release the On/Off Switch button on the grip. Wait for a few seconds until the repaired gets firm. Next, draw the StapleClips® out of the prongs. (See Image 3)
6. When repairing damaged areas with considerable length, please repeat the procedure 2-5 at intervals of 1-3 cm.
7. With a gloved hand simply snap off the Dent Fix Breakaway® StapleClips®. (See Image 7)

BE AWARE OF FRAGMENTS.

WEAR SAFETY GOGGLES WHEN YOU SNAP OFF BREAKWAY® STAPLECLIPS®.

8. Make sure the tip is cooled before putting the tool away.
9. Grind off excess or file any remaining staple above the service, using a sander or grinder.
10. Smooth ridges or fill any gaps with the plastic rods and Finishing Iron included in the kit.
11. Finish as necessary and usual with texture and paint.

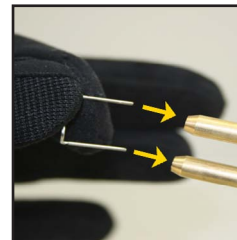

Image 1 - Step 2

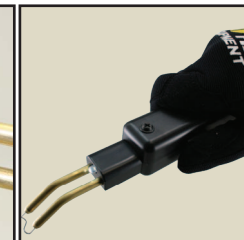

Image 2 - Step 4

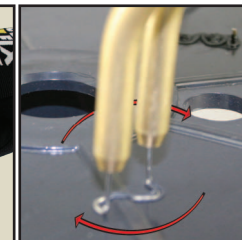

Image 3 - Step 5

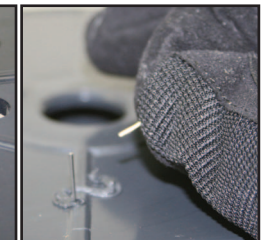

Image 4 - Step 7