

# Dryaire Membrane System

## Model 6770

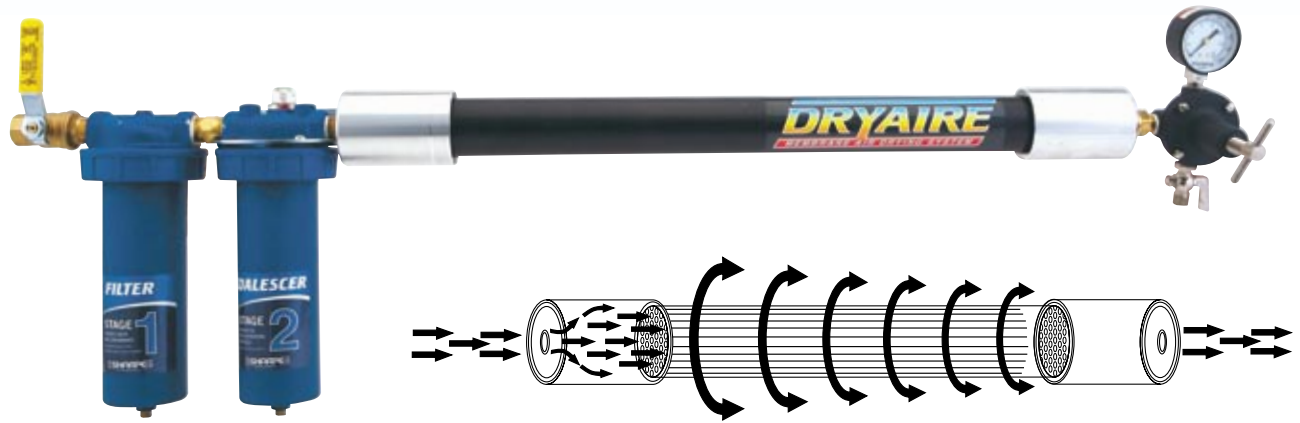

Advanced air drying technology for shop use. Lightweight, easy-to-install, and simple-to-operate, the Dryaire Membrane System maintains  $-40^{\circ}\text{F}$  dew point while achieving 0% compressed air humidity. It removes oil and sub-micron particles down to .01 micron.

- Stage 1 filter provides removal of water and contaminants down to 5 microns
- Stage 2 coalescer provides removal of oil and sub-microns particles down to .01 microns
- Stage 3 membrane dryer is maintenance free, no regeneration required

PN	Description
6770	Membrane System
22645	Stage 1 Replacement Filter Element
U23075	Stage 2 Replacement Coalescer Element
1-6770-3	Stage 3 Replacement Membrane

**NOTE:** For the overnight drain to operate, turn off the air pressure

- Shut off ball valve when not in use
- Recommended installation outside spray booth

- Instruction Manual: PN 310596
- Reference p. 53

	Stage 1	Stage 2	Stage 3
Air Inlet, NPT	1/2 in	1/2 in	1/2 in
Air Outlet, NPT	1/2 in	1/2 in	1/2 in
Air Flow Capacity	115 CFM (3.2 m <sup>3</sup> /min)	70 CFM (2.0 m <sup>3</sup> /min)	30 CFM (0.85 m <sup>3</sup> /min)
Max. Operating Pressure	175 psi (1.2 MPa, 12 bar)	175 psi (1.2 MPa, 12 bar)	175 psi (1.2 MPa, 12 bar)
Max. Temperature	150°F (65°C)	150°F (65°C)	175°F (79°C)

RAZOR  
HVLP 1.4 mm



PN 253434 (p. 2)

RAZOR  
Primer



PN 253438 (p. 9)

RAZOR  
HVLP Waterborne



PN 289388 (p. 3)

Finex  
FX3000 1.4 mm



PN 288880 (p. 12)

# Shop Air Piping Layout

## Refrigerated Air Dryer & Dryaire System Layout

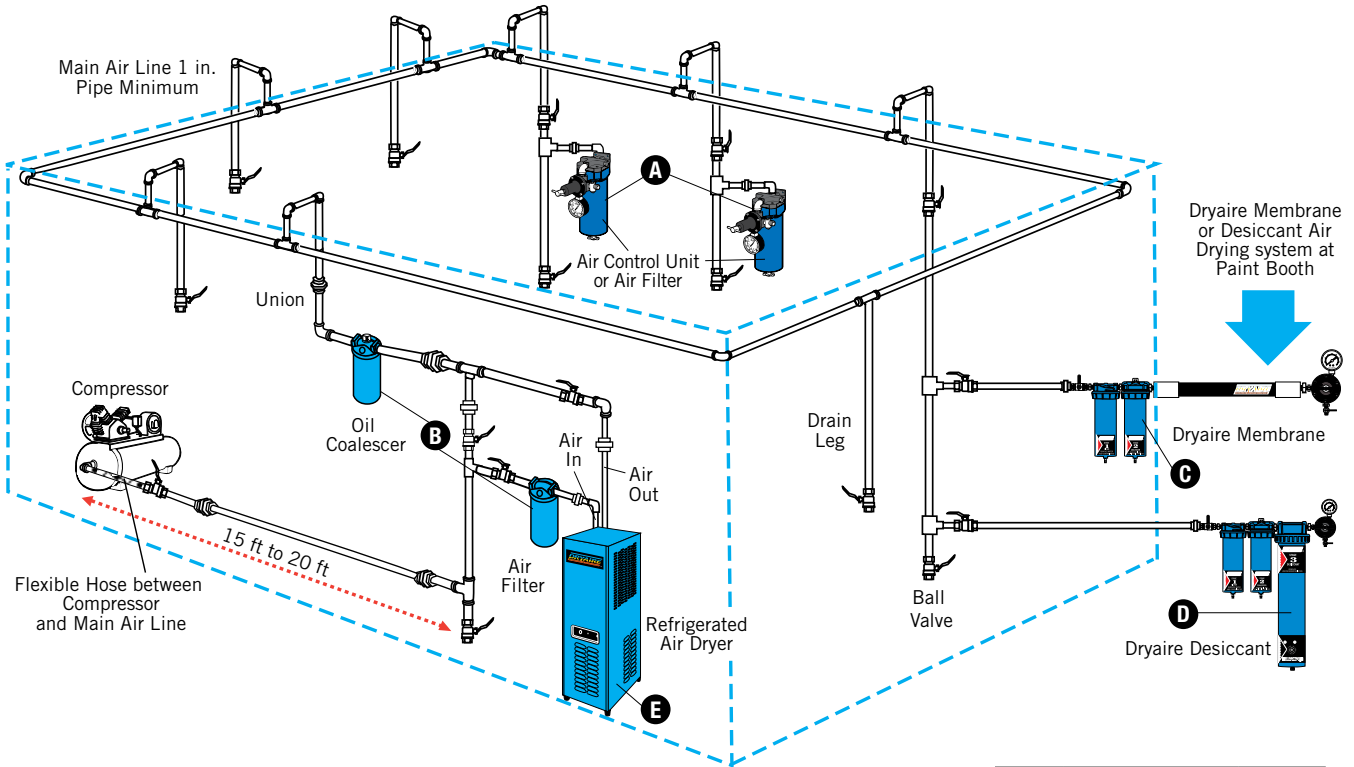

## Dryaire Desiccant System

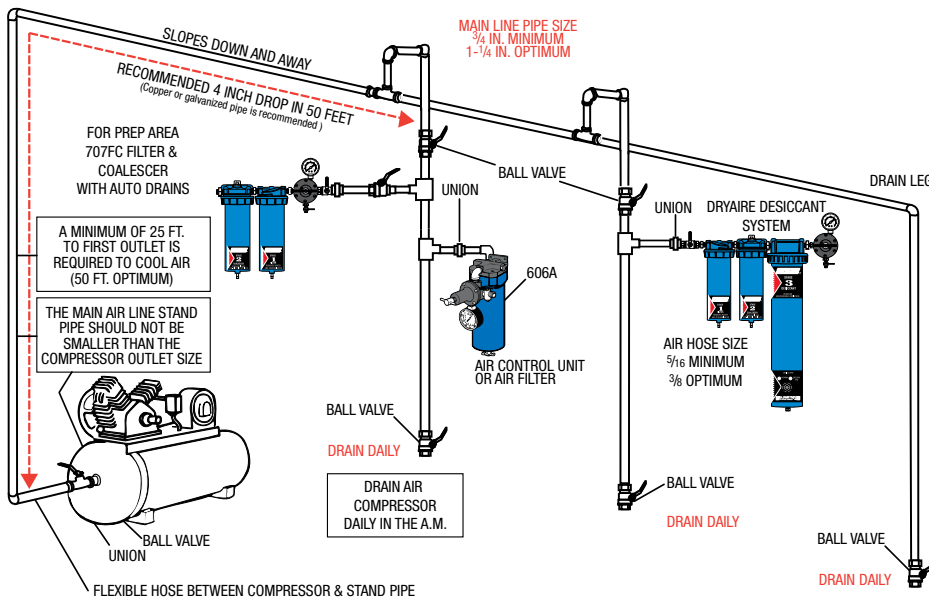

Ref. Letter	Description	Model No.
A	Sharpe 606	U06710
	Sharpe 606A	U06720
	Sharpe 606B	6730
	Sharpe 880A	6950
	Sharpe F88	8130
B	707C	6930
	707F	6920
	707FC	6910
C	Dryaire Membrane	6770
D	Dryaire Desiccant	6760
E	Refrigerated Air Dryer	
	25CFM	6880
	35CFM	6885
	50CFM	6890
	75CFM	6895

# REFERENCE

## REPLACEMENT PARTS DRAWINGS INDEX

### Model 6770 Dryaire Membrane Air Drying System

#### Air Filter with Overnight Drain Stage 1 - Part No. 22601

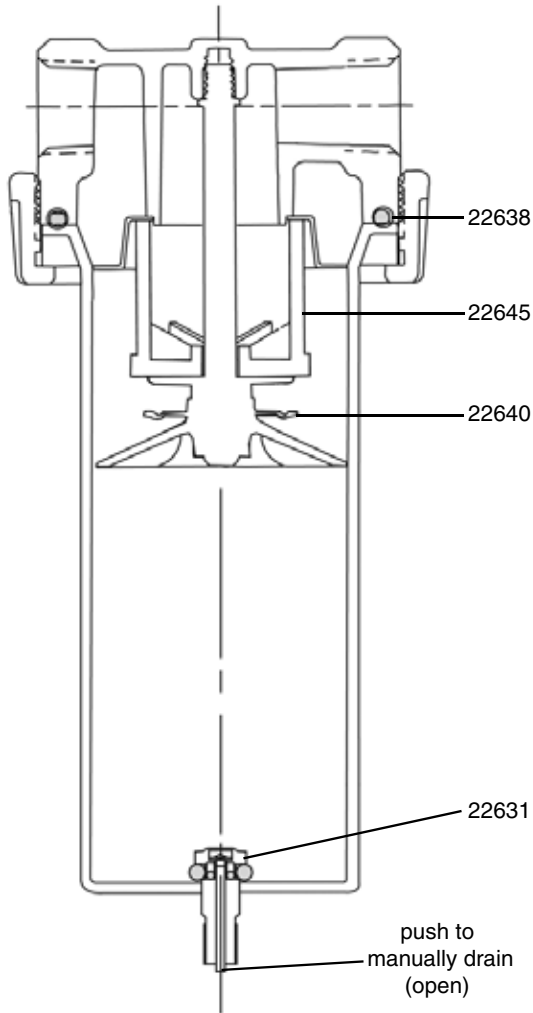

Part No.	Description
22631	Overnight Drain
22632	Mounting Bracket
22638	O-Ring
22640	Baffle Kit
22645	Filter Element

#### Coalescer with Overnight Drain Stage 2 - Part No. 22605

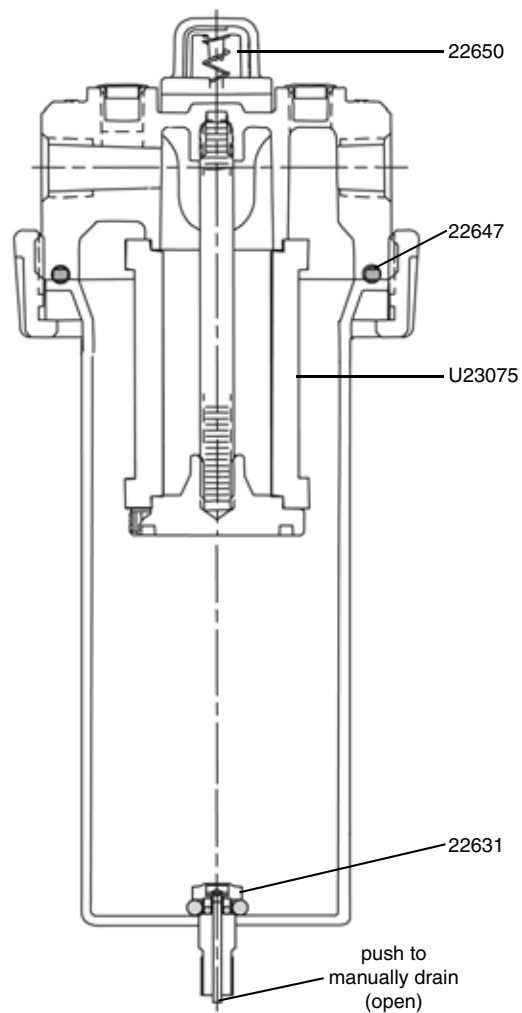

Part No.	Description
22631	Overnight Drain
22632	Mounting Bracket
22647	O-Ring
22650	Pop-up Indicator Repair Kit
U23075	Coalescer Element