

Air Control Units

Protection for Air Cylinders & Air Tools



880A Air Control Unit

Highly effective at removing water, oil and contamination to protect air cylinders and air tools. Contains 18C-3R Regulator with a 160 lb inverted gauge and air cock. Regulated outlet and filtered main line outlet included.

PN	Description
6950	Air Control Unit, 75 cfm
U32719	Replacement filter element

- 5 micron filtration
- Air Inlet Size: 1/2 in NPT (f)
- Air Outlet Size: 3/8 in NPT (f) and 1/4 in NPT (f) plugged
- Max. Operating Pressure: 200 psi (13.6 bar)
- Filter Capacity: 75 cfm
- Regulator Capacity: 50 cfm
- Instruction Manual: PN 310603
- Reference p. 58



606A Air Control Unit

Effective at removing water, oil and contamination to protect air cylinders and air tools. Contains 18C-3R Regulator with a 160 lb inverted gauge and air cock. Regulated outlet and filtered main line outlet included.

PN	Description
U06720	Air Control Unit, 120 cfm
19930	Replacement filter element

- 5 micron filtration
- Air Inlet Size: 1/2 in NPT
- Air Outlet Size: 1/4 in NPT
- Max. Operating Pressure: 200 psi (13.6 bar)
- Filter Capacity: 120 cfm
- Regulator Capacity: 50 cfm
- Instruction Manual: PN 310601
- Reference p. 60



606B Air Control Unit

Effective at removing water, oil and contamination to protect air cylinders and air tools. Contains 18C-3R Regulator with a 160 lb inverted gauge and air cock. Regulated outlet and filtered main line outlet with 200 lb gauge included.

PN	Description
6730	Air Control Unit, 120 cfm
19930	Replacement filter element

- 5 micron filtration
- Air Inlet Size: 1/2 in NPT
- Air Outlet Size: 1/4 in NPT
- Max. Operating Pressure: 200 psi (13.6 bar)
- Filter Capacity: 120 cfm
- Regulator Capacity: 50 cfm
- Instruction Manual: PN 310601
- Reference p. 60



606C Air Control Unit

Effective at removing water, oil and contamination to protect air cylinders and air tools. Contains two 18C-3R Regulators with a 160 lb inverted gauge and air cock. Two regulated outlets and a filtered main line outlet with 200 lb gauge included.

PN	Description
6740	Model 606C Air Control Unit
19930	Replacement Filter Element

- 5 micron filtration
- Air Inlet Size: 1/2 in NPT
- Air Outlet Size: 1/4 in NPT
- Max. Operating Pressure: 160 psi (13.6 bar)
- Filter Capacity: 120 cfm
- Regulator Capacity: 50 cfm
- Instruction Manual: PN 310601
- Reference p. 60

Shop Air Piping Layout

Refrigerated Air Dryer & Dryaire System Layout

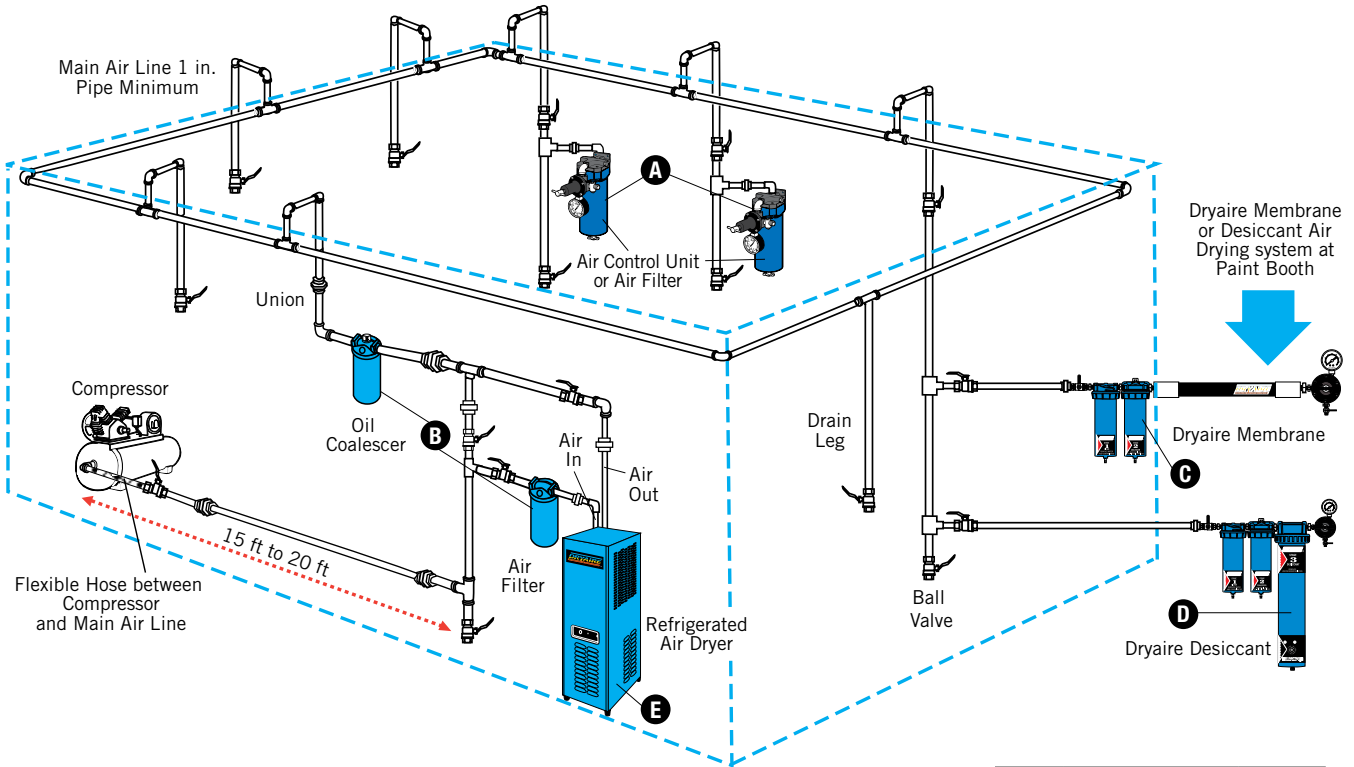

Dryaire Desiccant System

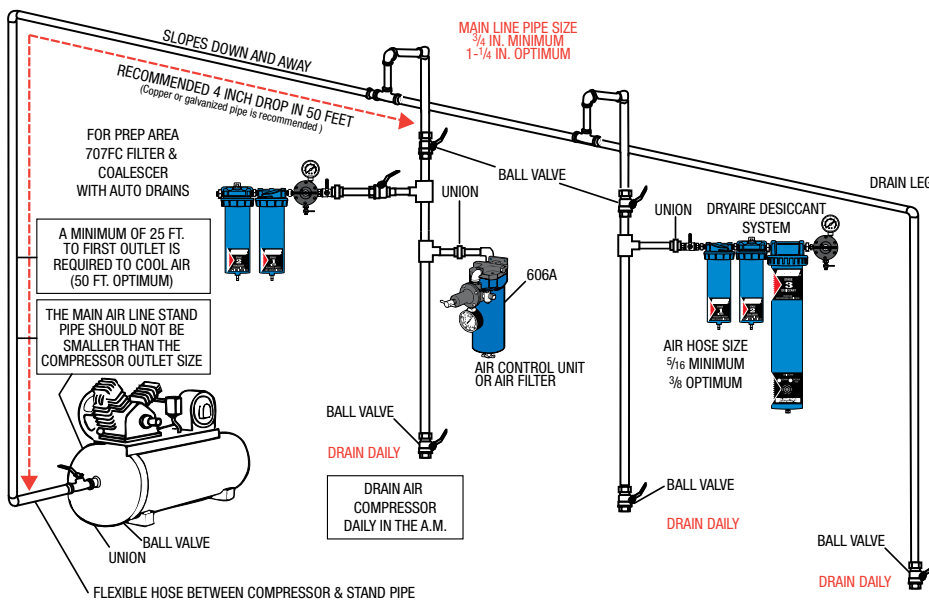

Ref. Letter	Description	Model No.
A	Sharpe 606	U06710
	Sharpe 606A	U06720
	Sharpe 606B	6730
	Sharpe 880A	6950
	Sharpe F88	8130
B	707C	6930
	707F	6920
	707FC	6910
C	Dryaire Membrane	6770
D	Dryaire Desiccant	6760
E	Refrigerated Air Dryer	
	25CFM	6880
	35CFM	6885
	50CFM	6890
	75CFM	6895

REFERENCE

REPLACEMENT PARTS DRAWINGS INDEX

880A Air Control Unit Part No. 6950

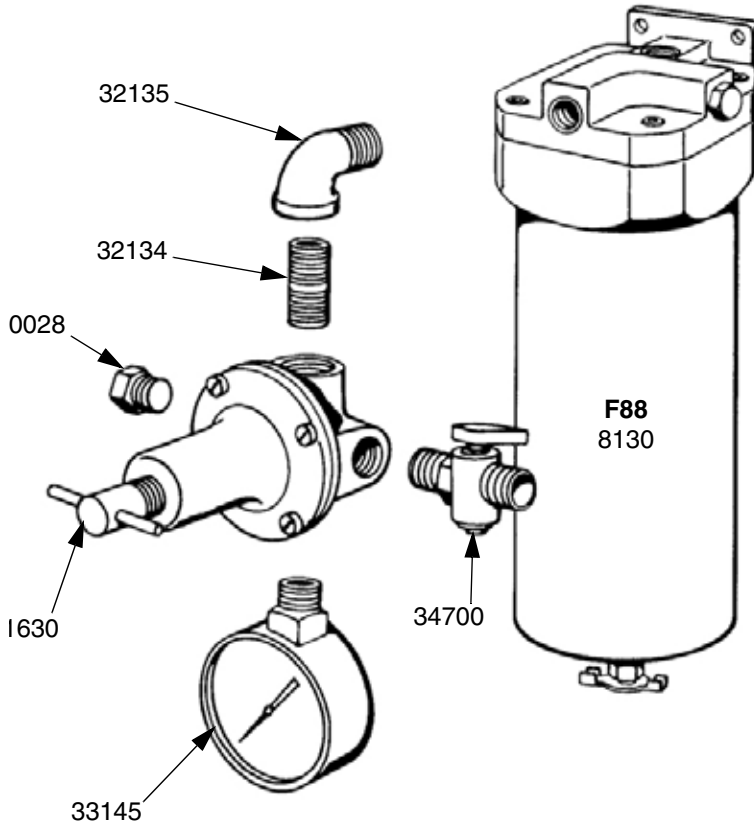

Part No.	Description
1630	Air Regulator
8130	Air Filter
1002	8 Plug
32134	Nipple
32135	Elbow
33145	Gauge
34700	Air Cock

Maximum Working
Pressure: 160 psi
(1.1 MPa, 11 bar)

Air Regulator Part No. 1610

2 Regulated Outlets
1 Main Line Outlet (bypass)

