

Air Filter with Automatic Drain (Part No. 22601, Series B)

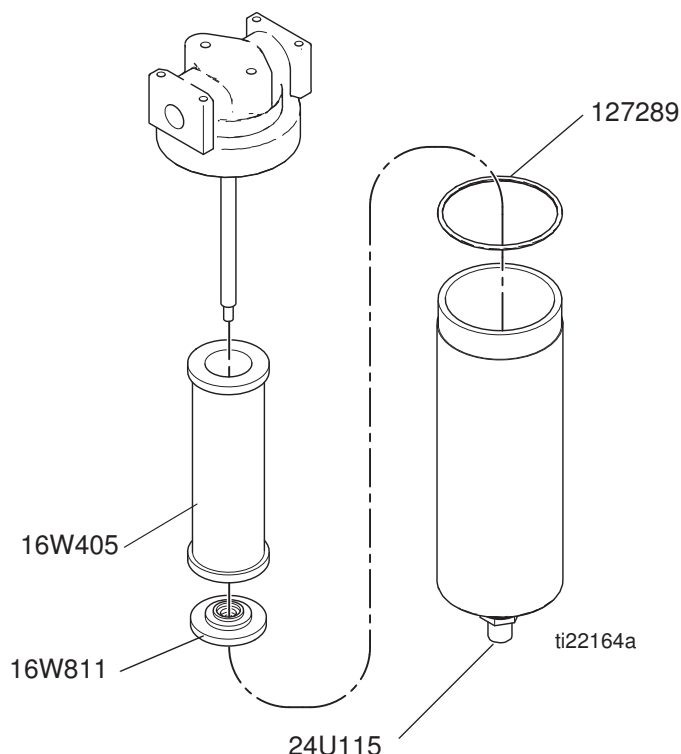

Maintenance

To maintain maximum filtering efficiency and to avoid excessive pressure drop, the filter must be kept clean. Bowl drainage is automatic with the float drain, however, manual draining can also be done by removing the bowl. A visible coating of dirt on the filter element surface or an excessive pressure drop is an indication that cleaning is necessary.

Cleaning

To clean, it is not necessary to remove the complete filter from the line. Disassembly is simple and does not require tools. Before disassembly, shut off the air supply and depressurize filter. Clean all parts with cleaning solvent and blow out filter body before reassembly. Wash filter element in cleaning solvent and blow out from the inside.

Automatic Drain

The automatic drain is equipped with a float actuated device which automatically ejects liquid contaminants under pressure.

Parts (Series B)

Part No.	Description
24U115	Automatic Drain
127289	O-Ring
16W811	Baffle End Cap
16W405	Filter Element

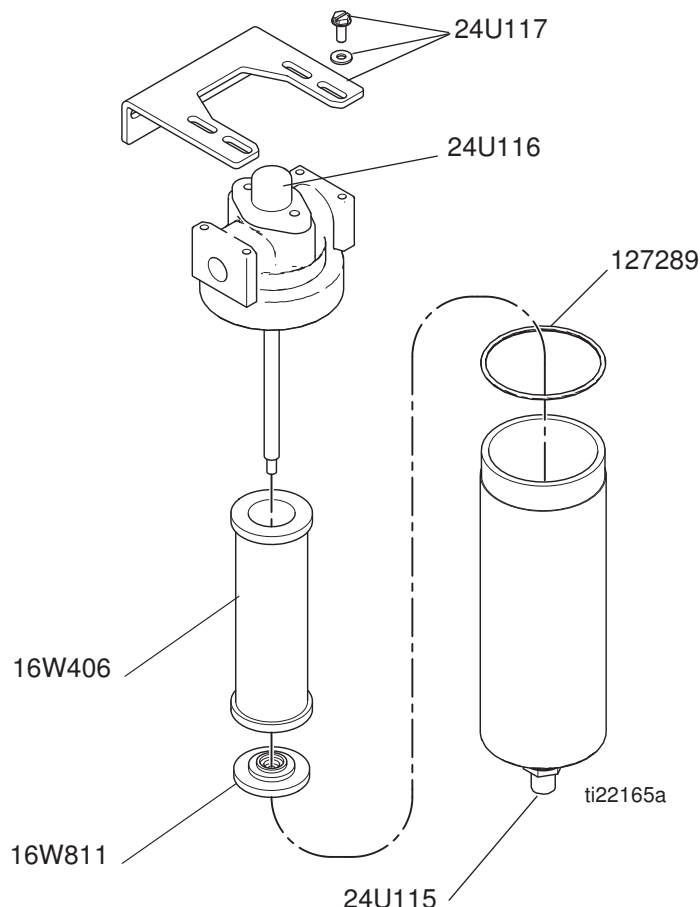

Coalescer with Automatic Drain (Part No. 22602, Series B)

Installation

It is always recommended that a Sharpe air filter be installed upstream of the coalescing filter to remove 1 micron and larger size particles and separate large droplets of moisture from the air line.

Maintenance

To maintain maximum filtering efficiency and to avoid excessive pressure drop, the filter must be kept clean. Bowl drainage is automatic with the float drain. Remove the bowl to drain manually. A visible coating of dirt on the filter element surface or an excessive pressure drop is an indication that cleaning is necessary.

Cleaning

To clean, it is not necessary to remove the complete filter from the line. Disassembly is simple and does not require tools. Before disassembly, shut off the air supply and depressurize coalescer. Clean all parts with cleaning solvent and blow out body before reassembly. Replace coalescing element (part no. 16W406).

Pressure Drop Indicator

The differential pressure drop indicator on this unit is designed to provide early detection of a clogged coalescing filter element. As the filter element becomes clogged the red indicator will start to rise while air is flowing through the unit. When the pressure drop across the element reaches 10-12 psi (.07-.08 MPa, 0.7-0.8 bar) the red indicator will be in full view and the element should be replaced. Failure to replace the element when the pressure drop exceeds 10 psi (.07 MPa, 0.7 bar) will affect your air quality and tool efficiency.

Automatic Drain

The automatic drain is equipped with a float actuated device which automatically ejects liquid contaminants under pressure.

Parts (Series B)

Part No.	Description
24U115	Automatic Drain
24U117	Mounting Bracket Kit
16W811	Baffle End Cap
127289	O-Ring
24U116	Pop-up Indicator Repair Kit
16W406	1 Micron Coalescer Element