

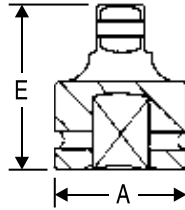

2-1/2" Drive Impact Attachments



2-1/2" Drive Adapter SAE



| Item Number | Female End | Male End | Socket Retention Device | Dimensions (Inches) | |
|---------------|---------------|---------------|-------------------------|---------------------|------|
| | | | | A | E |
| *7008A | 2-1/2" | 1-1/2" | Pin Hole | 5.00 | 5.43 |

* Reducing Adapters are not covered by the GP Warranty.
* See page 182 for New Reducing Sleeve Adapters

2-1/2" Drive Extensions SAE

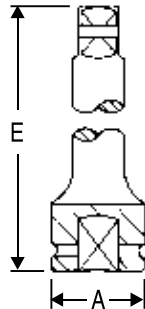

| Item Number | Description | Socket Retention Device | Dimensions (Inches) | |
|--------------|----------------------|-------------------------|---------------------|-------|
| | | | A | E |
| 7005E | 5" Extension | Pin Hole | 5.00 | 4.92 |
| 7010E | 10" Extension | Pin Hole | 5.00 | 9.84 |
| 7020E | 20" Extension | Pin Hole | 5.00 | 19.96 |

2-1/2"

2-1/2" Drive Socket O-Rings & Retaining Pins SAE MM



PINS

| Item Number | Fits Socket Drive End Diameters | Pin Diameter | Pin Length |
|-------------|---------------------------------|--------------|------------|
| 4525 | 5.00 (127mm) | .315 | 4.49 |
| 4526 | 5.98 (152mm) | .315 | 5.47 |

O-RINGS

| Item Number | Fits Socket Drive End Diameters | O-Ring I.D. | O-Ring Thickness |
|-------------|---------------------------------|-------------|------------------|
| 4515 | 5.00 (127mm) | 4.49 | .276 |
| 4516 | 5.98 (152mm) | 5.47 | .276 |

Socket Retention Device Key for 2-1/2" Drive Adapters & Extensions



PH Pin Hole

Uses Ret Ring® or Pin & O-ring to secure socket. The most secure system available. Recommended for 3/4" drive and larger impact wrenches.

Do NOT run the tool when the socket is **OFF** the fastener.