

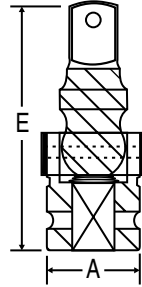

3/4" Drive Impact Attachments



3/4" Drive Universal Joint SAE



Item Number	Description	Dimensions (Inches)	
		A	E
3006UJ	3/4" x 3/4" w/Pin Hole	1.73	4.13

3/4" Drive Socket O-Rings & Retaining Pins SAE MM

PINS



Item Number	Fits Socket Drive End Diameters	Pin Diameter	Pin Length
3220	1.42" - 1.57" (36mm - 40mm)	.16" (4mm)	1.18" (30mm)
3221	1.65" - 1.75" (42mm - 44mm)	.16" (4mm)	1.38" (35mm)
4520	1.89" - 2.24" (48mm - 57mm)	.20" (5mm)	1.77" (45mm)

O-RINGS



Item Number	Fits Socket Drive End Diameters	O-Ring I.D.	O-Ring Thickness
3210	1.42" - 1.57" (36mm - 40mm)	1.22" (31mm)	.20" (5mm)
3211	1.65" - 1.69" (42mm - 43mm)	1.34" (34mm)	.20" (5mm)
3212	1.73" (44mm)	1.48" (37.5mm)	.20" (5mm)
4511	2.13" - 2.44" (54mm - 62mm)	1.85" (47mm)	.20" (5mm)

3/4" Ret Ring® One Piece Impact Socket Retainers SAE MM



The Ret Ring® connects an impact socket onto an impact wrench, extension, adapter or universal joint. One-piece, molded of new space age polyurethane, with a steel insert for added safety. Available for 3/4", 1" and 1-1/2" drive impact sockets. 3/4" drive sizes listed below. For a complete listing and cross-reference to other manufacturer's part numbers see page 121.

Item Number	Square Drive Size	Fits Socket Ends "A" Diameters
3110	3/4"	1.50" (38mm)
3111	3/4"	1.65" - 1.77" (42mm - 44mm)
3112	3/4"	2.13" - 2.24" (54mm - 56mm)

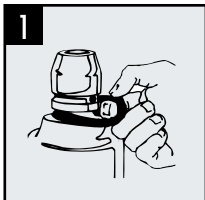

Step 1
Place Ret Ring® over impact square drive, put on impact socket aligning retention holes, then insert center-pin through retention holes.



Step 2
Push center-pin completely through hole.



Step 3
Pull O-ring up into groove on opposite side.