



*Impact Sockets,
Chisels & Attachments*

EVERYTHING IMPACT.®





GP is **EVERYTHING IMPACT**®

Grey Pneumatic (GP) through our distributors supplies the world's automotive, industrial, assembly, mining, maintenance, construction, and energy industries with heavy duty, high quality impact and specialty sockets. We carry a complete line of Impact Socket sets and individuals from 1/4" drive thru 2-1/2" and #5 spline drive with hex sizes up to 8". We also offer a large selection of star impact drivers, impact hex drivers, triple square drivers, torque limiting extensions plus Impact chisels and accessories.

GP sockets and tools are made in Taiwan using the highest quality chrome-molybdenum alloy steel and state-of-the-art manufacturing processes and equipment. Thorough and exact heat treatment, as well as rigid quality control, ensures the correct balance of strength and durability to deliver outstanding performance at the most competitive cost.

GP Tools are available through Automotive and Industrial warehouse distributors, tool stores, mobile tool truck dealers, tire equipment and supply warehouses and other sources that service these markets.

GP offers **Fast and Reliable** service to all of our distributors and their customers.



*GP Tools carry a
Lifetime Warranty.*

All GP Impact Sockets feature the GP "High Torque" Drive

Benefits are:

Increased Strength - Transfers the pressure from the thinnest part of the socket wall toward the thicker section, resulting in increased strength.

Increased Torque - Allows up to 20% more torque to be applied than on standard hex impact sockets.

Easier Access to Tight Areas - The shift in pressure allows us to reduce the socket wall thickness, increasing access to tight areas.

Reduced Wear - Our impact sockets grip the fastener across a broader contact area, reducing the chance of rounding off fasteners.

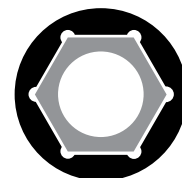

*GP "High Torque"
drive offers many
benefits.*



*All GP Sockets feature
extra-large size markings
for quick identification.*

EVERYTHING IMPACT®



1/2" Drive Impact Hex Drivers



Hex 1/2" Drive Fractional Hex Drivers SAE

One piece impact hex drivers in fractional sizes.



Item Number	Hex Size	Dimensions (Inches)			
		A	C	D	E
2908F	1/4"	.98	2.01	.59	2.95
2909F	9/32"	.98	2.01	.79	2.95
2910F	5/16"	.98	2.01	.98	2.95
2912F	3/8"	.98	2.01	.98	2.95
2914F	7/16"	.98	2.01	.98	2.95
2916F	1/2"	.98	2.01	.98	2.95
2918F	9/16"	.98	2.01	.98	2.95
2920F	5/8"	.98	2.01	.98	2.95
2922F	11/16"	.98	2.01	.98	2.95
2924F	3/4"	.98	2.01	.98	2.95

HEX

Hex 1/2" Drive Metric Hex Drivers MM

One piece impact hex drivers in metric sizes.

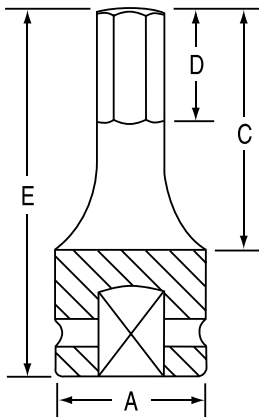

Item Number	Hex Size	Dimensions (Millimeters)			
		A	C	D	E
2906M	6mm	25	51	15	75
2907M	7mm	25	51	20	75
2908M	8mm	25	51	25	75
2909M	9mm	25	51	25	75
2910M	10mm	25	51	25	75
2911M	11mm	25	51	25	75
2912M	12mm	25	51	25	75
2913M	13mm	25	51	25	75
2914M	14mm	25	51	25	75
2915M	15mm	25	51	25	75
2916M	16mm	25	51	25	75
2917M	17mm	25	51	25	75
2918M	18mm	25	51	25	75
2919M	19mm	25	51	25	75



Hex Driver Display & Display Components



No. D157H

1/4", 3/8" & 1/2" Hex Driver Display



Dimensions:
Wall Mount: 24" W x 48-1/2" H x 8" D
Free Standing: 24" W x 55-1/4" H x 15-1/2" D
Weight: 54.0 lbs.

Includes a complete range of individual Hex Drivers as well as the most popular sets.

57 Piece Display Contents:

1/4" Drive Fractional Sizes:

1- 9904F	1/8"
1- 9905F	5/32"
1- 9906F	3/16"
1- 9907F	7/32"
1- 9908F	1/4"
1- 9910F	5/16"
1- 9912F	3/8"

1/4" Drive Metric Sizes:

1- 9902M	2mm
1- 9925M	2.5mm
1- 9903M	3mm
1- 9904M	4mm
1- 9905M	5mm
1- 9906M	6mm
1- 9907M	7mm
1- 9908M	8mm
1- 9910M	10mm

3/8" Drive Fractional Sizes:

1- 1906F	3/16"
1- 1907F	7/32"
1- 1908F	1/4"
1- 1910F	5/16"
1- 1912F	3/8"
1- 1914F	7/16"
1- 1916F	1/2"

3/8" Drive Metric Sizes:

1- 1904M	4mm
1- 1905M	5mm
1- 1906M	6mm
1- 1907M	7mm
1- 1908M	8mm
1- 1910M	10mm
1- 1912M	12mm

1/2" Drive Fractional Sizes:

1- 2908F	1/4"
1- 2909F	9/32"
1- 2910F	5/16"
1- 2912F	3/8"
1- 2914F	7/16"
1- 2916F	1/2"
1- 2918F	9/16"
1- 2920F	5/8"
1- 2922F	11/16"
1- 2924F	3/4"

1/2" Drive Metric Sizes:

1- 2906M	6mm
1- 2907M	7mm
1- 2908M	8mm
1- 2910M	10mm
1- 2911M	11mm
1- 2912M	12mm
1- 2913M	13mm
1- 2914M	14mm
1- 2915M	15mm
1- 2916M	16mm
1- 2917M	17mm
1- 2918M	18mm
1- 2919M	19mm

Fractional Sets

7 piece - 1297H	3/8" Drive
10 piece - 1398H	1/2" Drive

Metric Sets

7 piece - 1297MH	3/8" Drive
10 piece - 1498MH	1/2" Drive

Custom Display Components



Item Number Description

BASE RACK

DBASE	Display rack, includes coroplast backer & sign holder
LEGKIT	Set of legs for DBASE (1 pair)

SHELVES

4SHELF	4" Shelf for display (used for most sockets)
6SHELF	6" Shelf for display (used for small sets & large sockets)

RAIL & CLIPS

CRAILKIT	Metal rail for socket clips includes mounting hardware
14CLIP	1/4" clip for rail (each)
38CLIP	3/8" clip for rail (each)
12CLIP	1/2" clip for rail (each)
34CLIP	3/4" clip for rail (each)
1CLIP	1" clip for rail (each)

SIGNAGE

GENERICARD	Generic GP "IMPACT SOCKETS" Header Card 8" x 24"
SCHANNEL	Blank sign channel for 4" & 6" shelves (white)

Displays