



*Impact Sockets,
Chisels & Attachments*

EVERYTHING IMPACT.®





GP is **EVERYTHING IMPACT**®

Grey Pneumatic (GP) through our distributors supplies the world's automotive, industrial, assembly, mining, maintenance, construction, and energy industries with heavy duty, high quality impact and specialty sockets. We carry a complete line of Impact Socket sets and individuals from 1/4" drive thru 2-1/2" and #5 spline drive with hex sizes up to 8". We also offer a large selection of star impact drivers, impact hex drivers, triple square drivers, torque limiting extensions plus Impact chisels and accessories.

GP sockets and tools are made in Taiwan using the highest quality chrome-molybdenum alloy steel and state-of-the-art manufacturing processes and equipment. Thorough and exact heat treatment, as well as rigid quality control, ensures the correct balance of strength and durability to deliver outstanding performance at the most competitive cost.

GP Tools are available through Automotive and Industrial warehouse distributors, tool stores, mobile tool truck dealers, tire equipment and supply warehouses and other sources that service these markets.

GP offers **Fast and Reliable** service to all of our distributors and their customers.



*GP Tools carry a
Lifetime Warranty.*

All GP Impact Sockets feature the GP "High Torque" Drive

Benefits are:

Increased Strength - Transfers the pressure from the thinnest part of the socket wall toward the thicker section, resulting in increased strength.

Increased Torque - Allows up to 20% more torque to be applied than on standard hex impact sockets.

Easier Access to Tight Areas - The shift in pressure allows us to reduce the socket wall thickness, increasing access to tight areas.

Reduced Wear - Our impact sockets grip the fastener across a broader contact area, reducing the chance of rounding off fasteners.



*GP "High Torque"
drive offers many
benefits.*



*All GP Sockets feature
extra-large size markings
for quick identification.*

EVERYTHING IMPACT®



No. 103RA Reducing Adapter Set - Sleeve Type - Low Profile

These adapters reduce larger drive sizes down for use on smaller drive tools. The low profile design allows for use in a wide range of applications. A magnetic retention device keeps the adapter attached to the socket. Adapters can be stacked if additional drive reduction is needed. Designed for impact or hand tool use.



3 piece set contents:

1 ea: 938RA, 1138RA and 2238RA

Three piece set is conveniently packaged in a blister pack.

Individual Reducing Adapters - Sleeve Type - Low Profile



Item Number	Female End Size	Male End Size
938RA	1/4"	3/8"
912RA	1/4"	1/2"
1138RA	3/8"	1/2"
2238RA	1/2"	3/4"
3009RA	3/4"	1"
4009RA	1"	1-1/2"
6009RA	1-1/2"	2-1/2"

Impact Wrench Quick Change Adapters

These adapters provide a "quick change" mechanism by the use of a sliding collar and positive retention ball for fast change of a socket on the end of the tool anvil. Works with Impact tool anvils that have a clip retention device or pin hole. A pin hole type anvil and use of a pin and retaining o-ring recommended to secure this adapter to the anvil.

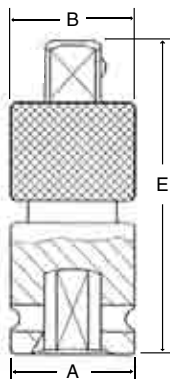

Item Number	Description	Dimensions (Inches)		
		A	B	E
930QC	1/4" Drive Quick Change Adapter	.51	.53	1.38
1130QC	3/8" Drive Quick Change Adapter	.79	.81	1.82
2230QC	1/2" Drive Quick Change Adapter	.98	1.00	2.38
3030QC	3/4" Drive Quick Change Adapter	1.74	1.76	3.18
4030QC	1" Drive Quick Change Adapter	2.13	2.15	3.95

Specials

