



*Impact Sockets,
Chisels & Attachments*

EVERYTHING IMPACT.®





GP is **EVERYTHING IMPACT**®

Grey Pneumatic (GP) through our distributors supplies the world's automotive, industrial, assembly, mining, maintenance, construction, and energy industries with heavy duty, high quality impact and specialty sockets. We carry a complete line of Impact Socket sets and individuals from 1/4" drive thru 2-1/2" and #5 spline drive with hex sizes up to 8". We also offer a large selection of star impact drivers, impact hex drivers, triple square drivers, torque limiting extensions plus Impact chisels and accessories.

GP sockets and tools are made in Taiwan using the highest quality chrome-molybdenum alloy steel and state-of-the-art manufacturing processes and equipment. Thorough and exact heat treatment, as well as rigid quality control, ensures the correct balance of strength and durability to deliver outstanding performance at the most competitive cost.

GP Tools are available through Automotive and Industrial warehouse distributors, tool stores, mobile tool truck dealers, tire equipment and supply warehouses and other sources that service these markets.

GP offers **Fast and Reliable** service to all of our distributors and their customers.



*GP Tools carry a
Lifetime Warranty.*

All GP Impact Sockets feature the GP "High Torque" Drive

Benefits are:

Increased Strength - Transfers the pressure from the thinnest part of the socket wall toward the thicker section, resulting in increased strength.

Increased Torque - Allows up to 20% more torque to be applied than on standard hex impact sockets.

Easier Access to Tight Areas - The shift in pressure allows us to reduce the socket wall thickness, increasing access to tight areas.

Reduced Wear - Our impact sockets grip the fastener across a broader contact area, reducing the chance of rounding off fasteners.



*GP "High Torque"
drive offers many
benefits.*



*All GP Sockets feature
extra-large size markings
for quick identification.*

EVERYTHING IMPACT®



3/4" Drive Impact Attachments



3/4" Drive Universal Joint SAE

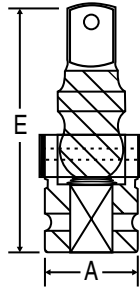

Item Number	Description	Dimensions (Inches)	
		A	E
3006UJ	3/4" x 3/4" w/Pin Hole	1.73	4.13

3/4"

3/4" Drive Socket O-Rings & Retaining Pins SAE MM

PINS



Item Number	Fits Socket Drive End Diameters	Pin Diameter	Pin Length
3220	1.42" - 1.57" (36mm - 40mm)	.16" (4mm)	1.18" (30mm)
3221	1.65" - 1.75" (42mm - 44mm)	.16" (4mm)	1.38" (35mm)
4520	1.89" - 2.24" (48mm - 57mm)	.20" (5mm)	1.77" (45mm)

O-RINGS



Item Number	Fits Socket Drive End Diameters	O-Ring I.D.	O-Ring Thickness
3210	1.42" - 1.57" (36mm - 40mm)	1.22" (31mm)	.20" (5mm)
3211	1.65" - 1.69" (42mm - 43mm)	1.34" (34mm)	.20" (5mm)
3212	1.73" (44mm)	1.48" (37.5mm)	.20" (5mm)
4511	2.13" - 2.44" (54mm - 62mm)	1.85" (47mm)	.20" (5mm)

3/4" Ret Ring® One Piece Impact Socket Retainers SAE MM



The Ret Ring® connects an impact socket onto an impact wrench, extension, adapter or universal joint. One-piece, molded of new space age polyurethane, with a steel insert for added safety. Available for 3/4", 1" and 1-1/2" drive impact sockets. 3/4" drive sizes listed below. For a complete listing and cross-reference to other manufacturer's part numbers see page 121.

Item Number	Square Drive Size	Fits Socket Ends "A" Diameters
3110	3/4"	1.50" (38mm)
3111	3/4"	1.65" - 1.77" (42mm - 44mm)
3112	3/4"	2.13" - 2.24" (54mm - 56mm)

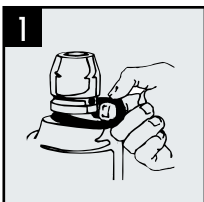

Step 1
Place Ret Ring® over impact square drive, put on impact socket aligning retention holes, then insert center-pin through retention holes.



Step 2
Push center-pin completely through hole.



Step 3
Pull O-ring up into groove on opposite side.