

Deep Impact Sockets

Nose-Down Means Greater Access

The nose-down design on smaller S•K 1/2" Drive Deep Impact Sockets extends the taper as far as possible, for improved access over straight wall designs.

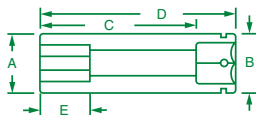

1/2" Drive, 6 Point, Deep Fractional Impact Sockets

PART NO.	HEX SIZE	A	B	C	D	E
34212	3/8"	0.65	1.00	1.80	3.25	0.41
34214	7/16"	0.73	1.00	1.81	3.25	0.43
34216	1/2"	0.79	1.00	1.81	3.25	0.55
34218	9/16"	0.87	1.00	1.81	3.25	0.55
34220	5/8"	1.00	1.00	1.81	3.25	0.63
34222	11/16"	1.08	1.08	1.81	3.25	0.63
34224	3/4"	1.13	1.13	1.81	3.25	0.63
34226	13/16"	1.19	1.24	2.00	3.25	0.72
34228	7/8"	1.28	1.31	2.00	3.50	0.72
34230	15/16"	1.38	1.38	2.00	3.50	0.76
34232	1"	1.49	1.44	2.00	3.50	0.76
34234	1 1/16"	1.50	1.51	2.00	3.50	0.76
34236	1 1/8"	1.63	1.62	2.12	3.50	0.84
34238	1 3/16"	1.69	1.69	2.12	3.50	0.84
34240	1 1/4"	1.75	1.75	2.12	3.50	0.84
34242	1 5/16"	1.94	2.00	2.12	3.50	0.84
34244	1 3/8"	1.94	2.00	2.12	3.50	0.90
34246	1 7/16"	2.00	2.15	2.12	3.50	0.90
34248	1 1/2"	2.06	2.23	2.12	3.50	0.90



No. 4041

11 Piece, 1/2" Drive, 6 Point, Deep Fractional Impact Socket Set Includes:

PART NO.	SIZE	PART NO.	SIZE	PART NO.	SIZE	PART NO.	SIZE
34212	3/8"	34218	9/16"	34224	3/4"	34230	15/16"
34214	7/16"	34220	5/8"	34226	13/16"	34232	1"
34216	1/2"	34222	11/16"	34228	7/8"		

Packaged on a rail.

IMPACT SOCKETS

high visibility



No. 4045

15 Piece, 1/2" Drive, 6 Point, Deep Fractional Impact Socket Set Includes:

PART NO.	SIZE	PART NO.	SIZE	PART NO.	SIZE	PART NO.	SIZE
34212	3/8"	34220	5/8"	34228	7/8"	34236	1 1/8"
34214	7/16"	34222	11/16"	34230	15/16"	34238	1 3/16"
34216	1/2"	34224	3/4"	34232	1"	34240	1 1/4"
34218	9/16"	34226	13/16"	34234	1 1/16"		

Packaged on a rail.



No. 4049

19 Piece, 1/2" Drive, 6 Point, Deep Fractional Impact Socket Set Includes:

PART NO.	SIZE	PART NO.	SIZE	PART NO.	SIZE	PART NO.	SIZE
34212	3/8"	34222	11/16"	34232	1"	34242	1 5/16"
34214	7/16"	34224	3/4"	34234	1 1/16"	34244	1 3/8"
34216	1/2"	34226	13/16"	34236	1 1/8"	34246	1 7/16"
34218	9/16"	34228	7/8"	34238	1 3/16"	34248	1 1/2"
34220	5/8"	34230	15/16"	34240	1 1/4"		

Packaged on a rail.